

**PHOTOMETRIC SCHEDULE**

	MINOR STREETS	FRESNO AVENUE
AVERAGE FOOTCANDLES	0.52	0.75
MAX. FOOTCANDLES	1.2	3.1
MIN. FOOTCANDLES	0.2	0.2
UNIFORMITY RATIO*	3:1 **	4:1 **

\*AVERAGE TO MIN. FOOTCANDLE READING ON PAVEMENT  
 \*\*CALCULATION LIMITED TO AREAS OF VEHICULAR ACCESS WITHIN PUBLIC STREETS

**PHOTOMETRIC PARAMETERS:**

LIGHT READINGS ARE ESTIMATED LEVELS IN PRIME CONDITIONS AND SHOULD NOT BE TAKEN AS EXACT READINGS.  
 FOOT CANDLE LIGHT READINGS ARE SPACED 10 FT. APART  
 EXISTING STREET LIGHTING IS SIMULATED BASED ON DATA PROVIDED FROM MFRS. AND APPROXIMATIONS OF EXISTING STREET LIGHTING.

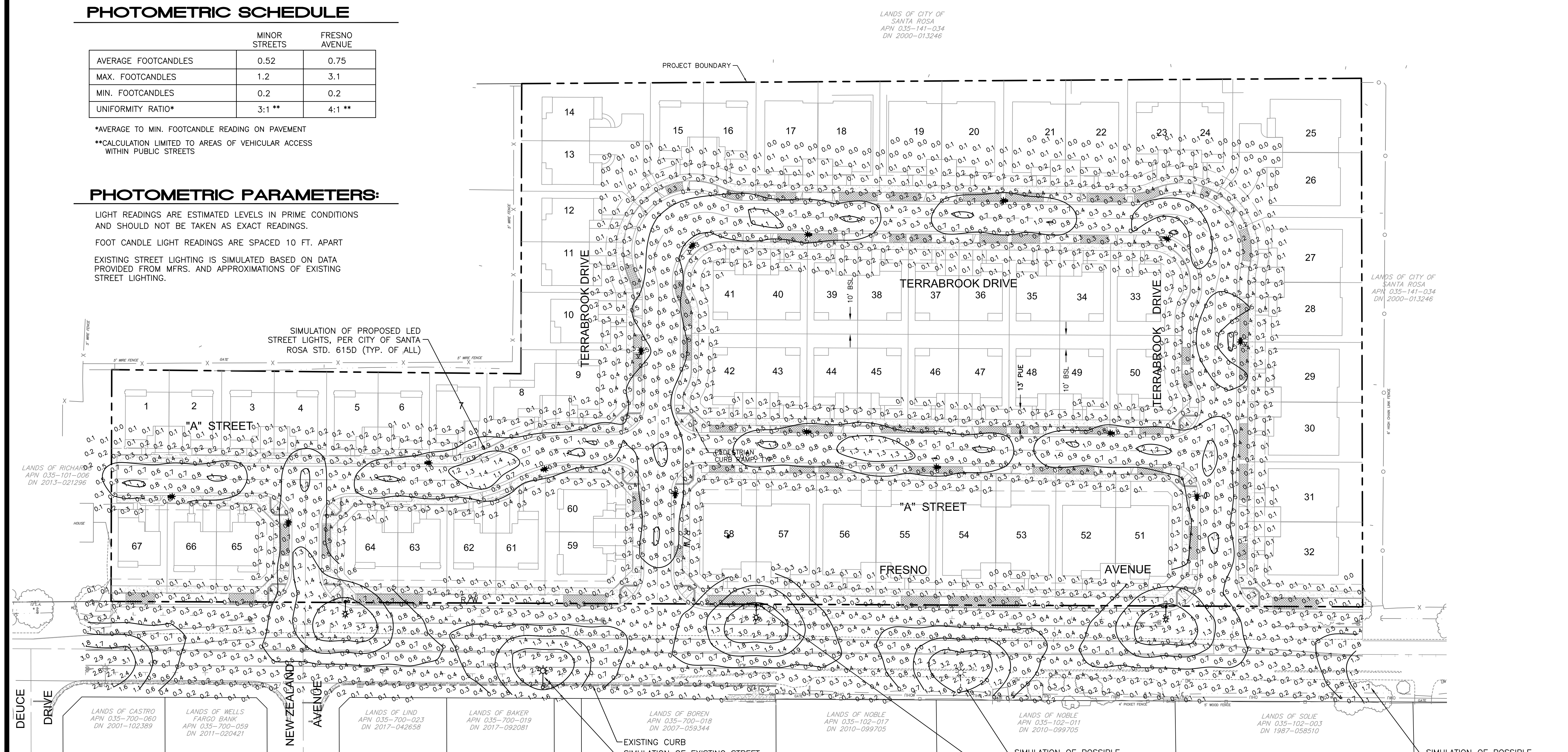

**PHOTOMETRIC ANALYSIS**

SCALE: 1" = 40'

**STREET LIGHTING LEGEND**

SYMBOL	TYPE	MANUFACTURER/SERIES	LUMINAIRE MODEL #	MOUNTING HEIGHT	ARM LENGTH	NOTES	QTY.
	EXISTING PUBLIC LIGHT STANDARD		PER CITY STANDARD 611	28'-0" VIF	6' W	PROTECT IN PLACE	-
	INTERIOR STREET LIGHT STANDARD PER CITY STD 615D *	HALOPHANE	AWDE-P20-30K-MVOLT-MS-AL3LU-GN W/ PHOTO CONTROL OPTION AND POLE PER CITY STD. (TYPE 3 DIST. 3000K)	15'-6"	N/A	6,000 LUMEN 70 W LED	11
	INTERIOR STREET LIGHT STANDARD PER CITY STD 615D *	HALOPHANE	AWDE-P20-30K-MVOLT-MS-AL5LU-GN W/ PHOTO CONTROL OPTION AND POLE PER CITY STD. (TYPE 5 DIST. 3000K)	15'-6"	N/A	6,000 LUMEN 70 W LED	4
	COBRAHEAD STYLE LIGHT STANDARD PER CITY STD 611 **	CREE LEDWAY	STR-LWY-3M-HI-08-E -UL-SY-525-N-7PHI-40K W/ PHOTO CONTROL OPTION PER CITY STD. (TYPE 3 DIST. 4000K)	28'-0"	6'	80 W LED	3

\* INSTALL PER MFR MOUNTING DESIGN AND CITY STANDARDS 602, 620B. LEVELING DETAIL PER MFR.  
 \*\* INSTALL PER CITY STANDARDS 620A, 621, 602. ALL STREET LIGHT POLES SHALL BE AMERON SERIES PL, LANDMARK LIGHTING S3508, PACIFIC UNION METAL LA 10120 OR AN APPROVED EQUAL

**LIGHTING NOTES**

- ALL LIGHTING SHALL COMPLY WITH THE CITY OF SANTA ROSA STREET LIGHTING DESIGN STANDARDS AND MEET THE APPLICABLE 2019 CALIFORNIA GREEN BUILDING STANDARDS CODE.
- SITE LIGHTING SHALL BE DIRECTED AND INSTALLED TO PREVENT OFF-SITE GLARE TO RESIDENCES.
- LUMINAIRES SHALL BE FULL CUTOFF ON ALL LOCAL ROADS AND IN ALL RESIDENTIAL AREAS. LUMINAIRES SHALL BE CUTOFF OR FULL CUTOFF IN ALL OTHER AREAS.
- THESE CALCULATIONS ARE BASED ON LIGHT LOCATIONS, TYPE, AND MOUNTING HEIGHT AS INDICATED ON THE PLAN AND LEGEND.
- LIGHTING SHALL BE EQUIPPED WITH VANDAL RESISTANT COVERS IN AREAS ADJACENT TO THE PUBLIC RIGHT OF WAY, AS REQUIRED.
- ALL EXTERIOR DOORS SHALL BE PROVIDED WITH THEIR OWN LIGHT SOURCE AND SHALL BE ADEQUATELY ILLUMINATED AT ALL HOURS OF DARKNESS TO MAKE CLEARLY VISIBLE THE PRESENCE OF ANY PERSON ON OR ABOUT THE PREMISES AND PROVIDE ADEQUATE ILLUMINATION FOR PERSONS EXITING THE BUILDING.
- PROPOSED DECORATIVE STREET LIGHTS (CITY STANDARD 615D) ARE TYPICALLY SPACED 110 TO 150 FEET ON CENTER. STREET LIGHTS SHOWN HAVE BEEN SPACED TO ACHIEVE 0.3 FC ON THE MINOR PUBLIC STREETS AND SIDEWALKS.
- PROPOSED COBRA-HEAD STREET LIGHTS (CITY STANDARD 611) SHALL BE LED LUMINAIRES, PRODUCED BY A MANUFACTURER APPROVED BY THE CITY OF SANTA ROSA. COLOR TEMPERATURE SHALL BE LESS THAN 4000K.

