



New Food Truck

El Roy's Express Mex

CITY OF SANTA ROSA
Dated Received July 8, 2022

505-509-515-517-523 Santa Rosa Ave.
& 518 Sebastopol Rd.

Santa Rosa CA 95404

APN #010-223-063 / 061 / 059 / 065 / 057
& 010-223-007

Owner:
El Roy's Express Mex Inc.
Roy Cabrera
2661 Santa Rosa Ave. #354
Santa Rosa CA 95407
(707) 304-1596

Sheet Index:
A1.1 Title Sheet, Vicinity Map Site Plan
A1.2 Neighborhood Context Map
A1.3 Site Photos
Rv OA Photometric Site Plan

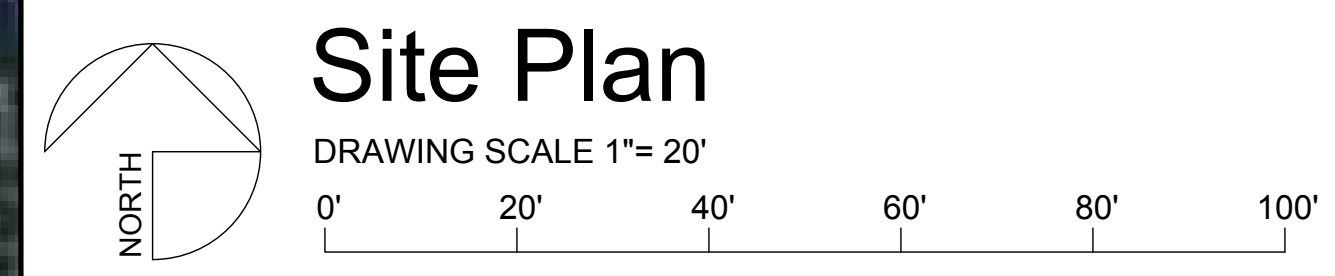
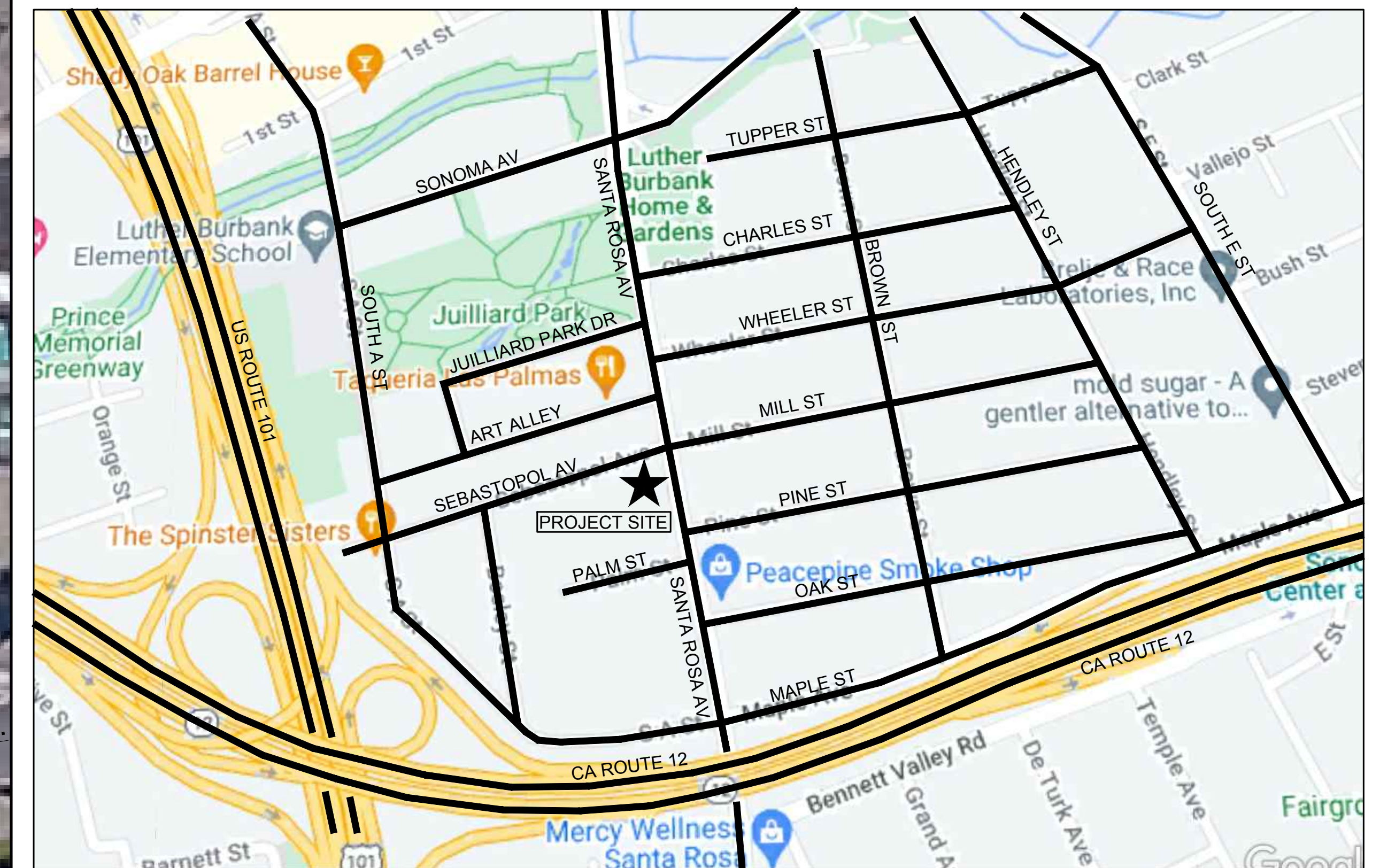

Hedgpeth ARCHITECTS
2321 Bethards Drive
Santa Rosa, California
95405
Phone 707 523 7010
Fax 707 542 2328

Proposed Food Truck in Santa Rosa for
EL ROY'S EXPRESS MEX

ROY CABRERA, OWNER
PROJECT LOCATION:
505 SANTA ROSA AVE, SANTA ROSA, CA 95404
OFFICE MAILING ADDRESS: 2661 SANTA ROSA AVE, #354, SANTA ROSA, CA 95407

NEIGHBORHOOD CONTEXT MAP
VICINITY MAP

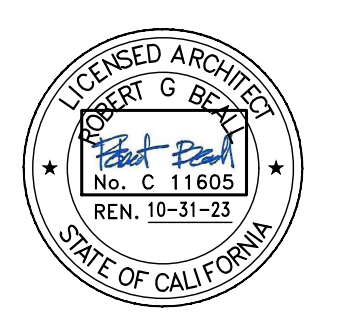

Revisions
220511 SITE PLAN
220705 PLNG RESUBMIT

Job Number
2204

Project Designer
PAUL GILGER

Drawn By
PAUL GILGER

Date
CONTRACT: MARCH 2021

Sheet

NOT FOR CONSTRUCTION
A1.1
of -



Proposed Food Truck in Santa Rosa for
EL ROY'S EXPRESS MEX

ROY CABRERA, OWNER
PROJECT LOCATION:
656 SANTA ROSA AVE, SANTA ROSA, CA 95404
OFFICE MAILING ADDRESS: 2681 SANTA ROSA AVE, #354, SANTA ROSA, CA 95407

NEIGHBORHOOD CONTEXT MAP



Revisions
220511 SITE PLAN
220705 PLNG RESUBMIT

Job Number
2204

Project Designer
PAUL GILGER

Drawn By
PAUL GILGER

Date
CONTRACT: MARCH 2021

Sheet
A1.2
of -

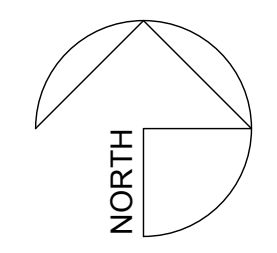

NOT FOR CONSTRUCTION



Toilet Rm door

3

View of adjacent toilet room



4

View of site from North



5

View of site from Northeast



2

View of small tree



3

4

5



6

View of site from East



1

View of large tree



2

1

6

7



7

View of site from Southeast

SITE PHOTOS

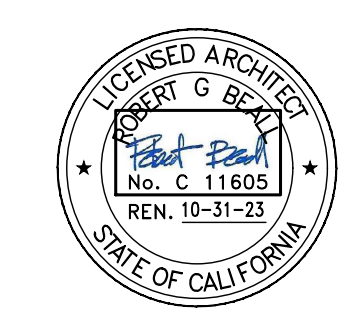

Revisions
220511 SITE PLAN
220705 PLNG RESUBMIT

Job Number
2204

Project Designer
PAUL GILGER

Drawn By
PAUL GILGER

Date
CONTRACT: MARCH 2021

Sheet
A1.3

NOT FOR CONSTRUCTION
of -

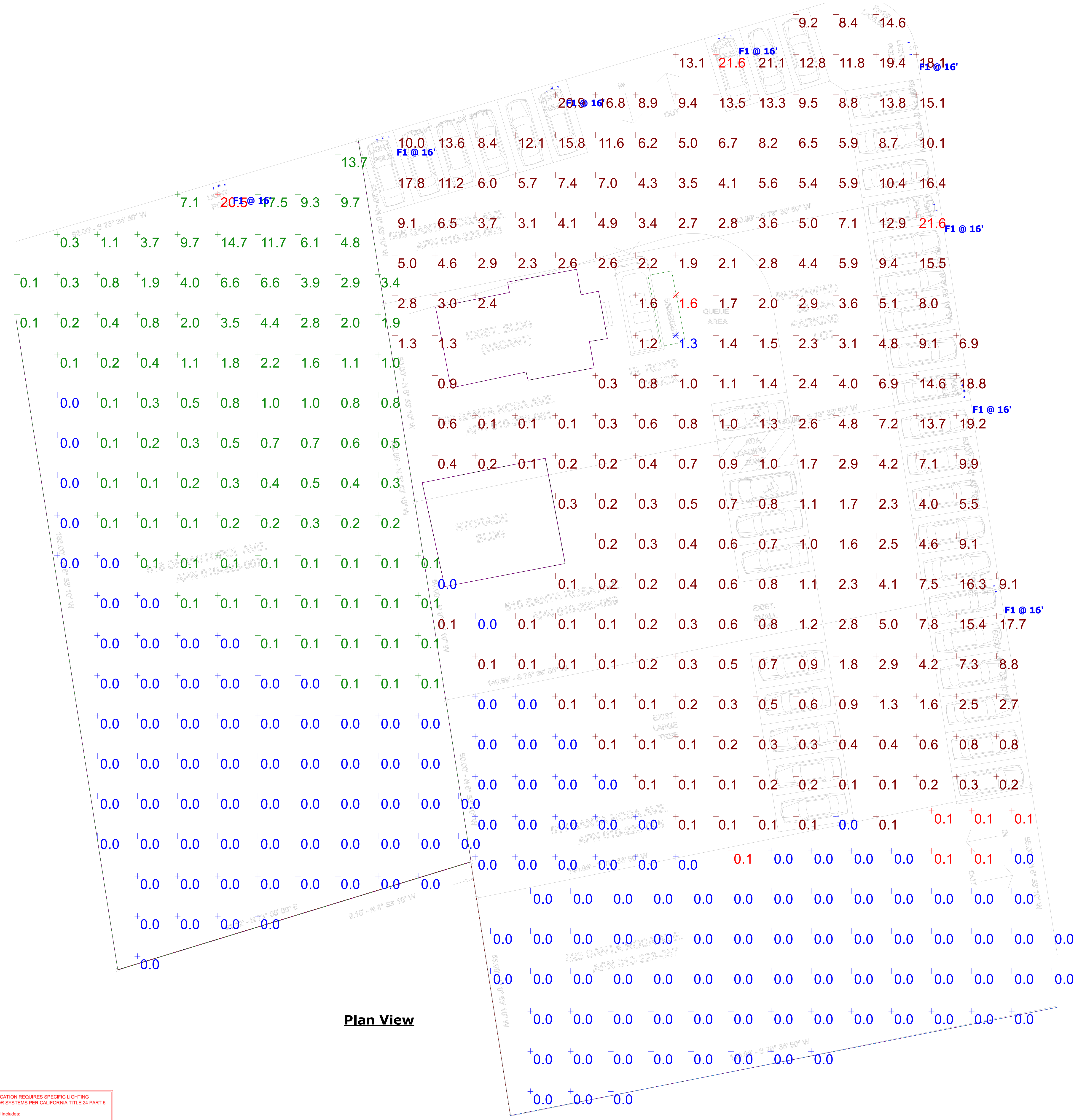

Plan View

THIS LIGHTING APPLICATION REQUIRES SPECIFIC LIGHTING CONTROL DEVICES OR SYSTEMS PER CALIFORNIA TITLE 24 PART 6.

Therefore, this proposal includes:

- SOLUTION: This proposal includes a complete lighting and control system either as an alternative to that specified, or as a recommendation based on the information provided, subject to your review and approval.
- SUPPLEMENT: This proposal includes lighting as requested/specified, as well as a proposed lighting control system for your review and approval.
- ALERT: This proposal includes only lighting as requested/specified, however, the application hereby requires compatible lighting controls to meet the following criteria. We are happy to provide a lighting control questionnaire at your request.
 - Manual Switch(es)
 - Automatic time switch (astronomical)
 - Occupancy Sensor(s)
 - Photoelectric(s) (daylight sensor(s))
 - Demand response / load shedding
 - Controlled Receptacle(s)
 - Motion Sensor(s) - Outdoor



Ceiling Height: Varies
 Luminaire Mounting Height: As noted
 Calculation Point Height: As noted

Luminaire illuminance values provided in this report, whether for normal, critical, or emergency applications, are for product application assistance only. These values were developed in collaboration with, and are subject to approval by, the design professional of record (architect/engineer/LC), and are NOT intended for construction. Because these values are approximate and based on limited application information provided to 16500, Inc. at the time of calculation, 16500, Inc. does not warrant the installed performance of the luminaire(s) will match that shown in this report. Please verify all data and conditions to assure the accuracy of the report. 16500 shall neither be responsible nor liable for design, approval, or results of emergency lighting under any circumstance.

Symbol	Label	Quantity	Manufacturer	Catalog Number	Description	Lamp	Lumens Per Lamp	Light Loss Factor	Wattage
F1		8	SLOANLED	LCG-SB-100W-U-40K-T4-(finish)-(mounting)-D1			13200	0.85	200

Description	Symbol	Avg	Max	Min	Max/Min	Avg/Min
Ordering 0'-0"	X	1.4 fc	1.6 fc	1.3 fc	1.2:1	1.1:1
Parking Lot 0'-0"	+	4.1 fc	21.6 fc	0.0 fc	N/A	N/A
Parking Lot Exit 0'-0"	+	0.0 fc	0.1 fc	0.0 fc	N/A	N/A
Landcape Spill Light 0'-0"	+	1.2 fc	20.5 fc	0.0 fc	N/A	N/A

Finish	Surface	Reflectance / Transmittance
Grey	Walls	50%
Grey	Ground	20%