

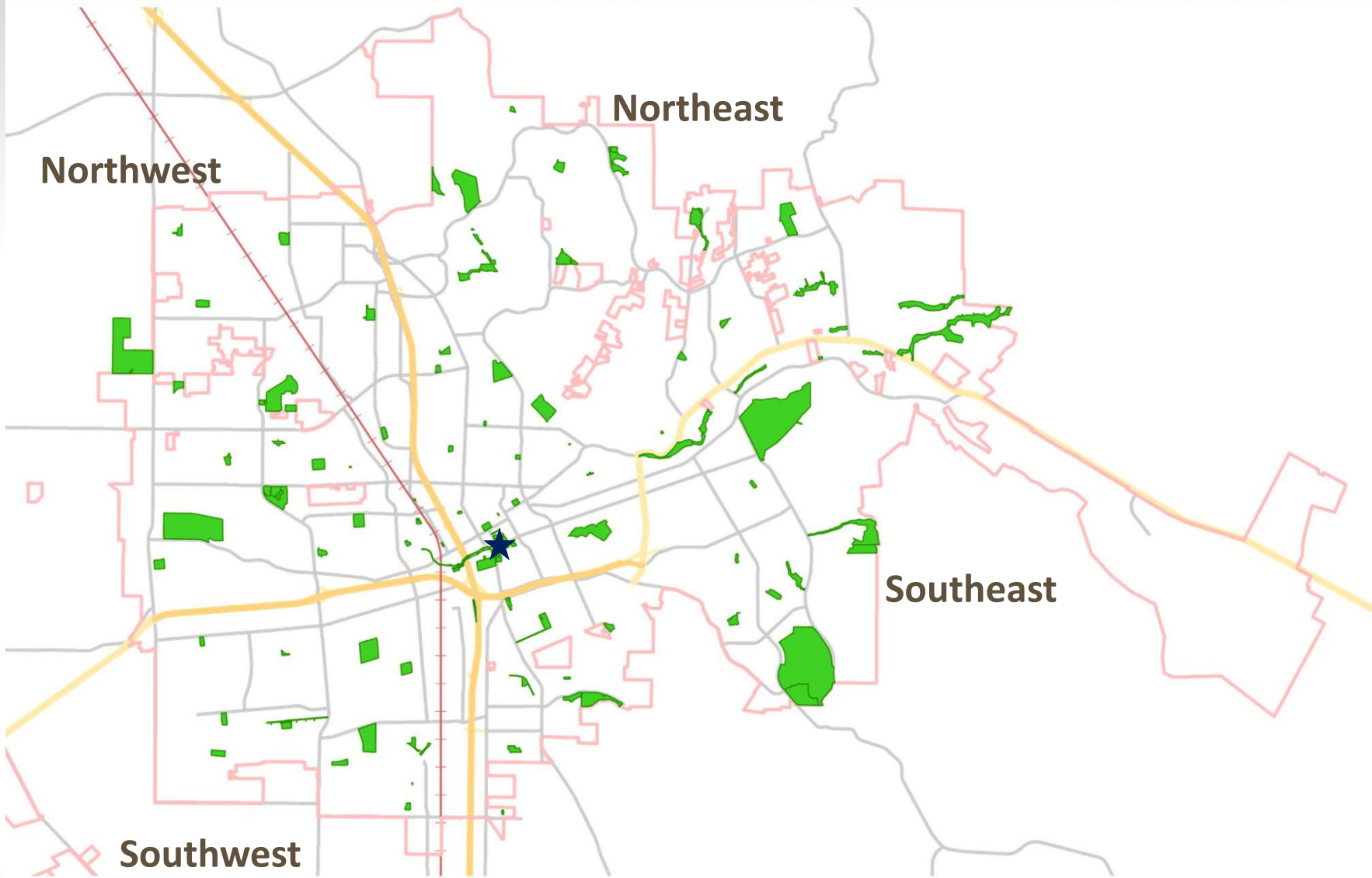

Luther Burbank Home & Gardens Roof Replacement Project

Cultural Heritage Board
September 7, 2022

Scott Wilkinson
Parks Planner



Location in Parks System



aerial site map



historic photos



historic photos



historic photos



historic photos

KEYNOTES

- E01 NEW ASP. ALUM. SH. GABLE CERTAINTEED
- E02 LINENWASH FINISH W/ EED. COLOR "EED"
- E03 PROTECT IN PLACE EX. STING METAL, DOWNSCOP TO EX. TRIM & DOWN BLACK FOR CLARITY
- E04 PROTECT IN PLACE EX. STING METAL, DOWNSCOP TO EX. TRIM & DOWN BLACK FOR CLARITY
- E05 REMOVE EXIST. W/ G METAL GUTTER, INSPECT EXISTING METAL DOWN SCOP OUT FOR REUSE.
- E06 RE-USE EXIST. W/ G ASPHALT SHIMMER RE-USE - RE-USE UNLESS CRACKS OR MISSING MORE OR LEAKS ARE NOTICED.
- E07 EXIST. W/ G WOOD GUTTER TO BE UNRECOGNIZABLE, SUBJECT TO BE REPAIRED AND REACTivate.
- E08 REMOVE EXISTING METAL DOWN SCOP OUT



WEST ELEVATION - MAIN HOUSE C3
1/4" = 1'-0"



SOUTH ELEVATION - MAIN HOUSE C1
1/4" = 1'-0"



EAST ELEVATION - MAIN HOUSE A3
1/4" = 1'-0"



NORTH ELEVATION - MAIN HOUSE A1
1/4" = 1'-0"

Main House - existing

KEYNOTES

- NE01 NEW ASPHALT SHINGLES, CERTAIN TEEB
1/8" MINIMUM OVERLAP @ 12" DIA. WE
- NE02 NEW 5/8" X 1/4" SHOOKS, 6" ASK HIGH
GLASS TY.
- NE03 JOIST BRACKET TO REMAIN, SHOWN
LOCATION FOR CLARITY.
- NE04 EXISTING 12" TYPICAL, SHOWN, BRACK
FOR CLARITY.
- NE05 NEW 2" X 4" BRACKET @ 16" ON CENTER
SILL TIE.
- NE06 BRACKET EXISTING DOWNSPOUT FOR
SCALE, NEW DOWNSPOUT IF NECESSARY
NEW DOWNSPOUT @ 12" ON CENTER FOR
CLARITY.
- NE07 RESTORE EXISTING BRICK CHIMNEY
CORNER, REPAIR THE BRICK ABOVE
THE LOWER PORTION REMOVED.

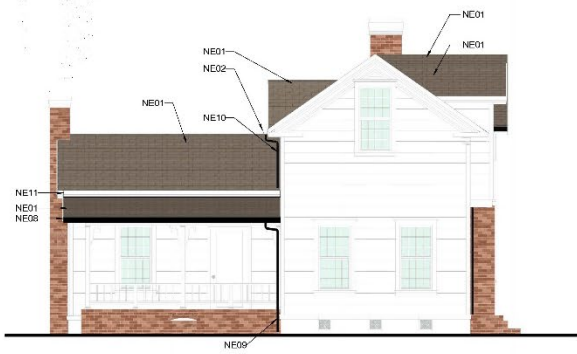

WEST ELEVATION-MAIN HOUSE C3
NF=1-2'



SOUTH ELEVATION-MAIN HOUSE C1
NF=1-7'

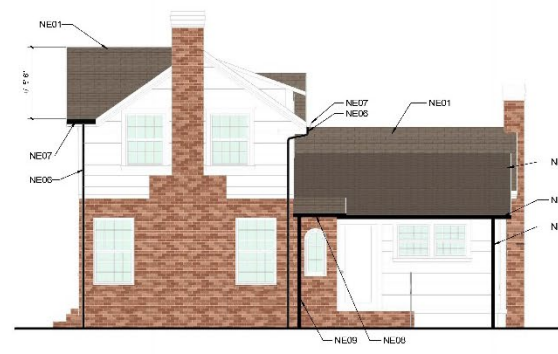

EAST ELEVATION-MAIN HOUSE A3
NF=1-2'



NORTH ELEVATION-MAIN HOUSE A1
NF=1-7'

FINISHED ROOF MATERIAL



CERTAIN TEEB
1/8" MINIMUM OVERLAP @ 12" DIA. WE
5/8" X 1/4" SHOOKS, 6" ASK HIGH
GLASS TY.

Main House - proposed

KEYNOTES

- E01 NEW ASPHALT SHINGLES, CHALK LINE PER 1.0
- E02 1.0 BRICK SHOT BOLT PER 1.0 CH. 1.0
- E03 PROTECT IN PLACE EXISTING METAL CUTTERS TO REMAIN SHOW BLACK FOR CLARITY
- E04 PROTECT IN PLACE EXISTING METAL DOORBOLT CUTTERS TO REMAIN SHOW BLACK FOR CLARITY
- E05 EXISTING WOOD SHINGLE ROOF AT SHED TO REMAIN
- E06 EXISTING T.E. ROOF TO REMAIN



CARRIAGE HOUSE - EXISTING WEST ELEVATION
 1/4" = 1'-0" **C3**

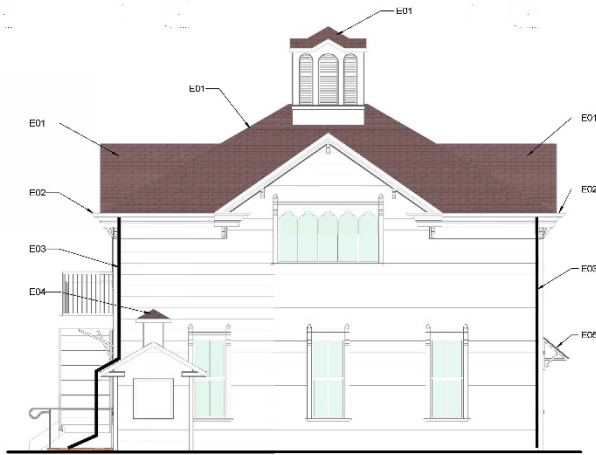

CARRIAGE HOUSE - EXISTING SOUTH ELEVATION
 1/4" = 1'-0" **C1**



CARRIAGE HOUSE - EXISTING EAST ELEVATION
 1/4" = 1'-0" **A3**



CARRIAGE HOUSE - EXISTING NORTH ELEVATION
 1/4" = 1'-0" **A1**

Carriage House - existing

KEYNOTES

- NE01 NEW ASPHALT SHINGLES, CERTAIN RED, 14" X 18" 30 YEAR WARRANTY, 125 GALS / 100 SQ FT
- NE04 15" X 20" 2" x 4" - NO. 1 - DOUGLASS SPRUCE - 10' MAX
- NE05 1" X 1" 3/8" - 10' MAX
- NE06 1" X 1" 3/8" - 10' MAX
- NE07 1" X 1" 3/8" - 10' MAX
- NE08 1" X 1" 3/8" - 10' MAX
- NE09 1" X 1" 3/8" - 10' MAX
- NE10 1" X 1" 3/8" - 10' MAX
- NE11 1" X 1" 3/8" - 10' MAX
- NE12 1" X 1" 3/8" - 10' MAX
- NE13 1" X 1" 3/8" - 10' MAX
- NE14 1" X 1" 3/8" - 10' MAX
- NE15 1" X 1" 3/8" - 10' MAX
- NE16 1" X 1" 3/8" - 10' MAX
- NE17 1" X 1" 3/8" - 10' MAX
- NE18 1" X 1" 3/8" - 10' MAX
- NE19 1" X 1" 3/8" - 10' MAX
- NE20 1" X 1" 3/8" - 10' MAX
- NE21 1" X 1" 3/8" - 10' MAX
- NE22 1" X 1" 3/8" - 10' MAX
- NE23 1" X 1" 3/8" - 10' MAX
- NE24 1" X 1" 3/8" - 10' MAX
- NE25 1" X 1" 3/8" - 10' MAX
- NE26 1" X 1" 3/8" - 10' MAX
- NE27 1" X 1" 3/8" - 10' MAX
- NE28 1" X 1" 3/8" - 10' MAX
- NE29 1" X 1" 3/8" - 10' MAX
- NE30 1" X 1" 3/8" - 10' MAX
- NE31 1" X 1" 3/8" - 10' MAX
- NE32 1" X 1" 3/8" - 10' MAX
- NE33 1" X 1" 3/8" - 10' MAX
- NE34 1" X 1" 3/8" - 10' MAX
- NE35 1" X 1" 3/8" - 10' MAX
- NE36 1" X 1" 3/8" - 10' MAX
- NE37 1" X 1" 3/8" - 10' MAX
- NE38 1" X 1" 3/8" - 10' MAX
- NE39 1" X 1" 3/8" - 10' MAX
- NE40 1" X 1" 3/8" - 10' MAX
- NE41 1" X 1" 3/8" - 10' MAX
- NE42 1" X 1" 3/8" - 10' MAX
- NE43 1" X 1" 3/8" - 10' MAX
- NE44 1" X 1" 3/8" - 10' MAX
- NE45 1" X 1" 3/8" - 10' MAX
- NE46 1" X 1" 3/8" - 10' MAX
- NE47 1" X 1" 3/8" - 10' MAX
- NE48 1" X 1" 3/8" - 10' MAX
- NE49 1" X 1" 3/8" - 10' MAX
- NE50 1" X 1" 3/8" - 10' MAX
- NE51 1" X 1" 3/8" - 10' MAX
- NE52 1" X 1" 3/8" - 10' MAX
- NE53 1" X 1" 3/8" - 10' MAX
- NE54 1" X 1" 3/8" - 10' MAX
- NE55 1" X 1" 3/8" - 10' MAX
- NE56 1" X 1" 3/8" - 10' MAX
- NE57 1" X 1" 3/8" - 10' MAX
- NE58 1" X 1" 3/8" - 10' MAX
- NE59 1" X 1" 3/8" - 10' MAX
- NE60 1" X 1" 3/8" - 10' MAX
- NE61 1" X 1" 3/8" - 10' MAX
- NE62 1" X 1" 3/8" - 10' MAX
- NE63 1" X 1" 3/8" - 10' MAX
- NE64 1" X 1" 3/8" - 10' MAX
- NE65 1" X 1" 3/8" - 10' MAX
- NE66 1" X 1" 3/8" - 10' MAX
- NE67 1" X 1" 3/8" - 10' MAX
- NE68 1" X 1" 3/8" - 10' MAX
- NE69 1" X 1" 3/8" - 10' MAX
- NE70 1" X 1" 3/8" - 10' MAX
- NE71 1" X 1" 3/8" - 10' MAX
- NE72 1" X 1" 3/8" - 10' MAX
- NE73 1" X 1" 3/8" - 10' MAX
- NE74 1" X 1" 3/8" - 10' MAX
- NE75 1" X 1" 3/8" - 10' MAX
- NE76 1" X 1" 3/8" - 10' MAX
- NE77 1" X 1" 3/8" - 10' MAX
- NE78 1" X 1" 3/8" - 10' MAX
- NE79 1" X 1" 3/8" - 10' MAX
- NE80 1" X 1" 3/8" - 10' MAX
- NE81 1" X 1" 3/8" - 10' MAX
- NE82 1" X 1" 3/8" - 10' MAX
- NE83 1" X 1" 3/8" - 10' MAX
- NE84 1" X 1" 3/8" - 10' MAX
- NE85 1" X 1" 3/8" - 10' MAX
- NE86 1" X 1" 3/8" - 10' MAX
- NE87 1" X 1" 3/8" - 10' MAX
- NE88 1" X 1" 3/8" - 10' MAX
- NE89 1" X 1" 3/8" - 10' MAX
- NE90 1" X 1" 3/8" - 10' MAX
- NE91 1" X 1" 3/8" - 10' MAX
- NE92 1" X 1" 3/8" - 10' MAX
- NE93 1" X 1" 3/8" - 10' MAX
- NE94 1" X 1" 3/8" - 10' MAX
- NE95 1" X 1" 3/8" - 10' MAX
- NE96 1" X 1" 3/8" - 10' MAX
- NE97 1" X 1" 3/8" - 10' MAX
- NE98 1" X 1" 3/8" - 10' MAX
- NE99 1" X 1" 3/8" - 10' MAX
- NE100 1" X 1" 3/8" - 10' MAX

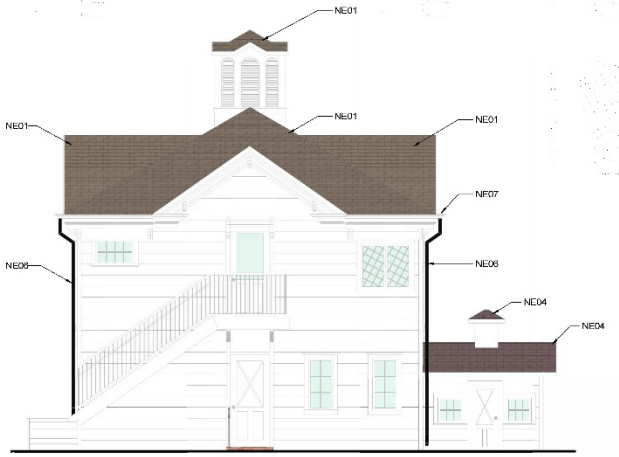

CARRIAGE HOUSE - WEST ELEVATION **C3**
1/4" = 1'-0"

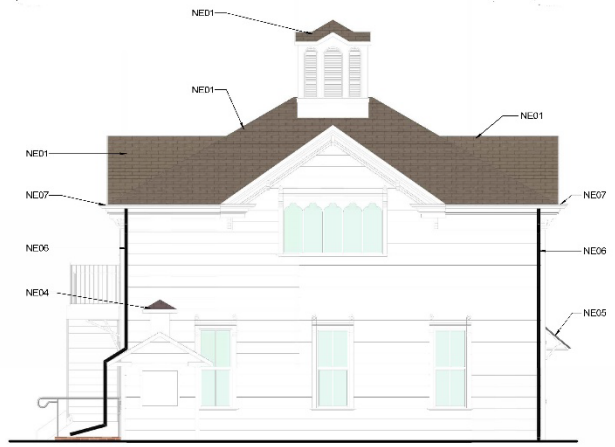

CARRIAGE HOUSE - SOUTH ELEVATION **C1**
1/4" = 1'-0"

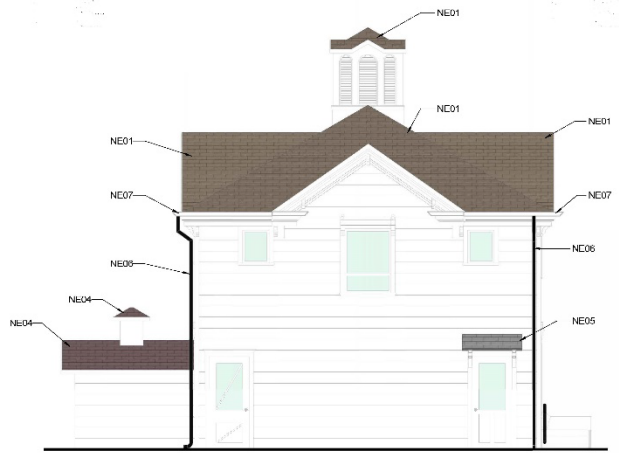

CARRIAGE HOUSE - EAST ELEVATION **A3**
1/4" = 1'-0"



CARRIAGE HOUSE - NORTH ELEVATION **A1**
1/4" = 1'-0"

PROPOSED ROOF MATERIAL



CHRYSLER LEAD
LANDMARK PRO MAX DET.
COLOR: TBC (ORANGE)
TEXT: PER BLNDR OR SIMILAR

Carriage House - proposed



Next Steps:

- Finalize plans and specifications
- Bid administration and contract award
- Construction - Spring 2023

Comments & Questions?