



KAPLAN GEHRING MCCARROLL
ARCHITECTURAL LIGHTING

RECEIVED

By Monet Sheikhali at 11:43 am, May 13, 2022

420 MENDOCINO AVENUE

SANTA ROSA, CA

KGM #22.0084

FIXTURE SCHEDULE
CATALOG CUTS

LIGHTING UPDATE
2022-05-09

420 MENDOCINO AVENUE

LIGHTING FIXTURE SCHEDULE

Contact: **Anne Friedman** / Josuel Lupericio

Telephone: (310) 552-2191

Facsimile: (310) 552-2192

TYPE	MANUFAC TURER	MODEL NUMBER	LAMP	WATT	CONTROL	DESCRIPTION
NOT FOR CONSTRUCTION						
LIGHTING UPDATE						
2022-05-09						
PROJECT VOLTAGE (LIGHTING) TO BE DETERMINED BY E.E.						
F1	LUMINIS	OCULUS - LED LC750-L1L35-R55-VOLT-FINISH BY ARCH.-K3-RG	INTEGRAL LED 3000K 80CRI 3364LM	36	0-10V	RECESSED ADJUSTABLE DOWNLIGHT IN OVERHANG
F2	LUMENPULSE	LUMENFACADE NANO LOGN-7W-48V-12/24/36/48-30K-80-10X10-HFR- UMPN(FIXED MOUNTING NANO)-FINISH BY ARCH.- UCTL-UL + LOGNRD-LENGTH TO MATCH FIXTURE-FINISH TO MATCH FIXTURE(LOUVER)	INTEGRAL LED 3000K 80+CRI 525LM/FT	7 WFT	0-10V	SURFACE MOUNTED LINEAR GRAZING FIXTURE
F3	TARGETTI	ZEDGE MINI HO ZES-HO-RP-FW-FINISH BY ARCH.-L2-30-24 + BACK BOX AND MOUNTING ACCESSORIES BY CONTR. + REMOTE DIMMABLE POWER SUPPLY	INTEGRAL LED 3000K 80CRI 181LM	4	0-10V	RECESSED STEP LIGHT
F4	IGUZZINI	TRICK RAIAL 360° I.BU10-UNV-15(GRAY, ARCH. TO VERIFY) + 4549-0350-019-UNV-ED10(REMOTE POWER SUPPLY)	INTEGRAL LED 3000K 80CRI 250LM	5.7	0-10V	WALL MOUNTED SCONCE, WITH REMOTE POWER SUPPLY
F5	TARGETTI	KEPLERO MINI WALL WASHER KPLM-41-WW-L1-30 + 1DU2525K(BLACK, ARCH. TO VERIFY) + INSTALLATION SLEEVE BY CONTR.	INTEGRAL LED 3000K 80+CRI 231LM/FT	14	0-10V	RECESSED INGRADE UPLIGHT IN PLANTER
F6	OPTIC ARTS	LINELED HE 48 WET TUBE LLHE48WET-T-LO-30K-LENGTH PER DRAWING + KXLC-C(CHANNEL) + REMOTE DIMMABLE POWER SUPPLY	INTEGRAL LED 3000K 90+CRI 231LM/FT	1.9 W/FT	0-10V	SURFACE MOUNTED LINEAR STRIP LIGHT UNDER BENCH, WITH REMOTE POWER SUPPLY
F7	BK	DENALI LED DE-LED-X59-FL-FINISH BY ARCH.-12-11-B + CANOPIES + REMOTE DIMMABLE TRANSFORMER	INTEGRAL LED 3000K 80CRI 692LM	12	MLV	WALL MOUNTED ADJUSTABLE BULLET ACCENT LIGHT, WITH REMOTE TRANSFORMER
F7A	BK	DENALI LED DE-LED-X59-WFL-FINISH BY ARCH.-13-11-B + CANOPIES + REMOTE DIMMABLE TRANSFORMER	INTEGRAL LED 3000K 80CRI 692LM	12	MLV	WALL MOUNTED ADJUSTABLE BULLET FLOOD LIGHT, WITH REMOTE TRANSFORMER
F8	NOT USED					

NOT FOR CONSTRUCTION

LIGHTING UPDATE

F9	BK	DELTA STAR LED DS-LED-E65-NSP-A9-FINISH BY ARCH.-12-11-B-360SL + REMOTE DIMMABLE TRNASFORMER	INTEGRAL LED 3000K 80CRI 466LM	7	MLV	STAKE MOUNTED TREE UPLIGHT, WITH REMOTE TRANSFORMER
F10	BEGA	LED BOLLARD - SYMMETRIC 88 262-K3-FINISH BY ARCH.	INTEGRAL LED 3000K 80+CRI 1577LM	20.6	0-10V	BOLLARD LIGHT
F11	OPTIC ARTS	LINELED HE 48 WET TUBE LLHE48WET-T-SO-30K-LENGTH PER DRAWING + KXLC-F(CHANNEL) + REMOTE DIMMABLE POWER SUPPLY	INTEGRAL LED 3000K 90+CRI 330LM/FT	2.8 W/FT	0-10V	SURFACE MOUNTED LINEAR LIGHT IN PLANTER, WITH REMOTE POWER SUPPLY
F12	ARTEMIDE	TOLOMEO MEGA OUTDOOR FLOOR SPUN WHITE TOU0102	INTEGRAL LED 3000K 90+CRI 1735LM	23	PHASE	OUTDOOR FLOOR LAMP

****Requirements for Substitutions****

At Bid time, the contractor shall submit unit pricing for each specified fixture type. This does not include installation costs. Bids not in the specified format will be rejected. This criteria is in addition to bid instructions found in the general conditions. The following instructions are required for the lighting designer to complete their review of the substitution:

- A. Considerable effort and time has gone into designing and specifying the lighting and the act of substituting packages should not be considered lightly. The lighting design and fixtures have been vetted based on value, performance, size, aesthetics, availability and carefully reviewed and approved by the design team and ownership. Please review carefully the procedures and make sure your requests comply to all items noted. Substitutions will not be allowed unless specifically submitted and approved in accordance with the following provisions.
- B. At bid time, the contractor shall submit unit pricing for each specified fixture type in a matrix format. This shall be for fixture costs only and does not include installation. Bids not in this format are deemed rejected. This criteria is in addition to bid instructions in the general conditions. In the event bids are not submitted per the criteria of the contract documents, the owner can recommend a national distributor. Any increased costs associated with utilizing the national distributor and the specified products shall remain the responsibility of the contractor.
- C. Substitutions shall be considered only if submitted in accordance with Division 01 of the general conditions and criteria noted below. If there is conflicting requirements between sections, the more stringent requirement will govern:
- D. Alternate fixtures must be submitted in a matrix format showing the specified product unit cost, alongside the alternate fixture with its associated cost. This is a document in 8 1/2" x 11" format with manufacturer, model number and unit costs indicated. In a separate document, the associated cut sheets shall be submitted and labeled to indicate fixture number with the specification items neatly highlighted. Basic cutsheets not highlighted are deemed rejected.
- E. The design team can select all or portions of the alternate package, and where the alternates are not selected the "as specified" product shall be provided at the unit prices noted in the matrix.
- F. Alternate fixture specifications shall not be submitted just for the purpose of creating a "package" provided by one representative.
- G. Alternates must be submitted 8 working days prior to final bids being submitted and shall not be included in the project bid, unless they have been pre-accepted as alternates.
- H. Requesting approval of alternates after the bid is submitted or during the submittal review is not permitted. These requests are deemed rejected even without written reply and the as specified products shall be provided at no increased cost to the owner.
- I. Prior to submitting substitutions, the GC shall confirm with the Electrical Engineer that Energy Code calculations or compliance submittals will not require modification and shall submit this in writing to the Electrical Engineer. If this is not received along with the other requested information, no review will take place.
- J. Contractor shall provide photometric studies as required to validate light levels of any proposed substituted fixtures critical to meeting established light level criteria at the discretion of the lighting designer. Calculations to follow these requirements:
 - i. Along with the alternate fixtures- Provide photometrics of the specified fixtures for a side-by-side comparison.
 - ii. Calculation grid shall be 5'x5', with a light loss factor of .9.
 - iii. Reflectance values of architectural finishes shall be confirmed with the Architect. Provide a letter from the architect indicating they have provided finishes for the various spaces.
 - iv. Provide calculations in both PDF and AGI format. Calculations shall clearly identify the space location, room number and floor level.
- K. By KGM rejecting an insufficient submittal will not be deemed a delay by the construction team.
- L. The construction team has had the Contract Documents for considerable time, to suggest a product is not available in a timely manner is not justification for substitutions. Any delay is the result of waiting too long to start the procurement process. Associated delay costs will be the sole responsibility of the construction team.
- M. Substitutions submitted by the GC must comply to all criteria noted above, and accompanied by a check of \$2,500 for the first review. (Payable to KGM Architectural Lighting 270 Coral Circle, EL Segundo CA 90245). It is likely the substitutions will not comply with the design intent and/or not provide adequate value to the Owner. In the event additional reviews are required, an additional check of \$2,500 will be required for each review. Please note, there is a chance the substitution packages will not be approved and no credit will be provided for the review payments.

420 MENDOCINO AVENUE | SANTA ROSA, CA



270 CORAL CIRCLE | EL SEGUNDO, CALIFORNIA 90245 | TEL: 310.552.2191 | FAX: 310.552.2192

TYPE: _____ QUANTITY: _____ PROJECT: _____

CATALOG NUMBER:

FIXTURE SUFFIX REFLECTOR VOLTAGE FINISH OPTION OPTION OPTION

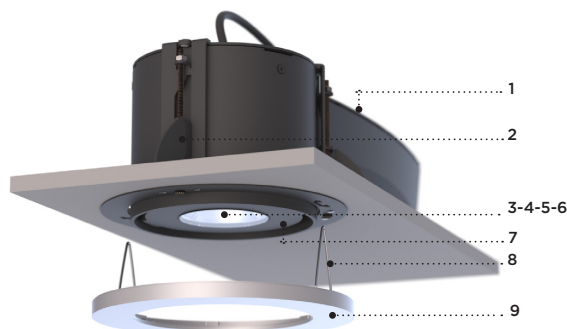

Oculus light module is designed with a tilting mechanism allowing forward and back light adjustability. The $\pm 30^\circ$ directional module allows the light beam to be aimed in the desired direction, without disturbing the luminaire mounting. Standard fully adjustable 360° rotation.

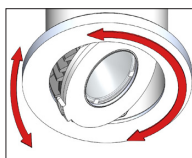

- 1- Driver housing with gasketed service door.
- 2- Fixture secured with three locking tabs.
- 3- Fully sealed cast aluminum light assembly.
- 4- Sealed cast aluminum lens frame.
- 5- Clear tempered glass lens.
- 6- Faceted specular aluminum reflector.
- 7- Light module. Regressed light module available as an option.
- 8- Trim secured by two wire springs inserted in slots in the mounting flange.
- 9- Cast aluminum trim available in multiple colors.

All stainless steel hardware.

OC750



OC750-RG



Shown with regressed option (RG)

MATERIALS

Oculus is made of corrosion resistant 356 aluminum alloy with a copper (CU) content of less than 0.1%.

The main housing is made of seamless extruded aluminum, with an integrally sealed LED light module designed for optimal heat dissipation, and lighting performance.

Oculus is standard with a unique proprietary design allowing the sealed LED module to tilt within the housing.

Oculus OC750 series is standard with 30° optic. See options section for alternate selection.

ELECTRICAL

DRIVER Standard driver is 0-10V dimming-ready (dims to 10%) with: 120-277 multi-volt compatibility (50-60Hz), operating temperature range of -40°C/-40°F to 55°C/131°F, output over voltage protection, output over current protection and output short circuit protection with auto-recovery.

LED Standard 4000K /80CRI. Optional 2700K, 3000K & 3500K. Optional Amber LED for turtle sensitive areas. Wavelengths: 584.5nm to 597nm.

LIFE

60,000hrs $L_{70}B_{50}$ (based on IESNA TM-21 Test Method and LM-80 data). Up to 70,000hrs $L_{70}B_{50}$ (calculated projection from LM-80 data).

FINISH

Five-stage preparation process including preheating of cast aluminum parts for air extraction, and an environmentally friendly alloy sealant. Polyester powder coating is applied through an electrostatic process and oven cured for long term finish.

MOUNTING

Maximum weight: 12.2 lbs (5.5 kg)

Remodeling type fixture designed to fit in a Ø 7.5" (191mm) opening on a ceiling 0.5" (13mm) to 1.5" (38mm) thick.

Three locking tabs secure frame in the ceiling and trim snaps in place.

Locking tabs can be retracted to remove the frame for maintenance. Requires 7" (178mm) clearance in ceiling.

NOTE: Fixture is non-IC rated. For IC, please consult factory.

CERTIFICATION

Tested to UL1598 and CSA 22.2 #250. cULus listed wet location.

Rated IP66 from below and above.

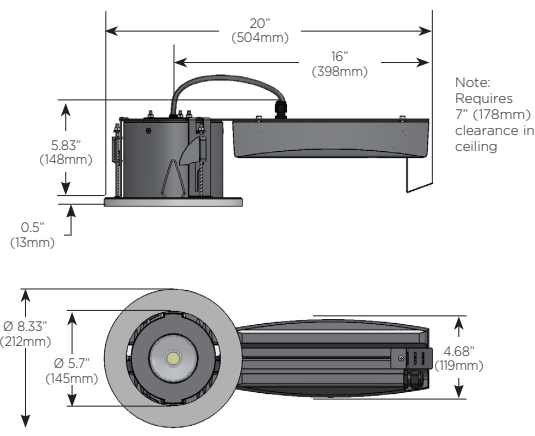

LUMINIS | Toll free: 866.586.4647 Fax: 514.683.8872 Email: info@luminis.com
260 Labrosse, Pointe-Claire (QC) Canada H9R 5L5

LUMINIS.COM

Luminaires may be altered for design improvement or discontinued without prior notice.

Jan. 2021 Rev. 1

OC750 SERIES OCULUS - LED

LUMINAIRE SELECTION

1 MODEL#

 LIGHT MODULE
☐ OC750

2 LED LIGHT SELECTION

SUFFIX	INPUT WATTS	DELIVERED LUMENS	CRI	CCT °K
<input type="checkbox"/> L1L15	14W	1436	80	4000
<input type="checkbox"/> L1L20	20W	1964	80	4000
<input type="checkbox"/> L1L35	36W	3364 ¹	80	4000

AMBER LED IDA - Dark Sky Approved

<input type="checkbox"/> L1L3K2A	11W	263	AMBER	
----------------------------------	-----	-----	-------	--

VERY NARROW DISTRIBUTION

<input type="checkbox"/> L1L15NR	24W	1401	80	4000
----------------------------------	-----	------	----	------

3 REFLECTORS
☐ **R15** Narrow optics 15°
☐ **R30** Flood optics 30° (standard)
☐ **R55** Wide flood optics 52°

☐ **R9** Very narrow optics 9°
 Field angle 18°
 (38,305 candela)

4 VOLTAGE
☐ 120V
☐ 277V
 Optional
☐ 347V

5 FINISH

TRIM & LIGHT MODULE COLOR (select one)

STANDARD COLORS

- ☐ WHT Snow white
- ☐ BKT Jet black
- ☐ BZT Bronze
- ☐ MST Matte silver
- ☐ GRT Titanium gray
- ☐ DGT Gun metal
- ☐ CHT Champagne
- ☐ SGT Steel gray
- ☐ BGT English cream

OPTIONAL COLORS

- ☐ CS Custom color
- ☐ RAL RAL# color

NATATORIUM SUITED COLORS

- ☐ NWH White
- ☐ NBKT Black

OPTIONS (Refer to page 3 for details)

LIGHT & OPTICS
 Alternate CCT °K LED (LCF: Lumen conversion factor)
☐ **K27** 2700K CCT 80 CRI (LCF: 0.91)⁵ IDA - Dark Sky Approved
☐ **K3** 3000K CCT 80 CRI (LCF: 0.94) IDA - Dark Sky Approved
☐ **K35** 3500K CCT 80 CRI (LCF: 0.983)⁵
 NOTE: Other CCT & higher CRI available, please consult factory.

☐ **RG** Regressed light module (light module color is BKT when RG is selected, trim color must still be chosen, not limited to BKT)²

ELECTRICAL
☐ **FS** Fuse
☐ **DMX/RDM** DMX/RDM control dim to dark (0%).⁴
☐ **RD** Remote driver. Consult factory.

ACCESSORIES
☐ **CPB** Concrete pour box
☐ **HL** Hexcell louver
☐ **SL** Solite lens (light loss factor [LLF]: 0.9)
☐ **LSL** Linear spread lens (Asymmetric lens distribution is achieved when light module is tilted)
☐ **GL** Trim glass for water ingress protection in ceiling

EMERGENCY
☐ **REML2-50** 7W remote emergency battery backup for LED, 90 min. Remote mount 50ft - 12" (305) square enclosure with access cover.³

NOTES

- 3130 delivered lumens with GL option.
- Cylindrical housing extended by 1" (25.4mm) for increased cut-off.
- The remote enclosure must be interior.
- Default dimming curve: Logarithmic. Factory set to address one unless otherwise specified. Refer to DMX Reference Guide for more information (available on website).
- K27 and K35 options not available with the R9 optics.

LUMINIS®

LUMINIS | Toll free: 866.586.4647 Fax: 514.683.8872 Email: info@luminis.com
260 Labrosse, Pointe-Claire (QC) Canada H9R 5L5

Luminaires may be altered for design improvement or discontinued without prior notice.

LUMINIS.COM

| 2

Jan. 2021 Rev. 1

420 MENDOCINO AVENUE | SANTA ROSA, CA



RECESSED ADJUSTABLE DOWNLIGHT IN OVERHANG

F1

270 CORAL CIRCLE | EL SEGUNDO, CALIFORNIA 90245 | TEL: 310.552.2191 | FAX: 310.552.2192

OPTIONS

ACCESSORIES

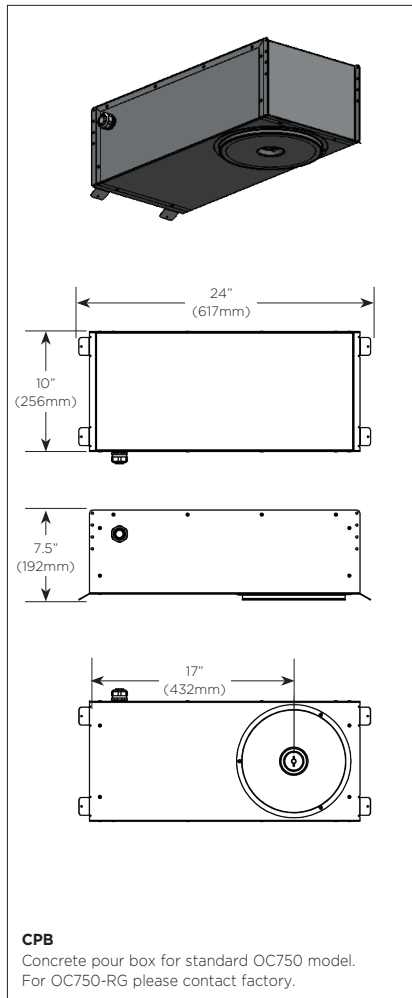

ELECTRICAL

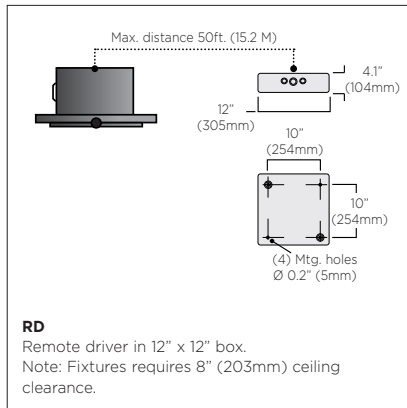

LUMINIS®

LUMINIS | Toll free: 866.586.4647 Fax: 514.683.8872 Email: info@luminis.com
260 Labrosse, Pointe-Claire (QC) Canada H9R 5L5

LUMINIS.COM

Luminaires may be altered for design improvement or discontinued without prior notice.

Jan. 2021 Rev. 1

| 3

420 MENDOCINO AVENUE | SANTA ROSA, CA



RECESSED ADJUSTABLE DOWNLIGHT IN OVERHANG

F1

270 CORAL CIRCLE | EL SEGUNDO, CALIFORNIA 90245 | TEL: 310.552.2191 | FAX: 310.552.2192

TYPICAL PHOTOMETRY SUMMARY

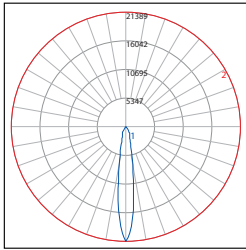

Descriptive Information

OC750-L1L35-R15
Total Lms: 3358 Lumens
Total Input Watts: 36 W
Efficacy: 93 Lumens/Watt
BUG: B3-U0-G0
CCT/CRI: 4000K/80
Maximum Candela: 21389 @ 0 deg

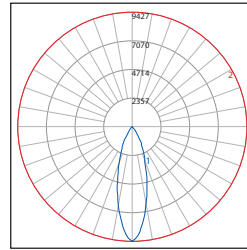

Descriptive Information

OC750-L1L35-R30
Total Lms: 3364 Lumens
Total Input Watts: 36 W
Efficacy: 93 Lumens/Watt
BUG: B3-U0-G0
CCT/CRI: 4000K/80
Maximum Candela: 9427 @ 0 deg

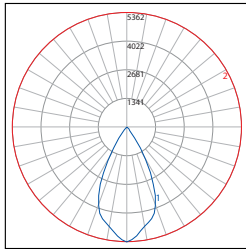

Descriptive Information

OC750-L1L35-R55
Total Lms: 3583 Lumens
Total Input Watts: 36 W
Efficacy: 99 Lumens/Watt
BUG: B3-U0-G0
CCT/CRI: 4000K/80
Maximum Candela: 5362 @ 0 deg

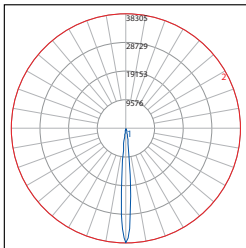

Descriptive Information

OC750-L1L14NR-R9
Total Lms: 1401 Lumens
Total Input Watts: 24 W
Efficacy: 60 Lumens/Watt
BUG: B2-U0-G0
CCT/CRI: 4000K/80
Maximum Candela: 38305 @ 0 deg

Please visit our web site www.luminis.com for complete I.E.S. formatted download data.

LUMINIS

LUMINIS | Toll free: 866.586.4647 Fax: 514.683.8872 Email: info@luminis.com
260 Labrosse, Pointe-Claire (QC) Canada H9R 5L5

LUMINIS.COM

Luminaires may be altered for design improvement or discontinued without prior notice.

Jan. 2021 Rev. 1

4

420 MENDOCINO AVENUE | SANTA ROSA, CA



RECESSED ADJUSTABLE DOWNLIGHT IN OVERHANG

F1

270 CORAL CIRCLE | EL SEGUNDO, CALIFORNIA 90245 | TEL: 310.552.2191 | FAX: 310.552.2192

Specification Sheet

lumenfacade nano

LOGN

WHITE AND STATIC COLORS

Project Name _____ Qty _____

Type _____ Catalog / Part Number _____

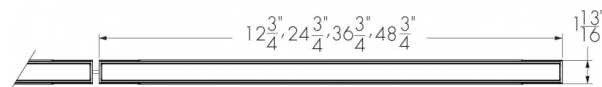

Top view

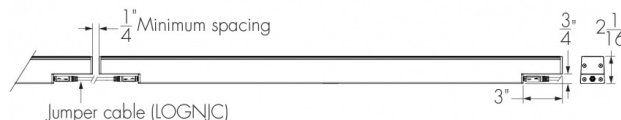

Front and side views

Photometric Summary (7 W/ft)

	Delivered output (lm)	Intensity (peak cd)
8°x8°	2,173	58,720
10°x10°	2,102	45,812
10°x30°	2,038	12,959
10°x60°	2,026	6,911
10°x90°	2,031	3,622
30°x10°	2,043	12,919
30°x30°	2,986	6,894
30°x60°	2,895	4,362
30°x90°	2,917	3,152
60°x10°	2,025	8,019
60°x60°	2,924	2,162
60°x90°	2,905	2,603
90°x90°	2,856	1,766
W (120°)	1,225	602
WW	2,164	10,498

Based on 4000K, CRI 80+, 4ft [1219mm], NO control. Photometric performance is measured in compliance with IESNA LM-79-08.

Optics

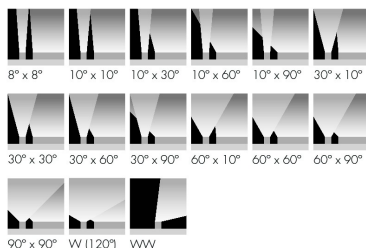

Description

The Lumenfacade Nano White and Static Colors is a high-efficiency linear LED luminaire that goes where no facade lighting has gone before. Available in 12 in, 24 in, 36 in or 48 in sections, the Lumenfacade Nano is the right fit for general urban structures, historical buildings and those hardest to reach places. The Lumenfacade Nano packs all the bells and whistles of the larger members of the Lumenfacade family and can be configured with a wide number of options, including: optics for grazing, floodlighting or wall washing; a choice of outputs; various color temperatures or static colors; various mounting options, finishes, accessories and controls. Now with 3G vibration-rating options, this little fixture can really go anywhere.

Features

Color and Color Temperature	2200K, 2700K, 3000K, 3500K, 4000K, Red, Green, Blue
Optics	8° x 8°, 10° x 10°, 10° x 30°, 10° x 60°, 10° x 90°, 30° x 10°, 30° x 30°, 30° x 60°, 30° x 90°, 60° x 10°, 60° x 60°, 60° x 90°, 90° x 90°, Wide 120°, Asymmetric Wallwash
Options	Corrosion-resistant coating for hostile environments, 3G ANSI C136.31-2010 Vibration Rating for bridge applications
Power Consumption	2 W/ft, 4 W/ft, 7 W/ft
Warranty	5-year limited warranty

Performance

Maximum Delivered Output	884 lm (2 W/ft, 48 in fixture, 4000K CRI 80+, 30° x 30°, NO control), 1,767 lm (4 W/ft, 48 in fixture, 4000K CRI 80+, 30° x 30°, NO control), 2,986 lm (7 W/ft, 48 in fixture, 4000K CRI 80+, 30° x 30°, NO control)
Maximum Delivered Intensity	20,676 cd at nadir (2 W/ft, 48 in fixture, 4000K CRI 80+, 8° x 8°, NO control), 41,352 cd at nadir (4 W/ft, 48 in fixture, 4000K CRI 80+, 8° x 8°, NO control), 58,720 cd at nadir (7 W/ft, 48 in fixture, 4000K CRI 80+, 8° x 8°, NO control)

lumenpulse[™]

1220 Marie-Victorin Blvd., Longueuil, QC J4G 2H9 CA
info@lumenpulse.com www.lumenpulse.com

United States 617.307.5700 | Canada 1.877.937.3003 | 514.937.3003 F 514.937.6289
www.lumenpulse.com/products/1578

LMPG Inc. reserves the right to make changes to this product at any time without prior notice and such modification shall be effective immediately
2022.04.18 copyright © 2022 LMPG Inc.
EM - R10

1 / 15

420 MENDOCINO AVENUE | SANTA ROSA, CA



SURFACE MOUNTED LINEAR GRAZING FIXTURE

F2

270 CORAL CIRCLE | EL SEGUNDO, CALIFORNIA 90245 | TEL: 310.552.2191 | FAX: 310.552.2192

Colors and Color Temperatures

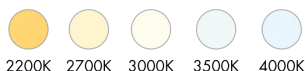

Controls

ON/OFF UCTL

Ratings

IP66 IK08

Certifications



Illuminance at Distance

Minimum 1 fc at 144 ft (2 W/ft, 48 in fixture, 4000K CRI 80+, 8° x 8°, NO control), Minimum 1 fc at 203 ft (4 W/ft, 48 in fixture, 4000K CRI 80+, 8° x 8°, NO control), Minimum 1 fc at 242 ft (7 W/ft, 48 in fixture, 4000K CRI 80+, 8° x 8°, NO control)

Color Consistency

3 SDCM (2 SDCM for 8° x 8°, 10° x 10°, 10° x 30°, 10° x 60°, 10° x 90°, 30° x 10°, 60° x 10°, W and WW optics)

Color Rendering

CRI 80+, CRI 90+ (27K and 30K color temperatures only)

Lumen Maintenance

L70 >90,000 hrs

Physical

Housing Material

Low copper content extruded aluminum

Lens Material

Clear tempered glass

Hardware Material

Stainless steel

End Cap Material

Machined aluminum

Gasket Material

Silicone

Surface Finish

Electrostatically applied polyester powder coat

Weight

1.4 lbs (12 in), 2.9 lbs (24 in), 4.4 lbs (36 in), 6 lbs (48 in)

Electrical and control

Voltage

48 VDC

Resolution (DMX/RDM)

Per fixture, 8-bit or 16-bit

Control

On/Off control, Universal control (compatible with 0-10V, DALI or DMX/RDM systems)

Environmental

Storage Temperature

-40 °F to 185 °F (device must reach start-up temperature value before operating)

Start-up Temperature

-13 °F to 122 °F

Operating Temperature

-40 °F to 122 °F

Ingress Protection Rating

IP66

Impact Resistance Rating

IK08 (IK09 for 48 in fixtures)

Accessories (order separately)

Cables

Lumenfacade Nano Jumper Cable (LOGNJC), Trunk Power Cable (TKPWR), Trunk Data Cable (TKDMX), Lumenfacade Nano Jumper Cable Joiner (LOGNJC-JOINER)

Control Boxes

Low-Voltage Control Box (LCBX), Low-Voltage Splitter Box (LSBX)

Remote Power Supply

Large Power Supply Box (LGPSU)

Optical Accessories

Lumenfacade Nano Radial Louver (LOGNRD), Lumenfacade Nano Visor (LOGNVS)

Control Systems

Lumentone™ 2 (LTN2), Pharos® kit (PHAROS)

Diagnostic and Addressing Tools

LumenID (LID)

lumenpulse™

1220 Marie-Victorin Blvd., Longueuil, QC J4G 2H9 CA
info@lumenpulse.com www.lumenpulse.com

United States 617.307.5700 | Canada 1.877.937.3003 | 514.937.3003
www.lumenpulse.com/products/1578 F 514.937.6289

LMPG Inc. reserves the right to make changes to this product at any time without prior notice and such modification shall be effective immediately
2022.04.18 copyright © 2022 LMPG Inc.
EM - R10

2 / 15

420 MENDOCINO AVENUE | SANTA ROSA, CA



SURFACE MOUNTED LINEAR GRAZING FIXTURE

F2

270 CORAL CIRCLE | EL SEGUNDO, CALIFORNIA 90245 | TEL: 310.552.2191 | FAX: 310.552.2192

Photometric information

2 W/ft (3000K, CRI 80+)

	Delivered output (lm)	Intensity (peak cd)
8°x8°	711	19,229
10°x10°	688	15,002
10°x30°	668	4,244
10°x60°	664	2,264
10°x90°	665	1,187
30°x10°	669	4,231
30°x30°	822	1,897
30°x60°	796	1,201
30°x90°	803	868
60°x10°	663	2,626
60°x60°	804	595
60°x90°	799	716
90°x90°	786	486
W (120°)	401	197
WW	709	3,438

Based on 3000K, CRI 80+, 4 ft, NO control configuration.

2 W/ft (3000K, CRI 90+)

	Delivered output (lm)	Intensity (peak cd)
8°x8°	598	16,152
10°x10°	578	12,602
10°x30°	561	3,565
10°x60°	558	1,901
10°x90°	559	997
30°x10°	562	3,554
30°x30°	691	1,594
30°x60°	669	1,009
30°x90°	674	729
60°x10°	557	2,206
60°x60°	676	500
60°x90°	671	602
90°x90°	660	409
W (120°)	337	166
WW	595	2,888

Based on 3000K, CRI 90+, 4 ft, NO control configuration.

Photometric performance is measured in compliance with IESNA LM 79-08.

4 W/ft (3000K, CRI 80+)

	Delivered output (lm)	Intensity (peak cd)
8°x8°	1,423	38,457
10°x10°	1,376	30,004
10°x30°	1,335	8,487
10°x60°	1,327	4,526
10°x90°	1,330	2,372
30°x10°	1,338	8,461
30°x30°	1,643	3,793
30°x60°	1,593	2,400
30°x90°	1,605	1,734
60°x10°	1,326	5,252
60°x60°	1,609	1,189
60°x90°	1,599	1,432
90°x90°	1,572	972
W (120°)	803	394
WW	1,417	6,875

Based on 3000K, CRI 80+, 4 ft, NO control configuration.

4 W/ft (3000K, CRI 90+)

	Delivered output (lm)	Intensity (peak cd)
8°x8°	1,195	32,304
10°x10°	1,156	25,203
10°x30°	1,121	7,129
10°x60°	1,115	3,802
10°x90°	1,117	1,993
30°x10°	1,124	7,107
30°x30°	1,380	3,187
30°x60°	1,338	2,016
30°x90°	1,348	1,457
60°x10°	1,114	4,411
60°x60°	1,351	999
60°x90°	1,343	1,203
90°x90°	1,320	816
W (120°)	674	331
WW	1,191	5,775

Based on 3000K, CRI 90+, 4 ft, NO control configuration.

7 W/ft (3000K, CRI 80+)

	Delivered output (lm)	Intensity (peak cd)
8°x8°	2,021	54,610
10°x10°	1,955	42,605
10°x30°	1,895	12,052
10°x60°	1,884	6,427
10°x90°	1,889	3,368
30°x10°	1,900	12,015
30°x30°	2,777	6,411
30°x60°	2,692	4,057
30°x90°	2,713	2,931
60°x10°	1,883	7,458
60°x60°	2,719	2,011
60°x90°	2,702	2,421
90°x90°	2,656	1,642
W (120°)	1,139	560
WW	2,013	9,763

Based on 3000K, CRI 80+, 4 ft, NO control configuration.

7 W/ft (3000K, CRI 90+)

	Delivered output (lm)	Intensity (peak cd)
8°x8°	1,698	45,872
10°x10°	1,642	35,788
10°x30°	1,592	10,124
10°x60°	1,583	5,399
10°x90°	1,587	2,830
30°x10°	1,596	10,092
30°x30°	2,333	5,386
30°x60°	2,262	3,408
30°x90°	2,279	2,462
60°x10°	1,582	6,264
60°x60°	2,284	1,689
60°x90°	2,269	2,033
90°x90°	2,231	1,380
W (120°)	957	470
WW	1,691	8,201

Based on 3000K, CRI 90+, 4 ft, NO control configuration.

lumenpulse™

1220 Marie-Victorin Blvd., Longueuil, QC J4G 2H9 CA
info@lumenpulse.com www.lumenpulse.com

T United States 617.307.5700 | Canada 1.877.937.3003 | 514.937.3003
www.lumenpulse.com/products/1578

F 514.937.6289

LMPG Inc. reserves the right to make changes to this product at any time without prior notice and such modification shall be effective immediately
2022.04.18 copyright © 2022 LMPG Inc.
EM - R10

3 / 15

420 MENDOCINO AVENUE | SANTA ROSA, CA



SURFACE MOUNTED LINEAR GRAZING FIXTURE

F2

270 CORAL CIRCLE | EL SEGUNDO, CALIFORNIA 90245 | TEL: 310.552.2191 | FAX: 310.552.2192

Chromaticity Data

TM-30 - 4000K

CCT	CIE	TM-30
4000K	R_a 83	R_t 85
	R_s 14	R_b 96

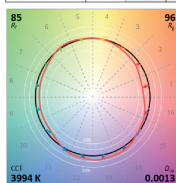

Spectral Power Distribution

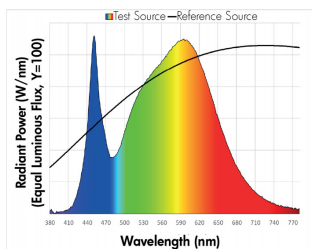

Optical option installation details

HFR - Half-frosted lens



Top view



Front view

- Always position frosted side toward the wall.
- Applicable for 8° x 8°, 10° x 10° or asymmetric wallwash optics only.

WW - Asymmetric wallwash

Recommended setback from wall is 1/10 of the wall height.

Example: 2 ft setback for a 20 ft wall.

Mounting options

One mounting bracket provided for 12 in fixtures. Two mounting brackets provided for 24 in, 36 in and 48 in fixtures. See installation instructions for details.

SAMN - Slim Adjustable Mounting Nano

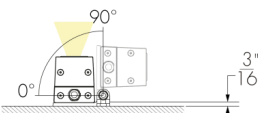

UMPN - Fixed Mounting Nano



SAMN - Mounting hole pattern

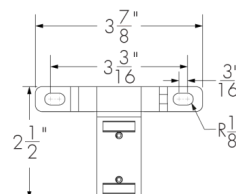

UMPN - Mounting hole pattern

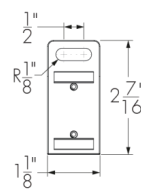

lumenpulse™

1220 Marie-Victorin Blvd., Longueuil, QC J4G 2H9 CA
info@lumenpulse.com www.lumenpulse.com

T United States 617.307.5700 | Canada 1.877.937.3003 | 514.937.3003 F 514.937.6289
www.lumenpulse.com/products/1578

LMPG Inc. reserves the right to make changes to this product at any time without prior notice and such modification shall be effective immediately
2022.04.18 copyright © 2022 LMPG Inc.
EM - R10

4 / 15

420 MENDOCINO AVENUE | SANTA ROSA, CA



SURFACE MOUNTED LINEAR GRAZING FIXTURE

F2

270 CORAL CIRCLE | EL SEGUNDO, CALIFORNIA 90245 | TEL: 310.552.2191 | FAX: 310.552.2192

UMASN - Universal Adjustable Mounting Nano

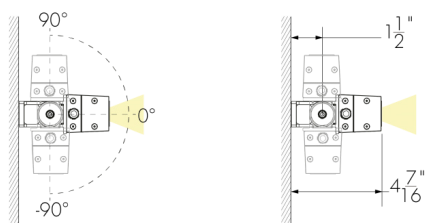

UMASN - Mounting hole pattern

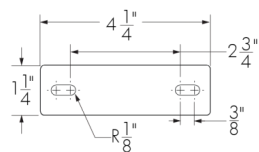

For 1 ft fixtures

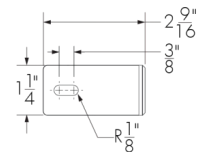

For 2 ft, 3 ft and 4 ft fixtures

WAMN2 - Adjustable Extended Arm Mounting Nano 2 in

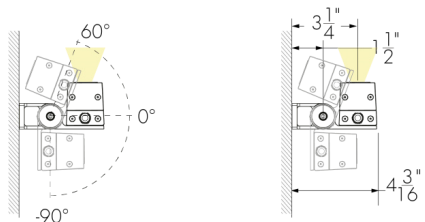

WAMN2 - Mounting hole pattern

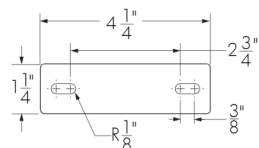

For 1 ft fixtures

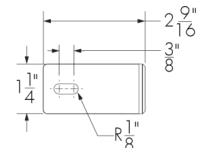

For 2 ft, 3 ft and 4 ft fixtures

WAMN6 - Adjustable Extended Arm Mounting Nano 6 in

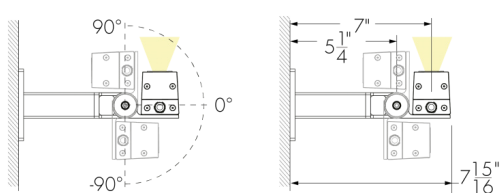

WAMN6 - Mounting hole pattern

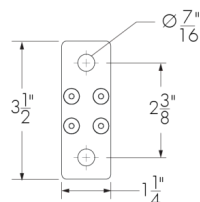

WAMN12 - Adjustable Extended Arm Mounting Nano 12 in

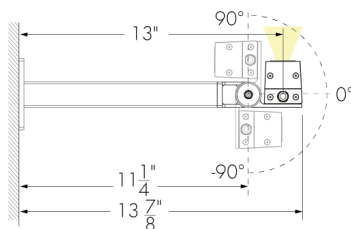

WAMN12 - Mounting hole pattern

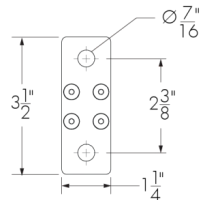

WAMN18 - Adjustable Extended Arm Mounting Nano 18 in

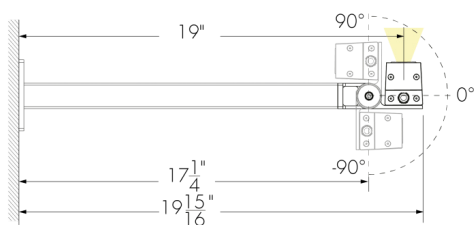

WAMN18 - Mounting hole pattern

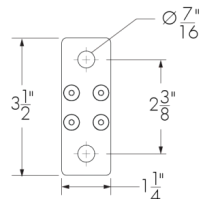

lumenpulse™

1220 Marie-Victorin Blvd., Longueuil, QC J4G 2H9 CA
info@lumenpulse.com www.lumenpulse.com

T United States 617.307.5700 | Canada 1.877.937.3003 | 514.937.3003 F 514.937.6289
www.lumenpulse.com/products/1578

LMPG Inc. reserves the right to make changes to this product at any time without prior notice and such modification shall be effective immediately
2022.04.18 copyright © 2022 LMPG Inc.
EM - R10

5 / 15

420 MENDOCINO AVENUE | SANTA ROSA, CA



SURFACE MOUNTED LINEAR GRAZING FIXTURE

F2

270 CORAL CIRCLE | EL SEGUNDO, CALIFORNIA 90245 | TEL: 310.552.2191 | FAX: 310.552.2192

WAMN28 - Adjustable Extended Arm Mounting Nano 28 in

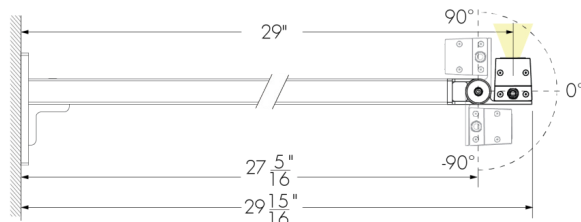

WAMN28 - Mounting hole pattern

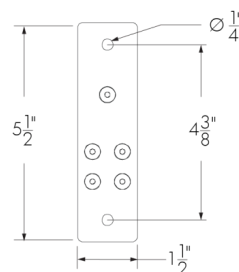

Mounting bracket placement (minimum and maximum distances)

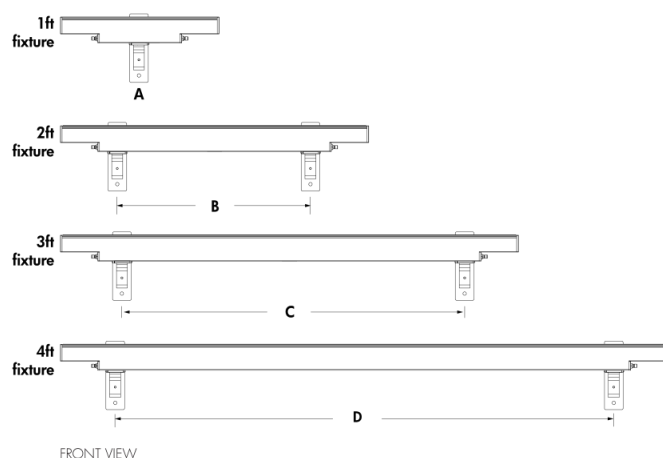

- A - Bracket in the center of the fixture
 - B - Minimum 14 in to maximum 16 in
 - C - Minimum 26 in to maximum 28 in
 - D - Minimum 38 1/2 in to maximum 40 1/2 in
- LOGN with bracket WAMN28 shown

The mounting bracket(s) to be centered on fixture and as symmetrical as possible. Distances must be respected for all installations.

lumenpulse™

1220 Marie-Victorin Blvd., Longueuil, QC J4G 2H9 CA
info@lumenpulse.com www.lumenpulse.com

T United States 617.307.5700 | Canada 1.877.937.3003 | 514.937.3003 F 514.937.6289
www.lumenpulse.com/products/1578

LMPG Inc. reserves the right to make changes to this product at any time without prior notice and such modification shall be effective immediately
2022.04.18 copyright © 2022 LMPG Inc.
EM - R10

6 / 15

420 MENDOCINO AVENUE | SANTA ROSA, CA



SURFACE MOUNTED LINEAR GRAZING FIXTURE

F2

270 CORAL CIRCLE | EL SEGUNDO, CALIFORNIA 90245 | TEL: 310.552.2191 | FAX: 310.552.2192

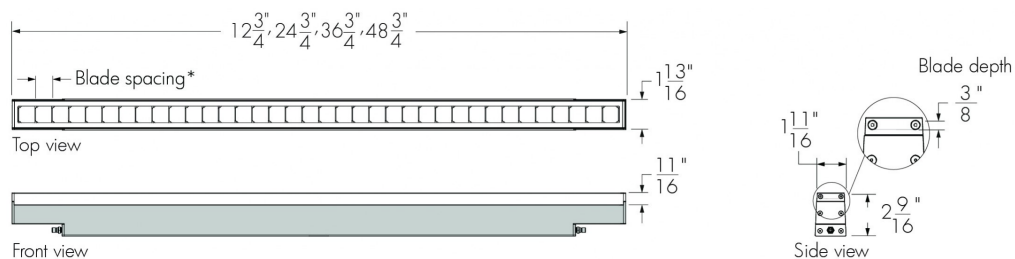
Optical accessories (order separately)**LOGNRD - Radial louver for Lumenfacade Nano**

*15/16 in blade spacing for 8° x 8°, 10° x 10°, 10° x 30°, 10° x 60°, 10° x 90°, 30° x 10° and 60° x 10° optics.

*1 15/16 in blade spacing for 30° x 30°, 30° x 60°, 30° x 90°, 60° x 60°, 60° x 90° and 90° x 90° optics.

LOGNRD-LENGTH-FINISH-OPTIONS

Please specify:

LENGTH: 12 in, 24 in, 36 in or 48 in; **FINISH:** BK - Black Sandtex®, BRZ - Bronze Sandtex®, SI - Silver Sandtex®, WH - Smooth white or CC - custom color and finish (please specify RAL color); **OPTIONS:** CRC - Corrosion-resistant coating for hostile environments

- The addition of a louver will affect beam distribution. Consult factory for application support.
- Not suitable for wide 120° and asymmetric wallwash optics.
- Maximum one accessory per fixture. Louvers are field installable.

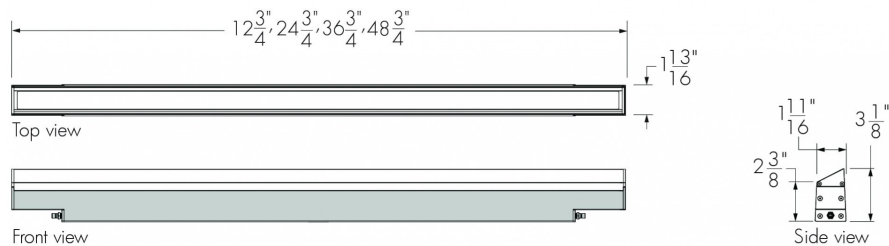
LOGNVS - Visor for Lumenfacade Nano**LOGNVS-LENGTH-FINISH-OPTIONS**

Please specify:

LENGTH: 12 in, 24 in, 36 in or 48 in; **FINISH:** BK - Black Sandtex®, BRZ - Bronze Sandtex®, SI - Silver Sandtex®, WH - Smooth white or CC - custom color and finish (please specify RAL color); **OPTIONS:** CRC - Corrosion-resistant coating for hostile environments

- The addition of a visor will affect beam distribution. Consult factory for application support.
- Not suitable for wide 120° optic.
- Maximum one accessory per fixture. Visors are field installable.

lumenpulse™

1220 Marie-Victorin Blvd., Longueuil, QC J4G 2H9 CA
info@lumenpulse.com www.lumenpulse.com

T United States 617.307.5700 | Canada 1.877.937.3003 | 514.937.3003 F 514.937.6289
www.lumenpulse.com/products/1578

LMPG Inc. reserves the right to make changes to this product at any time without prior notice and such modification shall be effective immediately
2022.04.18 copyright © 2022 LMPG Inc.
EM - R10

7 / 15

420 MENDOCINO AVENUE | SANTA ROSA, CA



SURFACE MOUNTED LINEAR GRAZING FIXTURE

F2

270 CORAL CIRCLE | EL SEGUNDO, CALIFORNIA 90245 | TEL: 310.552.2191 | FAX: 310.552.2192

Cables (order separately)**LOGNJIC - Jumper cable for Lumenfacade Nano**

Front view

4" Minimum bend radius for jumper cable

For minimal spacing between fixtures, use a 1 ft jumper cable.

LOGNJIC-CERTIFICATION-LENGTH-CABLE COLOR

Please specify:

CERTIFICATION: UL or CE; **LENGTH:** 1 ft to 30 ft (available in 1 ft increments) or 50 ft; **CABLE COLOR:** black or white (connectors are the same color as the specified cable color).

- Suitable for dimming/data and non-dimming applications.
- Consult Lumenfacade Nano jumper cable specification sheet for all available cable lengths and additional information.

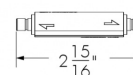
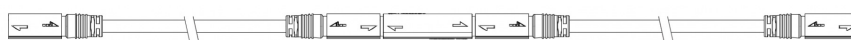
Joiner (order separately)**LOGNJIC-JOINER - Joiner for Lumenfacade Nano Jumper Cable**

- Use joiners to connect and lengthen jumper cables.
- Joiners add voltage drops. Consult factory to confirm impact on run length.
- Available in black.

Resolution details**DMX/RDM control, resolution per fixture: each fixture is addressed independently****DMX addresses:**

UCTL control option

- 48 in fixtures shown.
- Applicable for UCTL control only. A DMX/RDM enabled LCBX or LSBX is required for DMX/RDM control

lumenpulse™1220 Marie-Victorin Blvd., Longueuil, QC J4G 2H9 CA
info@lumenpulse.com www.lumenpulse.comT United States 617.307.5700 | Canada 1.877.937.3003 | 514.937.3003 F 514.937.6289
www.lumenpulse.com/products/1578LMPG Inc. reserves the right to make changes to this product at any time without prior notice and such modification shall be effective immediately
2022.04.18 copyright © 2022 LMPG Inc.
EM - R10

8 / 15

420 MENDOCINO AVENUE | SANTA ROSA, CA

SURFACE MOUNTED LINEAR GRAZING FIXTURE

F2

270 CORAL CIRCLE | EL SEGUNDO, CALIFORNIA 90245 | TEL: 310.552.2191 | FAX: 310.552.2192

Typical wiring diagrams

On/Off Control (NO)

Single unit - LCBX 60W



- A - Power input (120-277V, wiring by others)
- B - LCBX (60W)
- C - Jumper cable (LOGNJC)
- D - Lumenfacade Nano
- E - Terminator cap

Continuous run - LCBX 60W or 120W



- A - Power input (120-277V, wiring by others)
- B - LCBX (60W or 120W)
- C - Jumper cable (LOGNJC)
- D - Lumenfacade Nano
- E - Terminator cap

Continuous run - LCBX 200W

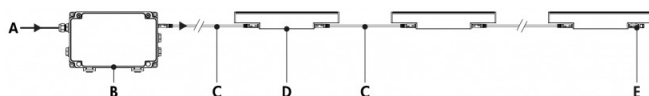

- A - Power input (120-277V, wiring by others)
- B - LCBX (200W)
- C - Jumper cable (LOGNJC)
- D - Lumenfacade Nano
- E - Terminator cap

- Consult factory for specific applications and maximum fixture count/run length recommendations.
- Maximum of 1 output to fixture, or fixture run, per LCBX.
- Consult the LCBX specification sheet for more information.
- 2W version: 2 W/ft; 4W version: 4 W/ft; 7W version: 7 W/ft.

Trunk system - LSBX

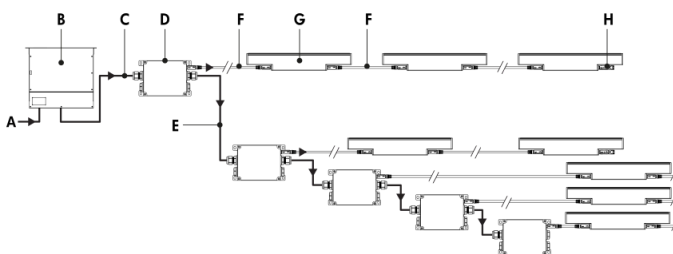

- A - Power input (120-277V, wiring by others)
- B - Large Power Supply (LGPSU) (order separately from Lumenpulse)
- C - Power input (48V, order separately from Lumenpulse - Trunk Power Cable (TKPWR), or equivalent by others. Refer to LSBX specification sheet for details)
- D - LSBX
- E - Power output to next LSBX (48V, order separately from Lumenpulse - Trunk Power Cable (TKPWR), or equivalent by others. Refer to LSBX specification sheet for details)
- F - Jumper cable (LOGNJC)
- G - Lumenfacade Nano
- H - Terminator cap

- Consult factory for specific applications and maximum fixture count/run length recommendations.
- Maximum of 1 output to fixture run per LSBX.
- The LSBX has a maximum of 200W for output to fixtures. Consult the LSBX specification sheet for more information.
- The Large Power Supply (LGPSU) has a maximum of 1000W (120V) or 1200W (277V). Consult LGPSU specification sheet for more information.
- 2W version: 2 W/ft; 4W version: 4 W/ft; 7W version: 7 W/ft.

lumenpulse™

1220 Marie-Victorin Blvd., Longueuil, QC J4G 2H9 CA
info@lumenpulse.com www.lumenpulse.com

T United States 617.307.5700 | Canada 1.877.937.3003 | 514.937.3003 F 514.937.6289
www.lumenpulse.com/products/1578

LMPG Inc. reserves the right to make changes to this product at any time without prior notice and such modification shall be effective immediately
2022.04.18 copyright © 2022 LMPG Inc.
EM - R10

9 / 15

420 MENDOCINO AVENUE | SANTA ROSA, CA



SURFACE MOUNTED LINEAR GRAZING FIXTURE

F2

270 CORAL CIRCLE | EL SEGUNDO, CALIFORNIA 90245 | TEL: 310.552.2191 | FAX: 310.552.2192

UCTL - Universal control

Single unit - LCBX 60W

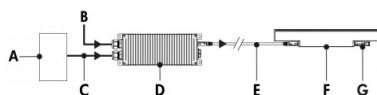

- A - Dimmer/controller (order separately from Lumenpulse, or by others)
- B - Power input (120-277V, wiring by others)
- C - Data input (wiring by others)
- D - LCBX (60W)
- E - Jumper cable (LOGNJC)
- F - Lumenfacade Nano
- G - Terminator cap

Continuous run - LCBX 60W or 120W

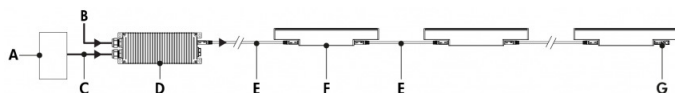

- A - Dimmer/controller (order separately from Lumenpulse, or by others)
- B - Power input (120-277V, wiring by others)
- C - Data input (wiring by others)
- D - LCBX (60W or 120W)
- E - Jumper cable (LOGNJC)
- F - Lumenfacade Nano
- G - Terminator cap

Continuous run - LCBX 200W

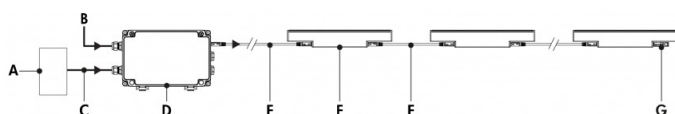

- A - Dimmer/controller (order separately from Lumenpulse, or by others)
- B - Power input (120-277V, wiring by others)
- C - Data input (wiring by others)
- D - LCBX (200W)
- E - Jumper cable (LOGNJC)
- F - Lumenfacade Nano
- G - Terminator cap

Continuous run - Daisy chain
LCBX 60W or 120W

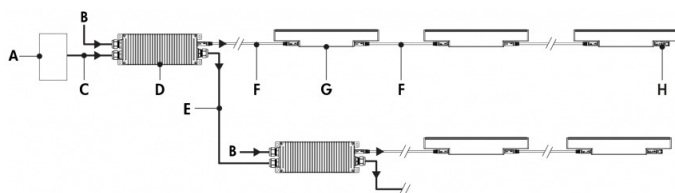

- A - Dimmer/controller (order separately from Lumenpulse, or by others)
- B - Power input (120-277V, wiring by others)
- C - Data input (wiring by others)
- D - LCBX (60W or 120W)
- E - Data output to next LCBX (wiring by others)
- F - Jumper cable (LOGNJC)
- G - Lumenfacade Nano
- H - Terminator cap

Continuous run - Daisy chain
LCBX 200W

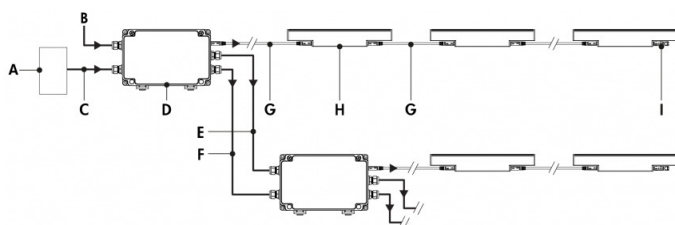

- A - Dimmer/controller (order separately from Lumenpulse, or by others)
- B - Power input (120-277V, wiring by others)
- C - Data input (wiring by others)
- D - LCBX (200W)
- E - Power output to next LCBX (120-277V, wiring by others)
- F - Data output to next LCBX (wiring by others)
- G - Jumper cable (LOGNJC)
- H - Lumenfacade Nano
- I - Terminator cap

lumenpulse™

1220 Marie-Victorin Blvd., Longueuil, QC J4G 2H9 CA
info@lumenpulse.com www.lumenpulse.com

T United States 617.307.5700 | Canada 1.877.937.3003 | 514.937.3003 F 514.937.6289
www.lumenpulse.com/products/1578

LMPG Inc. reserves the right to make changes to this product at any time without prior notice and such modification shall be effective immediately
2022.04.18 copyright © 2022 LMPG Inc.
EM - R10

10 / 15

420 MENDOCINO AVENUE | SANTA ROSA, CA



SURFACE MOUNTED LINEAR GRAZING FIXTURE

F2

270 CORAL CIRCLE | EL SEGUNDO, CALIFORNIA 90245 | TEL: 310.552.2191 | FAX: 310.552.2192

Maximum Run of Fixtures - Lumenfacade Nano® LOGN White & Static Colors

10ft Jumper Cable			
Wattage	2W/ft	4W/ft	7W/ft
Maximum Run of Fixtures per LCBX 60W	26ft	13ft	7ft
Maximum Run of Fixtures per LCBX 120W	52ft	25ft	15ft
Maximum Run of Fixtures per LCBX 200W	88ft*	45ft	25ft
25ft Jumper Cable			
Wattage	2W/ft	4W/ft	7W/ft
Maximum Run of Fixtures per LCBX 60W	26ft	13ft	7ft
Maximum Run of Fixtures per LCBX 120W	52ft	25ft	15ft
Maximum Run of Fixtures per LCBX 200W	88ft*	45ft	25ft
50ft Jumper Cable			
Wattage	2W/ft	4W/ft	7W/ft
Maximum Run of Fixtures per LCBX 60W	26ft	13ft	7ft
Maximum Run of Fixtures per LCBX 120W	52ft	25ft	15ft
Maximum Run of Fixtures per LCBX 200W	88ft*	45ft	25ft

*Example: 2W/ft = 88ft maximum run of end to end fixtures per LCBX 200W.
 (22 fixtures maximum for 4ft LOGN 2W/ft, 88 fixtures maximum for 1ft LOGN 2W/ft).
 Consult factory for system validation prior to quoting and ordering.

- Consult factory for specific applications and maximum fixture count/run length recommendations.
- Maximum of 1 output to fixture, or fixture run, per LCBX.
- Consult the LCBX specification sheet for more information.
- UCTL can be controlled via a 0-10V dimmer, DALI controller or DMX/RDM controller.
- For 0-10V dimming applications:
 - 0-10V mA ratings: Current Sink Mode: 25µA per LCBX; Current Source Mode: 2.5mA per LCBX.
- For DALI applications:
 - A maximum of 64 DALI fixtures per DALI loop.
- For DMX/RDM applications:
 - Each fixture requires 1 DMX channel.
- 1% minimum dimming value.
- 2W version: 2 W/ft; 4W version: 4 W/ft; 7W version: 7 W/ft.

lumenpulse™

1220 Marie-Victorin Blvd., Longueuil, QC J4G 2H9 CA
 info@lumenpulse.com www.lumenpulse.com

T United States 617.307.5700 | Canada 1.877.937.3003 | 514.937.3003 F 514.937.6289
www.lumenpulse.com/products/1578

LMPG Inc. reserves the right to make changes to this product at any time without prior notice and such modification shall be effective immediately
 2022.04.18 copyright © 2022 LMPG Inc.
 EM - R10

11 / 15

420 MENDOCINO AVENUE | SANTA ROSA, CA



SURFACE MOUNTED LINEAR GRAZING FIXTURE

F2

270 CORAL CIRCLE | EL SEGUNDO, CALIFORNIA 90245 | TEL: 310.552.2191 | FAX: 310.552.2192

Trunk system - LSBX

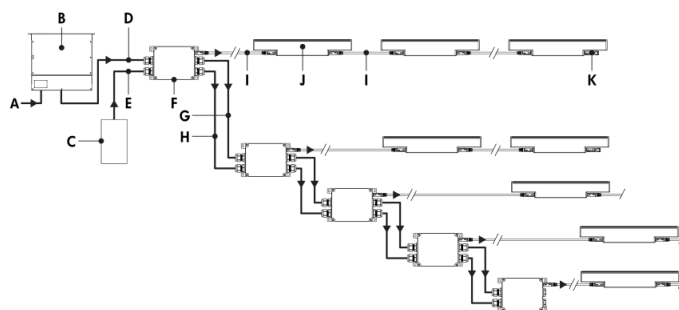

- A** - Power input (120-277V, wiring by others)
- B** - Large Power supply (LGPSU) (order separately from Lumenpulse)
- C** - Controller (order separately from Lumenpulse, or by others)
- D** - Power input (48V, order separately from Lumenpulse - Trunk Power Cable (TKPWR), or equivalent by others. Refer to LSBX specification sheet for details)
- E** - Data input (order separately from Lumenpulse - Trunk Data Cable (TKDMX), or equivalent by others. Refer to LSBX specification sheet for details)
- F** - LSBX
- G** - Power output to next LSBX (48V, order separately from Lumenpulse - Trunk Power Cable (TKPWR), or equivalent by others. Refer to LSBX specification sheet for details)
- H** - Data output to next LSBX (order separately from Lumenpulse - Trunk Data Cable (TKDMX), or equivalent by others. Refer to LSBX specification sheet for details)
- I** - Jumper cable (LOGNJC)
- J** - Lumenfacade Nano
- K** - Terminator cap

- Consult factory for specific applications and maximum fixture count/run length recommendations.
- Maximum of 1 output to fixture run per LSBX.
- The LSBX has a maximum of 200W for output to fixtures. Consult the LSBX specification sheet for more information.
- The Large Power Supply (LGPSU) has a maximum of 1000W (120V) or 1200W (277V). Consult LGPSU specification sheet for more information.
- Each fixture requires 1 DMX channel.
- 1% minimum dimming value.
- 2W version: 2 W/ft; 4W version: 4 W/ft; 7W version: 7 W/ft.

Control boxes (order separately)

LCBX - Low-Voltage Control Box

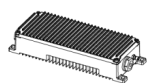

LCBX 60W & 120W

Low-voltage control and power box. One power and data output to fixture, or fixture run. Refer to LCBX specification sheet for details.

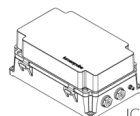

LCBX 200W

LSBX - Low-Voltage Splitter Box



Low-voltage control and power splitter box. One power and data output to fixture run. Refer to LSBX specification sheet for details.

Remote Power Supply (order separately)

LGPSU - Large Power Supply

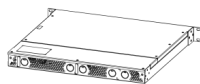

Monté sur rack

Indoor rack-mounted 1.2KW power supply allows for scalable DMX/RDM controlled Lumenfacade Nano systems. Wall Mount version coming soon, consult factory for details.

lumenpulse™

1220 Marie-Victorin Blvd., Longueuil, QC J4G 2H9 CA
info@lumenpulse.com www.lumenpulse.com

T United States 617.307.5700 | Canada 1.877.937.3003 | 514.937.3003 F 514.937.6289
www.lumenpulse.com/products/1578

LMPG Inc. reserves the right to make changes to this product at any time without prior notice and such modification shall be effective immediately
2022.04.18 copyright © 2022 LMPG Inc.
EM - R10

12 / 15

420 MENDOCINO AVENUE | SANTA ROSA, CA



SURFACE MOUNTED LINEAR GRAZING FIXTURE

F2

270 CORAL CIRCLE | EL SEGUNDO, CALIFORNIA 90245 | TEL: 310.552.2191 | FAX: 310.552.2192

Control systems (order separately)

LTN2 - Lumentone™ 2



Lumentone 2 is a simple pre-programmed DMX 512 controller with a push button rotary dial and live feedback.

PHAROS - Pharos® kit



The Pharos kit, available for 1 or 2 DMX universes, allows for complete control of large lighting installations. 2 DMX universes kit shown.

Diagnostic and addressing tools (order separately)

LID - LumenID



LumenID is a diagnostic and addressing DMX/RDM tool. It must be specified on all DMX applications. Consult LID specification sheet for details.

lumenpulse™

1220 Marie-Victorin Blvd., Longueuil, QC J4G 2H9 CA
info@lumenpulse.com www.lumenpulse.com

T United States 617.307.5700 | Canada 1.877.937.3003 | 514.937.3003 F 514.937.6289
www.lumenpulse.com/products/1578

LMPG Inc. reserves the right to make changes to this product at any time without prior notice and such modification shall be effective immediately
2022.04.18 copyright © 2022 LMPG Inc.
EM - R10

13 / 15

420 MENDOCINO AVENUE | SANTA ROSA, CA



SURFACE MOUNTED LINEAR GRAZING FIXTURE

F2

270 CORAL CIRCLE | EL SEGUNDO, CALIFORNIA 90245 | TEL:310.552.2191 | FAX:310.552.2192

How to order

Housing	Wattage	Voltage	Length	Color and Color Temperature ⁽²⁾	Color Rendering ⁽⁴⁾
LOGN Lumenfacade™ Nano	2W 2 W/ft ⁽¹⁾ 4W 4 W/ft 7W 7 W/ft	48V 48 VDC	12 12 3/4 in (1.4 lbs) 24 24 3/4 in (2.9 lbs) 36 36 3/4 in (4.4 lbs) 48 48 3/4 in (6 lbs)	22K 2200K 27K 2700K 30K 3000K 35K 3500K 40K 4000K RD Red ⁽³⁾ GR Green ⁽³⁾ BL Blue ⁽³⁾	80 CRI 80+ 90 CRI 90+ ⁽⁵⁾

Notes:

1. Not available for static red, green or blue color options.
 2. Consult factory for availability of static Royal Blue, and 6500K.
 3. Static colors made to order 8-10 weeks.

4. Not applicable to static red, green or blue color options.
 5. Available for 27K and 30K color temperatures only.

lumenpulse™

1220 Marie-Victorin Blvd., Longueuil, QC J4G 2H9 CA
 info@lumenpulse.com www.lumenpulse.com

T United States 617.307.5700 | Canada 1.877.937.3003 | 514.937.3003 F 514.937.6289
www.lumenpulse.com/products/1578

LMPG Inc. reserves the right to make changes to this product at any time without prior notice and such modification shall be effective immediately
 2022.04.18 copyright © 2022 LMPG Inc.
 EM - R10

14 / 15

420 MENDOCINO AVENUE | SANTA ROSA, CA



SURFACE MOUNTED LINEAR GRAZING FIXTURE

F2

270 CORAL CIRCLE | EL SEGUNDO, CALIFORNIA 90245 | TEL: 310.552.2191 | FAX: 310.552.2192

How to order

Optics	Lens	Mounting Options ⁽¹¹⁾ (12)	Finish	Control ⁽¹⁴⁾	Options	Certification
8x8 8° x 8° 10x10 10° x 10° 10x30 10° x 30° 10x60 10° x 60° 10x90 10° x 90° 30x10 30° x 10° 30x30 30° x 30° 30x60 30° x 60° 30x90 30° x 90° 60x10 60° x 10° 60x60 60° x 60° 60x90 60° x 90° 90x90 90° x 90° W Wide 120° ⁽⁴⁾ WW Asymmetric Wallwash ⁽⁷⁾	CL Clear lens ⁽⁸⁾ FR Frosted lens ⁽⁹⁾ HFR Half-frosted lens ⁽¹⁰⁾	SAMN Slim Adjustable Mounting Nano UMPN Fixed Mounting Nano UMASN Universal Adjustable Mounting Nano WAMN2 Adjustable Wall Mounting Nano 2 in WAMN6 Adjustable Extended Arm Mounting Nano 6 in WAMN12 Adjustable Extended Arm Mounting Nano 12 in WAMN18 Adjustable Extended Arm Mounting Nano 18 in WAMN28 Adjustable Extended Arm Mounting Nano 28 in	BK Black Sandtex® BRZ Bronze Sandtex® SI Silver Sandtex® WH Smooth white CC Custom color and finish (please specify RAL color) ⁽¹³⁾ (14) (15)	NO On/Off control UCTL Universal control (compatible with 0-10V, DALI or DMX/RDM systems)	CRC Corrosion-resistant coating for hostile environments ⁽¹⁷⁾ (18) 3GV 3G ANSI C136.31-2010 Vibration Rating for bridge applications ⁽¹⁹⁾	UL UL compliant CE CE compliant

Notes:

4. Not compatible with louver or visor optical accessories.

7. Not compatible with louver optical accessory.

8. Not available for 8x8, 10x10, W or WW optics.

9. Not available for WW optic.

10. Available for 8x8, 10x10 or WW optics only.

11. One mounting bracket provided for 12 in fixtures. Two mounting brackets provided for 24 in, 36 in and 48 in fixtures.

12. Refer to Mounting Bracket Placement section in the specification sheet for mounting bracket distances that must be respected.

13. Lumenpulse offers a wide selection of RAL CLASSIC (K7) colors with a smooth texture and high-gloss finish. Please consult factory for a list of available K7 colors, other RAL textures and glosses, or to match alternate color charts. Final color matching results may vary.

14. Setup charges apply for RAL colors. Consult factory for details.

15. Longer lead times can be expected for custom RAL color finishes.

16. A Low-Voltage Control Box (LCBX) or Low-Voltage Splitter Box (LSBX) and LumenID (LID) must be specified.

17. Use only when exposed to salt spray. This option is not required for normal outdoor exposure.

18. Setup charges apply. Consult factory for details.

19. Not available for SAMN mounting option. Mounting bracket distances that must be respected, consult Mounting Bracket Placement section in the specification sheet for details.

lumenpulse™

1220 Marie-Victorin Blvd., Longueuil, QC J4G 2H9 CA
info@lumenpulse.com www.lumenpulse.com

T United States 617.307.5700 | Canada 1.877.937.3003 | 514.937.3003 F 514.937.6289
www.lumenpulse.com/products/1578

LMPG Inc. reserves the right to make changes to this product at any time without prior notice and such modification shall be effective immediately
2022.04.18 copyright © 2022 LMPG Inc.
EM - R10

15 / 15

420 MENDOCINO AVENUE | SANTA ROSA, CA



SURFACE MOUNTED LINEAR GRAZING FIXTURE

F2

270 CORAL CIRCLE | EL SEGUNDO, CALIFORNIA 90245 | TEL: 310.552.2191 | FAX: 310.552.2192

ZEDGE MINI HO

Professional Small Scale High Efficiency LED Steplight

Concept: Recessed high efficiency LED steplight for indoor and outdoor applications. A high output steplight version of the classic Zedge Floor Wall wash fixture for applications with higher illumination requirements.

Housing: Small 2.5" x 2.5" Floor Washer faceplate.

Materials: Die-cast anodized aluminum body fitted with a spring fixing system. Powder coated die-cast anodized aluminum external frame. ^AConsult factory for use in marine grade environments.

Source: LED High Efficiency Board.

Optic: Polycarbonate clear lens.

Mounting: To be completed with installation back box. Fixture secured with stainless steel spring system for semi-flush installation only.

Installation: Pre-cabled with 3' Belden 18ga 2 conductor direct burial cable (no conduit required).

Finish: Textured Standard Finishes – Ferrite Grey / Heritage Brown / Bronze RAL 8019 / White / Black / Sandstone Grey

Power Supply: Remote Class 2, 120V-277VAC power supply required, see remote driver option pages.

Wattage: 4W

Color Temperature: 2700K / 3000K / 3500K / 4000K

CRI: +Ra90

Delivered Lumens: *Values in White Textured Finish*

2700K	3000K	3500K	4000K
171Lm	181Lm	186Lm	187Lm

Lumen Maintenance (L80/B10): 56,000hrs tq +25°C

Calculation for LED fixtures are based on measurements that comply with IES LM-80.

Voltage: 24V DC

IK Rating: IK10

IP Rating: IP66

BUG: B0-U1-G0

Certifications: UL Listed Class 2 wet location E479873

Low voltage landscape lighting. Tested in accordance with LM-79-08

Energy efficient for California installations.

Warranty: 5 year limited warranty

Designed in collaboration with Gensler as Product Design Consultant

^AConsult factory for use in marine grade environments. Not to be in direct contact with salt for extended periods of time or used with corrosive agents.



Shown in Sandstone Grey Finish



Suitable for indoor and outdoor applications

PRODUCT CODE	TYPE	DRIVER	FACEPLATE	FINISH	WATTAGE	COLOR TEMP	VOLTAGE	+	INSTALLATION & POWER SUPPLY
ZES – ZEDGE	HO– High Output	RP – Remote Power	FW– Floor Washer	FE – Ferrite Grey	L2 – 4W	27 – 2700K	24 – 24V DC		Required (See page)
				HB – Heritage Brown		30 – 3000K			
				BZ – Bronze RAL8019		35 – 3500K			
				WT – White Textured		40 – 4000K			
				BT – Black Textured					
				SG – Sandstone Grey					

Views

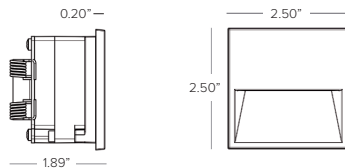

INSTALLATION (REQUIRED) - CHOOSE 1	
1US3166-B	PVC installation back box for semi-fush installations fitted for parallel connection with feed through-wiring, black finish. 1/2" knockout made for low voltage cable (no conduit required, class 2 wiring). Suitable for drywall or stucco applications. Dimensions: 2¾"D x 2¼"H x 3¼"W
1US3166	Stainless steel installation back box for semi-fush installations fitted for parallel connection with feed through-wiring. 3/8" and 1/2" grommet made for low voltage cable (no conduit required, class 2 wiring). Suitable for concrete pour outdoor/harsh environment applications. Dimensions: 2¾"D x 2¼"H x 3¼"W
1USMK01	Mud kit for drywall or stucco. For retrofit or Class 2 installations. Dimensions: 4.25" x 4.25"

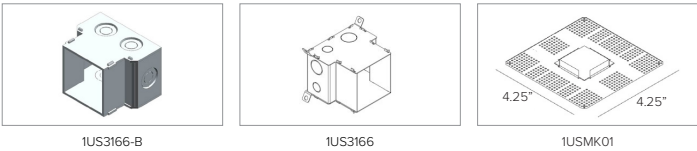

Wiring Diagram

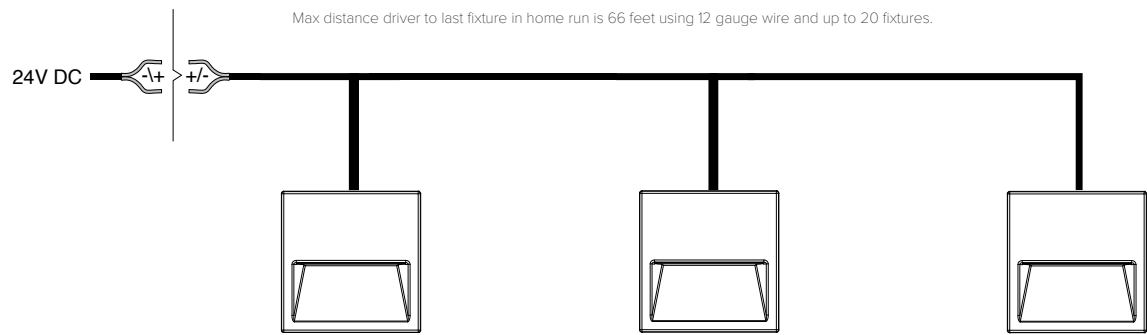

Maximum Cable Distances

No. Fixtures	Load	18 AWG	16 AWG	14 AWG	12 AWG
1-4 Fixtures	≤16W	72ft	115ft	180ft	290ft
5-8 Fixtures	≤32W	42ft	67ft	106ft	165ft
9-12 Fixtures	≤48W	28ft	44ft	70ft	112ft
13-16 Fixtures	≤54W	20ft	33ft	52ft	84ft
17-20 Fixtures	≤80W	16ft	26ft	41ft	66ft

*Voltage drop calculations are based on 3% max drop to last fixture in run for load and distances below

Power Supply (REQUIRED)	Type	Wattage	Input/Output Voltage	Dimmable	IP Rating	Output	Dimensions
DMLE301242UD	EMCOD MLE ELECTRONIC UNIVERSAL DIMMING DRIVER WITH WIRING COMPARTMENT.	30W	120-277V / 24V	MLV <5% / ELV <20% / 0-10V <10% / TRIAC <5%	NEMA3R ENCLOSURE	UL CLASS 2	4.47" X 6.79" X 1.38"
DMLE601242UD	EMCOD MLE ELECTRONIC UNIVERSAL DIMMING DRIVER WITH WIRING COMPARTMENT.	60W	120-277V / 24V	MLV <5% / ELV <20% / 0-10V <10% / TRIAC <5%	NEMA3R ENCLOSURE	UL CLASS 2	4.47" X 6.79" X 1.38"
DMLE961242UD	EMCOD MLE ELECTRONIC UNIVERSAL DIMMING DRIVER WITH WIRING COMPARTMENT.	96W	120-277V / 24V	MLV <5% / ELV <20% / 0-10V <10% / TRIAC <5%	NEMA3R ENCLOSURE	UL CLASS 2	5.16" X 7.73" X 1.54"
DMLE1922242UD	EMCOD MLE ELECTRONIC UNIVERSAL DIMMING DRIVER WITH WIRING COMPARTMENT.	2X96W	120-277V / 24V	MLV <5% / ELV <20% / 0-10V <10% / TRIAC <5%	NEMA3R ENCLOSURE	UL CLASS 2	5.04" X 10.94" X 1.81"
DMLE2882242UD	EMCOD MLE ELECTRONIC UNIVERSAL DIMMING DRIVER WITH WIRING COMPARTMENT.	3X96W	120-277V / 24V	MLV <5% / ELV <20% / 0-10V <10% / TRIAC <5%	NEMA3R ENCLOSURE	UL CLASS 2	5.04" X 10.94" X 1.81"
DEL60PWM	MEANWELL ELECTRONIC STANDALONE PWM DRIVER, UL LISTED ENCLOSURE PROVIDED BY OTHERS.	60W	120-277V / 24V	0-10V <10%	IP67	UR CLASS 2	5.9" X 2.09" X 1.38"
DEL90PWM	MEANWELL ELECTRONIC STANDALONE PWM DRIVER, UL LISTED ENCLOSURE PROVIDED BY OTHERS.	90W	120-277V / 24V	0-10V <10%	IP67	UR CLASS 2	6.73" X 2.48" X 1.48"
DELX601241CPWM	MEANWELL ELECTRONIC PWM DRIVER.	60W	120-277V / 24V	0-10V <10%	IP67 DRIVER IN NEMA3R ENCLOSURE	UL CLASS 2	10" x 10" x 4" ¹
DELX901241CPWM	MEANWELL ELECTRONIC PWM DRIVER.	90W	120-277V / 24V	0-10V <10%	IP67 DRIVER IN NEMA3R ENCLOSURE	UL CLASS 2	10" x 10" x 4" ¹
DELX1802242CPWM	MEANWELL ELECTRONIC PWM DRIVER.	2X90W	120-277V / 24V	0-10V <10%	IP67 DRIVER IN NEMA3R ENCLOSURE	UL CLASS 2	12" x 12" x 4" ¹
DELX2703243CPWM	MEANWELL ELECTRONIC PWM DRIVER.	3X90W	120-277V / 24V	0-10V <10%	IP67 DRIVER IN NEMA3R ENCLOSURE	UL CLASS 2	12" x 12" x 4" ¹
PS060	LUTRON HI-LUME PREMIER 0.1% CONSTANT VOLTAGE DRIVER WITH UL LISTED ENCLOSURE	96W	UNIVERSAL 120-277 VAC	HI-LUME ECOSYSTEM 0.1%	IP20/NOM CERTIFIED	UL CLASS 2	10.5" x 5.5" x 2" ¹

¹ Dimensions include enclosure with mounting bracket.

* Constant voltage drivers 50/60HZ, voltage regulated with short circuit protection. Operating temperature -40 C- 80° C

* Installation of power supply must be compliant to Class 2 installation standards. Refer to NEC and local building code requirements.

* Consult factory for additional driver options (ie: DMX, DALI, wattage, size, shape, Lutron, ELDO, or others).

Max Fixtures Per Driver

Fixture Wattage	Driver Wattage									
		30W	40W	60W	96W	90W	2X90W	3X90W	192W	288W
	4W	6	8	12	20	18	2X18	2X18	2X20	3X20

Photometry

FLOOR WASHER

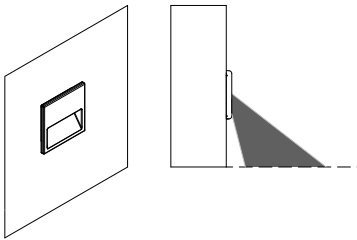
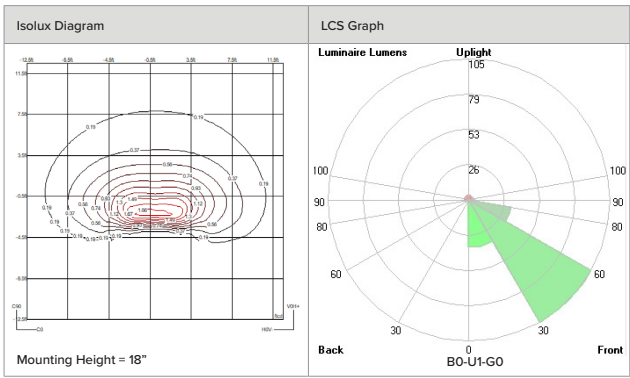

Project name:

Type:



Surface mounted luminaire with 360° radial optic that emphasizes spaces with highly concentrated lines of light. Design by Dean Skira

Luminaire characteristics:

Input load: 6W

Lumens: 250lm

Luminaire efficacy: 41lm/W

Source: LED module, (LM-80 tested)
3000K: 80CRI

Lumen maintenance: >80% of initial lumens at 50 000 hours (L80),(LM-79 tested)

Optics: 360° radial effect

Mounting: Wall or ceiling mounted, installs on standard 4" junction box. Floor mounting in dry location only (interior).

Material:

Body: Die-cast aluminum

Diffuser: PMMA lens

Hardware: Stainless steel screws

Electrical: Integral high efficiency electronic power supply, rated at 50 000 hours, 120-277V or see remote power supply options on page 3.

Finish: White RAL9016 or Gray RAL9007 painted finish with a high level of weather and UV resistance. The semi-gloss finish coating is electrostatically applied, durable acrylic enamel baked at high temperatures for superior color retentive finish. Chrome finish available for indoor use only.

Weight: 0.6lb (0.27kg)

Contact temperature: Less than 50°C (122°F)

Warranty: 5 year limited warranty

Certification: cULus listed for wet location

Ratings: IP66, IK07

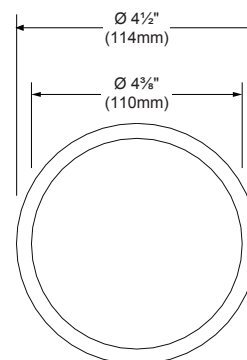
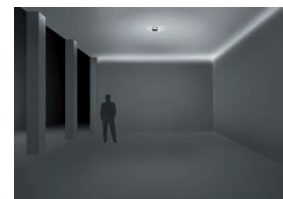
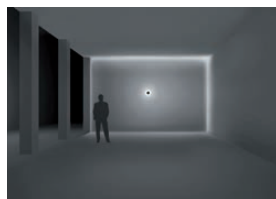

FRONT VIEW

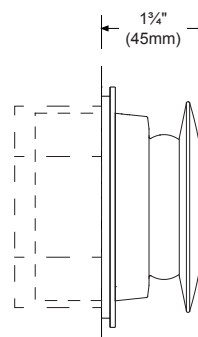

SIDE VIEW

DUE TO CONTINUOUS IMPROVEMENTS, THE INFORMATION HEREIN MAY BE CHANGED WITHOUT NOTICE.

LAST UPDATE: JUNE 13, 2018

JP - R10

iGuzzini
NORTH AMERICA



9320 Boul. St-Laurent, suite 100, Montréal (Québec) Canada H2N 1N7
P.: 514.523.1339 F.: 514.525.6107 www.iguzzini.com/us

420 MENDOCINO AVENUE | SANTA ROSA, CA



WALL MOUNTED SCONCE, WITH REMOTE POWER SUPPLY

F4

270 CORAL CIRCLE | EL SEGUNDO, CALIFORNIA 90245 | TEL: 310.552.2191 | FAX: 310.552.2192

Project name: _____

Type: _____

TECHNICAL DATA

Visit iguzzini.com/us for complete photometric data.

LOAD (W)	CCT (K)	CRI	OPTIC	LUMENS (lm)	EFFICACY (lm / w)	MAX CANDELA (cd)	MODEL
6W	3000K	80	360° radial effect	250	41	145	I.BU10

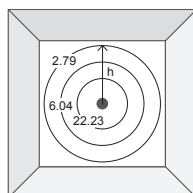
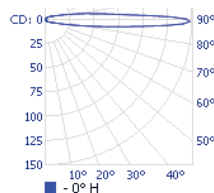

Distance (h)	Illuminance
3.3'	22.23 fc
6.5'	6.04 fc
9.8'	2.79 fc



ACCESSORIES (TO BE ORDERED SEPARATELY)

- ☐ **I.X021** - 3 Trick bits Ø 3/8" (9mm)
H: 1" (25mm)



- ☐ **I.X022** - 3 Trick bits Ø 1/2" (13mm)
H: 1" (25mm)



DUE TO CONTINUOUS IMPROVEMENTS, THE INFORMATION HEREIN MAY BE CHANGED WITHOUT NOTICE.

LAST UPDATE: JUNE 13, 2018

JP - R10

iGuzzini
NORTH AMERICA



9320 Boul. St-Laurent, suite 100, Montréal (Québec) Canada H2N 1N7
P.: 514.523.1339 F.: 514.525.6107 www.iguzzini.com/us

420 MENDOCINO AVENUE | SANTA ROSA, CA



WALL MOUNTED SCNCE, WITH REMOTE POWER SUPPLY

F4

270 CORAL CIRCLE | EL SEGUNDO, CALIFORNIA 90245 | TEL: 310.552.2191 | FAX: 310.552.2192

Project name:

Type:

ORDERING INFO

RESET

I.BU10

MODEL

VOLTAGE

FINISH

MODEL



I.BU10

VOLTAGE



UNV - 120-277V



REM - Remote

FINISH



01 - White



04 - Chrome*



15 - Gray

* Available only for indoor use

REMOTE POWER SUPPLY OPTION

REMOTE POWER SUPPLY OPTION (TO BE ORDERED SEPARATELY)

Requirement for one (1) fixture: 5.7W, 350mA (for remote fixture only)



4549-0350-019-UNV-ED10



4549-0350-018-UNV-TE

**REMOTE POWER SUPPLY OPTION
(TO BE ORDERED SEPARATELY)**

Watts	Min-Max QTY	Voltage	Rated	Dimming protocol	Box dimensions	Max distance at full load (18AWG)	Code
19	1-2	120-277V	Outdoor	0-10V ELDOLED ECOdrive	14" X 5" X 3" (356 X 127 X 76mm)	72ft (22m)	4549-0350-019-UNV-ED10
18	1-2	120V	Outdoor	Trailing edge (ELV)	14" X 5" X 3" (356 X 127 X 76mm)	72ft (22m)	4549-0350-018-UNV-TE

WIRING DIAGRAMS

*Multiple luminaires must be connected in series (home run or fixture chain)

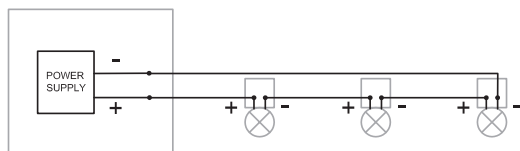
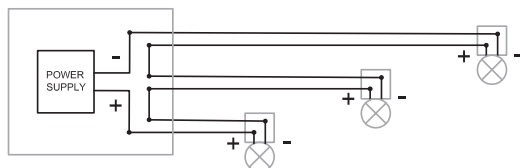

DUE TO CONTINUOUS IMPROVEMENTS, THE INFORMATION HEREIN MAY BE CHANGED WITHOUT NOTICE.

LAST UPDATE: JUNE 13, 2018

JP - R10

iGuzzini
NORTH AMERICA



9320 Boul. St-Laurent, suite 100, Montréal (Québec) Canada H2N 1N7
P.: 514.523.1339 F.: 514.525.6107 www.iguzzini.com/us

420 MENDOCINO AVENUE | SANTA ROSA, CA



WALL MOUNTED SCNCE, WITH REMOTE POWER SUPPLY

F4

270 CORAL CIRCLE | EL SEGUNDO, CALIFORNIA 90245 | TEL: 310.552.2191 | FAX: 310.552.2192

KEPLERO MINI WALL WASHER

Professional Inground LED Fixture

Concept: Single COB LED inground wall washer.
Housing: 8" tall x 6.625" diameter die-cast aluminum housing.
Materials: Anodized and powder coated black die-cast aluminum heat sink body. PVC installation sleeve and stainless steel (AISI316L) trim ring with extra clear glass. ^ABody completed with marine grade cathaphoresis suitable for use in marine grade environments. Stainless steel trim will need to be maintained and cleaned regularly to avoid mineral deposits.
Trim: Stainless steel (AISI316L) trim available in ultra flat round or square decorative rings, with beveled edge in brushed natural, bronze or black finishes. Features tamper-proof Torx screws.
Optic: Wall Wash 84° x 34° optical unit includes acrylic lens, a high reflectance asymmetrical anodized aluminum reflector and integral holographic filter for even illumination of vertical surfaces as well as excellent light diffusion at ground level. This unique reflector system allows the Keplero Wall Wash fixtures to be installed at an unparalleled 1:6 ratio for completely uniform illumination on the vertical surface. Range of motion: +/- 15° optic rotation on the vertical axis and rotates 360° on the horizontal plane with integrated locking system.
Mounting: Flush and semi-flush installation sleeves or optional raised installation tube for landscape. Fixture includes screw down holes and stainless steel screws for attachment to installation sleeve. Includes optional stainless steel L brackets for support mounting. installation sleeve (required) for flush or semi-flush mounting.
Driver: Integrated 4/1 driver (Non-dimmable / 0-10V / Reverse Phase / Forward Phase).
Installation: Fixture flush mount installation includes 8" tall x 6.625" diameter sleeve, extension pipe for wire slack and accessibility. Pre-cabled with 4ft IP68 connector cable, direct burial brass ingrade j-box (required, sold separately).
Wattage: 14W
Color Temperature: 2700K / 3000K / 3500K / 4000K
CRI: Ra84
Lumen Maintenance (L70): 50,000hrs
Calculation for LED fixtures are based on measurements that comply with IES LM-80.
Voltage: Universal Voltage 120-277V AC 50/60Hz
IK Rating: IK10
IP Rating: IP67*, IP68 Tested**
Load Rating: Resistant to static loads up to 4,496lbs in flush mounted cement and pavement installations.
Certifications: cULus Wet Listed E477426
Tested in accordance with LM-79-08
Energy efficient for California installations.
Warranty: 5 year limited warranty
* Up to 1 METER DEPTH of water for up to a maximum of 30 MINUTES
** Not suitable for submersible installations
^ANot to be in direct contact with salt for extended periods of time or used with corrosive agents.



KEPLERO® MINI Wall Washer with Clear Lens





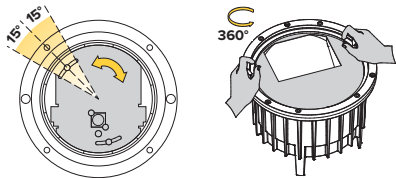

Delivered Lumens:	3000K	4000K
Wall Wash =	933Lm	957Lm

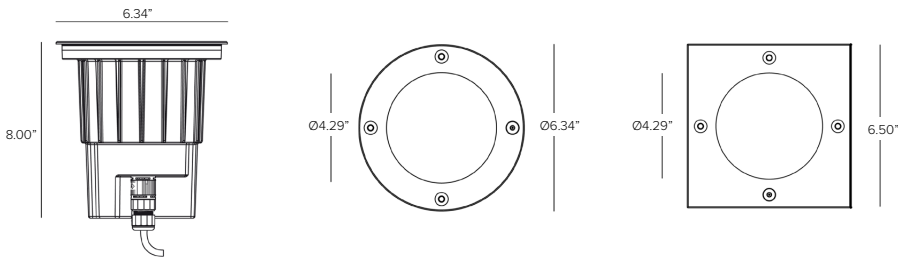

PRODUCT CODE	DRIVER	TYPE	WATTAGE	COLOR TEMP	+	TRIM & INSTALLATION
KPLM – KEPLERO Mini	41 — 4/1 Dimming (Non-Dimming / 0-10V / Reverse Phase / Forward Phase)	WW — Wall Wash	L1 — 14W	27 — 2700K 30 — 3000K 35 — 3500K 40 — 4000K		Required (See Pg 2)

Views



TRIM RING (REQUIRED) - CHOOSE 1			
Round Trim Ring (Available in Brushed Natural, Bronze, and Black PVD finishes)			
			Description
			
1E2525	1DU2525B	1DU2525K	Round stainless steel (AISI316L) decorative ring. 10mm thick extra clear protective glass. Silicone gasket. Tamper proof (AISI316L) Torx screws.
1DU2525A	1DU2525BA	1DU2525KA	Round stainless steel (AISI316L) decorative ring with anti-slip glass. 10mm thick extra clear protective glass. Silicone gasket. Tamper proof (AISI316L) Torx screws.
Square Trim Ring (Available in Brushed Natural Stainless Steel finish) ¹			
	Description		
1E2526	Square stainless steel (AISI316L) decorative ring. 10mm thick extra clear protective glass. Silicone gasket. Tamper proof (AISI316L) Torx screws.		
1DU2526A	Square stainless steel (AISI316L) decorative ring with anti-slip glass. 10mm thick extra clear protective glass. Silicone gasket. Tamper proof (AISI316L) Torx screws.		

¹Square trim available in Bronze and Black finish upon request. Consult factory.



Round Trim Ring



Square Trim Ring

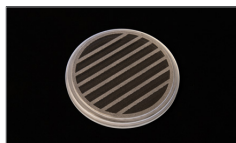

Anti-Slip Glass

INSTALLATION SLEEVE (REQUIRED) - CHOOSE 1	
1DU2521	Installation sleeve for concrete pour applications. Grey Nylon 8" casing with 10" PVC installation outer pipe. Round ring for flush or semi-flush installations.
1DU2522	Installation sleeve for concrete pour applications. Grey Nylon 8" casing and stainless steel profile with 10" PVC installation outer pipe. Square ring for flush installation only. For use with square trim options only.
1DU4344	Raised installation sleeve for landscape applications. 36"H stainless steel painted deep black finish, includes 8" inner sleeve. To be used with round trim options. (Field cuttable. Used for fixture elevation 21" above ground). Not suitable with 1DU2521 and 1DU2522.
1DU434418	Raised installation sleeve for ground cover (succulents and low level planting) applications. 18"H stainless steel painted deep black finish, includes 8" inner sleeve. To be used with round trim options. (Field cuttable. Used for fixture elevation 7" above ground). Not suitable with 1DU2521 and 1DU2522.
1DU434412	At grade or raised installation sleeve for turf or ground cover applications. 12"H stainless steel painted deep black finish, includes 8" inner sleeve. To be used with round trim options. (Field cuttable. Used for fixture elevations at grade to 3" above grade). Not suitable with 1DU2521 and 1DU2522.

INSTALLATION ACCESSORIES:	
1DU2530	Direct burial brass ingrade j-box. Features stainless steel cover screws and strain relief for power cord, (2) 3/4" NPT bottom holes and (2) 3/4" NPT side holes. Includes (4) 3/4" to 1/2" adaptors and (2) 1/2" NPT plugs. (REQUIRED)
1E2495	Anti-vandal torx head. Suggested one per 5 fixture.
1E2524	Fixture metal maintenance removal handle. Helpful one per 10 fixtures.
1E0388	Glass suction removal tool. Helpful one per 20 fixtures.



1DU2521

1DU2522



1DU2530



1E2495



1E2524



1E0388

INSTALLATION DIAGRAM - Concrete Pour Applications



Flush Mount Sleeve Assembly
1DU2521 and 1DU2522 Sleeves

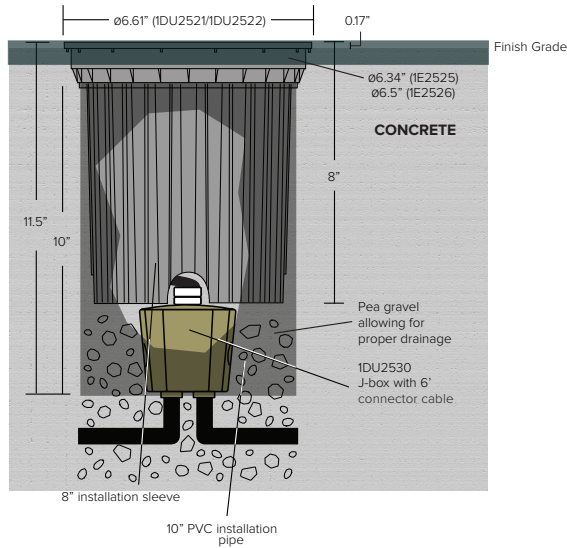

Semi-Flush Mount Sleeve Assembly
1DU2521 Sleeve Only

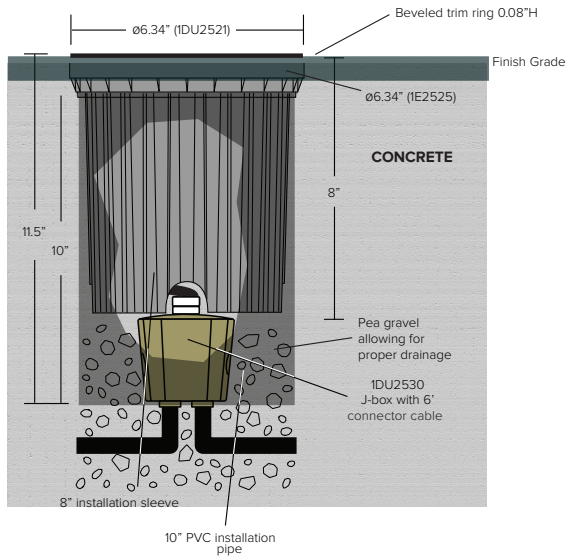

INSTALLATION DIAGRAM - Landscape Applications

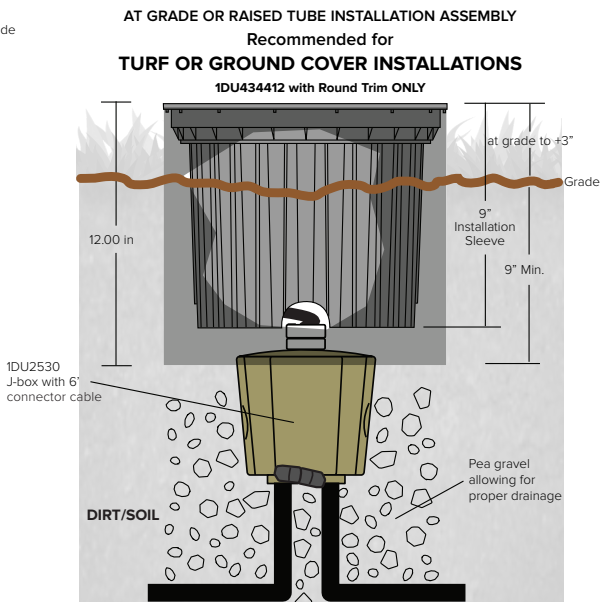
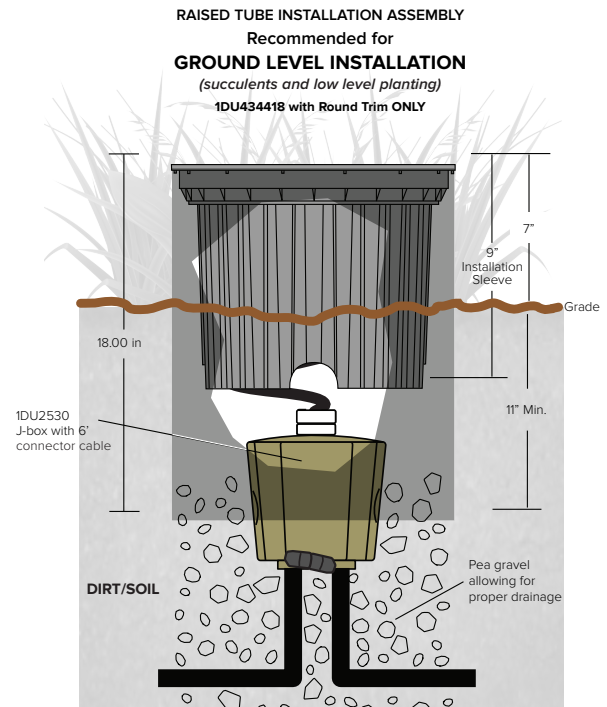
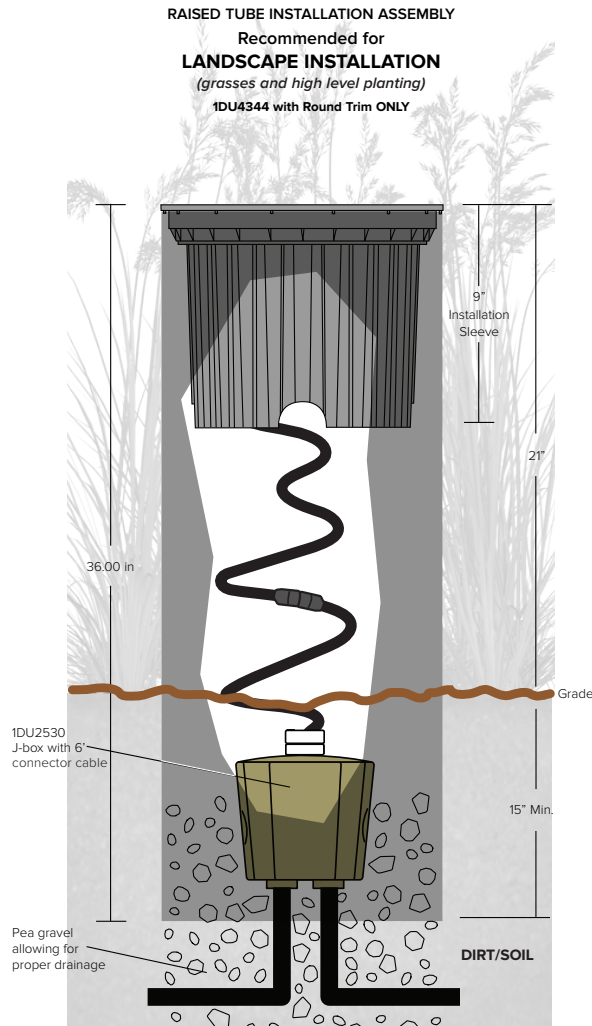

TARGETTI

KEPLERO MINI WALL WASHER

INSTALLATION DIAGRAM - 1DU2530 J-Box

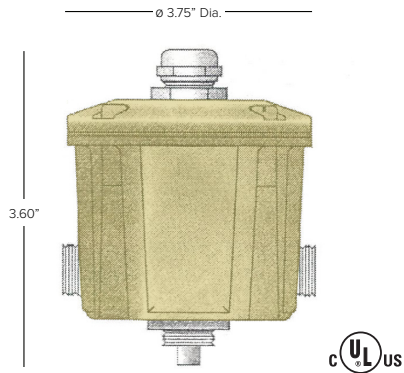

NOTE: Box fill size = 15.94 IN³

Certifications: cULus Wet Listed E496240

Brass junction box is supplied with the following components:

- (4) 3/4" side/bottom NPT holes
- (4) 1/2" reduction NPT adapters
- (2) 1/2" cap plugs

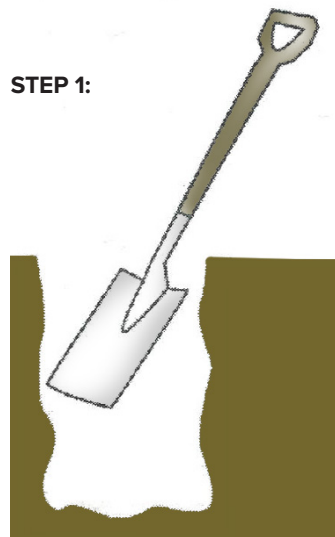

STEP 1:

Dig a hole large enough to accommodate the junction box.

STEP 2:

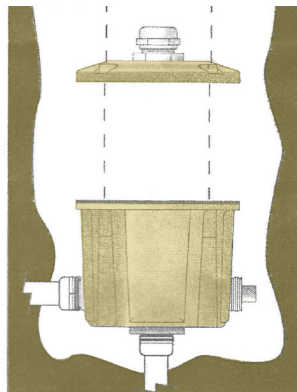

Connect brass junction box to conduit system. Seal conduit entries inside junction box with a good grade RTV sealant per sealant manufacturer's instructions.
Note: Drainage must be in place below junction box.

STEP 3:

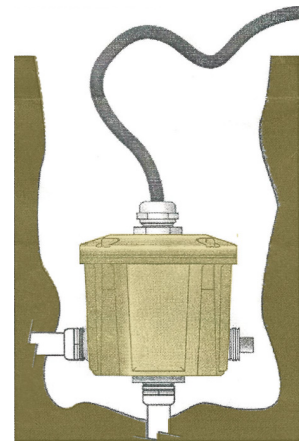

Seal threads. Tighten locking screw on bottom of cover. Connect all wires observing polarity (ie. green-to-ground, white-to-common, and black-to-voltage). Comes with 1/2" strain relief.

Optics

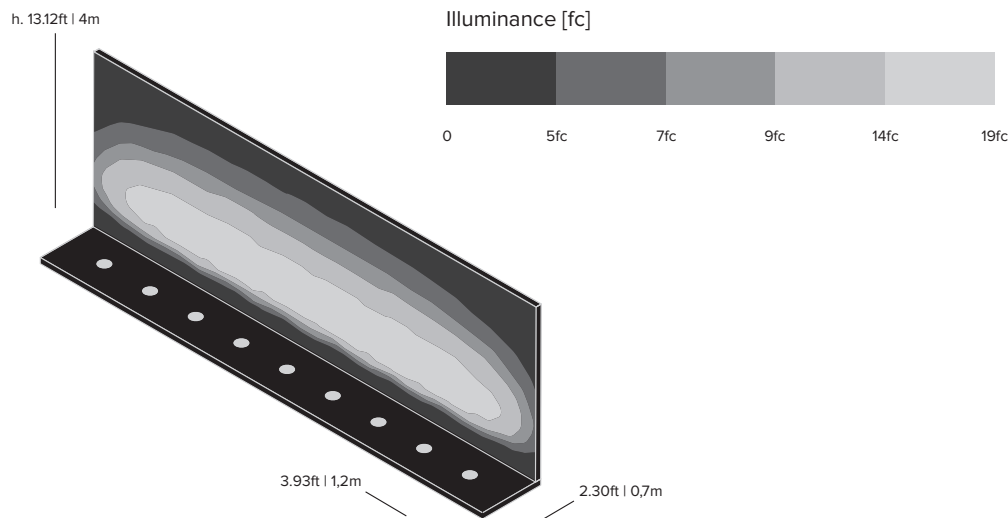

Photometry

WALL WASHER

	3000K	H(m)	D1(m)	D2(m)	E _{max} (lx)
	Ra84		34°	84°	
Fixture Power	14W	1	0.70	1.87	877
Source Flux	1852lm	2	1.40	3.75	219
Fixture Flux	933lm	3	2.10	5.62	97
Efficacy	67lm/W	4	2.81	7.49	55
TS1152	I _{max} =537cd/klm	I _{max}	994cd	5	3.51 9.36 35

	4000K	H(m)	D1(m)	D2(m)	E _{max} (lx)
	Ra84		34°	84°	
Fixture Power	14W	1	0.70	1.87	899
Source Flux	1900lm	2	1.40	3.75	225
Fixture Flux	957lm	3	2.10	5.62	100
Efficacy	68lm/W	4	2.81	7.49	56
TS1152	I _{max} =537cd/klm	I _{max}	1020cd	5	3.51 9.36 36

LineLED HE 48 Wet Tube

IP65 & IP68 rated Linear LED strip - 24V



The High Efficacy (LLHE48) Wet Tube series is a small form factor high performance constant voltage LED strip. Designed to deliver best in class efficacy while operating at low temperature, LLHE48 Wet Tube delivers constant light output, outstanding color consistency and dimming performance without the need of an additional heat sink. Available in 3 different outputs with a tight LED pitch of 0.25", LLHE48 Wet Tube offers a clean dot free illumination in most luminii profiles when paired with our frosted lenses.

To maintain IP65, IP67, and IP68 rating, LLHE48 Wet Tube is factory sealed and bonded. Order in exact lengths required for install, LineLED Wet Tube is not field cuttable. IP rating of strip is equal to the lowest IP rating of section start and end options.

Mounting

LED strip is equipped with 3M™ VHB™ adhesive transfer tape.

Approvals

IP65, IP67, and IP68 rated

Operating Environment

Temperature
-30°C (-22°F) to 50°C (122°F)

Operating voltage

24 VDC

Lumen Maintenance:

Calculated L90 at 173,000 hours for High Output

Warranty

3 years



Applications: outdoor / wet location, above cabinet, cove lighting, counter accent, architectural accents, under banisters, decks, gazebos, barbeque stations and wet bars.

Technical information

MODEL	LO	SO	MO
LEDS/ft	48	48	48
Light output 3000K	231 lum/ft	330 lum/ft	441 lum/ft
Average power consumption (for 4' section)	1.9 W/ft	2.8 W/ft	3.5 W/ft
Ordering increment	1.97	1.97	1.97
Efficacy lum/watt	122 lm/W	118 lm/W	126 lm/W
Maximum run length (in series)	48 ft	42 ft	33ft
Dimensions	0.53"W x 0.24" H		

Color Temperature	Multiplier (referenced from 3000K)	CRI	R _f	R _g	R ₉
2700K	0.94	92	90	99	58
3000K	1.00	92	89	99	57
3500K	1.02	92	89	99	60
4000K	1.02	92	86	94	71

SECTION START/END OPTIONS

SL65

72" Soldered Leads, IP65 rated

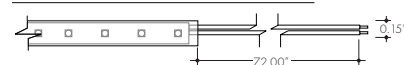

SL68

72" Soldered Leads, IP68 rated

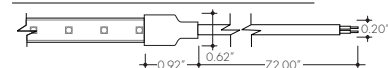

F

Female Quick Connect End, IP67 rated

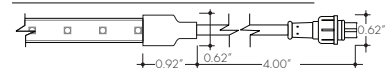

M

Male Quick Connect End, IP67 rated

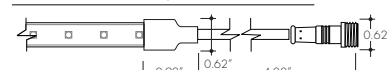

NC

No Connector



IP68 rated when used with SL68 selection

IP65 rated when used with SL65 selection
IP67 rated when used with M or F selection

Ordering code

MODEL	ENCLOSURE	OUTPUT ¹	CCT	SECTION START	SECTION END ²	LENGTH
LLHE48WET	T - Tube	LO - Low SO - Standard MO - Medium	27K - 2700K 30K - 3000K 35K - 3500K 40K - 4000K	SL65 - IP65 Soldered lead wires (72") SL68 - IP68 Soldered lead wires (72") F - IP67 Female Quick Connect M - IP67 Male Quick Connect NC - No Connector	SL65 - IP65 Soldered lead wires (72") SL68 - IP68 Soldered lead wires (72") F - IP67 Female Quick Connect M - IP67 Male Quick Connect NC - No Connector	2" increments

1 - All outputs and CCTs combination be used to comply with Title 24 JA8.

2 - IP rating of strip is equal to the lowest IP rating of section and start end options.

REV2.204262022

page 1 of 6

www.luminii.com

tel: 224-333-6033

420 MENDOCINO AVENUE | SANTA ROSA, CA



SURFACE MOUNTED LINEAR STRIP LIGHT UNDER BENCH

F6

270 CORAL CIRCLE | EL SEGUNDO, CALIFORNIA 90245 | TEL: 310.552.2191 | FAX: 310.552.2192

Power consumption per linear foot - loads tested with PSD series

Accessories

Length of Strip (LF)	LLHE48WET					
	LO		SO		MO	
	W/ft	Total wattage	W/ft	Total wattage	W/ft	Total wattage
1	1.7	1.7	2.5	2.5	3.5	3.5
2	1.9	3.7	2.7	5.4	3.5	7.0
3	2.0	5.7	2.8	8.2	3.5	10.2
4	1.8	7.1	2.8	11.2	3.5	13.9
5	1.8	9.0	3.0	14.6	3.6	17.6
6	1.9	11.3	2.9	17.9	3.5	21.4
7	1.8	13.1	2.9	20.8	3.5	25.1
8	1.8	14.7	2.9	23.3	3.6	28.5
9	1.8	16.4	2.9	25.9	3.5	31.9
10	1.8	18.1	2.9	28.6	3.5	35.5
11	1.7	19.1	2.8	31.2	3.5	38.9
12	1.7	20.4	2.9	34.4	3.5	42.3
13	1.7	22.1	2.8	36.8	3.5	45.7
14	1.6	22.8	2.8	39.3	3.5	48.8
15	1.6	23.5	2.8	41.9	3.5	52.1
16	1.6	25.6	2.8	45.3	3.5	56.5
17	1.7	28.5	2.8	48.1	3.5	59.4
18	1.7	30.4	2.8	51.0	3.5	62.8
19	1.8	33.6	2.8	53.3	3.5	65.8
20	1.8	35.8	2.8	56.0	3.5	69.0
21	1.8	37.7	2.8	59.4	3.4	71.4
22	1.8	39.5	2.8	61.3	3.3	73.5
23	1.8	41.4	2.8	64.4	3.3	75.4
24	1.8	43.1	2.8	66.0	3.2	77.2
25	1.9	46.2	2.7	68.1	3.2	78.8
26	1.9	48.2	2.7	70.7	3.1	79.8
27	1.9	50.4	2.7	72.0	3.0	81.4
28	1.9	52.2	2.6	73.6	3.0	82.9
29	1.9	53.9	2.6	74.7	2.9	84.2
30	1.9	57.7	2.5	76.1	2.9	86.1
31	1.9	59.6	2.5	77.0	2.8	87.6
32	1.9	61.4	2.4	77.7	2.8	89.2
33	1.9	63.3	2.4	78.9	2.7	90.7
34	1.9	65.0	2.3	78.0		
35	1.9	65.4	2.2	78.1		
36	1.9	67.1	2.2	79.5		
37	1.9	69.3	2.2	80.4		
38	1.9	71.1	2.1	80.9		
39	1.9	73.0	2.1	81.0		
40	1.9	74.7	2.0	81.2		
41	1.9	76.0	2.0	82.6		
42	1.8	77.3	2.0	83.0		
43	1.8	78.6				
44	1.8	79.9				
45	1.8	81.1				
46	1.8	81.8				
47	1.8	82.5				
48	1.7	83.1				

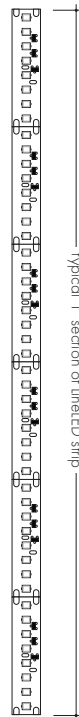

Mounting clip:
recommended at every 12" when
LineLED strip is facing down.

Part # CL-2

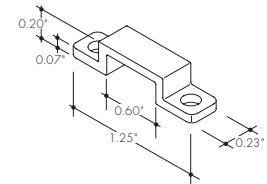

Splice Box:
Wet rated, low voltage
splice box, gray

Part # LVSP-WET

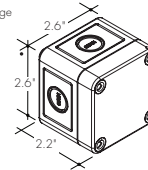

Connector:
Low voltage splice box wet cable
management gray

Part # LVSP-WET-CM

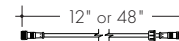

Male/Female Joiner:
Linking and extension cable in 12" or 48"

Part # IP68-12
IP68-48

Lens options / light transmission percentage per lens

C Clear	HF Half (50%) Frosted	G Graze	SI Satin Ice	S Square Frosted	Q Rounded Square Frosted
F Frosted	M Medium beam frosted	R Raised	C36 Clear 36° beam angle	C10 Clear 10° beam angle	

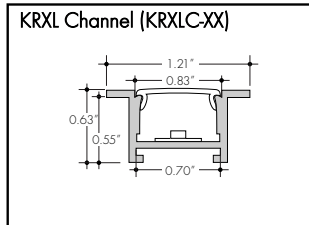

C	F	HF
74%	46%	61%

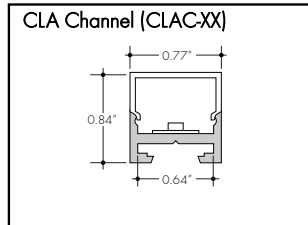

S	Q
62%	63%

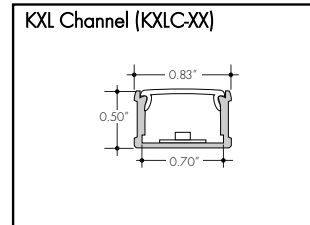

C	F	HF
74%	46%	61%

*Not compatible with IP68 connectors

Installation

All mounting channels are field cuttable using miter saw with circular blade suitable for cutting aluminum.

Ordering

Extrusions are sold separately. View respective specsheets for details on ordering extrusions and their accessories (endcaps, mounting brackets, etc).

Discontinued Extrusion Reference Link

<https://www.luminii.com/media/4351/extrusion-update-02.pdf>

LED Dotting per extrusion

using the frosted lens option

extrusion	LED Model
KXLC, KRXLC	ND
KLC, KRLC	ND
CLAC	ND

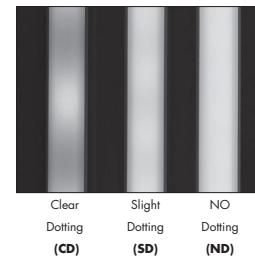

Power Supplies

See Power Supply instructions and spec sheet for wiring information. For a complete list of compatible dimmers, see Compatible Dimming Chart on the Resources page.

Universal Power Supply 1% 120VAC - 277VAC

MODEL	POWER	OUTPUT
PDCU-D - IP20 Dry Series	30 - 30 W 60 - 60 W 96 - 96 W 3X96 - 3X96 W	24 - 24 VDC
PDCU-W - IP66 Wet Series	96 - 96 W 3X96 - 3X96 W	

0-10V dims down to 1%, MLV/ELV/TRIAC dims down to 1%.
For a complete list of compatible dimmers, see [Compatible Dimming Chart](#) on the Resources page.

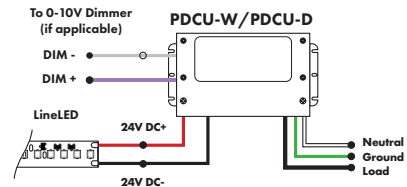

MODELS	PDCU-W 96W	PDCU-W 3X96W	PDCU-D 30W	PDCU-D 60W	PDCU-D 96W	PDCU-D 3X96W
Length	8.66"	11.85"	6.10"	7.93"	8.25"	9.57"
Width	3.73"	4.32"	3.35"	3.35"	4.10"	5.94"
Depth	1.61"	1.81"	1.33"	1.32"	1.56"	1.13"

0-10V Dimming Power Supplies 0.1% 120VAC - 277VAC

MODEL	POWER	OUTPUT	DIMMING
PS010V - 0-10V Power Supply dims down to 0.1%	96 - 96 Watt 3X96 - 3 X 96 Watt	24 - 24 VDC	LIN - Linear LOG - Logarithmic

MODELS	96W	3X96
Length	14.40"	15.75"
Width	5.20"	6.62"
Depth	2.60"	4.95"

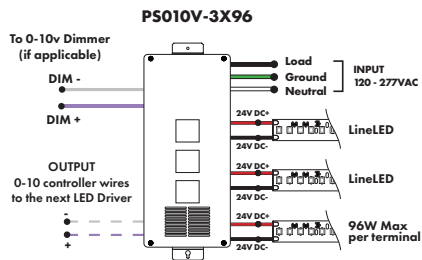
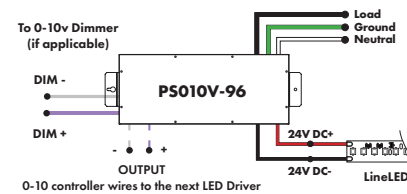

Triac, MLV, ELV, & PWM Compatible Dimmers

MODEL	POWER	OUTPUT
PDC - (IP20) Power Supply	96 - 96 Watts	24 - 24 VDC

MODELS	96W
Length	8.25"
Width	4.10"
Depth	1.56"

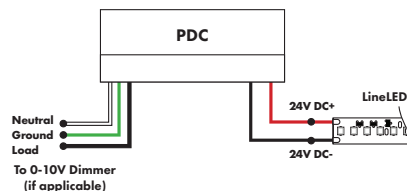

Power Supplies

See Power Supply instructions and spec sheet for wiring information. For a complete list of compatible dimmers, see Compatible Dimming Chart on the Resources page.

DMX Dimming Power Supplies 120VAC - 277VAC

MODEL	POWER	OUTPUT
PSDMX - DMX Power Supply dims down to 0%	96 - 96 Watt 3X96 - 3 X 96 Watt	24 - 24 VDC

Features eldoLED's LINEARdrive configurable dimmable drivers

MODELS	96W	3X96
Length	14.40"	15.75"
Width	5.20"	6.62"
Depth	2.60"	4.95"

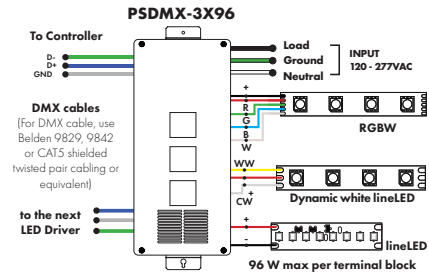
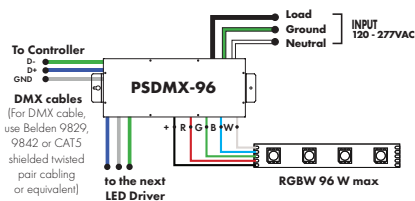

DALI 0% Dimming Power Supplies 120VAC - 277VAC

MODEL	POWER	OUTPUT
PSDALI - DALI Power Supply dims down to 0%	96 - 96 Watt 3X96 - 3 X 96 Watt	24 - 24 VDC

Features eldoLED's LINEARdrive configurable dimmable drivers

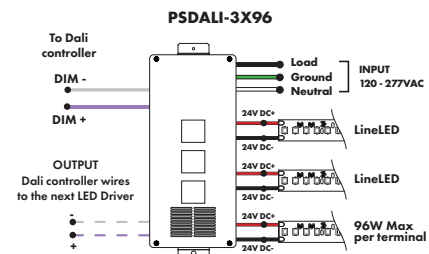
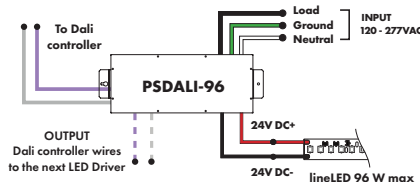

Enlighted Enabled Dimming Power Supplies 120VAC - 277VAC

MODEL	POWER	OUTPUT	DIMMING	LOCATION
PSV - PSV Series	96 - 96 Watt	24 - 24 VDC	ENL - Enlighted Dimming dims down to 0%	D - Damp

Model	96W
Length	14.40"
Width	5.20"
Depth	2.60"

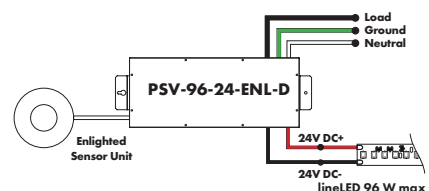

Power Supplies

See Power Supply instructions and spec sheet for wiring information. For a complete list of compatible dimmers, see Compatible Dimming Chart on the Resources page.

Non-Dimming Power Supply 120VAC - 277VAC

MODEL	POWER	OUTPUT	DIMMING	LOCATION
PSV - PSV Series	96 - 96 Watt	24 - 24 VDC	U2ND - Non Dimming	D - Damp

MODELS	96W
Length	14.40"
Width	5.20"
Depth	2.60"

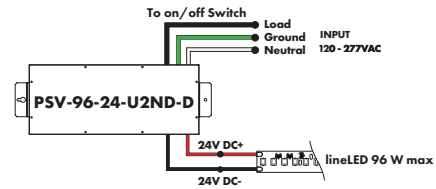

Luminii is a Lutron OEM Advantage Partner

Lutron Power Supplies 1%

MODEL	MODEL
LTEA4U1UKL-CV240	L3DA4U1UKL-CV240
Lutron - HiLume™ 1% 2-wire LED Driver 40W max	HiLume™ 1% EcoSystem Voltage LED driver 40W max
(120V forward phase only)	

MODELS	LTEA4U1UKL-CV240	L3DA4U1UKL-CV240
Length	4.89"	4.98"
Width	4.00"	4.00"
Depth	2.62"	2.62"

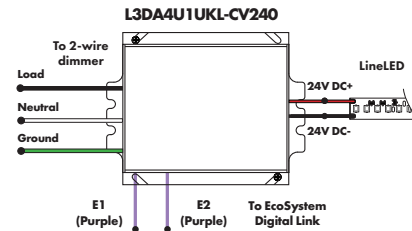
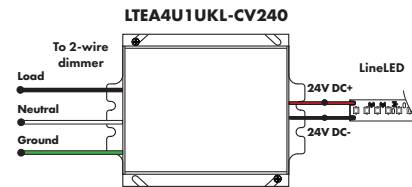

Luminii is a Lutron OEM Advantage Partner

Lutron Power Supplies 0.1%

MODEL
L3D0-96W24V-U
HiLume™ 0.1% EcoSystem Voltage LED Driver with Soft-On, Fade-to-Black™ 96W max

MODELS	L3D0
Length	10.50"
Width	5.50"
Depth	2.00"

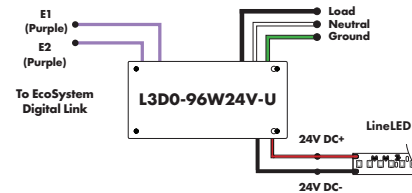

In-Ground Power Supplies

MODEL	POWER	OUTPUT	INPUT
IG - In ground CVE Series	CVE - ELV Dimming DALI - eldoLED Dali dimming	96X2 - 2 X 96 Watt	Blank - 120 V 277 - 240/277 V
Both dims down to 0%			

MODELS	Dual Circuit
Length	8.40"
Width	8.30"
Depth	8.10"

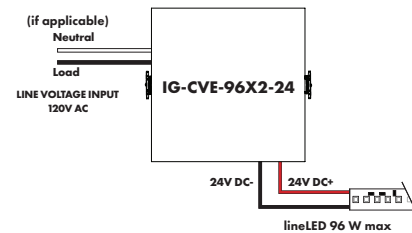

DENALI LED (REMOTE)

IP66 RATED

DATE:

PROJECT:

TYPE:

CATALOG NUMBER LOGIC:



**Driver housing required.
Configure separately.**

**Accommodates up to 2 lens/shielding media.*

CATALOG NUMBER LOGIC

Example: DE - LED - x58 - SP - BZW - 9 - 11 - A

MATERIAL

Aluminum

SERIES

DE - Denali

SOURCE

LED - Chip on Board Technology

LED TYPE

x58 - 12W/2700K/80CRI	x62 - 20W/3000K/80CRI	x66 - 27W/4000K/80CRI
x59 - 12W/3000K/80CRI	x63 - 20W/4000K/80CRI	x67 - 27W/2700K/90CRI ✓
x60 - 12W/4000K/80CRI	x64 - 27W/2700K/80CRI	x68 - 27W/3000K/90CRI ✓
x61 - 20W/2700K/80CRI	x65 - 27W/3000K/80CRI	x69 - 27W/3500K/80CRI

OPTICS

SP - Spot (15°) FL - Flood (35°) WFL - Wide Flood (60°)

FINISH (See page 2 for full-color swatches)

Standard Finishes (BZP, BZW, BLP, BLW, WHP, WHW, SAP, VER)

Premium Finish (ABP, AMG, AQW, BCM, BGE, BPP, CAP, CMG, CRI, CRM, HUG, MDS, NBP, OCP, RMG, SDS, SMG, TXF, WCP, WIR)

Also available in RAL Finishes

LENS TYPE*

9 - Clear (Standard)

10 - Spread 12 - Soft Focus 13 - Rectilinear

SHIELDING*

11 - Honeycomb Baffle

CAP STYLE

A - 45°

B - 90°

C - Flush

D - 45° Less Weephole (Interior use only)

E - 90° Less Weephole (Interior use only)



TITLE 24, JA8 COMPLIANT

B-K LIGHTING

MADE IN THE USA

559.438.5800 | INFO@BKLIGHTING.COM | BKLIGHTING.COM

THIS DOCUMENT CONTAINS PROPRIETARY INFORMATION OF B-K LIGHTING, INC. AND ITS RECEIPT OR POSSESSION DOES NOT CONVEY ANY RIGHTS TO REPRODUCE, DISCLOSE ITS CONTENTS, OR TO MANUFACTURE, USE OR SELL ANYTHING IT MAY DESCRIBE. REPRODUCTION, DISCLOSURE OR USE WITHOUT SPECIFIC WRITTEN AUTHORIZATION OF B-K LIGHTING, INC. IS STRICTLY FORBIDDEN.

10/06/2021 SKU-848
SUB001113

420 MENDOCINO AVENUE | SANTA ROSA, CA



WALL MOUNTED ADJUSTABLE BULLET ACCENT / FLOOD LIGHT

F7,7A

270 CORAL CIRCLE | EL SEGUNDO, CALIFORNIA 90245 | TEL: 310.552.2191 | FAX: 310.552.2192

DATE:

PROJECT:

TYPE:

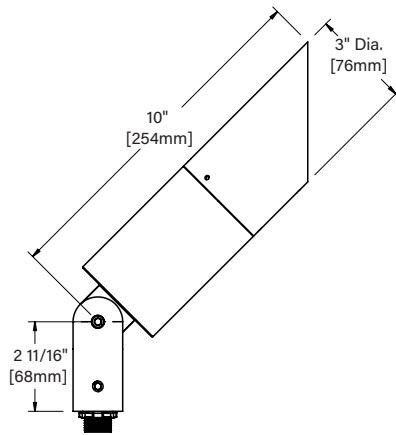
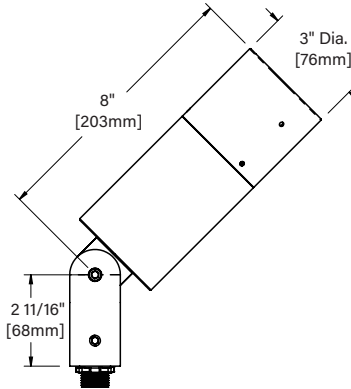
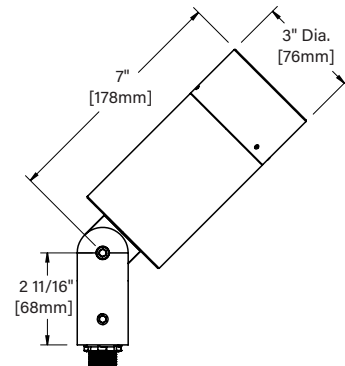
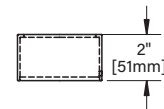
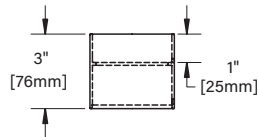
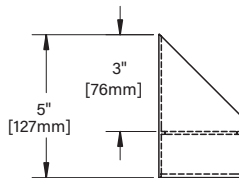
**"A"/"D" CAP****"B"/"E" CAP****"C" CAP****STANDARD FINISHES**

[Click Here](#) to view larger, full-color swatches of all available finishes on our website.

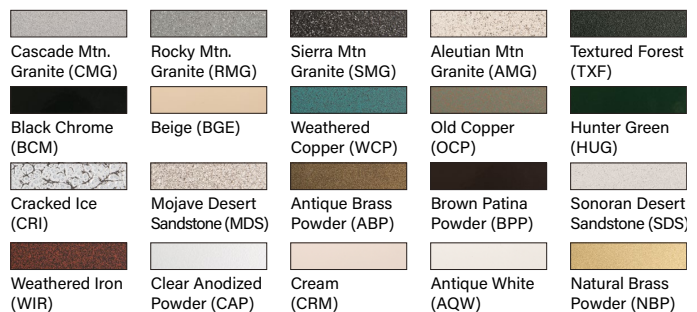
PREMIUM FINISHES**B-K LIGHTING****MADE IN THE USA**559.438.5800 | INFO@BKLIGHTING.COM | BKLIGHTING.COM

THIS DOCUMENT CONTAINS PROPRIETARY INFORMATION OF B-K LIGHTING, INC. AND ITS RECEIPT OR POSSESSION DOES NOT CONVEY ANY RIGHTS TO REPRODUCE, DISCLOSE ITS CONTENTS, OR TO MANUFACTURE, USE OR SELL ANYTHING IT MAY DESCRIBE. REPRODUCTION, DISCLOSURE OR USE WITHOUT SPECIFIC WRITTEN AUTHORIZATION OF B-K LIGHTING, INC. IS STRICTLY FORBIDDEN.

10/06/2021 SKU-848
SUB001113

420 MENDOCINO AVENUE | SANTA ROSA, CA

WALL MOUNTED ADJUSTABLE BULLET ACCENT / FLOOD LIGHT

F7,7A

270 CORAL CIRCLE | EL SEGUNDO, CALIFORNIA 90245 | TEL: 310.552.2191 | FAX: 310.552.2192

DATE:

PROJECT:

TYPE:

Accessories (Configure separately)



Power Pipe II

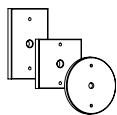

Canopies

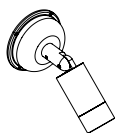

Power Canopy

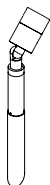

Power Pipe II

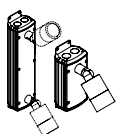

PM2D & PM2

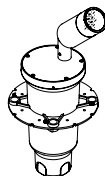

HP2

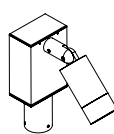

TMB

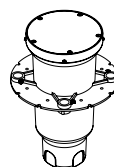

HP2RM

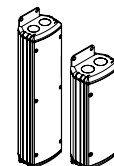

PM2DRM & PM2RM

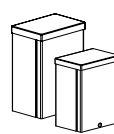

RM & DRM

SPECIFICATIONS

ELECTRICAL	WATTAGE	12W, 20W, or 27W LED
	WIRING	Stranded XLPE, 18GA, 600V, 150°C, wire rated to UL3321.
	REMOTE DRIVER	For use with remote LED driver. See remote driver submittal to determine remote distance and wiring requirements prior to detailing field installation of any remote wiring.
PHYSICAL	MATERIALS	Furnished in copper-free aluminum (6061-T6).
	BODY	Unibody design with enclosed, water-proof wireway and integral heat sink is fully machined from solid billet. Anti-condensation and corrosion vent equalizes fixture pressure and eliminates potential for damage to internal components.
	KNUCKLE	360HD Mounting System features a mechanical taperlock, allowing full 180° vertical adjustment without the use of aim-limiting serrated teeth. High temperature, silicone 'O' Ring provides water-tight seal and compressive resistance to maintain fixture position. Design withstands 73 lbs. static load prior to movement for optical alignment with a ½" pipe thread for mounting. Biaxial source control additionally provides 360° horizontal rotation in addition to vertical adjustment. Aim & Lock technology allows precision adjustment without the redundant tightening and loosening of knuckle screw. 360HD hardware is stainless steel with black oxide treatment for additional corrosion resistance.
	CAP	Fully machined and accommodates two (2) lens or louver media.
	LENS	Shock-resistant, tempered glass lens is factory adhered to fixture cap and provides hermetically sealed optical compartment.
	LED	Integrated solid state system and modular design with electrical disconnects allow for easy field upgrade and maintenance. LM-80 certified. Title 24, JA8 compliant. Minimum 50,000 hour rated life at 70% of initial lumens (L70). LED technology provides long life, significant energy reduction and exceptional thermal management.
	COLOR MANAGEMENT	Corrected cold phosphor technology delivers natural white light with long term phosphor maintenance over product life. Exact color point conformity exceeds ANSI C78.377 standard. Provides uniform beam with no color variation over angle. Module exceeds 80 CRI (RA>80, R9>16).
	HARDWARE	Tamper-resistant, stainless steel hardware. 360HD hardware is black oxide treated for additional corrosion resistance.
	FINISH	StarGuard, our 15-stage chromate-free process cleans and conversion coats aluminum components prior to application of Class 'A' TGIC polyester powder coating and is RoHS compliant.
	WARRANTY	5-year limited warranty.
	CERTIFICATION & LISTING	UL tested to IESNA LM-79. UL Listed. Certified to CAN/CSA/ANSI Standards. RoHS compliant. Title 24, JA8 compliant. Suitable for indoor or outdoor use, in wet locations, and for installation within 4' of the ground. IP66 Rated. Made in the USA with sustainable processes.



TITLE 24, JA8



RoHS

**B-K LIGHTING****MADE IN THE USA**

559.438.5800 | INFO@BKLIGHTING.COM | BKLIGHTING.COM

THIS DOCUMENT CONTAINS PROPRIETARY INFORMATION OF B-K LIGHTING, INC. AND ITS RECEIPT OR POSSESSION DOES NOT CONVEY ANY RIGHTS TO REPRODUCE, DISCLOSE ITS CONTENTS, OR TO MANUFACTURE, USE OR SELL ANYTHING IT MAY DESCRIBE. REPRODUCTION, DISCLOSURE OR USE WITHOUT SPECIFIC WRITTEN AUTHORIZATION OF B-K LIGHTING, INC. IS STRICTLY FORBIDDEN.

10/06/2021 SKU-848
SUB001113**420 MENDOCINO AVENUE | SANTA ROSA, CA**

WALL MOUNTED ADJUSTABLE BULLET ACCENT / FLOOD LIGHT

F7,7A

270 CORAL CIRCLE | EL SEGUNDO, CALIFORNIA 90245 | TEL: 310.552.2191 | FAX: 310.552.2192

LAMP & DRIVER DAT (page 1 of 2)

DATE:

PROJECT:

TYPE:

DRIVER ELECTRICAL DATA

Type	LED Type	AC Input Range	Frequency Hz	Power Factor At Full Load (Efficiency)	THD	InRush Current	Operating Current	Operation Ambient Temperature	Dimmer Type	Dimmer Range
INC	x58-x63	105-305Vac	50/60	> 0.94	≤5%	< 250mA	700mA	-30° C ~ 50°C	Incandescent	10-100%
INC	x64-x66	105-305Vac	50/60	> 0.94	≤5%	< 250mA	700mA	-30° C ~ 50°C	TRIAC/ELV, (120 Only)	10-100%
010	x64-x66	120-277Vac	50/60	> 0.90	<20%	6A	700mA	-30° C ~ 70°C	0-10 (120 or 277)	10-100%

LM79 DATA

OPTICAL DATA

BK No.	CCT (Typ.)	CRI (Typ.)	Input Watts (Typ.)	L70 Data	Angle	CBCP	Del. Lumens	Muliplier
x58	2700	80	12	50,000	15	3,865	721	0.85
x58	2700	80	12	50,000	35	1,493	661	0.85
x58	2700	80	12	50,000	60	627	623	0.85
x59	3000	80	12	50,000	15	4,048	756	0.89
x59	3000	80	12	50,000	35	1,564	692	0.89
x59	3000	80	12	50,000	60	657	653	0.89
x60	4000	80	12	50,000	15	4,561	851	1.00
x60	4000	80	12	50,000	35	1,762	780	1.00
x60	4000	80	12	50,000	60	740	736	1.00
x61	2700	80	20	50,000	15	7,103	1,307	0.91
x61	2700	80	20	50,000	35	2,623	1,125	0.91
x61	2700	80	20	50,000	60	1,049	1,064	0.91
x62	3000	80	20	50,000	15	7,478	1,376	0.96
x62	3000	80	20	50,000	35	2,761	1,184	0.96
x62	3000	80	20	50,000	60	1,104	1,120	0.96
x63	4000	80	20	50,000	15	7,800	1,435	1.00
x63	4000	80	20	50,000	35	2,880	1,235	1.00
x63	4000	80	20	50,000	60	1,152	1,168	1.00
x64	2700	80	27	50,000	15	15,656	1,767	0.92
x64	2700	80	27	50,000	35	4,649	1,586	0.92
x64	2700	80	27	50,000	60	1,515	1,383	0.92
x65	3000	80	27	50,000	15	16,132	1,820	0.95
x65	3000	80	27	50,000	35	4,791	1,634	0.95
x65	3000	80	27	50,000	60	1,561	1,426	0.95
x66	4000	80	27	50,000	15	17,042	1,923	1.00
x66	4000	80	27	50,000	35	5,061	1,726	1.00
x66	4000	80	27	50,000	60	1,649	1,506	1.00
x67	2700	90	27	50,000	15	14852	1676	0.95
x67	2700	90	27	50,000	35	4,411	1504	0.95
x67	2700	90	27	50,000	60	1437	1312	0.95
x68	3000	90	27	50,000	15	15770	1779	0.98
x68	3000	90	27	50,000	35	4,683	1597	0.98
x68	3000	90	27	50,000	60	1526	1394	0.98

B-K LIGHTING

MADE IN THE USA

559.438.5800 | INFO@BKLIGHTING.COM | BKLIGHTING.COM

THIS DOCUMENT CONTAINS PROPRIETARY INFORMATION OF B-K LIGHTING, INC. AND ITS RECEIPT OR POSSESSION DOES NOT CONVEY ANY RIGHTS TO REPRODUCE, DISCLOSE ITS CONTENTS, OR TO MANUFACTURE, USE OR SELL ANYTHING IT MAY DESCRIBE. REPRODUCTION, DISCLOSURE OR USE WITHOUT SPECIFIC WRITTEN AUTHORIZATION OF B-K LIGHTING, INC. IS STRICTLY FORBIDDEN.

420 MENDOCINO AVENUE | SANTA ROSA, CA



WALL MOUNTED ADJUSTABLE BULLET ACCENT / FLOOD LIGHT

F7,7A

270 CORAL CIRCLE | EL SEGUNDO, CALIFORNIA 90245 | TEL:310.552.2191 | FAX:310.552.2192

LAMP & DRIVER DAT (page 2 of 2)

DATE:

PROJECT:

TYPE:

OPTICS	
Optic	Angle
Spot	15°
Flood	35°
Wide Flood	60°

B-K LIGHTING

MADE IN THE USA

559.438.5800 | INFO@BKLIGHTING.COM | BKLIGHTING.COM

THIS DOCUMENT CONTAINS PROPRIETARY INFORMATION OF B-K LIGHTING, INC. AND ITS RECEIPT OR POSSESSION DOES NOT CONVEY ANY RIGHTS TO REPRODUCE, DISCLOSE ITS CONTENTS, OR TO MANUFACTURE, USE OR SELL ANYTHING IT MAY DESCRIBE. REPRODUCTION, DISCLOSURE OR USE WITHOUT SPECIFIC WRITTEN AUTHORIZATION OF B-K LIGHTING, INC. IS STRICTLY FORBIDDEN.

420 MENDOCINO AVENUE | SANTA ROSA, CA



WALL MOUNTED ADJUSTABLE BULLET ACCENT / FLOOD LIGHT

F7,7A

270 CORAL CIRCLE | EL SEGUNDO, CALIFORNIA 90245 | TEL: 310.552.2191 | FAX: 310.552.2192

DATE:

PROJECT:

TYPE:

CATALOG NUMBER LOGIC:



**Designed for use with LED transformer. Requires magnetic low voltage dimmer.*

***Please see Adjust-e-Lume photometry to determine desired intensity.*

****The 360SL cost is already included in the price of UPM, UPM dual, and Power Canopy.*

CATALOG NUMBER LOGIC

Example: B - DS - LED - e64 - SP - A7 - BZP - 12 - 11 - A - 360SL

MATERIAL

(Blank) - Aluminum B - Brass S - Stainless Steel

SERIES

DS - Delta Star

SOURCE

LED - with Integral Dimming Driver (25W min. load when dimmed)*

LED TYPE

e64 - 7W LED/2700K e66 - 7W LED/4000K
e65 - 7W LED/3000K e74 - 7W LED/Amber

OPTICS

NSP - Narrow Spot (13°) MFL - Medium Flood (23°)
SP - Spot (16°) WFL - Wide Flood (31°)

ADJUST-E-LUME® OUTPUT INTENSITY**

A9 (Standard), A8, A7, A6, A5, A4, A3, A2, A1

FINISH (See page 2 for full-color swatches)

Standard Finishes (BZP, BZW, BLP, BLW, WHP, WHW, SAP, VER)

Premium Finish (ABP, AMG, AQW, BCM, BGE, BPP, CAP, CMG, CRI, CRM, HUG, MDS, NBP, OCP, RMG, SDS, SMG, TXF, WCP, WIR)

Also available in RAL Finishes

Brass Finishes (MAC, POL, MIT)

Stainless Steel Finishes (MAC, POL)

LENS TYPE

12 - Soft Focus 13 - Rectilinear

SHIELDING

11 - Honeycomb Baffle

CAP STYLE

A - 45°

B - 90°

C - Flush Lens

D - 45° Less Weephole (Interior use only)

E - 90° Less Weephole (Interior use only)

F - 90° with Flush Lens

OPTIONS

360SL - Knuckle Mounting System***

B-K LIGHTING**MADE IN THE USA**

559.438.5800 | INFO@BKLIGHTING.COM | BKLIGHTING.COM

THIS DOCUMENT CONTAINS PROPRIETARY INFORMATION OF B-K LIGHTING, INC. AND ITS RECEIPT OR POSSESSION DOES NOT CONVEY ANY RIGHTS TO REPRODUCE, DISCLOSE ITS CONTENTS, OR TO MANUFACTURE, USE OR SELL ANYTHING IT MAY DESCRIBE. REPRODUCTION, DISCLOSURE OR USE WITHOUT SPECIFIC WRITTEN AUTHORIZATION OF B-K LIGHTING, INC. IS STRICTLY FORBIDDEN.

01/15/2020 SKU-739
SUB000930

420 MENDOCINO AVENUE | SANTA ROSA, CA

STAKE MOUNTED TREE UPLIGHT

F9

270 CORAL CIRCLE | EL SEGUNDO, CALIFORNIA 90245 | TEL: 310.552.2191 | FAX: 310.552.2192

DATE:

PROJECT:

TYPE:

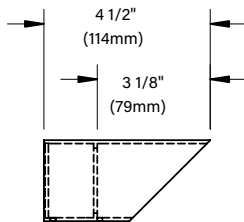
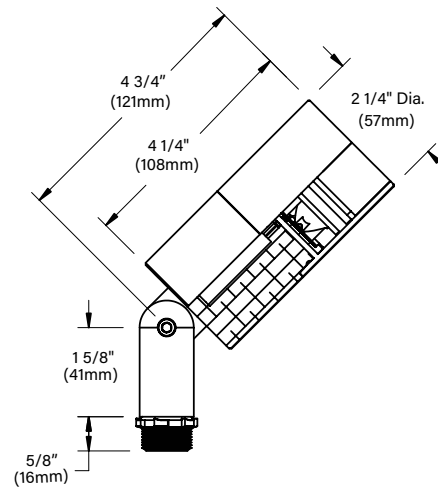
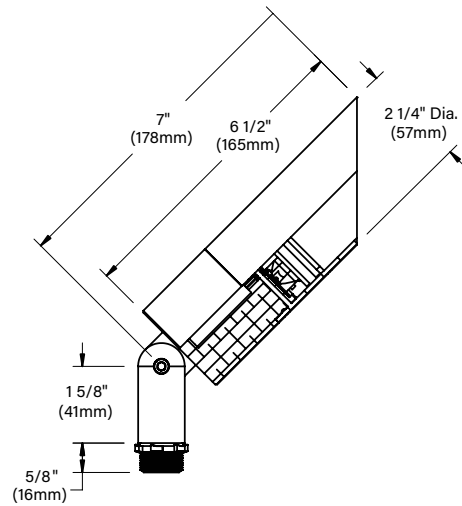
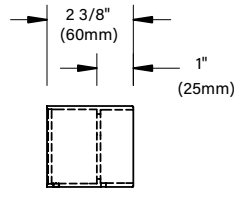
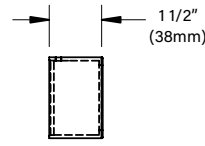
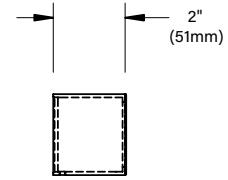
**A/D CAP****B/E CAP****C CAP****F CAP****STANDARD FINISHES**

Click Here to view larger, full-color swatches of all available finishes on our website.

PREMIUM FINISHES**B-K LIGHTING****MADE IN THE USA**

559.438.5800 | INFO@BKLIGHTING.COM | BKLIGHTING.COM

THIS DOCUMENT CONTAINS PROPRIETARY INFORMATION OF B-K LIGHTING, INC. AND ITS RECEIPT OR POSSESSION DOES NOT CONVEY ANY RIGHTS TO REPRODUCE, DISCLOSE ITS CONTENTS, OR TO MANUFACTURE, USE OR SELL ANYTHING IT MAY DESCRIBE. REPRODUCTION, DISCLOSURE OR USE WITHOUT SPECIFIC WRITTEN AUTHORIZATION OF B-K LIGHTING, INC. IS STRICTLY FORBIDDEN.

01/15/2020 SKU-739
SUB000930

420 MENDOCINO AVENUE | SANTA ROSA, CA

STAKE MOUNTED TREE UPLIGHT

F9

270 CORAL CIRCLE | EL SEGUNDO, CALIFORNIA 90245 | TEL: 310.552.2191 | FAX: 310.552.2192

DATE:

PROJECT:

TYPE:

Accessories (Configure separately)

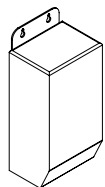

TR Series

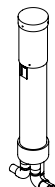

Power Pipe

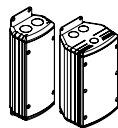

UPMRM

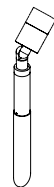

Power Pipe

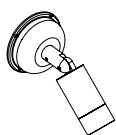

Power Canopy

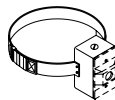

Tree Strap



Stems

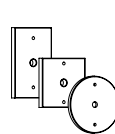

Canopies

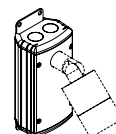

UPM

SPECIFICATIONS

ELECTRICAL	WATTAGE	7W LED
	WIRING	XLPE, 18GA, 150C, 600V, rated and certified to UL3321.
	REMOTE TRANSFORMER	For use with 12VAC remote transformer or magnetic transformers only. B-K Lighting cannot guarantee performance with third party manufacturers' transformers.
PHYSICAL	MATERIALS	Furnished in copper-free aluminum (6061-T6), brass (360) or stainless steel (304).
	BODY	Unibody design with enclosed, water-proof wireway and integral heat sink is fully machined from solid billet.
	KNUCKLE	LOCK Knuckle is integral to the body and features an interior taper machined from solid billet and a second, reverse angle taper allowing full 180° vertical adjustment without the use of aim-limiting serrated teeth. High temperature, silicone 'O' Ring provides water-tight seal and compressive resistance to maintain fixture position. Design withstands 73 lbs. static load prior to movement for optical alignment with a 1/2" pipe thread for mounting. Optional 360SL provides biaxial source control with 360° horizontal rotation in addition to vertical adjustment.
	CAP	Fully machined and accommodates two (2) lens or louver media.
	LENS	Shock-resistant, tempered glass lens is factory adhered to fixture cap and provides hermetically sealed optical compartment.
	LED	Integrated solid state system and modular design with electrical disconnects allow for easy field upgrade and maintenance. High power, forward throw source complies with ANSI C78.377 binning requirements and exceeds ENERGY STAR® lumen maintenance requirements. LM-80 certified components. Integral, constant current driver. 12VAC/VDC input. 50/60Hz. Proprietary input control scheme achieves power factor correction and eliminates inrush current (limited to <250mA non-dimming). Output, overvoltage, open-circuit, and short circuit protected. Conforms to Safety Std. C22.2 No. 250.13-12.
	DIMMING	Line voltage dimmable via magnetic low voltage dimmer with dedicated neutral conductor. Remote magnetic transformer with LED loads should be loaded to 25% of the transformer VA (watts) rated value.
	ADJUST-E-LUME	Integral electronics allow for dynamic lumen response at the individual fixture. Indexed (100% to 25% nom.) lumen output. Maintains output at desired level or may be changed. Specify factory preset output intensity.
	OPTICS	Interchangeable OPTIKIT modules permit optical field changes. Color-code: Narrow Spot (NSP) = red; Spot (SP) = green; Medium Flood (MFL) = yellow; Wide Flood (WFL) = blue.
	HARDWARE	Tamper-resistant, stainless steel hardware. LOCK aiming screw is black oxide treated for additional corrosion resistance.
	FINISH	StarGuard, our 15-stage chromate-free process cleans and conversion coats aluminum components prior to application of Class 'A' TGIC polyester powder coating and is RoHS compliant. Powder coat or metal finish options available for brass material and metal finish option only for stainless steel material.
	WARRANTY	5-year limited warranty.
	CERTIFICATION & LISTING	ITL tested to IESNA LM-79. UL Listed. Certified to CAN/CSA/ANSI Standards. RoHS compliant. Suitable for indoor or outdoor use, in wet locations, and for installation within 4' of the ground. IP66 Rated. Made in the USA with sustainable processes.

**B-K LIGHTING****MADE IN THE USA**

559.438.5800 | INFO@BKLIGHTING.COM | BKLIGHTING.COM

THIS DOCUMENT CONTAINS PROPRIETARY INFORMATION OF B-K LIGHTING, INC. AND ITS RECEIPT OR POSSESSION DOES NOT CONVEY ANY RIGHTS TO REPRODUCE, DISCLOSE ITS CONTENTS, OR TO MANUFACTURE, USE OR SELL ANYTHING IT MAY DESCRIBE. REPRODUCTION, DISCLOSURE OR USE WITHOUT SPECIFIC WRITTEN AUTHORIZATION OF B-K LIGHTING, INC. IS STRICTLY FORBIDDEN.

01/15/2020 SKU-739
SUB0000930**420 MENDOCINO AVENUE | SANTA ROSA, CA**

STAKE MOUNTED TREE UPLIGHT

F9

270 CORAL CIRCLE | EL SEGUNDO, CALIFORNIA 90245 | TEL: 310.552.2191 | FAX: 310.552.2192

LAMP & DRIVER DATA (e64, e65, e66, e74)

DATE:	PROJECT:	TYPE:
-------	----------	-------

CATALOG NUMBER LOGIC:

DRIVER DATA	Input Volts	InRush Current	Operating	Dimmable	Operation Ambient Temperature
	12VAC/DC 50/60Hz	<250mA (non-dimmed)	700mA	Magnetic Low Voltage Dimmer	-22°F-194°F (-30°C - 90°C)

LM79 DATA				L70 DATA		OPTICAL DATA			
BK No.	CCT (Typ.)	CRI (Typ.)	Input Watts (Typ.)	Minimum Rated Life (hrs.) 70% of initial lumens (L ₇₀)		Angle	CBCP	Delivered Lumens	Multiplier
e64	2700K	80	7	50,000		13°	5993	456	0.87
	2700K	80	7	50,000		16°	4546	445	0.87
	2700K	80	7	50,000		23°	1726	397	0.87
	2700K	80	7	50,000		31°	1131	399	0.87
e65	3000K	80	7	50,000		13°	6131	466	0.89
	3000K	80	7	50,000		16°	4650	455	0.89
	3000K	80	7	50,000		23°	1766	406	0.89
	3000K	80	7	50,000		31°	1157	409	0.89
e66	4000K	80	7	50,000		13°	6889	524	
	4000K	80	7	50,000		16°	5225	511	
	4000K	80	7	50,000		23°	1984	456	
	4000K	80	7	50,000		31°	1300	459	
e74	Amber	80	7	50,000		13°	3,927	299	0.57
	Amber	80	7	50,000		16°	2,978	291	0.57
	Amber	80	7	50,000		23°	1,131	260	0.57
	Amber	80	7	50,000		31°	741	262	0.57

OPTICS

Optic	Angle
NSP - Narrow Spot	13°
SP - Spot	16°
MFL - Medium Flood	23°
WFL - Wide Flood	31°

B-K LIGHTING

MADE IN THE USA

559.438.5800 | INFO@BKLIGHTING.COM | BKLIGHTING.COM

THIS DOCUMENT CONTAINS PROPRIETARY INFORMATION OF B-K LIGHTING, INC. AND ITS RECEIPT OR POSSESSION DOES NOT CONVEY ANY RIGHTS TO REPRODUCE, DISCLOSE ITS CONTENTS, OR TO MANUFACTURE, USE OR SELL ANYTHING IT MAY DESCRIBE. REPRODUCTION, DISCLOSURE OR USE WITHOUT SPECIFIC WRITTEN AUTHORIZATION OF B-K LIGHTING, INC. IS STRICTLY FORBIDDEN.

420 MENDOCINO AVENUE | SANTA ROSA, CA



STAKE MOUNTED TREE UPLIGHT

F9

270 CORAL CIRCLE | EL SEGUNDO, CALIFORNIA 90245 | TEL: 310.552.2191 | FAX: 310.552.2192

Application

LED bollard with fully shielded light distribution. The glare-free illumination of these luminaires is ideally suited for lighting entrances and footpaths as well as many areas of garden and landscape architecture.

Materials

Luminaire housing and base constructed of die-cast and extruded marine grade, copper free ($\leq 0.3\%$ copper content) A360.0 aluminum alloy
Clear safety glass with optical texture
Reflector made of pure anodized aluminum
High temperature silicone gasket
Mechanically captive stainless steel fastener

NRTL listed to North American Standards, suitable for wet locations

Protection class IP65

Weight: 9.3lbs

Electrical

Operating voltage	120-277VAC
Minimum start temperature	-30°C
LED module wattage	20.6W
System wattage	25.0W
Controllability	0-10V dimmable
Color rendering index	Ra > 80
Luminaire lumens	1577 lumens (3000K)
Lifetime at Ta = 15°C	>500,000 h (L70)
Lifetime at Ta = 50°C	280,000 h (L70)

LED color temperature

- ☐ 4000K - Product number + **K4**
- ☐ 3500K - Product number + **K35**
- ☐ 3000K - Product number + **K3**
- ☐ 2700K - Product number + **K27**

BEGA can supply you with suitable LED replacement modules for up to 20 years after the purchase of LED luminaires - see website for details

Finish

All BEGA standard finishes are matte, textured polyester powder coat with minimum 3 mil thickness.

Available colors ☐ Black (BLK) ☐ White (WHT) ☐ RAL:
☐ Bronze (BRZ) ☐ Silver (SLV) ☐ CUS:

**LED bollard - symmetric**

	LED	A	B	C	Anchorage
88262	20.6W	10	21 1/2	4 3/8	79824

Type:

BEGA Product:

Project:

Modified:



BEGA 1000 BEGA Way, Carpinteria, CA 93013 (805) 684-0533 info@bega-us.com

Due to the dynamic nature of lighting products and the associated technologies, luminaire data on this sheet is subject to change at the discretion of BEGA North America. For the most current technical data, please refer to bega-us.com
© copyright BEGA 2018 Updated 08/02/18

420 MENDOCINO AVENUE | SANTA ROSA, CA



BOLLARD LIGHT

F10

270 CORAL CIRCLE | EL SEGUNDO, CALIFORNIA 90245 | TEL: 310.552.2191 | FAX: 310.552.2192

LineLED HE 48 Wet Tube

IP65 & IP68 rated Linear LED strip - 24V

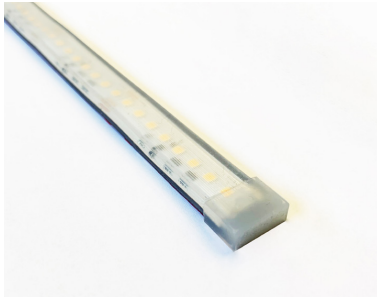

The High Efficacy (LLHE48) Wet Tube series is a small form factor high performance constant voltage LED strip. Designed to deliver best in class efficacy while operating at low temperature, LLHE48 Wet Tube delivers constant light output, outstanding color consistency and dimming performance without the need of an additional heat sink. Available in 3 different outputs with a tight LED pitch of 0.25", LLHE48 Wet Tube offers a clean dot free illumination in most luminii profiles when paired with our frosted lenses.

To maintain IP65, IP67, and IP68 rating, LLHE48 Wet Tube is factory sealed and bonded. Order in exact lengths required for install, LineLED Wet Tube is not field cuttable. IP rating of strip is equal to the lowest IP rating of section start and end options.

Mounting

LED strip is equipped with 3M™ VHB™ adhesive transfer tape.

Approvals

IP65, IP67, and IP68 rated

Operating Environment

Temperature
-30°C (-22°F) to 50°C (122°F)

Operating voltage

24 VDC

Lumen Maintenance:

Calculated L90 at 173,000 hours for High Output

Warranty

3 years



Applications: outdoor / wet location, above cabinet, cove lighting, counter accent, architectural accents, under banisters, decks, gazebos, barbeque stations and wet bars.

Technical information

MODEL	LO	SO	MO
LEDS/ft	48	48	48
Light output 3000K	231 lum/ft	330 lum/ft	441 lum/ft
Average power consumption (for 4' section)	1.9 W/ft	2.8 W/ft	3.5 W/ft
Ordering increment	1.97	1.97	1.97
Efficacy lum/watt	122 lm/W	118 lm/W	126 lm/W
Maximum run length (in series)	48 ft	42 ft	33ft
Dimensions	0.53"W x 0.24" H		

Color Temperature	Multiplier (referenced from 3000K)	CRI	R _f	R _g	R ₉
2700K	0.94	92	90	99	58
3000K	1.00	92	89	99	57
3500K	1.02	92	89	99	60
4000K	1.02	92	86	94	71

SECTION START/END OPTIONS

SL65

72" Soldered Leads, IP65 rated

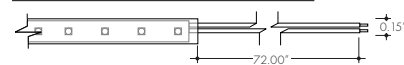

SL68

72" Soldered Leads, IP68 rated

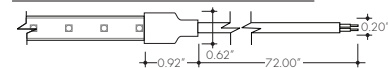

F

Female Quick Connect End, IP67 rated

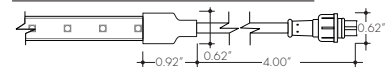

M

Male Quick Connect End, IP67 rated

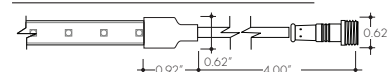

NC

No Connector



IP68 rated when used with SL68 selection

IP65 rated when used with SL65 selection
IP67 rated when used with M or F selection

Ordering code

MODEL	ENCLOSURE	OUTPUT ¹	CCT	SECTION START	SECTION END ²	LENGTH
LLHE48WET	T - Tube	LO - Low SO - Standard MO - Medium	27K - 2700K 30K - 3000K 35K - 3500K 40K - 4000K	SL65 - IP65 Soldered lead wires (72") SL68 - IP68 Soldered lead wires (72") F - IP67 Female Quick Connect M - IP67 Male Quick Connect NC - No Connector	SL65 - IP65 Soldered lead wires (72") SL68 - IP68 Soldered lead wires (72") F - IP67 Female Quick Connect M - IP67 Male Quick Connect NC - No Connector	2" increments

1 - All outputs and CCTs combination be used to comply with Title 24 JA8.

2 - IP rating of strip is equal to the lowest IP rating of section and start end options.

REV2.204262022

page 1 of 6

www.luminii.com

tel: 224-333-6033

420 MENDOCINO AVENUE | SANTA ROSA, CA



SURFACE MOUNTED LINEAR LIGHT IN PLANTER

F11

270 CORAL CIRCLE | EL SEGUNDO, CALIFORNIA 90245 | TEL: 310.552.2191 | FAX: 310.552.2192

Power consumption per linear foot - loads tested with PSD series

Accessories

Length of Strip (LF)	LLHE48WET					
	LO		SO		MO	
	W/ft	Total wattage	W/ft	Total wattage	W/ft	Total wattage
1	1.7	1.7	2.5	2.5	3.5	3.5
2	1.9	3.7	2.7	5.4	3.5	7.0
3	2.0	5.7	2.8	8.2	3.5	10.2
4	1.8	7.1	2.8	11.2	3.5	13.9
5	1.8	9.0	3.0	14.6	3.6	17.6
6	1.9	11.3	2.9	17.9	3.5	21.4
7	1.8	13.1	2.9	20.8	3.5	25.1
8	1.8	14.7	2.9	23.3	3.6	28.5
9	1.8	16.4	2.9	25.9	3.5	31.9
10	1.8	18.1	2.9	28.6	3.5	35.5
11	1.7	19.1	2.8	31.2	3.5	38.9
12	1.7	20.4	2.9	34.4	3.5	42.3
13	1.7	22.1	2.8	36.8	3.5	45.7
14	1.6	22.8	2.8	39.3	3.5	48.8
15	1.6	23.5	2.8	41.9	3.5	52.1
16	1.6	25.6	2.8	45.3	3.5	56.5
17	1.7	28.5	2.8	48.1	3.5	59.4
18	1.7	30.4	2.8	51.0	3.5	62.8
19	1.8	33.6	2.8	53.3	3.5	65.8
20	1.8	35.8	2.8	56.0	3.5	69.0
21	1.8	37.7	2.8	59.4	3.4	71.4
22	1.8	39.5	2.8	61.3	3.3	73.5
23	1.8	41.4	2.8	64.4	3.3	75.4
24	1.8	43.1	2.8	66.0	3.2	77.2
25	1.9	46.2	2.7	68.1	3.2	78.8
26	1.9	48.2	2.7	70.7	3.1	79.8
27	1.9	50.4	2.7	72.0	3.0	81.4
28	1.9	52.2	2.6	73.6	3.0	82.9
29	1.9	53.9	2.6	74.7	2.9	84.2
30	1.9	57.7	2.5	76.1	2.9	86.1
31	1.9	59.6	2.5	77.0	2.8	87.6
32	1.9	61.4	2.4	77.7	2.8	89.2
33	1.9	63.3	2.4	78.9	2.7	90.7
34	1.9	65.0	2.3	78.0		
35	1.9	65.4	2.2	78.1		
36	1.9	67.1	2.2	79.5		
37	1.9	69.3	2.2	80.4		
38	1.9	71.1	2.1	80.9		
39	1.9	73.0	2.1	81.0		
40	1.9	74.7	2.0	81.2		
41	1.9	76.0	2.0	82.6		
42	1.8	77.3	2.0	83.0		
43	1.8	78.6				
44	1.8	79.9				
45	1.8	81.1				
46	1.8	81.8				
47	1.8	82.5				
48	1.7	83.1				

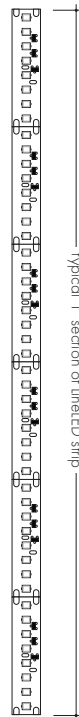

Mounting clip:
recommended at every 12" when
LineLED strip is facing down.

Part # CL-2

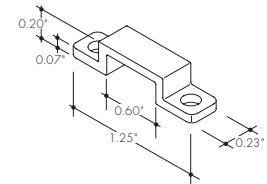

Splice Box:
Wet rated, low voltage
splice box, gray

Part # LVSP-WET

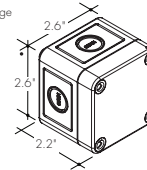

Connector:
Low voltage splice box wet cable
management gray

Part # LVSP-WET-CM

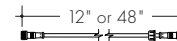

Male/Female Joiner:
Linking and extension cable in 12" or 48"

Part # IP68-12
IP68-48

Lens options / light transmission percentage per lens

C Clear	HF Half (50%) Frosted	G Graze	SI Satin Ice	S Square Frosted	Q Rounded Square Frosted
F Frosted	M Medium beam frosted	R Raised	C36 Clear 36° beam angle	C10 Clear 10° beam angle	

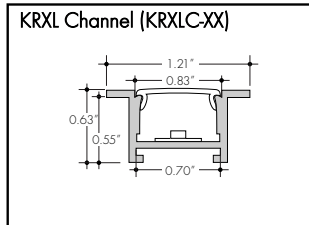

C	F	HF
74%	46%	61%

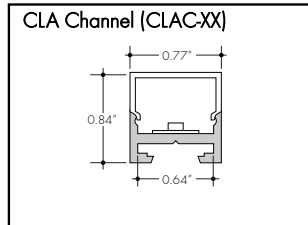

S	Q
62%	63%

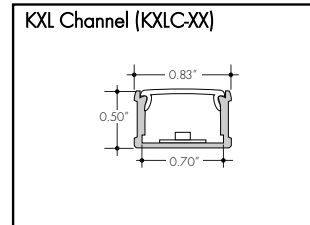

C	F	HF
74%	46%	61%

*Not compatible with IP68 connectors

Installation

All mounting channels are field cuttable using miter saw with circular blade suitable for cutting aluminum.

Ordering

Extrusions are sold separately. View respective specsheets for details on ordering extrusions and their accessories (endcaps, mounting brackets, etc).

Discontinued Extrusion Reference Link

<https://www.luminii.com/media/4351/extrusion-update-02.pdf>

LED Dotting per extrusion

using the frosted lens option

extrusion	LED Model
KXLC, KRXLC	ND
KLC, KRLC	ND
CLAC	ND

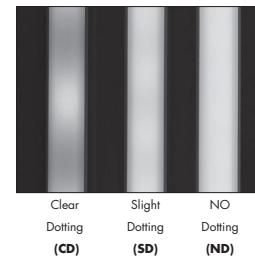

Power Supplies

See Power Supply instructions and spec sheet for wiring information. For a complete list of compatible dimmers, see Compatible Dimming Chart on the Resources page.

Universal Power Supply 1% 120VAC - 277VAC

MODEL	POWER	OUTPUT
PDCU-D - IP20 Dry Series	30 - 30 W 60 - 60 W 96 - 96 W 3X96 - 3X96 W	24 - 24 VDC
PDCU-W - IP66 Wet Series	96 - 96 W 3X96 - 3X96 W	

0-10V dims down to 1%, MLV/ELV/TRIAC dims down to 1%.
For a complete list of compatible dimmers, see [Compatible Dimming Chart](#) on the Resources page.

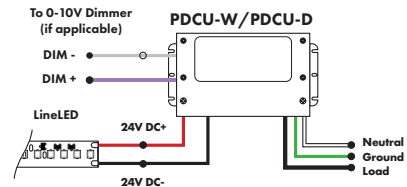

MODELS	PDCU-W 96W	PDCU-W 3X96W	PDCU-D 30W	PDCU-D 60W	PDCU-D 96W	PDCU-D 3X96W
Length	8.66"	11.85"	6.10"	7.93"	8.25"	9.57"
Width	3.73"	4.32"	3.35"	3.35"	4.10"	5.94"
Depth	1.61"	1.81"	1.33"	1.32"	1.56"	1.13"

0-10V Dimming Power Supplies 0.1% 120VAC - 277VAC

MODEL	POWER	OUTPUT	DIMMING
PS010V - 0-10V Power Supply dims down to 0.1%	96 - 96 Watt 3X96 - 3 X 96 Watt	24 - 24 VDC	LIN - Linear LOG - Logarithmic

MODELS	96W	3X96
Length	14.40"	15.75"
Width	5.20"	6.62"
Depth	2.60"	4.95"

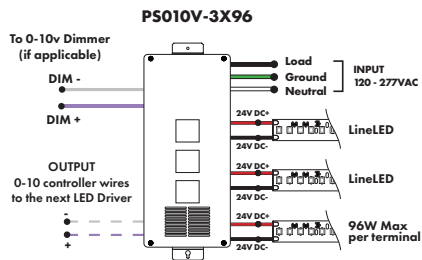
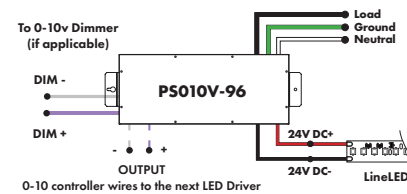

Triac, MLV, ELV, & PWM Compatible Dimmers

MODEL	POWER	OUTPUT
PDC - (IP20) Power Supply	96 - 96 Watts	24 - 24 VDC

MODELS	96W
Length	8.25"
Width	4.10"
Depth	1.56"

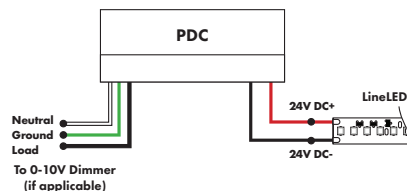

Power Supplies

See Power Supply instructions and spec sheet for wiring information. For a complete list of compatible dimmers, see Compatible Dimming Chart on the Resources page.

DMX Dimming Power Supplies 120VAC - 277VAC

MODEL	POWER	OUTPUT
PSDMX - DMX Power Supply dims down to 0%	96 - 96 Watt 3X96 - 3 X 96 Watt	24 - 24 VDC

Features eldoLED's LINEARdrive configurable dimmable drivers

MODELS	96W	3X96
Length	14.40"	15.75"
Width	5.20"	6.62"
Depth	2.60"	4.95"

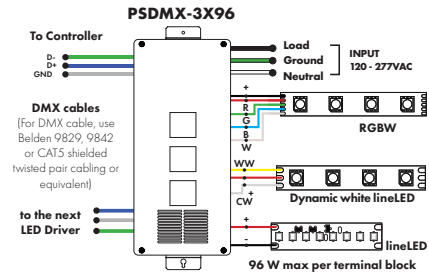
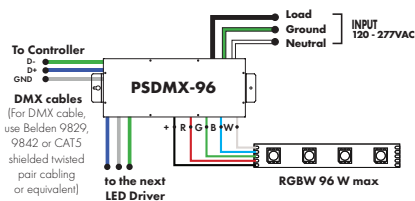

DALI 0% Dimming Power Supplies 120VAC - 277VAC

MODEL	POWER	OUTPUT
PSDALI - DALI Power Supply dims down to 0%	96 - 96 Watt 3X96 - 3 X 96 Watt	24 - 24 VDC

Features eldoLED's LINEARdrive configurable dimmable drivers

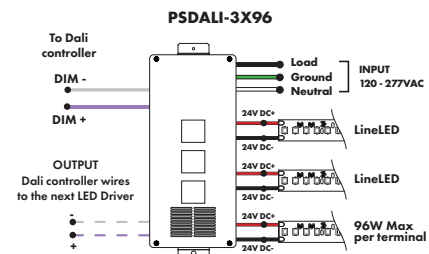
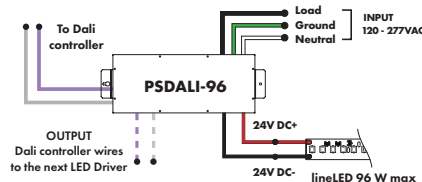

Enlighted Enabled Dimming Power Supplies 120VAC - 277VAC

MODEL	POWER	OUTPUT	DIMMING	LOCATION
PSV - PSV Series	96 - 96 Watt	24 - 24 VDC	ENL - Enlighted Dimming dims down to 0%	D - Damp

Model	96W
Length	14.40"
Width	5.20"
Depth	2.60"

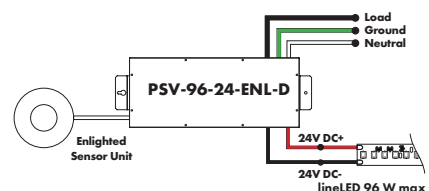

Power Supplies

See Power Supply instructions and spec sheet for wiring information. For a complete list of compatible dimmers, see Compatible Dimming Chart on the Resources page.

Non-Dimming Power Supply 120VAC - 277VAC

MODEL	POWER	OUTPUT	DIMMING	LOCATION
PSV - PSV Series	96 - 96 Watt	24 - 24 VDC	U2ND - Non Dimming	D - Damp

MODELS	96W
Length	14.40"
Width	5.20"
Depth	2.60"

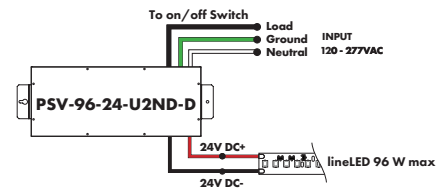

Luminii is a Lutron OEM Advantage Partner

Lutron Power Supplies 1%

MODEL	MODEL
LTEA4U1UKL-CV240	L3DA4U1UKL-CV240
Lutron - HiLume™ 1% 2-wire LED Driver 40W max	HiLume™ 1% EcoSystem Voltage LED driver 40W max
(120V forward phase only)	

MODELS	LTEA4U1UKL-CV240	L3DA4U1UKL-CV240
Length	4.89"	4.98"
Width	4.00"	4.00"
Depth	2.62"	2.62"

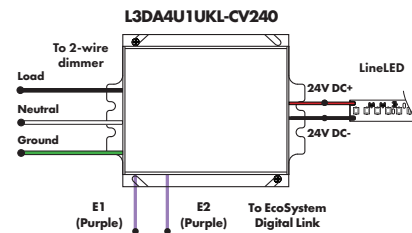
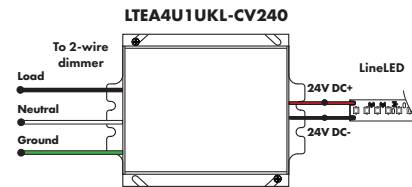

Luminii is a Lutron OEM Advantage Partner

Lutron Power Supplies 0.1%

MODEL
L3D0-96W24V-U
HiLume™ 0.1% EcoSystem Voltage LED Driver with Soft-On, Fade-to-Black™ 96W max

MODELS	L3D0
Length	10.50"
Width	5.50"
Depth	2.00"

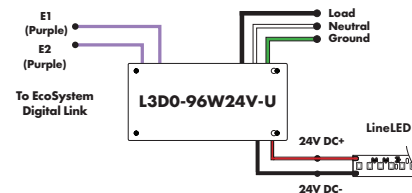

In-Ground Power Supplies

MODEL	POWER	OUTPUT	INPUT
IG - In ground CVE Series	CVE - ELV Dimming DALI - eldoLED Dali dimming	96X2 - 2 X 96 Watt	Blank - 120 V 277 - 240/277 V
Both dims down to 0%			

MODELS	Dual Circuit
Length	8.40"
Width	8.30"
Depth	8.10"

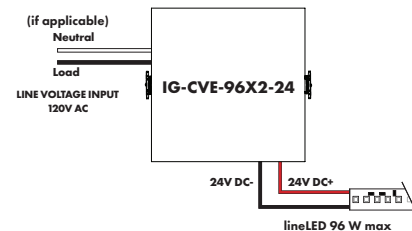

Tolomeo Mega Outdoor floor Spun white

TOU0102

SPECIFICATIONS



Design By

Michele De Lucchi
Giancarlo Piretti

Collection

Outdoor



Colors & Finishes

- White (Diffuser)
- Aluminum (Body & Base)

Materials

- Base and body in aluminum
- Diffuser in Paola Lenti Thua outdoor fabric

Specifications

Delivered lumens	1735lm
Light output ratio	87lm/W
Power consumption	23W
Led type	20W C.O.B.*
CCT (Correlated Color Temperature)	3000K
CRI (Color Rendering Index)	>90
Life expectancy	50000Hrs
Control type	Dimmable 2-Wire
Input Voltage	120V
Driver	N/A
BUG Rating	B0-U0-G0

Features & Accessories

- Structural elements of Tolomeo floor reinforced for outdoor use
- Lighting source fitted inside a transparent IP65 plastic unit that recalls old lanterns
- 5 meters cord length

Dimensions

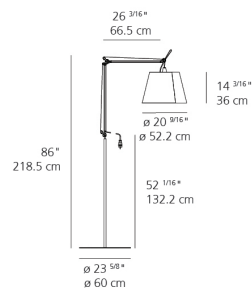

Packaging

4 Boxes

- 1 x 42-5/8" x 16-5/8" x 9-9/16" / 9.15 lbs - 108 cm x 42 cm x 24 cm / 4.15 kg
- 1 x 21-3/4" x 21-3/4" x 15-13/16" / 5.29 lbs - 55 cm x 55 cm x 40 cm / 2.4 kg
- 1 x 28" x 28" x 4-13/16" / 34.39 lbs - 71 cm x 71 cm x 12 cm / 15.6 kg
- 1 x 50-7/8" x 1-11/16" x 1-11/16" / 3.31 lbs - 129 cm x 4 cm x 4 cm / 1.5 kg

Light distribution

Diffused

Luminaire weight

45.64 lbs / 20.7 kg

Warranty

last updated: 2022-04-30

We reserve the right to change specifications of our products.
For the latest product information please visit www.artemide.net

Artemide

420 MENDOCINO AVENUE | SANTA ROSA, CA



OUTDOOR FLOOR LAMP

F12

270 CORAL CIRCLE | EL SEGUNDO, CALIFORNIA 90245 | TEL: 310.552.2191 | FAX: 310.552.2192