



Parcels and existing building layouts



Malm Fireplace and Magic Motors



Street View of Magic Motors and Malm Fireplaces



New Proposed Malm Building and Retail Building



Proposed Site Plan

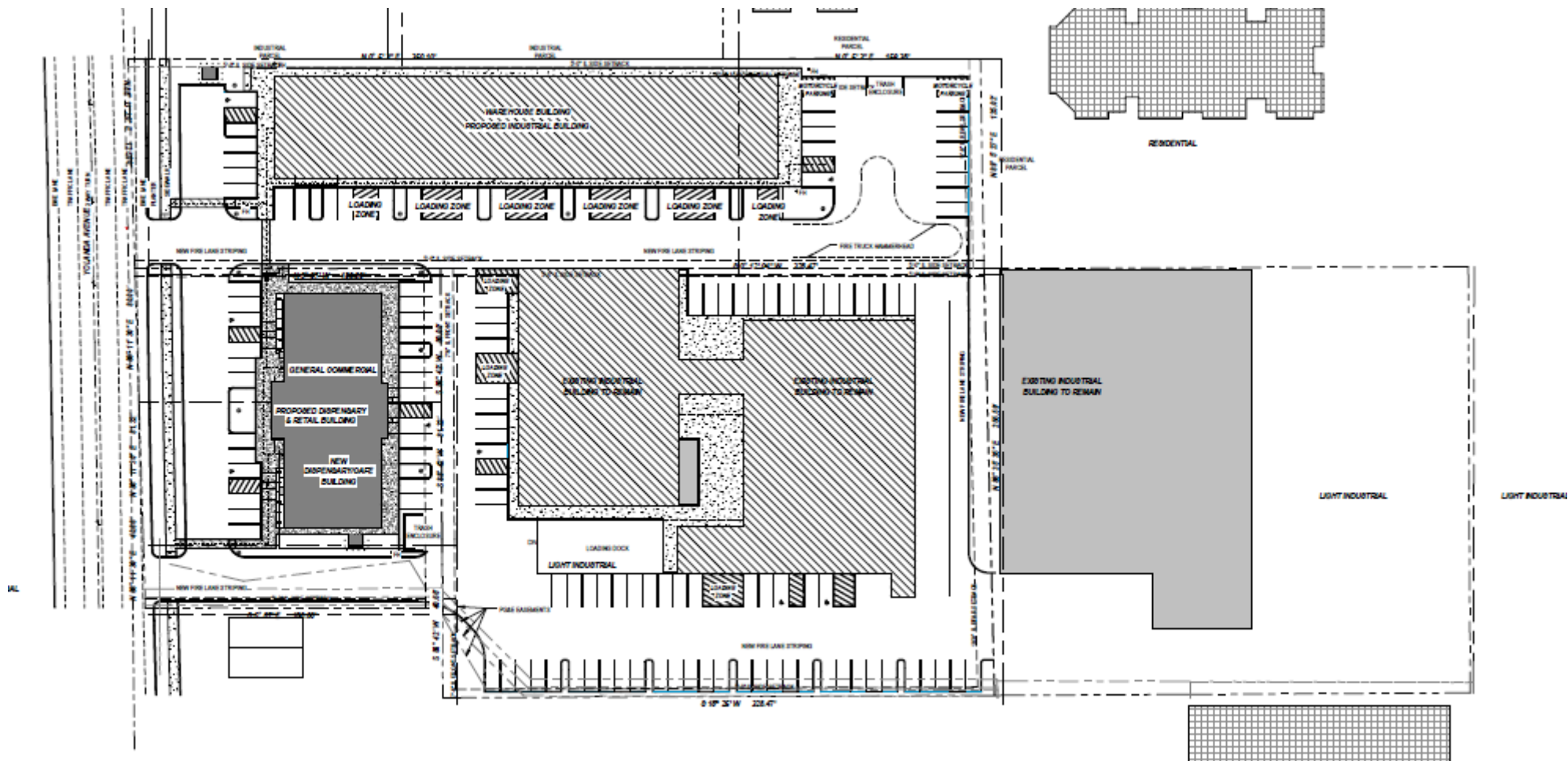

CEQA Summary:

- Edd Clark & Associates, Inc. (EC&A) conducted an Initial Study, which resulted in a Mitigated Negative Declaration per California Environmental Quality Act (CEQA) guidelines for Yolanda Avenue Industrial Project.

- Environmental factors requiring mitigation:

Air Quality	Cultural Resources
Geology & Soils	Greenhouse Gas Emissions
Hazard & Hazardous Materials	Noise
Tribal Cultural Resources	Mandatory Finding of Significance

- Potentially significant environmental impacts would be less than significant with the implementation of the Mitigation Measures presented in the Mitigation Monitoring & Reporting Program. If adopted, no significant negative environmental impacts will be caused by this project.