

EXISTING CITY BOUNDARY AS ESTABLISHED BY MONTECITO ANNEXATION NO. 15, CITY ORDINANCE NO. 1330, FILED IN BOOK 124 OF MAPS AT PAGE 49 SCR ON APRIL 18, 1968

LEGEND
 SCR SONOMA COUNTY RECORDS

NOTE
 THE BEARINGS AND DISTANCES SHOWN ON THIS MAP ARE FOR INFORMATIONAL PURPOSES ONLY AND ARE NOT INTENDED TO AFFECT THE BOUNDARIES OF THIS REORGANIZATION.

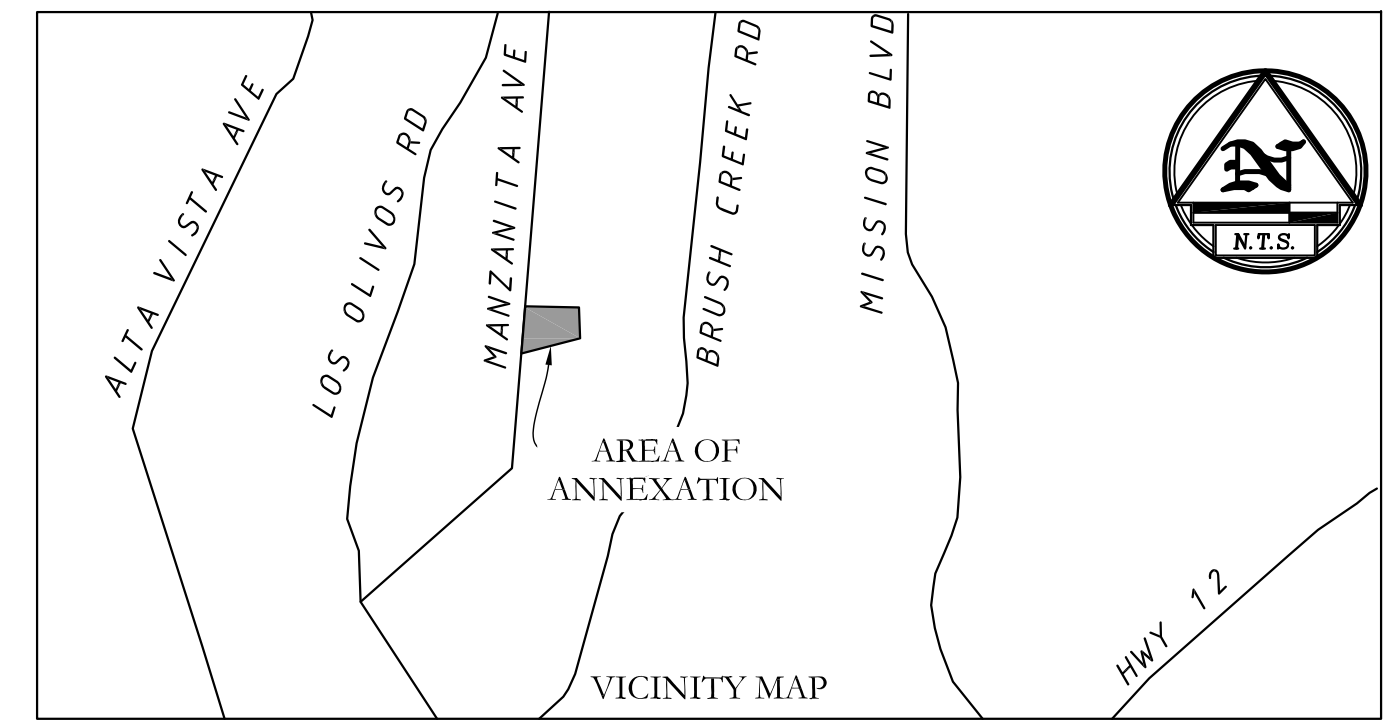

SENN
 2015-027729
 APN 181-030-007
 1610 MANZANITA AVENUE

COUNTY

HORTON
 2021-083818
 APN 181-030-006
 1333 BRUSH CREEK ROAD

COUNTY

WINKLER & DANZICA
 2021-107266
 APN 181-030-005
 1600 MANZANITA AVENUE

STERBA TRUST
 2020-123710
 APN 181-030-014
 1592 MANZANITA AVENUE

EXISTING CITY BOUNDARY AS ESTABLISHED BY NORTH EAST SANTA ROSA REORGANIZATION NO. 4-89 RESOLUTION NO. 2290 JUNE 5 1997 IN BOOK 566 OF MAPS PAGE 37. SCR

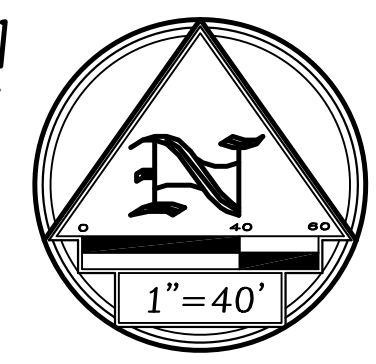

CITY ENGINEER'S STATEMENT

I, _____, City Engineer for the City Of Santa Rosa, hereby certify that the map hereon shown conforms to the requirements of Title 4, Division 1 Chapter 1, Article 3, of the Government Code of the State of California and to the description of the reorganization as adopted by Sonoma LAFCO in Resolution No. _____ dated _____

By: _____ Date: _____
 name, title, license number

Deputy _____

SURVEYOR'S STATEMENT

THIS MAP CORRECTLY REPRESENTS A SURVEY MADE BY ME OR UNDER MY DIRECTION IN CONFORMANCE WITH THE REQUIREMENTS OF THE PROFESSIONAL LAND SURVEYORS' ACT AT THE REQUEST OF WINKLER IN SEPTEMBER, 2022

DATED: _____
 RAY C. CARLSON
 PLS 3890



CITY OF SANTA ROSA
 SONOMA COUNTY
NORTHEAST SANTA ROSA REORGANIZATION NO.
 (WINKLER & D'ANZICA)

INVOLVING ANNEXATION TO THE CITY OF SANTA ROSA AND DETACHMENT FROM THE RINCON VALLEY FIRE PROTECTION DISTRICT.

IN RANCHO CABEZA DE SANTA ROSA

CITY OF SANTA ROSA
 COUNTY OF SONOMA STATE OF CALIFORNIA

COUNTY

LAFCO

Approved by Sonoma Local Agency Formation Commission Resolution No. dated _____
 By: _____ Date: _____
 Executive Officer

RECORDER'S STATEMENT

RECORDED AT THE REQUEST OF THE EXECUTIVE OFFICER OF THE SONOMA LOCAL AGENCY FORMATION COMMISSION, THIS _____ DAY, 20____, IN BOOK _____ OF MAPS, AT PAGE _____, SONOMA COUNTY RECORDS

 COUNTY RECORDER

 DEPUTY



RAY CARLSON
 AND ASSOCIATES, INC.
 Mapping for a Better World™

SURVEYING • MAPPING • GIS • CONSULTING
 411 RUSSELL AVENUE SANTA ROSA, CALIFORNIA 95403
 (707) 528-7649 • RCMAPS.COM
 ©2022, Ray Carlson and Associates, Inc.

Exhibit "A"

Beginning at the southwest corner of the lands of Winkler and D'Anzica as described in Document Number 2021-107266 recorded in Sonoma County Records, also being the northwest corner of the Northeast Santa Rosa Reorganization No. 4-89 per Resolution No. 2290 approved June 5, 1997 and filed in Book 566 of Maps, at Page 37 of Sonoma County Records; thence along the southerly boundary of the said lands of Winkler and D'Anzica and being the northerly boundary of the said annexation, North 77 degrees 33 minutes 18 seconds East, 276.01 feet to the southeasterly corner of the said lands of Winkler and D'Anzica; thence along the easterly boundary of the said lands of Winkler and D'Anzica and along the new annexation boundary line North 04 degrees 07 minutes 00 seconds East, 209.73 feet to the northeasterly corner of said Winkler and D'Anzica lands; thence continuing along said lands of Winkler and D'Anzica North 85 degrees 22 minutes 10 minutes West, 264.51 feet to the east right of line of Manzanita Avenue and the existing City boundary per Montecito Annexation No. 15, City Ordinance No.1330, filed in Book 124 of Maps, Page 49, filed April 18, 1968 in Sonoma County Records; thence along the east right of way and the existing city boundary South 04 degrees 07 minutes 00 seconds West, 290.94 feet to the point of beginning.

Containing 1.52 acres

Winkler
Job 2022-019
APN 181-030-005
September 23, 2022