

**SECTION A-A'**  
NOT TO SCALE

MATCHLINE - SEE SHEET C1.1 FOR CONTINUATION

**PRELIMINARY GRADING PLAN**

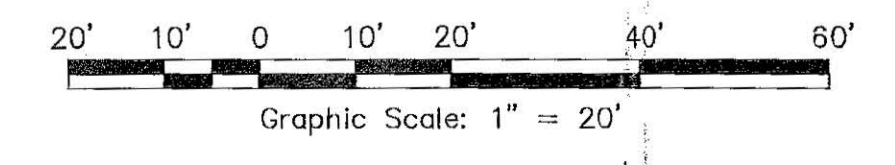

**HATCHING LEGEND:**

	AC OVER CL II AB
	HARDSCAPE (SLD)

City of Santa Rosa  
NOV - 1 2017  
Planning & Economic Development Department

No.	Date	Description	Approved

**adobe associates, inc.**  
civil engineering / land surveying / wastewater  
1220 N. Dutton Ave., Santa Rosa, CA 95401  
P. (707) 541-2300 F. (707) 541-2301  
Website: www.adobeinc.com  
"A Service You Can Count On!"

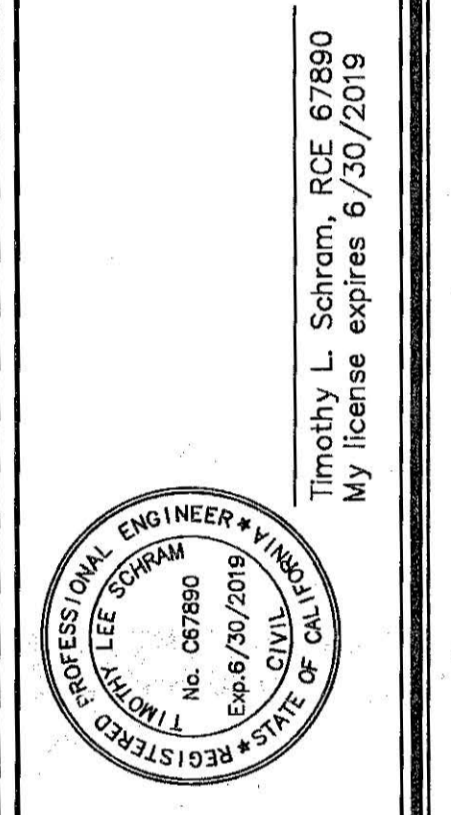

**RESIDENCE INN  
SANTA ROSA BY MARRIOTT  
PRELIMINARY GRADING PLAN**  
3558 Round Barn Circle  
Santa Rosa, California  
APN 173-023-008

SCALE: AS NOTED  
Date: OCT 30, 2017  
Design by: GRN  
Drawn by: GRN, LSC  
Checked by: TLS  
Sheet  
**C1.0**  
1 of 2 Sheets  
Job 16142

T:\2016 PROJECTS\16142\Drawings\Grading-Design\Design Review\16142-C1.0 - Preliminary Grading Plan.dwg, Casey McDonald, 10/30/2017 11:36:42 PM

E:\2016 PROJECTS\16142\dwg\Adobe-Design\Design Review\16142-C1.0\_Preliminary Grading Plan.dwg, Casey, McDonald, 10/20/2017 1:36:48 PM

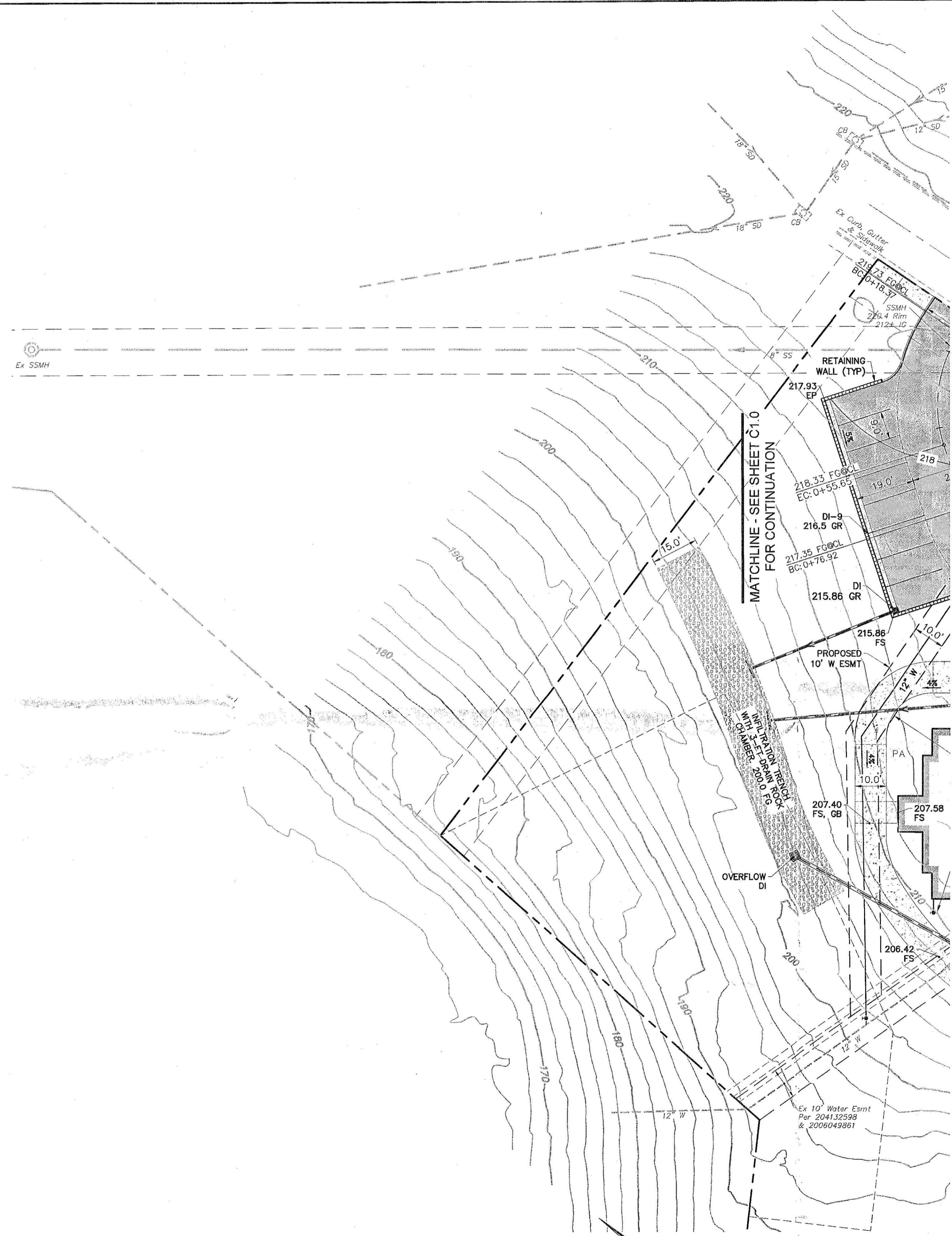

**PRELIMINARY GRADING PLAN**

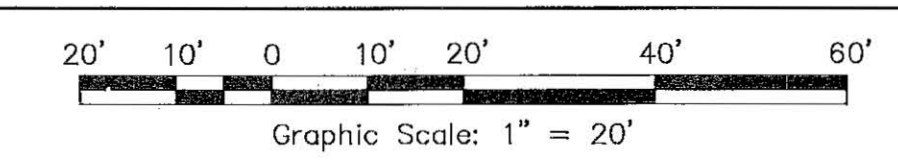

**HATCHING LEGEND:**

[Hatched Pattern]	AC OVER CL II AB
[Dotted Pattern]	HARDSCAPE (SLD)

SCALE: AS NOTED  
 Date: OCT 30, 2017  
 Design by: [Signature]  
 Drawn by: [Signature]  
 Checked by: [Signature]

**RESIDENCE INN  
 SANTA ROSA BY MARRIOTT  
 PRELIMINARY GRADING PLAN**

3558 Round Barn Circle  
 Santa Rosa, California  
 APN 173-023-008

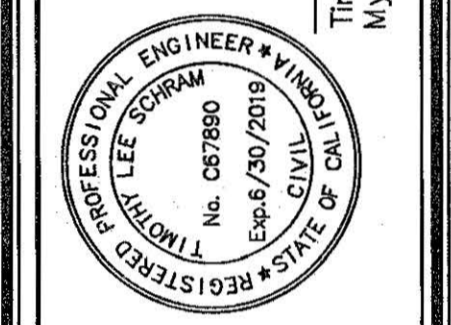

Timothy L. Schram, RCE 67890  
 My license expires 6/30/2019

**adobe associates, inc.**  
 civil engineering | land surveying | wastewater  
 1220 N. Dutton Ave., Santa Rosa, CA 95401  
 P. (707) 541-2300 F. (707) 541-2301  
 Website: www.adobeinc.com  
 "A Services You Can Count On!"

**Revisions**

No.	Date	Description	Approved

Sheet  
**C1.1**  
 1 of 2 Sheets  
 Job 16142