**Juilliard Park Master Plan Amendment
and
Church of One Tree Site
Adding a Fence**

November 18, 2014

Nanette Smejkal
Director, Recreation and Parks

Kelley Magnuson
Deputy Director of Recreation

Objectives & Benefits

- Increase use of the Church of One Tree
- Protect the building
- Incorporate redwoods within Church of One Tree setting

Vicinity Map

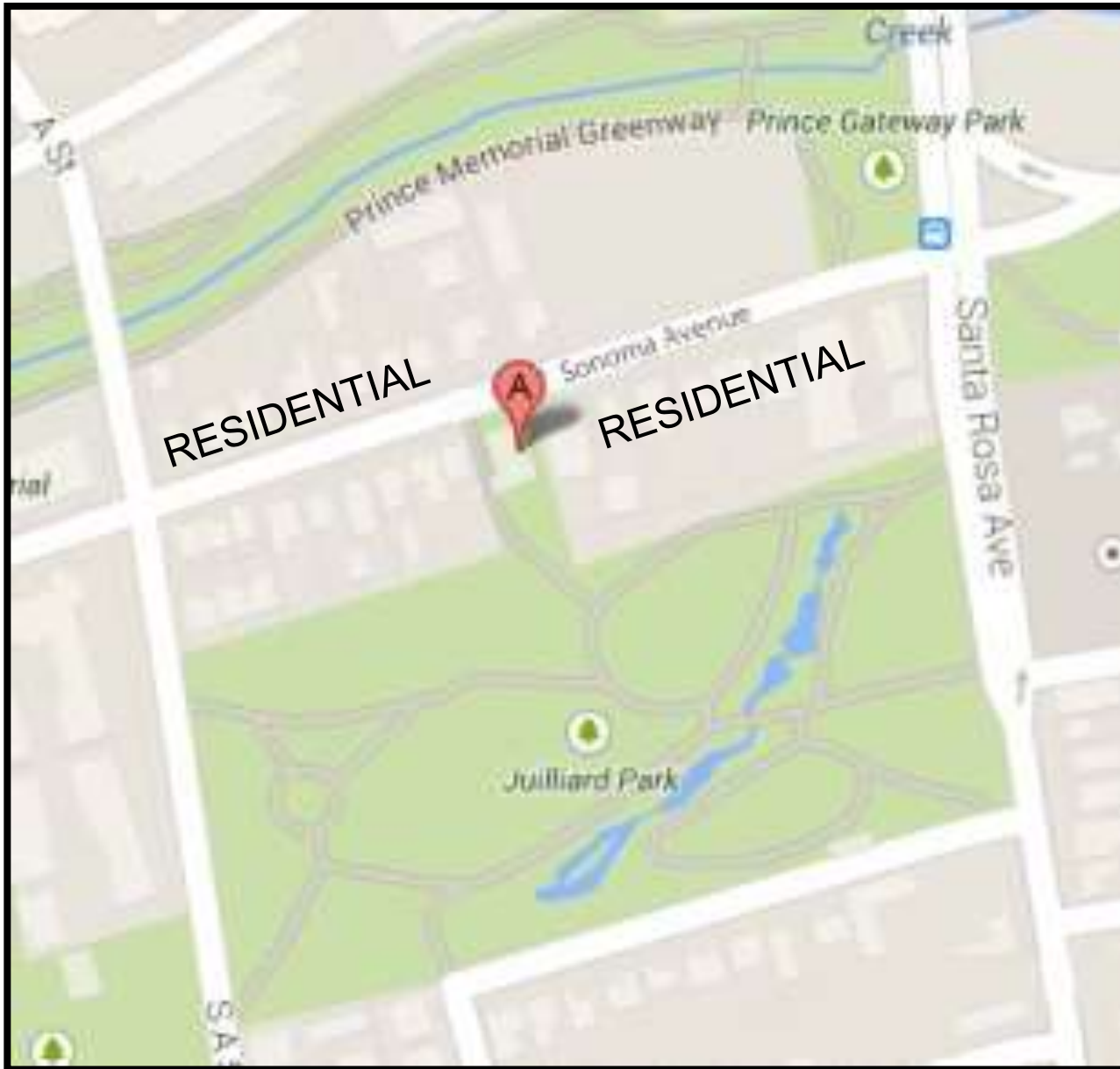

Current Juilliard Park Master Plan

JUILLIARD PARK

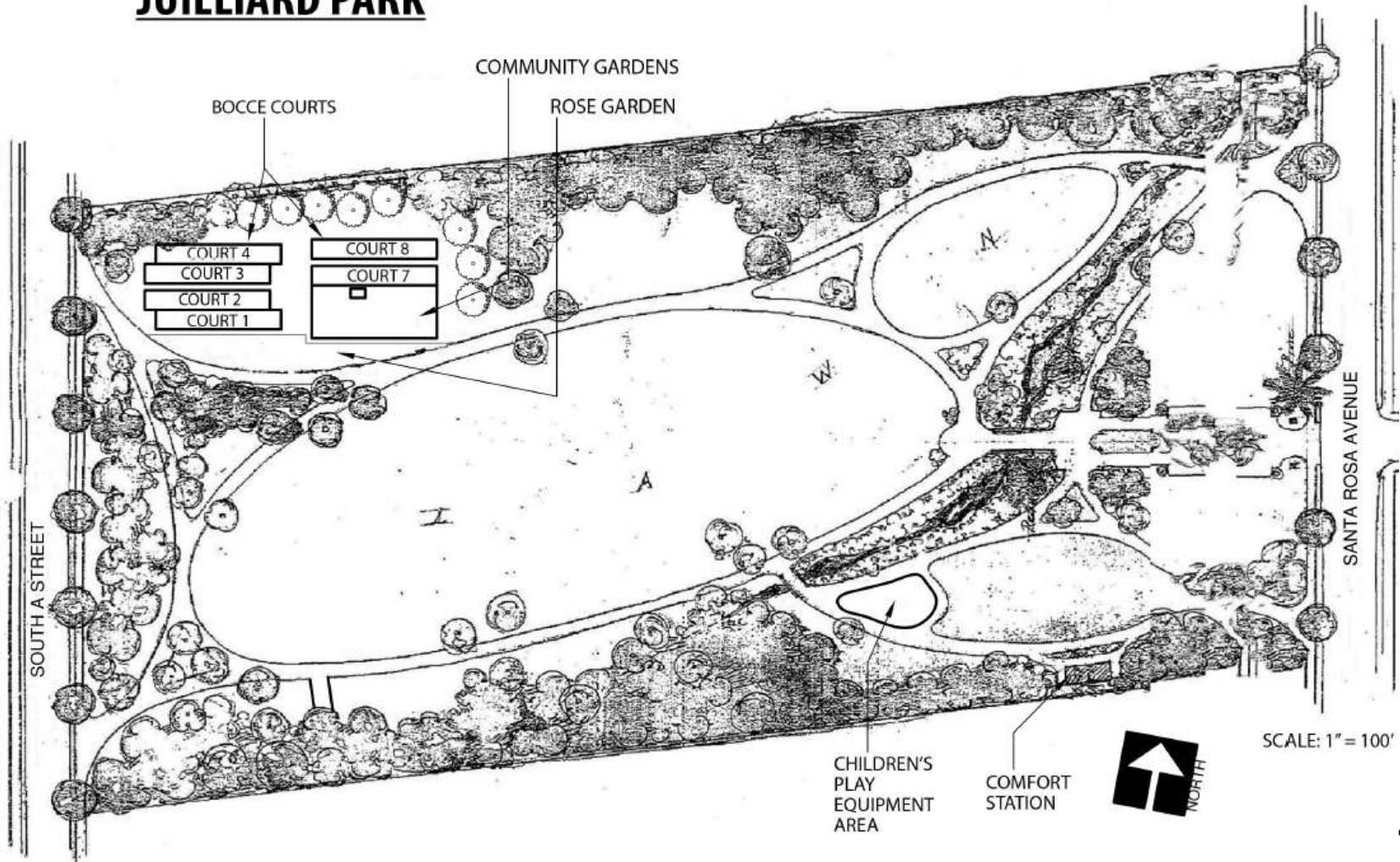

Proposed Juilliard Park Master Plan

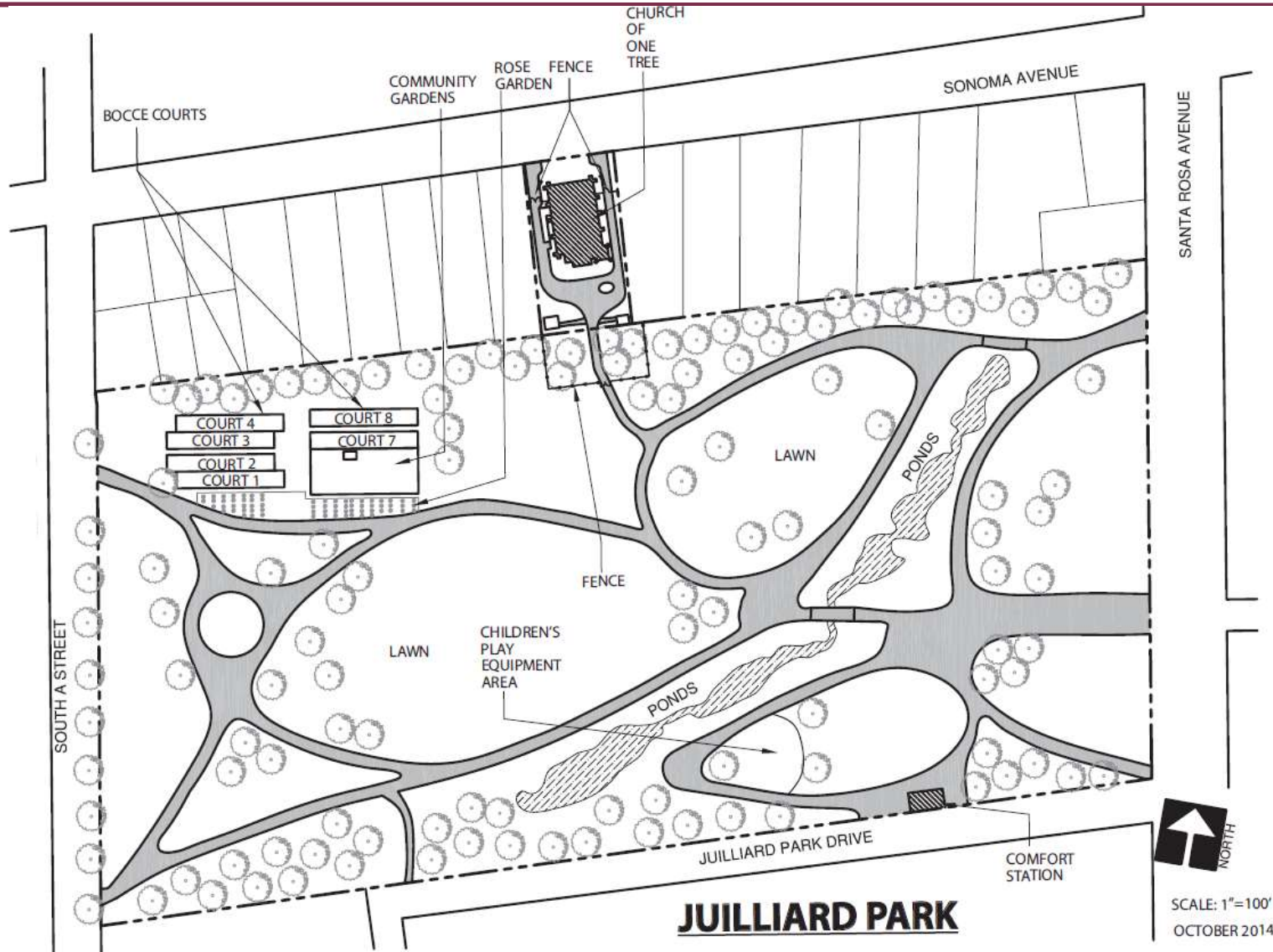

Conceptual Plan Viewed from Juilliard Park



Conceptual Plan Viewed from Sonoma Avenue



Recommendation

- Board of Community Services July 23, 2014
 - Recommend approval to install fence
- Cultural Heritage Board November 5, 2014
 - Recommended approval of fence design