

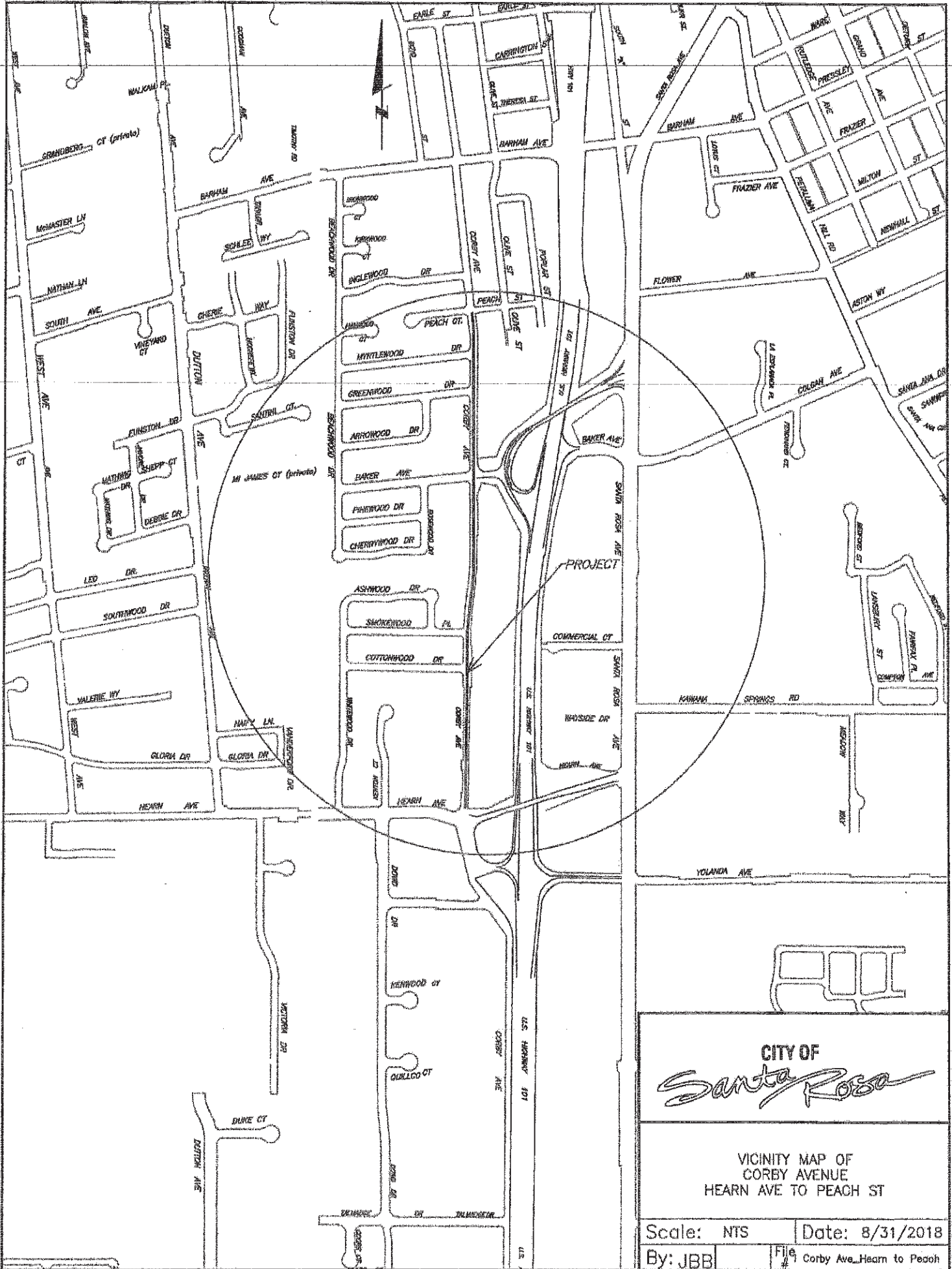

ATTACHMENT 1



CITY OF
Santa Rosa

VICINITY MAP OF
 CORBY AVENUE
 HEARN AVE TO PEACH ST

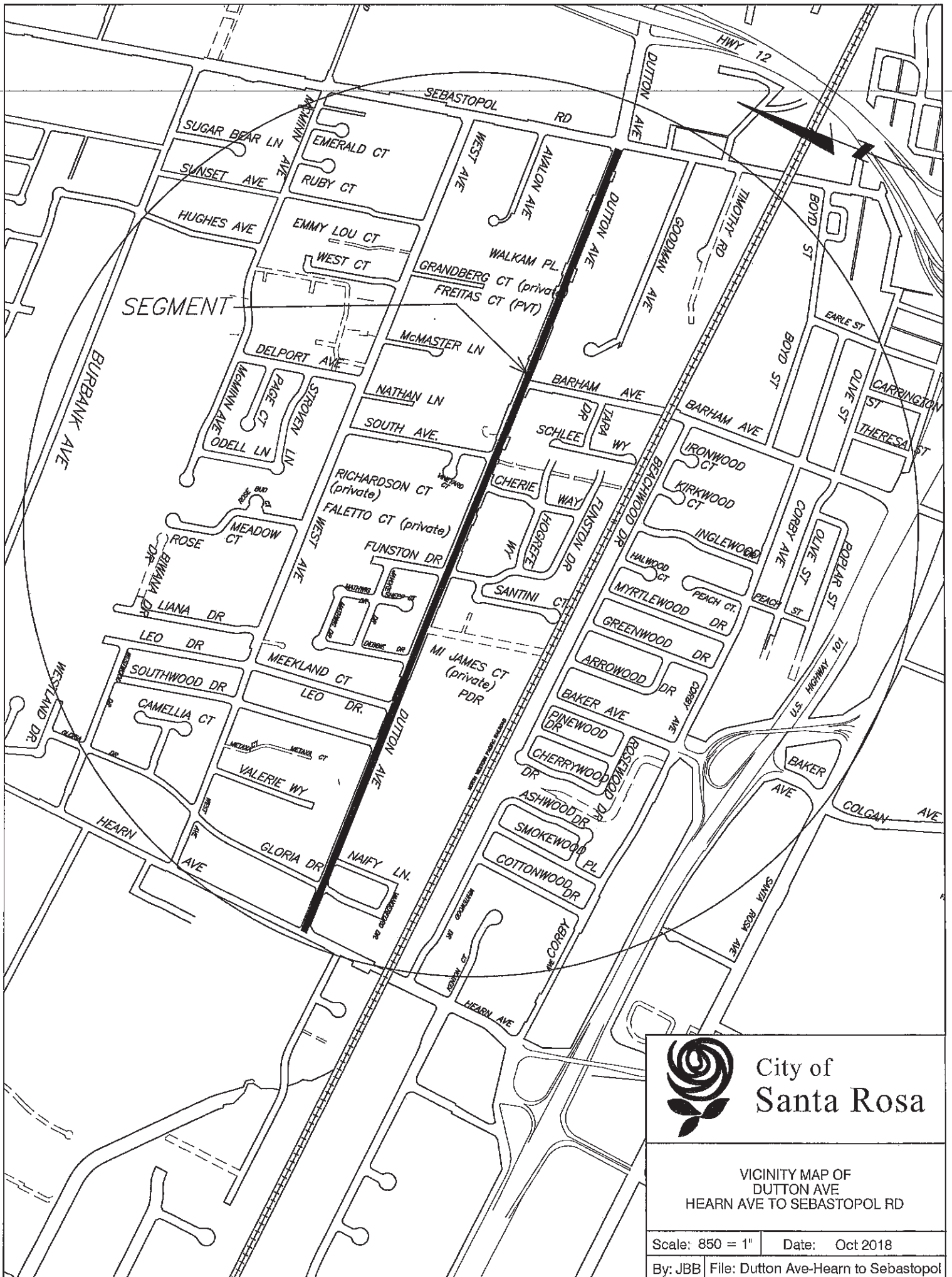
Scale: NTS	Date: 8/31/2018
By: JBB	File # Corby Ave_Hearn to Peach





City of
Santa Rosa

VICINITY MAP OF
DUTTON AVE
HEARN AVE TO SEBASTOPOL RD

Scale: 850 = 1" Date: Oct 2018

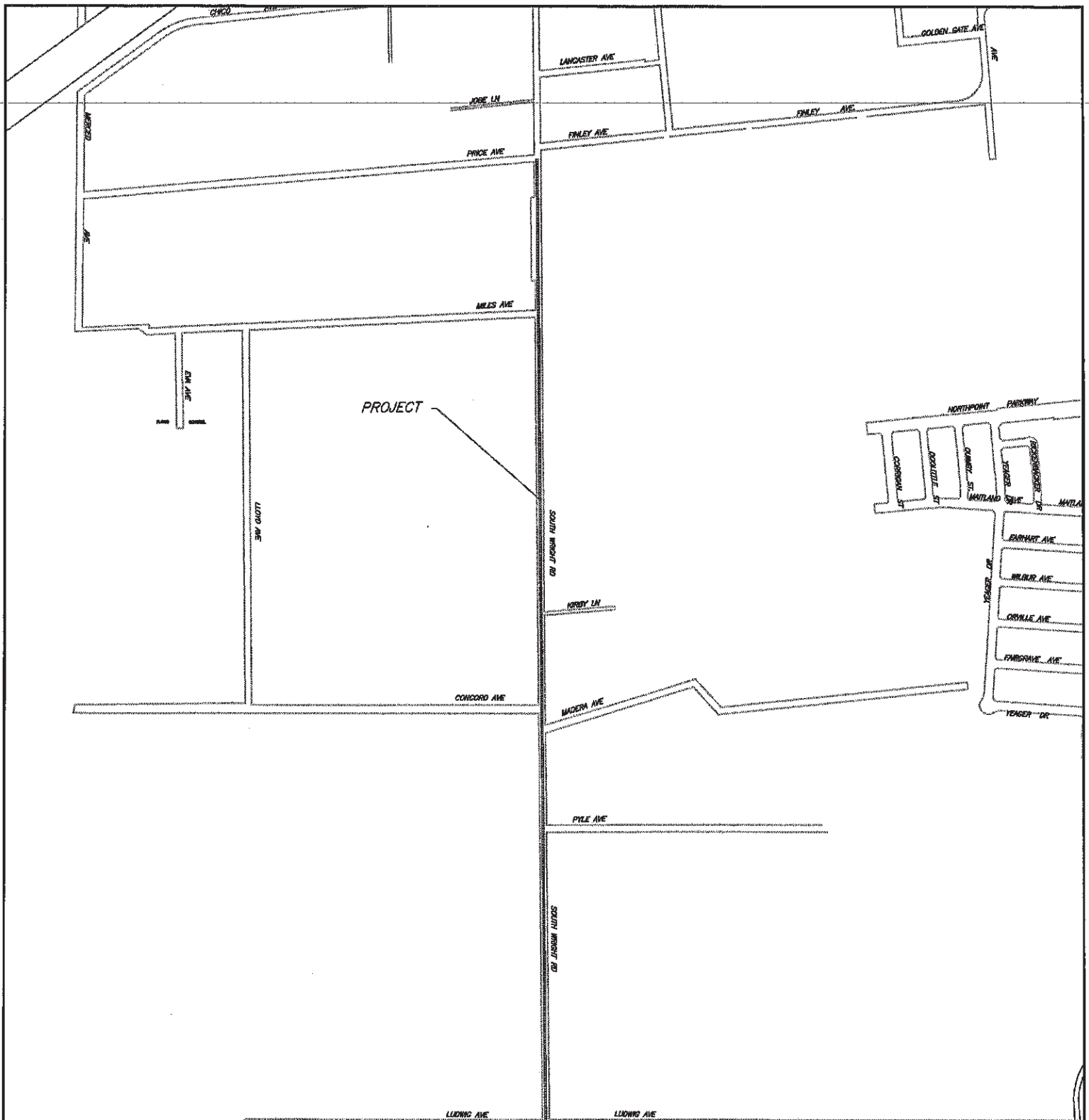
By: JBB File: Dutton Ave-Hearn to Sebastopol



City of
Santa Rosa

VICINITY MAP OF
SOUTH WRIGHT ROAD
FROM
LUDWIG AVENUE TO PRICE AVENUE

Scale: NTS	Date: JULY 2018
By: SE	File: S Wright_Ludwig-Price

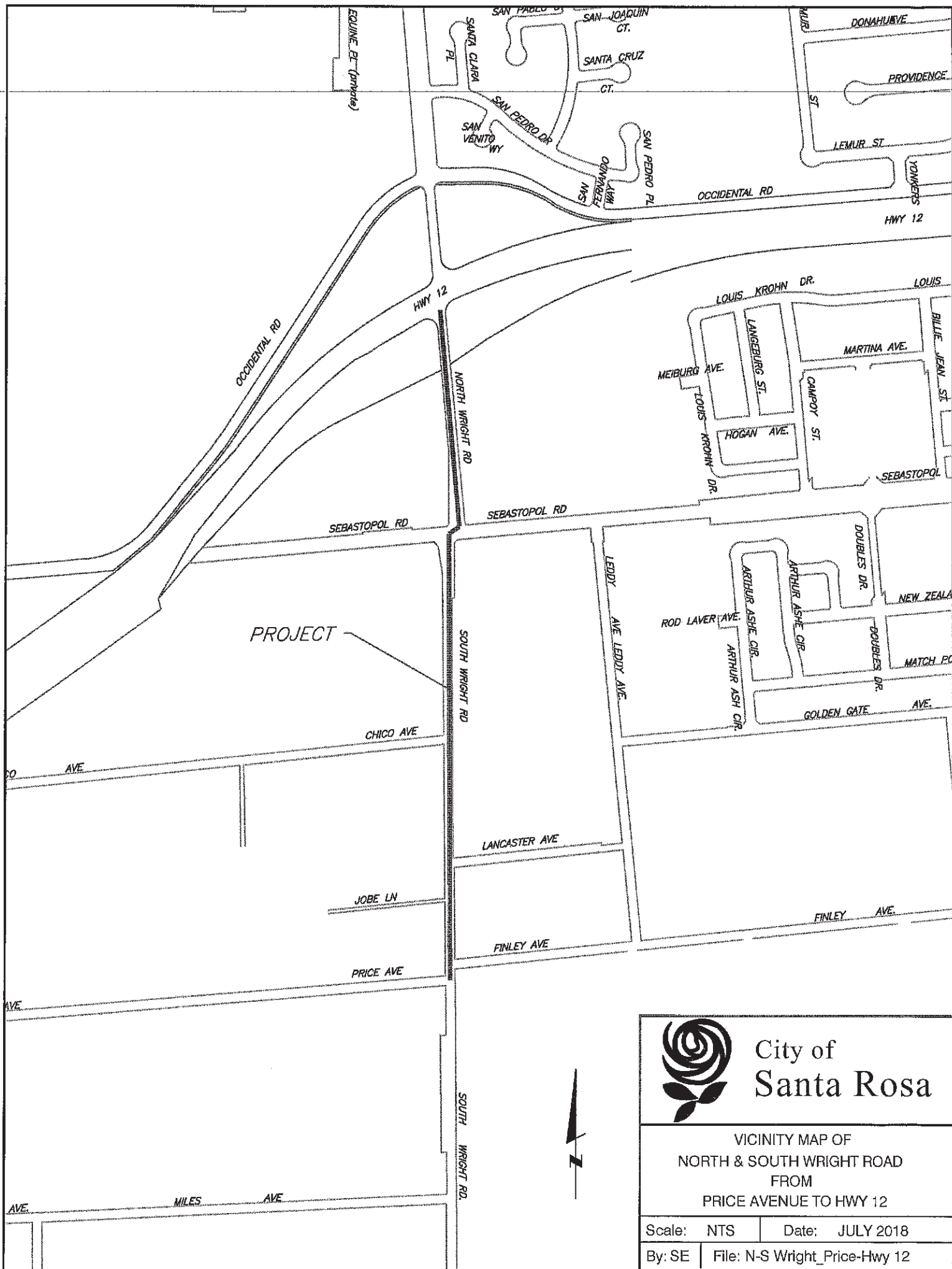



City of Santa Rosa

VICINITY MAP OF
NORTH & SOUTH WRIGHT ROAD
FROM
PRICE AVENUE TO HWY 12

Scale: NTS	Date: JULY 2018
By: SE	File: N-S Wright_Price-Hwy 12

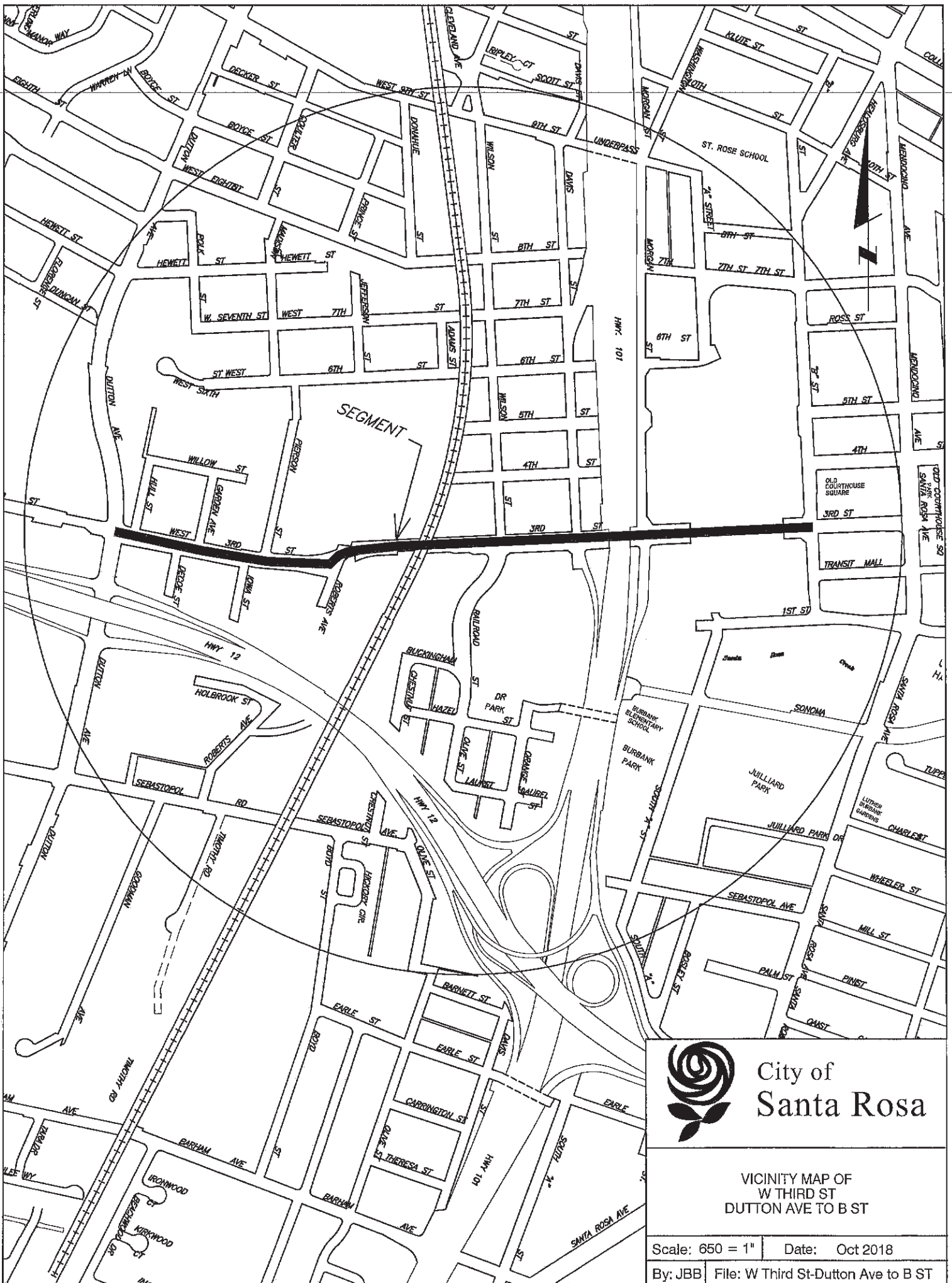

City of
Santa Rosa

VICINITY MAP OF
W THIRD ST
DUTTON AVE TO B ST

Scale: 650 = 1" Date: Oct 2018
By: JBB File: W Third St-Dutton Ave to B ST



City of
Santa Rosa

VICINITY MAP OF
THIRD ST
E STREET TO MONTGOMERY DR

Scale: 850 = 1" Date: Oct 2018
By: JBB File: Third St-E St to Montgomery Dr

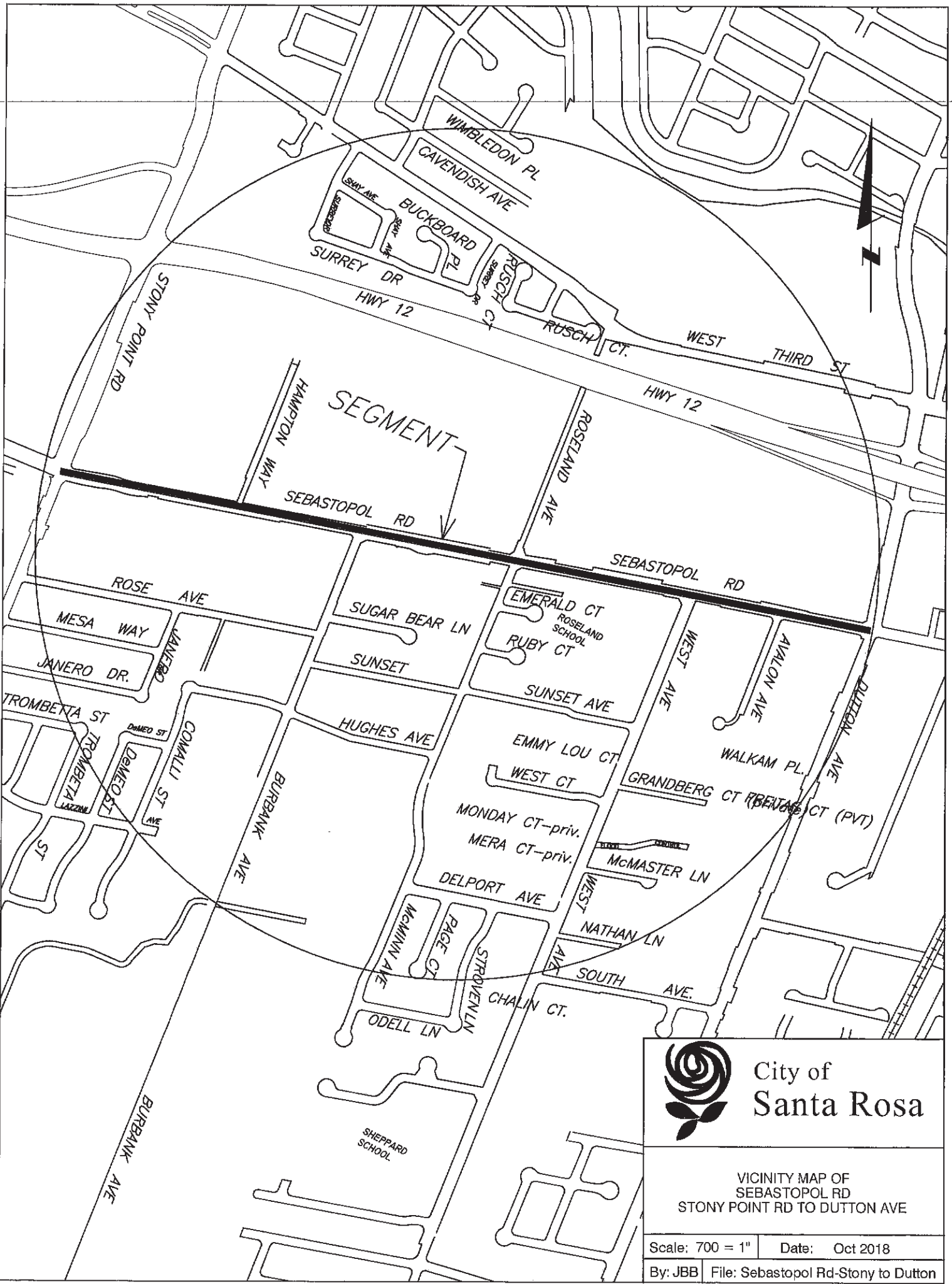

City of
Santa Rosa

VICINITY MAP OF
SEBASTOPOL RD
STONY POINT RD TO DUTTON AVE

Scale: 700 = 1" Date: Oct 2018

By: JBB File: Sebastopol Rd-Stony to Dutton

SEGMENT

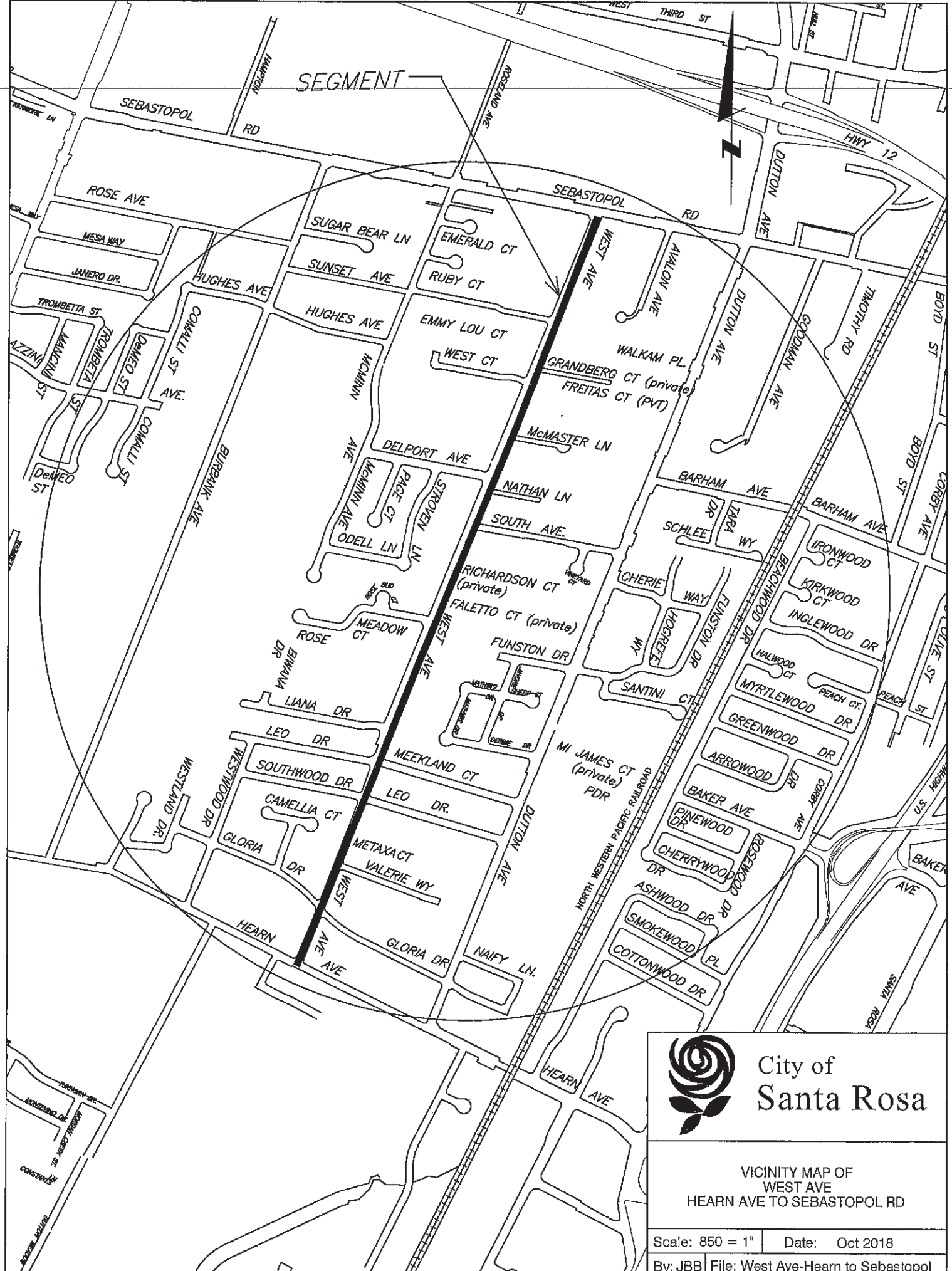

City of
Santa Rosa

VICINITY MAP OF
WEST AVE
HEARN AVE TO SEBASTOPOL RD

Scale: 850 = 1" Date: Oct 2018

By: JBB File: West Ave-Hearn to Sebastopol