

SECTION A-A'
NOT TO SCALE

ROUND BARN CIRCLE

PRELIMINARY GRADING PLAN

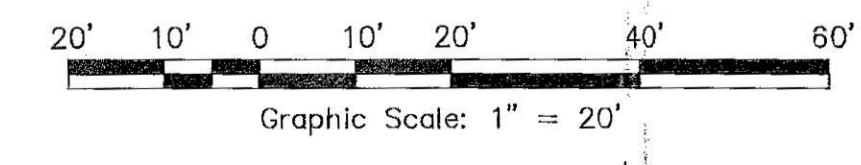

HATCHING LEGEND:

[Hatched Pattern]	AC OVER CL II AB
[Dotted Pattern]	HARDSCAPE (SLD)

City of Santa Rosa
NOV - 1 2017
Planning & Economic Development Department

No.	Date	Description	Approved

adobe associates, inc.
civil engineering / land surveying / wastewater
1220 N. Dutton Ave., Santa Rosa, CA 95401
P. (707) 541-2300 F. (707) 541-2301
Website: www.adobeinc.com
"A Service You Can Count On!"

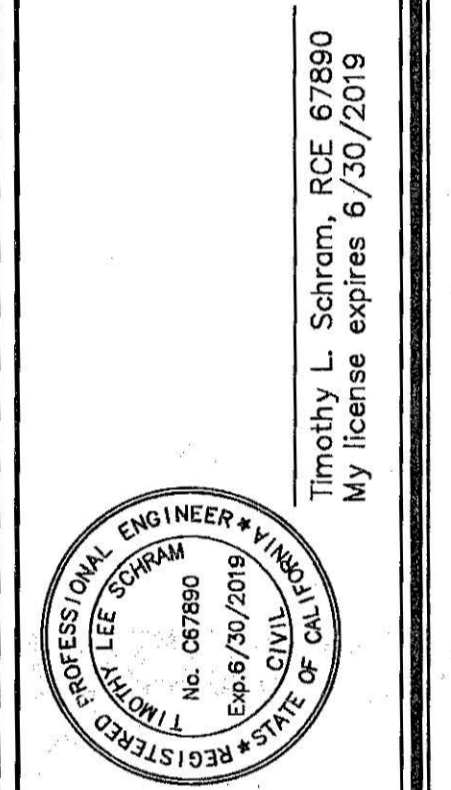

**RESIDENCE INN
SANTA ROSA BY MARRIOTT
PRELIMINARY GRADING PLAN**
3558 Round Barn Circle
Santa Rosa, California
APN 173-023-008

SCALE: AS NOTED
Date: OCT 30, 2017
Design by: [Signature]
Drawn by: [Signature]
Checked by: T.L.S.
Sheet
C1.0
1 of 2 Sheets
Job 16142

T:\2016 PROJECTS\16142\Drawings\Grading-Design\Design Review\16142-C1.0_Preliminary Grading Plan.dwg, Casey McDonald, 10/30/2017 11:36:42 PM

E:\2016 PROJECTS\16142\dwg\Adobe-Design\Design Review\16142-C1.0_Preliminary Grading Plan.dwg, Casey, McDonald, 10/20/2017 1:36:48 PM

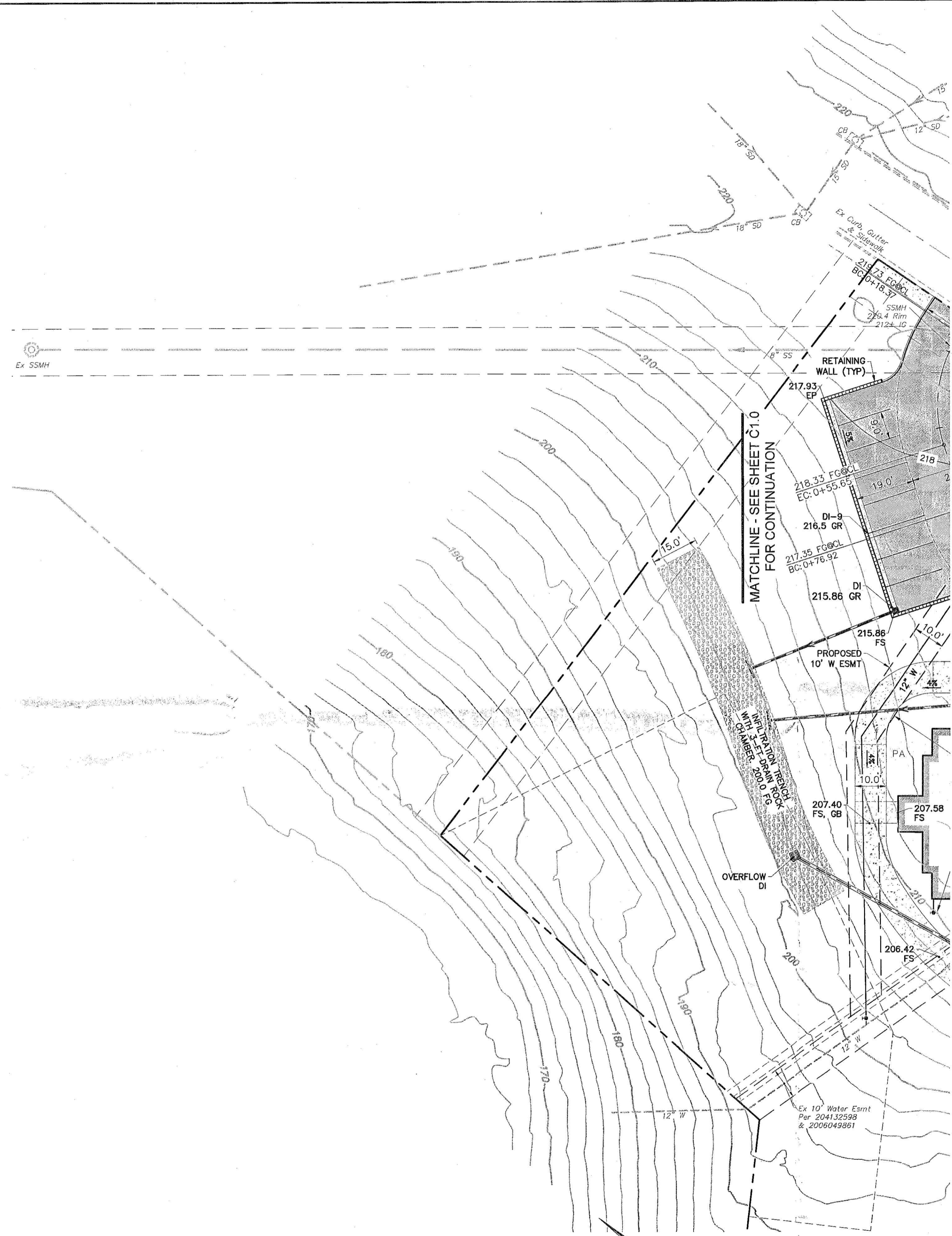

PRELIMINARY GRADING PLAN

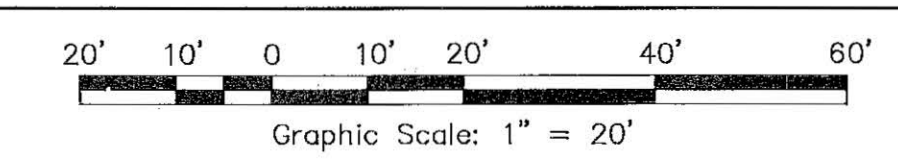

HATCHING LEGEND:

[Stippled Pattern]	HARDSCAPE (SLD)
[Diagonal Hatching]	AC OVER CL II AB

SCALE: AS NOTED
 Date: OCT 30, 2017
 Design by: [Signature]
 Drawn by: [Signature]
 Checked by: [Signature]

**RESIDENCE INN
 SANTA ROSA BY MARRIOTT
 PRELIMINARY GRADING PLAN**
 3558 Round Barn Circle
 Santa Rosa, California
 APN 173-023-008

Sheet
C1.1
 1 of 2 Sheets
 Job 16142

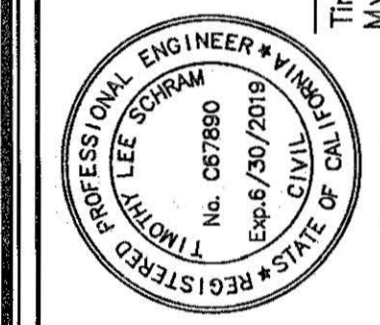

Timothy L. Schram, RCE 67890
 My license expires 6/30/2019

adobe associates, inc.
 civil engineering | land surveying | wastewater
 1220 N. Dutton Ave., Santa Rosa, CA 95401
 P. (707) 541-2300 F. (707) 541-2301
 Website: www.adobeinc.com

Revisions

No.	Date	Description	Approved