

Stoddard, Laurie

Subject: FW: Item 13.1 Southeast Greenway

From: Lea Barron-Thomas [<mailto:leamail@sonic.net>]

Sent: Tuesday, September 29, 2015 10:05 PM

To: _CityCouncilListPublic

Subject: Item 13.1 Southeast Greenway

Dear City Council,

Just a thought about the Proposed Greenway-

Is it truly a fair and reasonable decision to give ALL this property over to yet another park/greenspace when there's such a cry in the community for more housing- especially affordable housing? It would seem very prudent for the City to carefully consider every opportunity to add more housing in all parts of Santa Rosa - if the City truly wants to make more housing available, decrease rents and keep Santa Rosa families from leaving because they can't afford to live here anymore.

Of course, another green space always sounds like a great idea. The SE area of SR already boasts a 320 acre county park, a 5200 acre park with over 40 miles of interconnected trails and 25-acre lake and a 152-acre community park and they are **just minutes** away from this proposed Greenway site.

One has to wonder, can't at least a small portion of this property (57 acres) be used for some type of affordable housing?

Thank-you for your consideration.

Lea Barron-Thomas

Sincerely,

Lea Barron-Thomas

Morris, Erin

From: Chelsea McKenna Hollender <chollender@live.com>
Sent: Tuesday, September 29, 2015 7:50 PM
To: Morris, Erin
Subject: Greenway feedback

Hello! We are writing in support of the southeast greenway. We have been following the project and are excited to see another space for people to walk, bike, run, and just enjoy a dose of nature. Spring creek and Howarth park are so popular and full, the demand is obvious! Go greenway!!

Chelsea and Will Hollender
Mayette ave.

Please excuse typos, sent from a mobile device.

Morris, Erin

From: Ron Bendorff <rbendorff@gmail.com>
Sent: Tuesday, September 29, 2015 6:12 PM
To: Morris, Erin
Subject: Notice of Public Meeting - Southeast Greenway Project

Hi Erin,

Thank you so much for speaking with me the other day about this project.

As we discussed, my wife and I are homeowners who live in close proximity to the project site. We are not opposed to the concept of the greenway and believe it could be a nice addition to the City's overall trail system, however we ask that the project not be considered until there is a guaranteed source of funding for its continual maintenance. We have seen the quality of the City's existing parks, street medians and other public landscaped areas deteriorate in recent years due to reduced budgets for general upkeep. Recreational and visually aesthetic features have always been a low priority in City budgets, where public safety, infrastructure expansion and maintenance, and other more pressing needs take precedence. With the loss of redevelopment funds that previously helped City budgets the dollars spent on parks and trails are further diminished. We are concerned that additional greenspace will only further stretch the City's ability to maintain what it already has, and this would certainly not improve our residents' quality of life.

When we moved into our home, we were informed that the paved bike path adjacent to our house was supposed to be landscaped and dedicated to the City for maintenance, and that a creek area behind our home was supposed to be similarly finished. These details were conditions of our subdivision's approvals, yet the City neglected to follow through with them, citing an inability to fund their maintenance. If the City is unable to take care of small bike path sections such as this, then why would it want to take on the burden of another mile or so of additional greenspace? Again, it's a nice idea, but do we really want to create another potential maintenance headache? We sincerely hope that the Council genuinely appreciates the need to identify suitable and perpetual funding for this project and does not merely treat this as a "feel good" project for which funding decisions can be postponed.

Thank you for this opportunity to comment.

Ron Bendorff
Tricia Consani

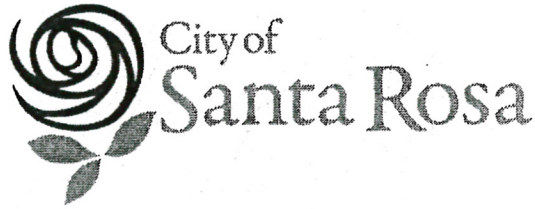

CITY OF SANTA ROSA
NOTICE OF PUBLIC MEETING

SOUTHEAST GREENWAY PROJECT

The purpose of this notice is to inform surrounding property owners and interested parties about the status of the Southeast Greenway project. City of Santa Rosa staff have completed a report titled "Southeast Greenway Existing Conditions, Opportunities, and Constraints" regarding the approximately 57 acre site comprised of undeveloped Highway 12 right of way between Farmers Lane and Spring Lake Regional Park in southeast Santa Rosa (see map on reverse).

The report provides background information about the site including existing conditions on and surrounding the right of way. In addition to reviewing the report, the Santa Rosa City Council will consider whether to initiate a General Plan Amendment and Rezoning for the site. Initiation of a General Plan Amendment and Rezoning would be the first step toward deciding the future uses of the site; if initiated, the community planning process is anticipated to begin in early 2016 and will involve significant community engagement followed by formal public hearings by the Planning Commission and Council.

Both the report and consideration of the initiation of a General Plan Amendment and Rezoning will be presented to the Council on Tuesday, October 6, 2015, at or after 4:00 p.m., in the City Council Chamber, City Hall, 100 Santa Rosa Avenue, Santa Rosa.

If you cannot attend, you are encouraged to submit written comments and recommendations prior to the public meeting. Comments and questions may be directed to Erin Morris, Community Development, City of Santa Rosa, 100 Santa Rosa Avenue, Room 10, Santa Rosa, CA 95404, telephone 707-543-3273 or email emorris@srcity.org.

Terri A. Griffin, City Clerk, City of Santa Rosa



Sept. 25, 2015 - Dear Ms. Morris,
I strongly support a General Plan Amendment and Rezoning for the Southeast Greenway project. Converting this valuable unused property to be a public park would be an asset to the City, and a TREMENDOUS benefit for the community. I live within 50 feet of the Greenway (location marked on back), and am most eager to walk on it. I also support funding the costs for traffic control lights and crosswalks where needed. Thank you.
Sincerely, Maurine Bentley #9
1277 Yulupa Ave.,
Santa Rosa CA 95409



For accessible meeting information please call (707) 543-3015
TDD (707) 543-3031

MAIL: P.O. Box 6775
SANTA ROSA 95406

Highway 12 Right of Way - Overview

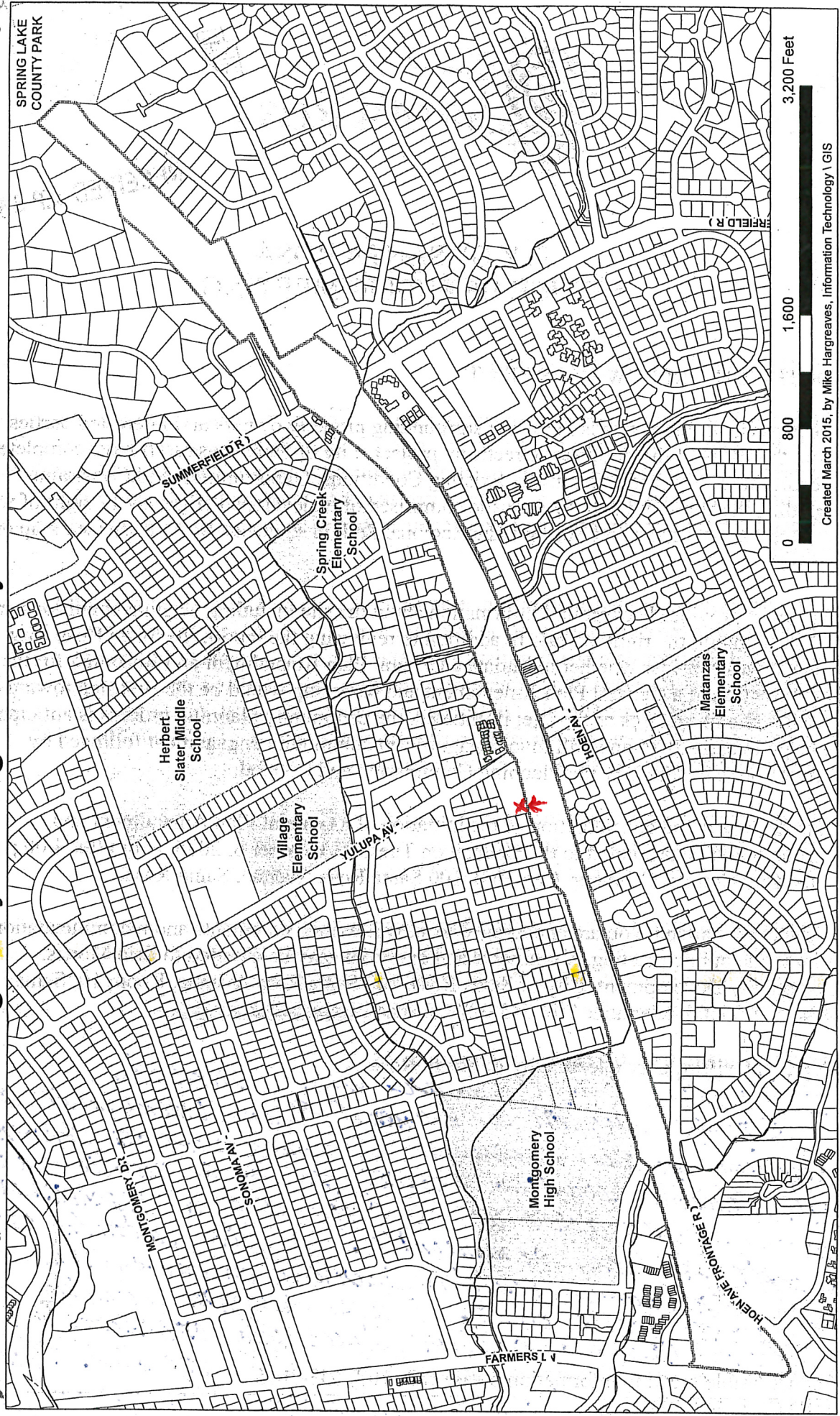



NORTH COAST CHAPTER

September 26, 2015

Erin Morris, Senior Planner
Santa Rosa City Council members

Re: Support for proposed Southeast Greenway

The Community Alliance with Family Farmers (CAFF) is a statewide organization that advocates for family farmers and sustainable agriculture. We also support urban ag and access to fresh, healthful food for all residents of California. CAFF's North Coast Chapter comprises Sonoma, Mendocino, Napa and Marin counties, but is most active in Sonoma County.

CAFF NC chapter wishes to express its support for the proposed Santa Rosa City General Plan Amendment and Rezoning for proposed Southeast Greenway site. This is a very important step forward towards deciding the future uses of the site.

CAFF has supported the Greenway concept from its inception for several reasons. In particular, the historic orchard and plans for community gardens to be established on sites adjacent to high density, low income housing, are relevant to our mission. Santa Rosa has been developed on land that supplied almost every type of agricultural commodity to the San Francisco area in the past. There are excellent soils in this area and the climate is conducive to a wide range of food crops. We support and encourage the preservation of land in and around urban areas for food production as well as recreational uses.

The Southeast Greenway has the potential to offer a wide array of other community benefits including:

- Restored natural habitat that protects wildlife and offers mitigation potential
- Community gardens and recreational amenities that promote healthy community
- Restored historic orchard providing food, income and increasing "ag literacy"
- Open space that provides groundwater recharge, carbon sequestration and urban cooling
- Provide the impetus for revitalizing adjacent residential and commercial areas to improve the local economy

Our CAFF chapter has a representative on the SE Greenway Advisory Committee and has been very impressed with the quality of the Greenway campaign's management. We urge the Santa Rosa City Council to approve the General Plan Amendment and Rezoning.

Sincerely,

Wendy Krupnick
Vice president, CAFF NC chapter
4993 B. Occidental Rd. Santa Rosa, 95401

Morris, Erin

From: Ursula <ursibochem@hotmail.com>
Sent: Saturday, September 26, 2015 2:37 PM
To: Morris, Erin
Subject: Southeast Greenway Project.

Hi Erin,

As a homeowner and resident of a house adjacent to Hoen I would be living in very close proximity to the proposed Greenway. As a matter of fact the front of our house is on Hoen a major thoroughfare through this area. The traffic on Hoen Ave has increased over the years and the constant noise, and pollution, and many accidents in front of our home are already a real burden to bear and accept.

When my husband and I bought our home a plan and financing was in place to built a freeway on the land now proposed for the Greenway. This has been defeated.

A Greenway sounds so benign, but I am aware of the sorry condition of city parks. Instead of joy they bring many concerns of crime and more traffic to the residents and homeowners around them. I vote no and am heavily opposed to the Greenway idea. I would like to see a road built to lighten some of the traffic on Hoen. (Even if it wouldn't be a freeway). Please do not put this neighbourhood through more suffering and problems.

Sincerely
Ursula Bochem

Morris, Erin

From: Lorne Swanets <swanets4620@sbcglobal.net>
Sent: Friday, September 25, 2015 8:44 PM
To: Morris, Erin
Subject: SOUTHEAST GREENWAY PROJECT

As property owners, 1575 Yulupa Ave and 1515 - 1525 Camden Court we will definitely be affected by this project. As apartment owners we recently attended the council meeting regarding possible instituting of rent control. At the end of at meeting it was decided that more study was needed and hat more housing , low cost affordable and regular housing, apartments and single family dwelling. We are both in our 80's and will most likely be gone by the time money is raised for this project. As a side issue here, I have been trying to raise \$20K as Chairman of Fundraising for the Santa Rosa Tennis Club for the courts at Howarth. 30 years, yet no City money for resurfacing? OK, excuse my snippiness for now. If the city needs more housing, affordable and other, why take this land out of circulation for housing? Please take a look at what was planned back in 1960 on the plat maps. Camden Ct. was referred to as Camden Way and was connected to Janet Way or Wanda? just to the north. I would much rather it be developed as housing. Look at the homes on Janet and Wanda Way One more question regarding rent control. Since our units were built in the early sixties, why if rent controland these are not big homes, like 1100 to 1500 square feet. Also on Yulupa I would rather see apartments like ours or those proposed on North Street. Wouldn't it be better to build a firm tax base for the city and create the housing which the city agrees is in a critical need? We are against this project! If the money is ever raised, who will maintain I, surely not the City since they don't have any money. Has the crime problem been solved for the present Greenway? One more question. If rent control is eventually imposed why are older units going to be the ones affected. Ours were built in the 60's

Morris, Erin

From: Rybat Edward E. <erybat@comcast.net>
Sent: Friday, September 25, 2015 6:39 PM
To: Morris, Erin
Subject: SouthEast Greenway Project

The Southeast Greenway Project has merit.....but there is a greater issue that needs to be resolved.....the traffic on Farmers Lane and Hoen Ave. Due to the commuters and those that are continuing through to Highway 12 towards Napa the vehicular traffic is really bad and needs to be resolved before further consideration of the Southeast Greenway Project. Additionally the traffic that backs up on Hoen Ave, past Yulupa Ave, due to only one entrance to Highway 12 west bound needs to be resolved also before further consideration of the Southeast Greenway Project. The pollution from all the vehicles that are stuck in traffic has to be horrendous.....has an environmental study been done on all the vehicles that are just idling stuck in traffic? There needs to be a better flow of traffic for commuters and for those just passing through on Highway 12.

tcb/
Ed Rybat

Morris, Erin

From: Hap Culp <pluc@att.net>
Sent: Friday, September 25, 2015 6:12 PM
To: Morris, Erin
Subject: South Greenway Existing Conditions, Opportunities, and Constraints report

Dear Ms. Morris, I have just received a notice of a hearing on the above captioned project. I wish to read the report and cannot locate it on the city website. Could you please send me the link or the report (via email) if possible. I own a duplex on Hilliard Ct which backs on the right of way which explains my interest. Thank you. Henry Culp (pluc@att.net)

Morris, Erin

From: Lisa Pierce <lepierce@sbcglobal.net>
Sent: Friday, September 25, 2015 3:13 PM
To: Morris, Erin
Subject: Greenway Project

Dear Ms. Morris,

I just received the notice about the Greenway. I just wanted to write and tell you how happy and excited I am about this project! So looking forward to having this park in our neighborhood!

All the best, Steve & Lisa Pierce (Yulupa Cohousing)

Morris, Erin

From: Dennis Hagemann <dennish@sonic.net>
Sent: Friday, September 25, 2015 2:31 PM
To: Morris, Erin
Subject: SOUTHEAST GREENWAY PROJECT,,

Hello Erin Morris;

I would like to know who owns the land that was set aside for Highway 12 known as the Southeast Greenway.

I feel this land should be used as originally intended, to connect Highway 12. Once this land is given up there will never be a quick access from 101 to 12.

Thank you,

Dennis Hagemann