



EXHIBIT 'A'

VACATION OF SANITARY SEWER EASEMENT

Being a portion of those Easement Deeds filed under Document No. 86-108173, Document No. 88-094168, and Document No. 1996-0022671, Official Records of the County of Sonoma. The portion to be vacated is more particularly described as follows:

All that portion of Document No. 1996-0022671, Exhibit 'A', described under the heading "Legal Description New Sewer Easement".

TOGETHER WITH, all that portion of Document No. 86-108173 and Document NO. 88-094168 described under the heading "Easement "B" Sewer Easement",

Prepared by:

BKF ENGINEERS

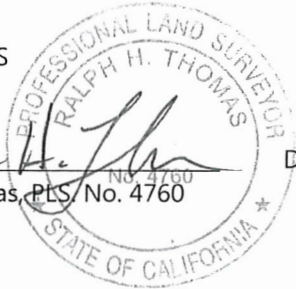

Ralph H. Thomas, PLS, No. 4760



Dated: 5/1/2018

City of Santa Rosa
AUG 20 2018
Planning & Economic
Development Department

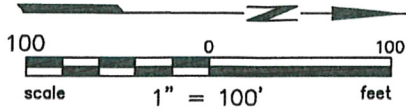
EXHIBIT 'B'



EXISTING 15' SEWER EASEMENT
3297 O.R. 539 (TO REMAIN)

HWY 101

LANDS OF COUNTY OF SONOMA
APN 180-010-011
2972 O.R. 229

LANDS OF COUNTY OF SONOMA
APN 180-010-012
DN 2000-106322

PORTION OF EASEMENT
ABANDONED BY QUITCLAIM
DN 1996-050737

15' PUBLIC SEWER EASEMENT
DN 1996-0022671
(TO BE VACATED)

LANDS OF COUNTY OF SONOMA
APN 180-010-011
DN 81-038465

PUBLIC SEWER EASEMENT "B"
DN 86-108173 & DN 88-094168
(TO BE VACATED)

LANDS OF COUNTY
OF SONOMA
DN 1993-104750

LANDS OF COUNTY OF SONOMA
APN 180-010-008
DN 2000-106322

RUSSELL AVE

LANDS OF COUNTY OF SONOMA
APN 180-010-009
2358 O.R. 551

City of Santa Rosa
AUG 20 2018
Planning & Economic
Development Department



Ralph H. Thomas 5/1/2018
RALPH H. THOMAS PLS 4760



200 4TH ST, STE. 300
SANTA ROSA, CA 95401
PH: 707-583-8500
FAX: 707-583-8539

Subject VACATION OF SANITARY SEWER
EASEMENT
Job No. 20179086
By AEG Date MAY 2018 Chkd. RHT
SHEET 1 OF 1

Plot May 01, 2018 at 8:39am