An abstract graphic on the left side of the slide consists of several 3D rectangular blocks of various colors (red, orange, teal, light blue, and white) arranged in a cluster. The blocks are rendered with black outlines and are set against a solid light blue background. The perspective is from a low angle, looking up at the blocks.

# **APPEAL OF PROPOSED VERIZON CELL TOWER APPLICATION**

**A SUMMARY OF KEY POINTS**

# KEY POINTS AGAINST VERIZON'S APPLICATION

- No gap in coverage established
- Visual blight harms neighborhood
- No mitigation provided
- Miscellaneous points:
  - Shot clock does not apply
  - Emergency calls not affected

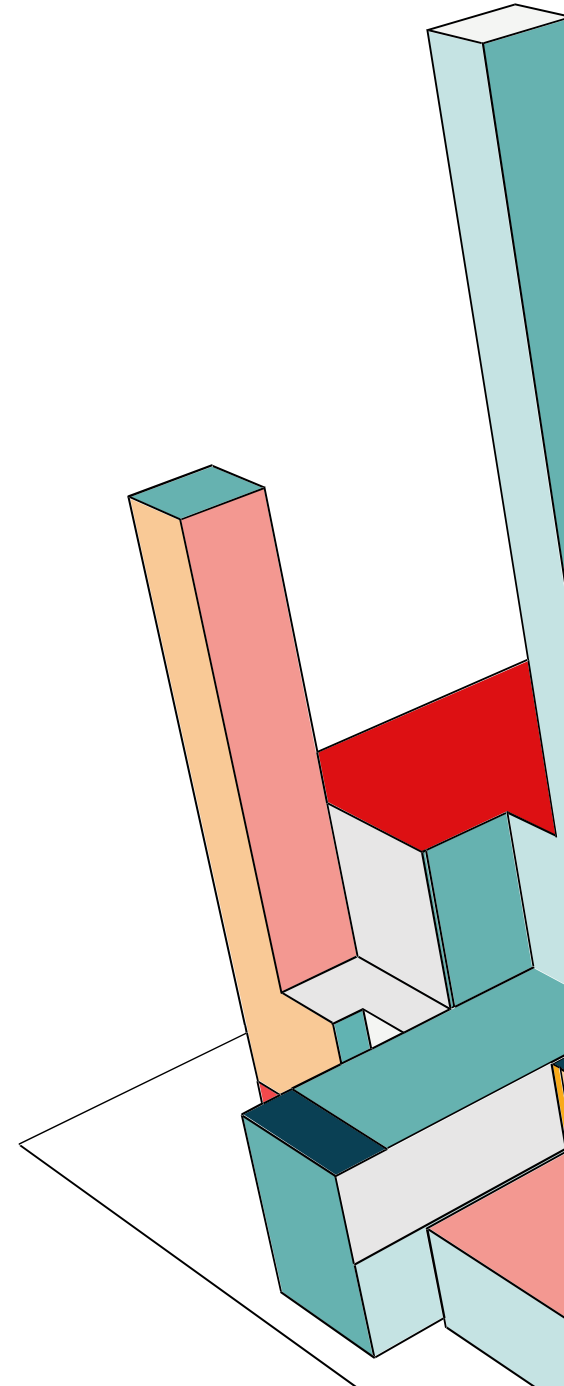

**NO GAP IN  
COVERAGE  
ESTABLISHED**

# MAP OF EXISTING SITES

## SANTA ROSA MAP: EXISTING VERIZON SITES

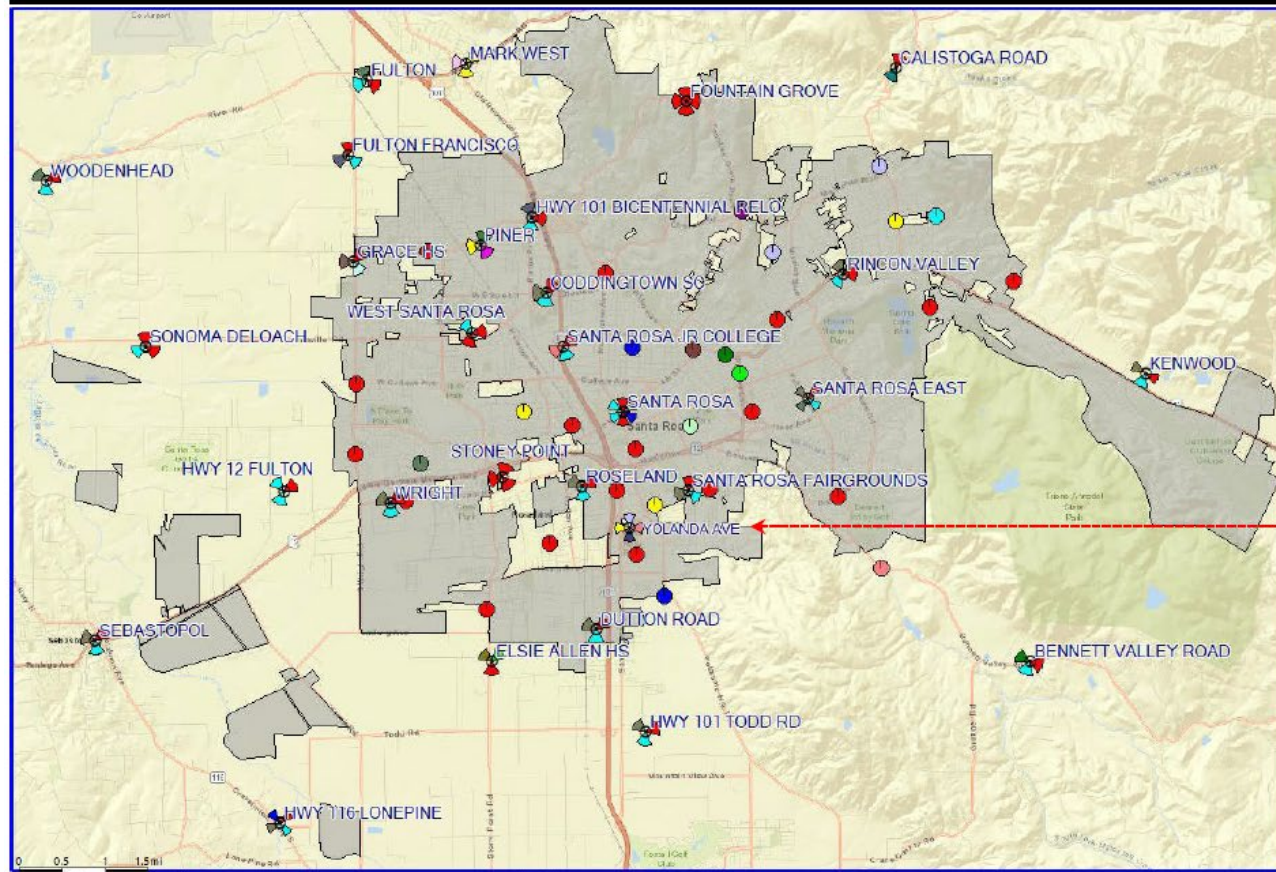

 Existing Macro Sites

 Existing Small Cells

Note: Small Cells are not labelled to simplify a readable map

Proposed VZW Wireless Facility  
Site Name: YOLANDA AVE

Santa Rosa City Border

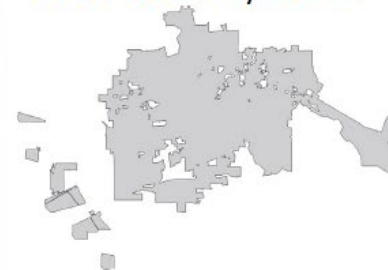

**verizon** Confidential and proprietary materials for authorized Verizon personnel and outside agencies only. Use, disclosure or distribution of this material is not permitted to any unauthorized persons or third parties except by written agreement.

1 of 1

# MAP SHOWS AMPLE COVERAGE

- Santa Rosa has the highest concentration of cell towers than any North bay community.
- There are over 40 cell towers in Santa Rosa.
- There are over a dozen within a 2-mile radius of the proposed tower.
- The current ordinance states that you **cannot place a cell tower within a 2-mile radius of an existing uncamouflaged or unscreened cell tower.**

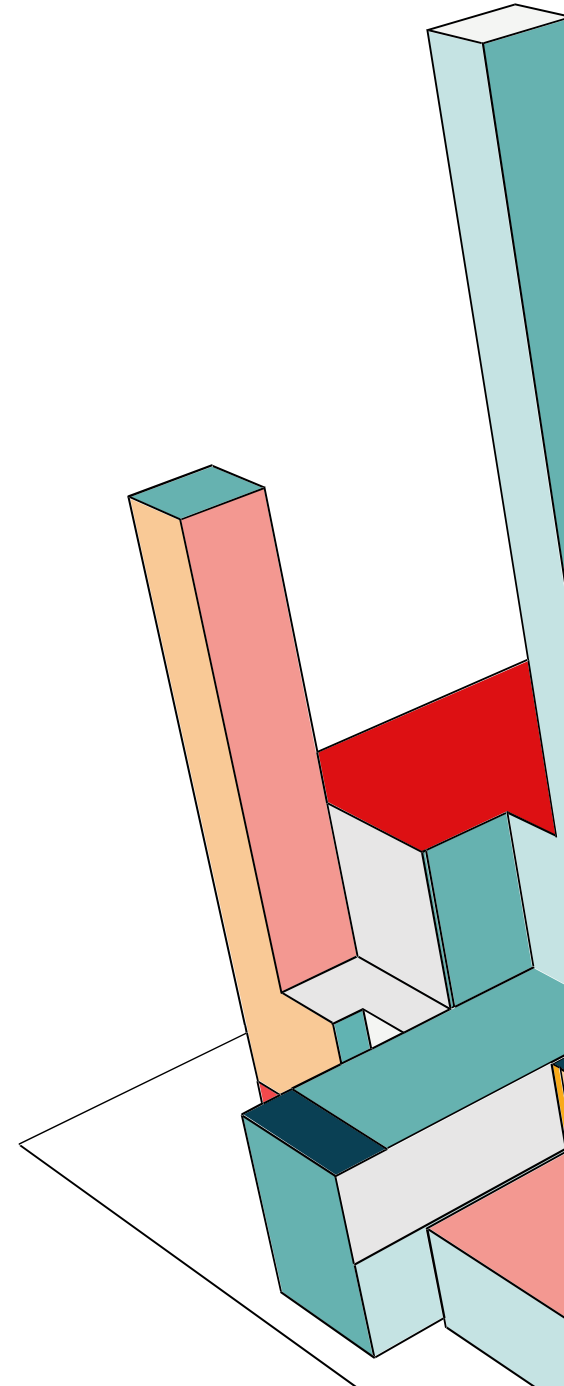

# PROOF OF GAP IN COVERAGE MISSING

- What can show whether a gap exists?
  - Drop call lists and drive by tests
  - These are objective measures.
- Verizon has not provided either one.
- You need all the facts to make an objective call as to whether a gap exists, how big it is, where it is, and if the proposal is over kill.

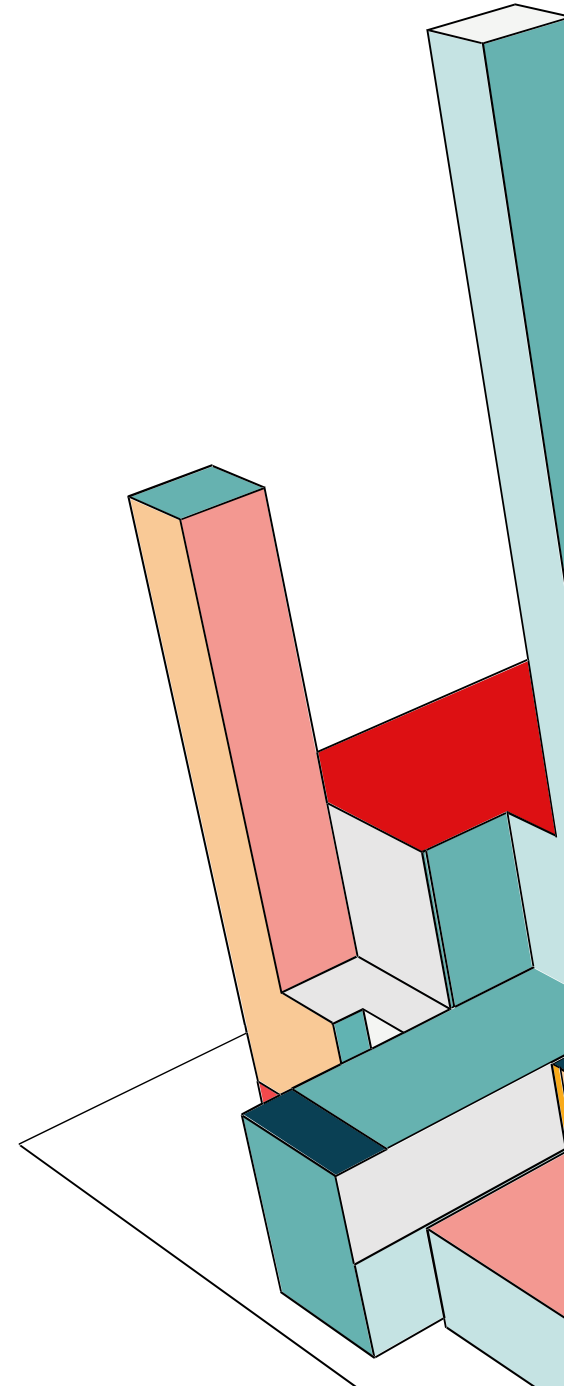

# VERIZON CAN'T HAVE IT BOTH WAYS

- Verizon is claiming that there's a gap in coverage to the City Council.
- Verizon's own website claims that along Colgan and in the bulk of Santa Rosa, there's no gap in coverage. **RED** indicates excellent coverage.

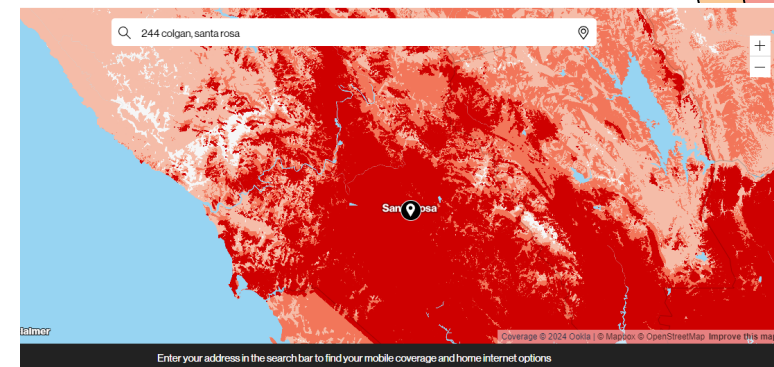
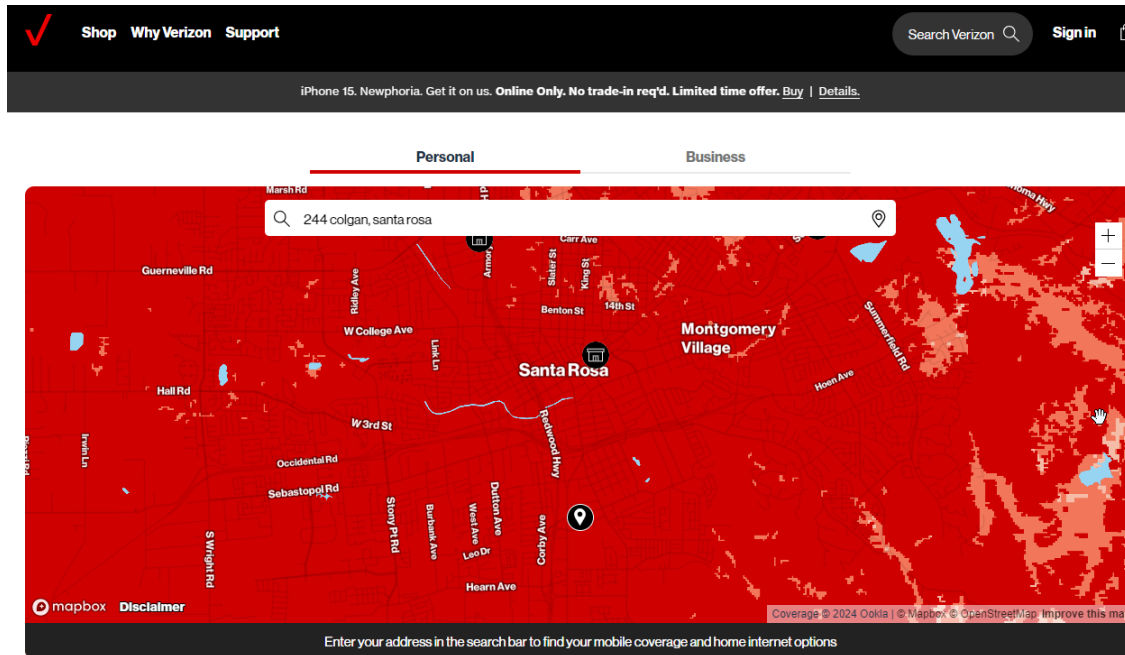

Map of Santa Rosa and larger environ

Close up map of 244 Colgan Ave.



**VISUAL BLIGHT  
HARMS THE  
NEIGHBORHOOD**



# THE DESIGN VIOLATES LOCAL AESTHETICS

- Verizon proposes a 69-foot cell tower, rising more than 30 feet higher than any building along Colgan.
- Out of character for the neighborhood
- Daily visual slap in the face
- Ugly eye sore wrecking the skyline

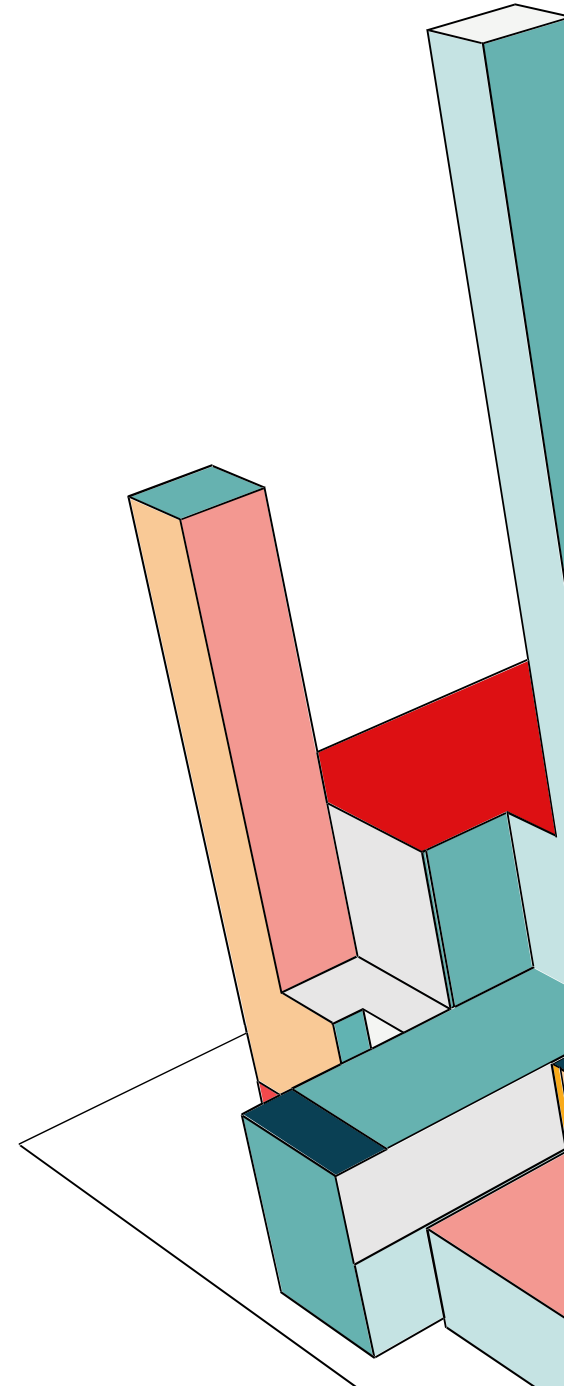

# VISUAL HARM CAN BE COMPOUNDED

- If approved, the project can be allowed to go higher.
  - 20 feet higher!
- Verizon would have the clout to increase the harm without having to seek Council approval.

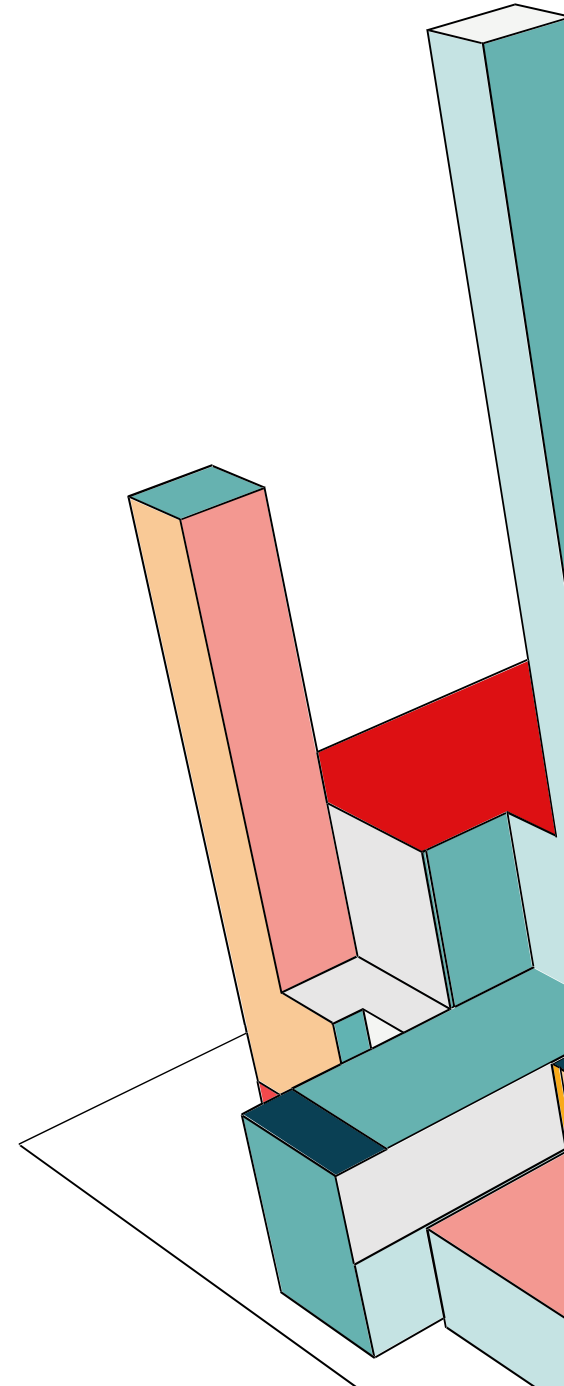

# PROPERTY VALUES WILL BE HARMED

- Giving free reign to a corporation to erode property values hurts homeowners.
- On average, residential property values drop by 20% near cell towers.
- The neighborhood reflects middle-income, lower-income, and retirees—not affluent residents.
- Undermining property values here increases the economic divide.
- The proposed tower undermines the General Plan supporting a livable residential neighborhood.
- Affects those with the least to protect the value of what modest homes they have.

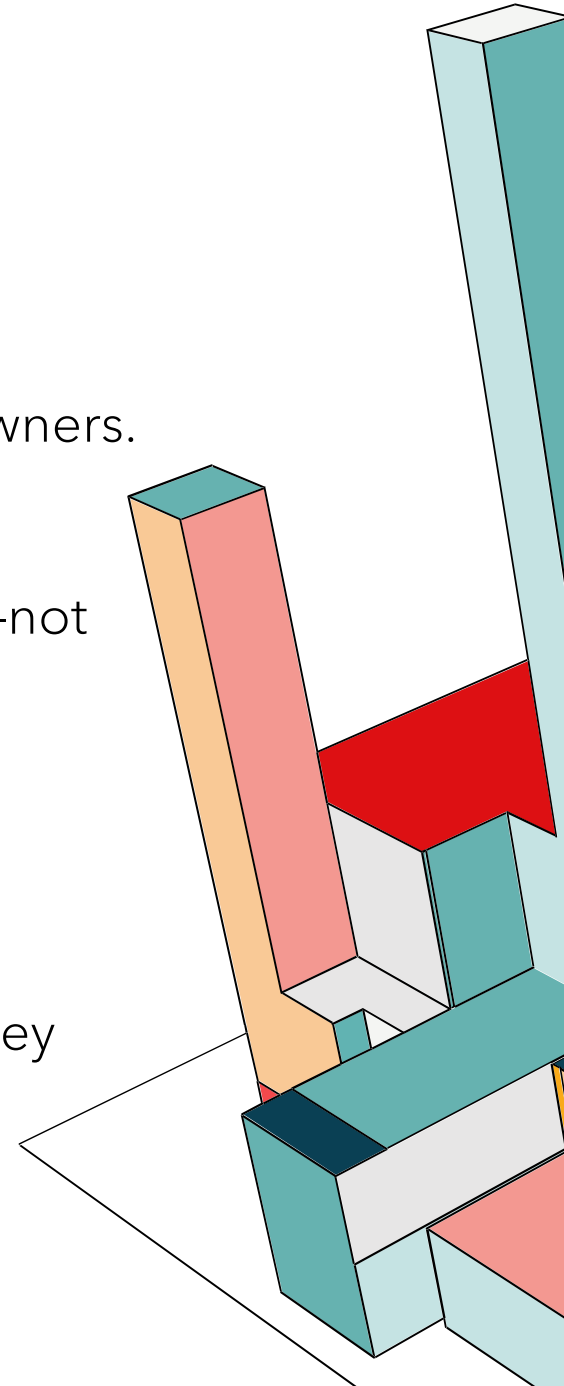

**NO MITIGATION TO  
REDUCE HARM**

# VERIZON HAS NOT TRIED TO MINIMIZE THE HARM

- The ordinance requires that Verizon:
  - Conduct alternate site location analysis.
  - Minimize visual impacts to the surrounding area.
  - Co-locate, where feasible.
- Verizon has failed to exhaust numerous possibilities in a 2-mile radius.
- Verizon has not camouflaged, screened, or reduced the tower's height.
- Verizon has not acted in good faith nor performed due diligence.

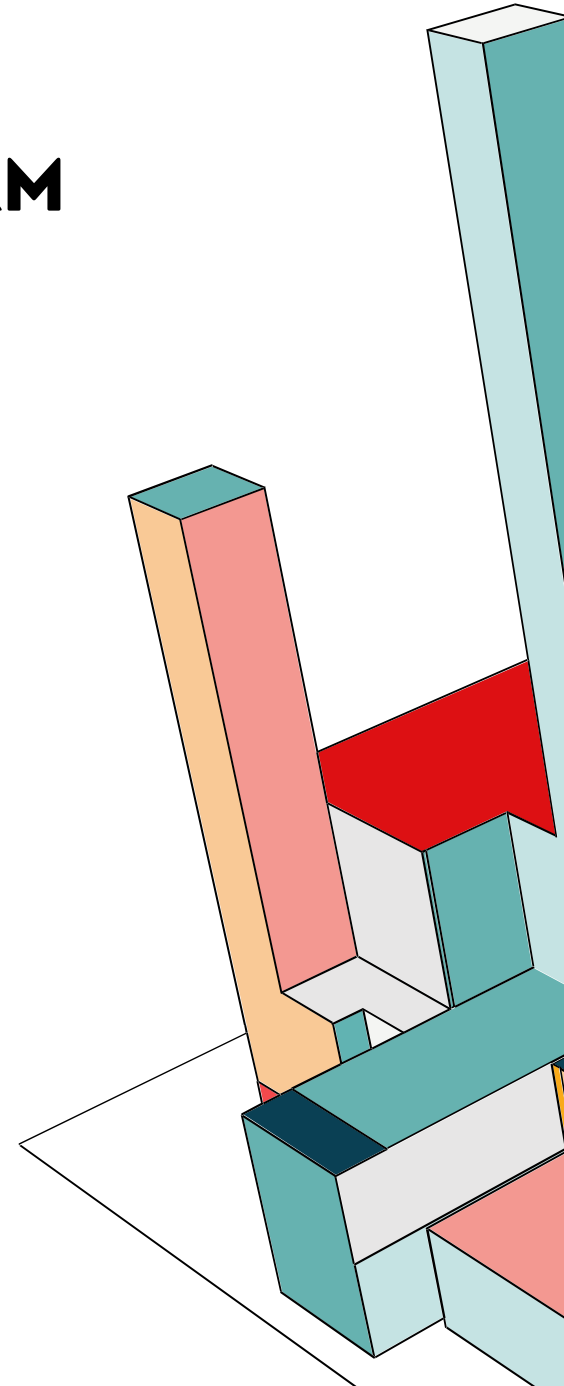

# **MISCELLANEOUS ISSUES**

Shot clock and emergency calls

# SHOT CLOCK DOES NOT APPLY

- The Telecommunications Act created a time frame for cities to review applications, called the Shot Clock.

## **(B) Limitations**

**(ii)** A State or local government or instrumentality thereof shall act on any request for authorization to place, construct, or modify personal wireless service facilities within a reasonable period of time after the request is duly filed with such government or instrumentality, taking into account the nature and scope of such request.

- It was created to make sure cities didn't ignore applications.
- Once a city takes "an action" (approval or denial) within 150 days or an agreed toll date.
- After that, there is no additional shot clock. An appeal or a court proceeding has no effect because the shot clock has been met.

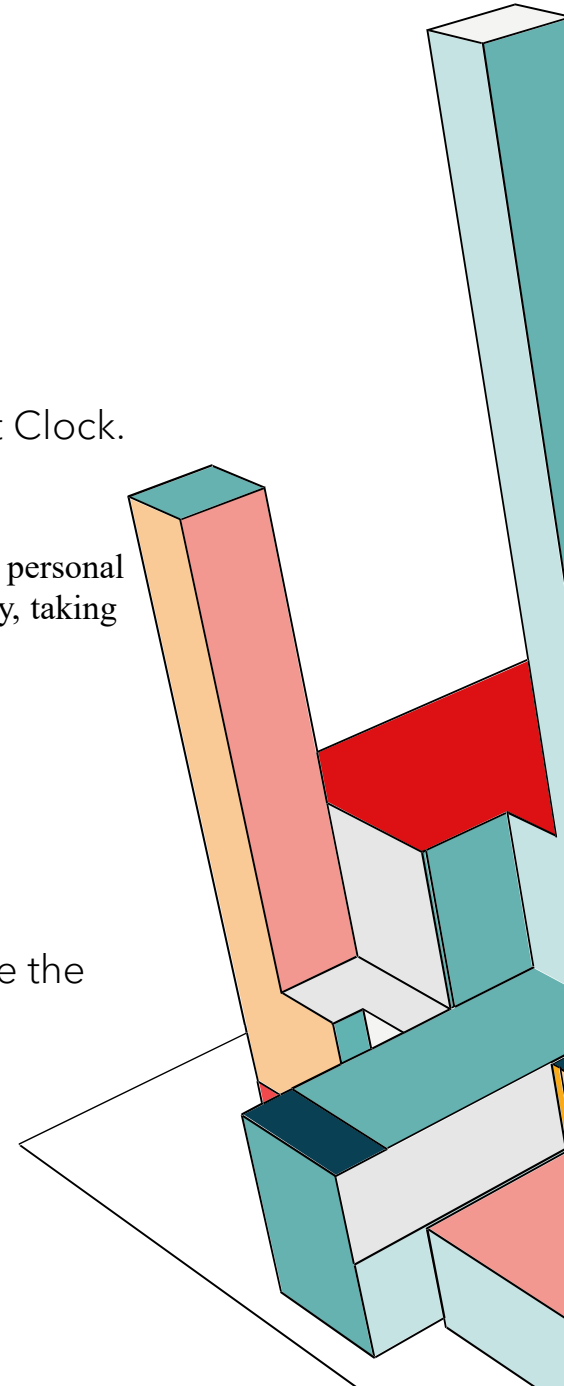



# EMERGENCY CALLS UNAFFECTED BY VERIZON'S PROPOSED TOWER

- AT&T operates the national First Net first responder network, not Verizon.
- Safety and 911 calling would be affected if AT&T mounted its antennae on the proposed tower.
  - With co-location, that AT&T antennae affects only AT&T customers.
- No indication that Verizon has a deal to support AT&T antennae.
- No indication that AT&T would co-locate on the proposed tower rather than its own.
- Bottom line: All 911 calls connect to any available network.

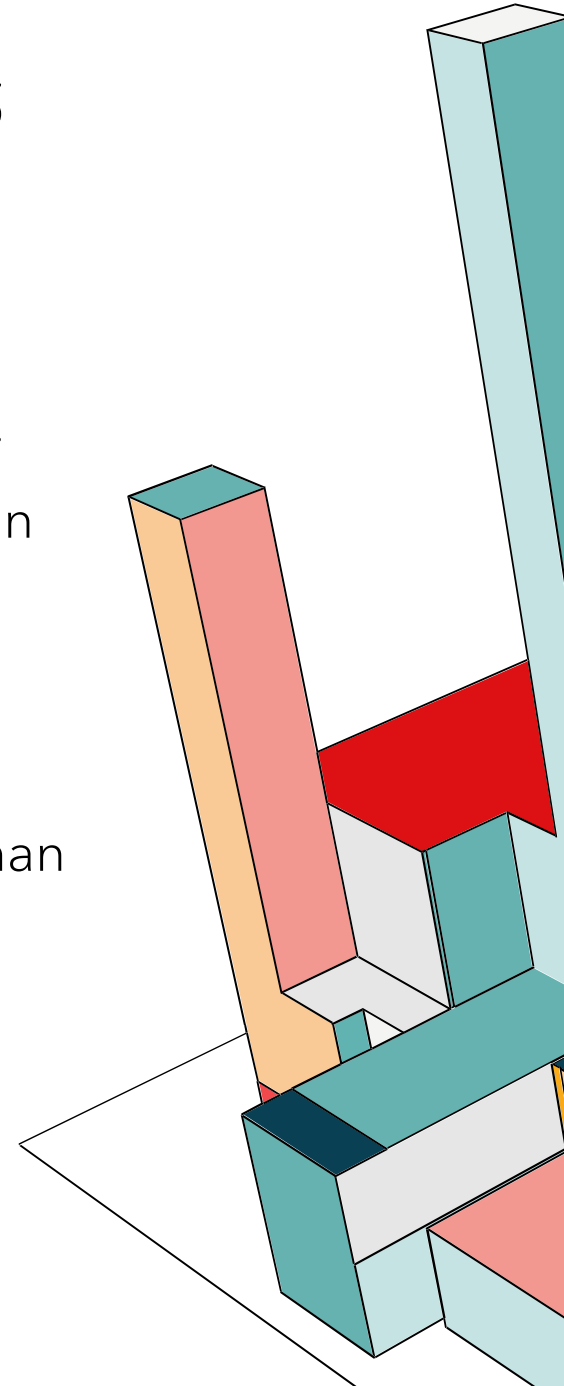

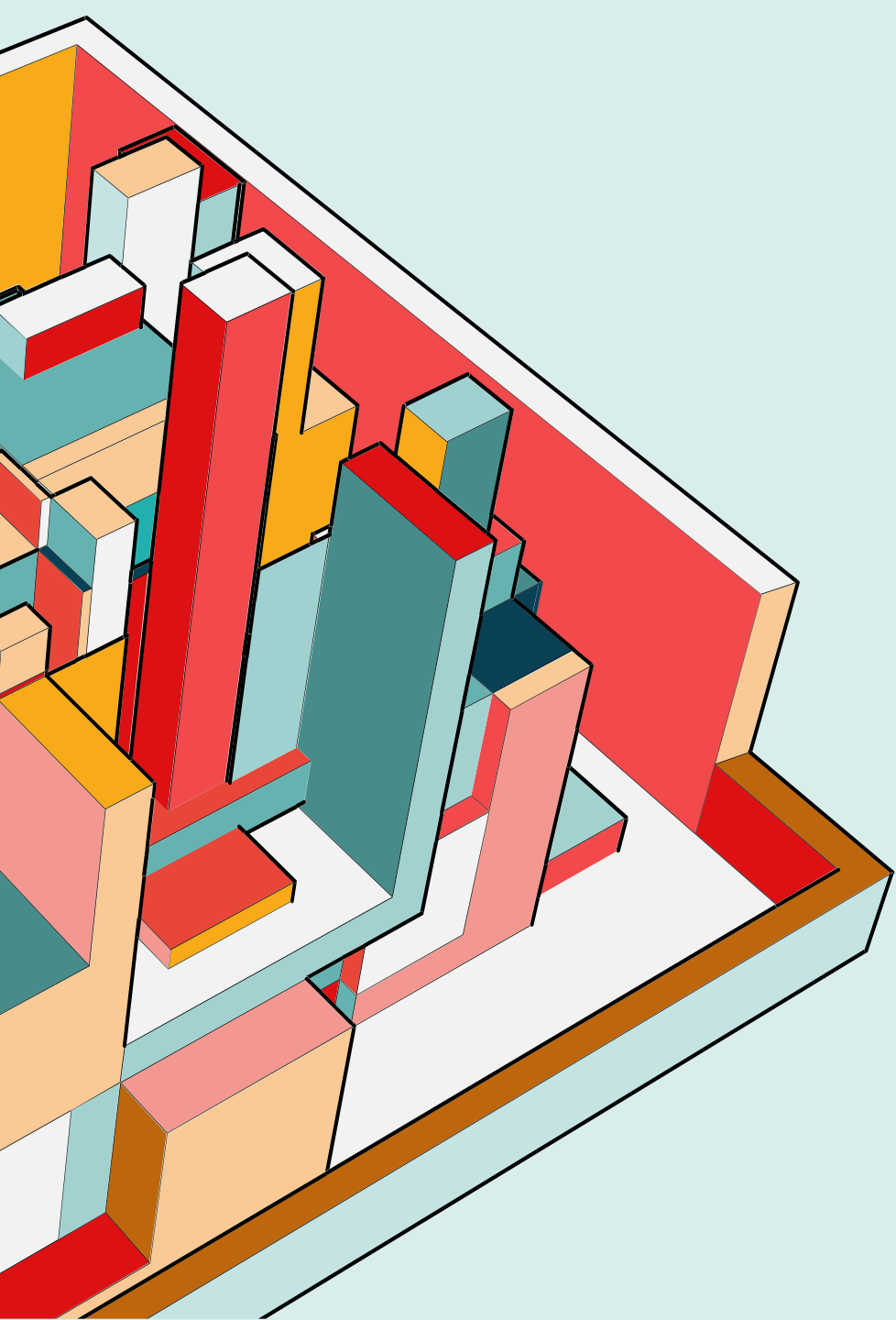

# **REJECT VERIZON'S CELL TOWER APPLICATION AT 244 COLGAN AVENUE**

- No gap in coverage established
- Visual blight harms neighborhood
- No mitigation provided

# THANK YOU

Carmen R. Gonzalez, homeowner at La Esplanada Condominiums

Sidnee Cox, Co-director EMF Safety Network

Paul-André Schabraq, Co-director EMF Safety Network

Kim Schroeder, SafeTech4Santa Rosa

