

NOTICE OF SUBMITTAL OF FINAL MAP

The Final Map of Mission Village Condominium was submitted on April 19, 2017 to the City Engineer. In accordance with City Code Section 19-28, notice is hereby provided to the City Council that the subdivision map of Mission Village Condominium is being reviewed for final approval.

The Mission Village Condominium is located on Prospect Avenue, east of Mission Blvd. at Sherbook Drive, south of Highway 12.

Mission Village Condominium project is 2.96 acres of 62 existing units that will be subdivided into 62 Airspace units and 1 common parcel.

The City Engineer shall approve or deny the final map within 10 working days following the City Council meeting of August 8, 2017.

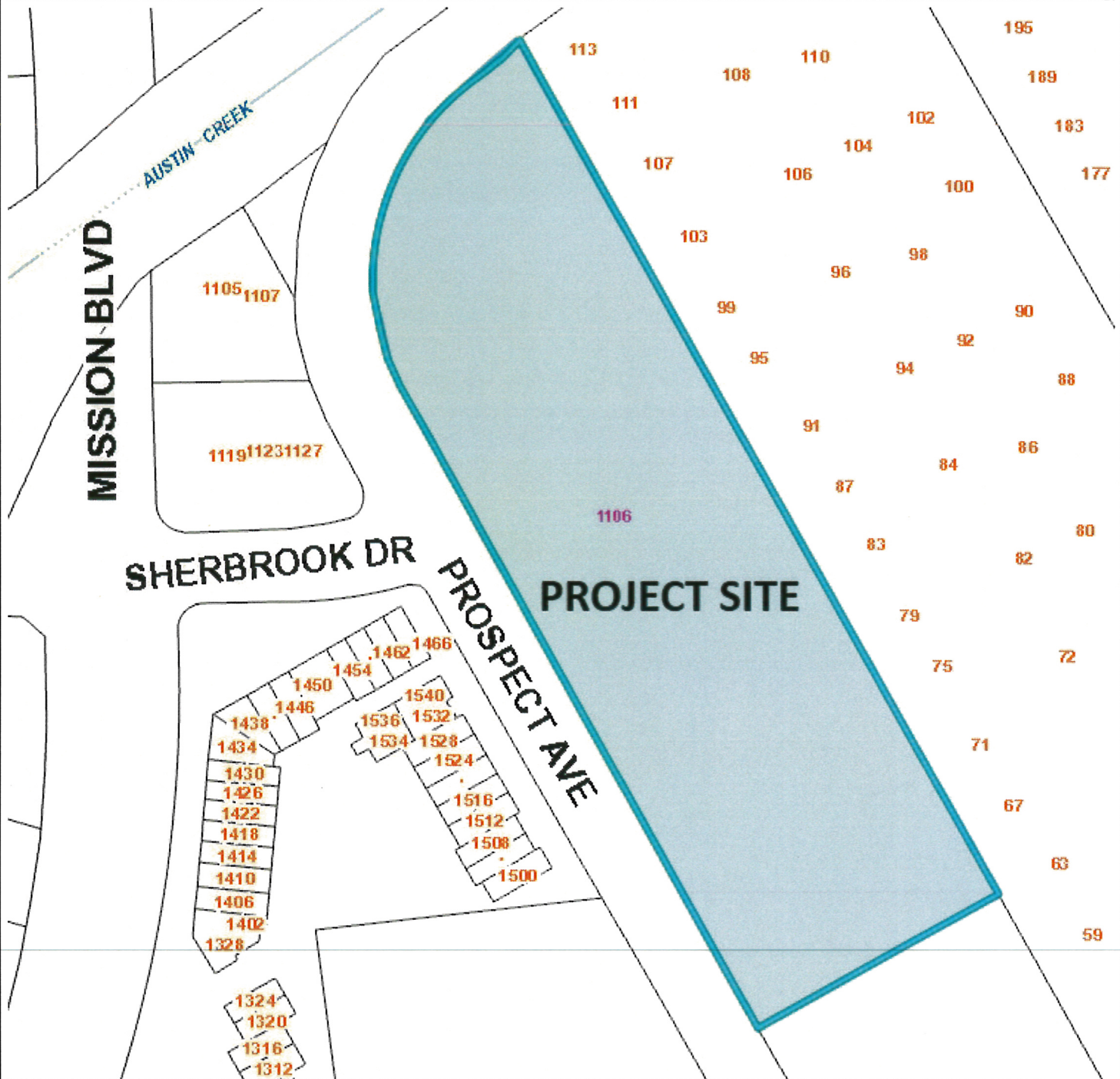

**Project site for Mission Village
 Condominiums**



7/21/2017

Scale 1: 1,200

0 Miles 0.02