

COUNTY OF SONOMA  
CITY OF SANTA ROSA

NOTE: The State of California or its officers or agents shall not be responsible for the accuracy or completeness of digital images of this map.

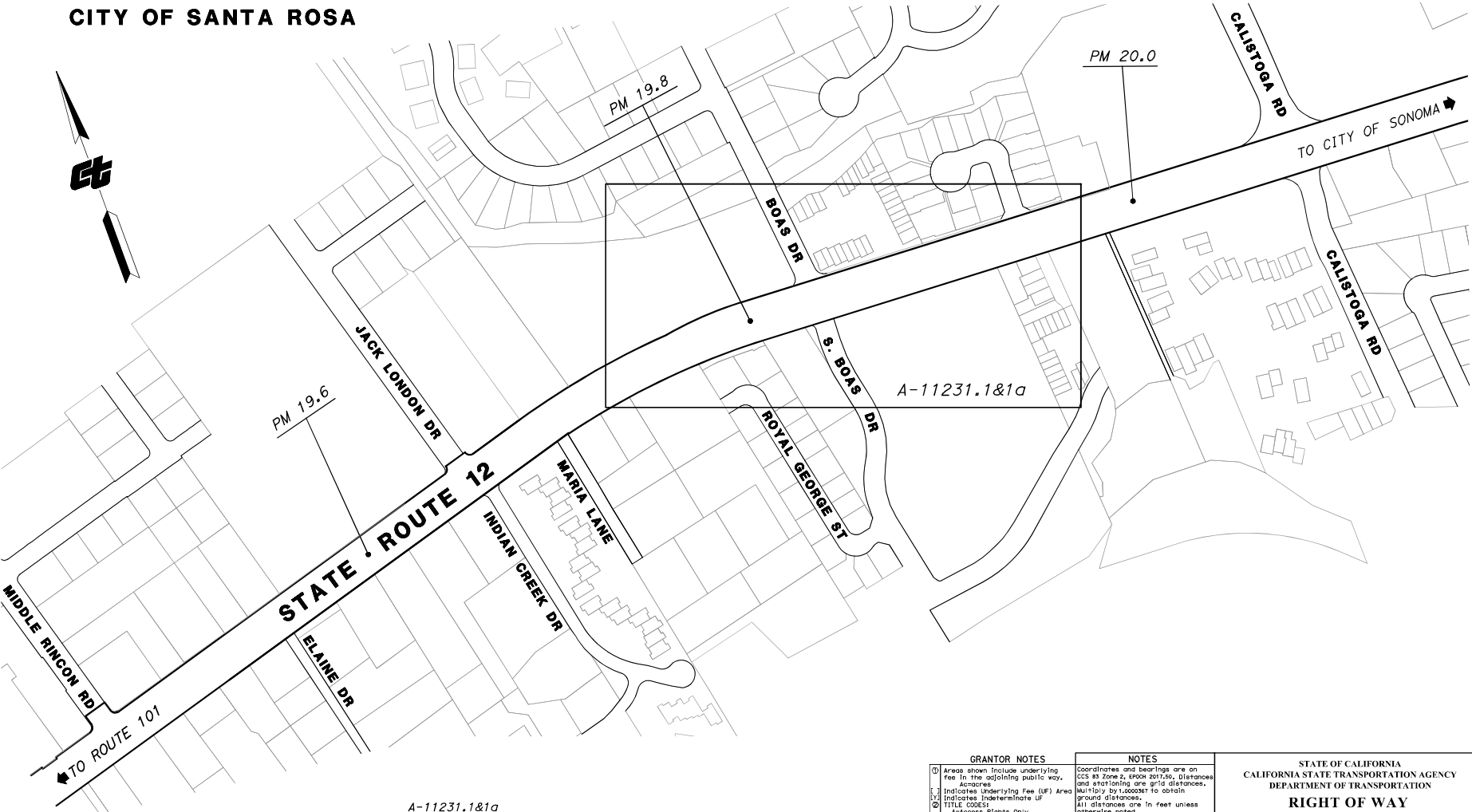

A-11231.1&1a

- 64741-1 64745-1
- 64742-1 64745-2
- 64742-2 64745-3
- 64742-3 64746-1
- 64743-1 64746-2
- 64743-2 64747-1
- 64744-1 64747-2
- 64744-2

**GRANTOR NOTES**

① Areas shown include underlying fee in the adjoining public way.  
A=Access  
② Includes underlying fee (UF) Area  
③ Indicates Indeterminate UF

④ TITLE CODES:  
A=Access Rights Only  
F=Fee  
E=Easement (Ease)  
TCA=Temp Construction Ease  
T=Other Temp Ease (See Remarks)  
D=Other (See Remarks)

⑤ TIME:  
G=Grant deed  
E=Easement deed  
AC=Quitclaim  
DE=Director's deed  
DE=Director's easement deed  
DO=Director's quitclaim deed  
FOC=Final Order of Concentration  
HE=Highway easement deed  
REL=Relinquishment  
VAC=Vacation  
JUA=Joint use agreement  
CCUA=Consent to common use agreement

⑥ Document or Instrument number

**NOTES**

Coordinates and bearings are on CCS 83 Zone 2, epoch 2017.50. Distances and stationing are grid distances. Multiplied by 1.00082 to obtain ground distances. All distances are in feet unless otherwise noted. THE RW LANDNET IS BASED ON FIELD SURVEY JOB # 2022-0681

**LEGEND**

ACCESS PROHIBITED  
DIMENSION POINT  
APN  
ASSESSOR'S PARCEL NUMBER  
R/W  
ACRES  
RIGHT OF WAY  
RADIAL BEARING  
DOCUMENT NUMBER  
INCLD.  
S.F.  
ESMT.  
SQUARE FEET  
EASEMENT

STATE OF CALIFORNIA  
CALIFORNIA STATE TRANSPORTATION AGENCY  
DEPARTMENT OF TRANSPORTATION

**RIGHT OF WAY  
APPRAISAL MAP  
A-11231.0**

FOR PREVIOUS R/W INFORMATION SEE MAP(S) R-138A.8

SCALE: 1" = 50'

FEET 0 25 50 100 150

TO DESIGN: EA(s) 207802 FAS: J. CARDARELLI  
DRAFTED BY: A. ZHONG CHECKED BY: J. CARDARELLI

DISTRICT	COUNTY	ROUTE	SHEET PM	SHEET NO.	TOTAL SHEETS
04	SON	12	19.8	1	3

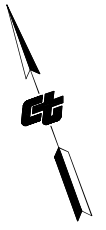
[illegible]

**GRANTOR NOTES**

1) Area shown include underlying fee in the adjoining public way, Accretes

Indicates Underlying Fee (UE) Area Includes Indeterminate UE

TITLE CODES:

Advocate Rights Only

F=Fee

E=Easement (Ease)

TCA=Temp Construction Ease

Temp Easement (See Remarks)

Other (See Remarks)

TYPE:

Q=Quitclaim deed

E=Easement deed

GC=Quitclaim

DD=Director's deed

DE=Director's easement deed

DEK=Director's quitclaim deed

FO=First Offer of Consideration

H=Highway easement deed

REL=Reliance deed

M=Mortgage

JOA=Joint use agreement

CO=Consentation to common use agreement

DO=Document Instrument number

**NOTES**

Coordinates and bearings are on CS 3 as Zone 2, NAD 83, Distances ground and stationing are grid distances. Multiply by 1.0000087 to obtain ground distances.

All distances are in feet unless otherwise noted.

THE R/W LANEWAY IS BASED ON FIELD SURVEY (See R-2022-060)

**STATE OF CALIFORNIA**

**CALIFORNIA STATE TRANSPORTATION AGENCY**

**DEPARTMENT OF TRANSPORTATION**

**RIGHT OF WAY**

**APPRAISAL MAP**

**A-11231.1**

**LEGEND**

	ACCESS PROHIBITED
O	DIMENSION POINT
APN	ASSESSOR'S PARCEL NUMBER
R/W	RIGHT OF WAY
AC.	AREAS
(R)	RADIAL BEARING
DOC. NO.	DOCUMENT NUMBER
INCLD.	INCLUDING
S.F.	SQUARE FEET
ESMT	ESSENTIAL

FOR PREVIOUS R/W INFORMATION SEE MAP(S) R-138A.8

SCALE: 1" = 50'

0	25	50	100	150
FEET				

TO DESIGN:      EA(s): 207802      F&M:

DRAFTED BY: A. ZHONG      CHECKED BY: J. CARDARELLI

DISTRICT	COUNTY	ROUTE	SHEET PM	SHEET NO.	TOTAL SHEETS
44	SON	12	19.8	2	3

