

**PROJECT DESCRIPTION:
2835 DUKE COURT
SANTA ROSA, CA**

*Conditional Use Permit Application for
Commercial Cannabis Cultivation*

Initial Submittal: October 2016

Supplementary Submittal: January 2017

TABLE OF CONTENTS

BACKGROUND	3
ZONING & SCHOOLS	3
BUILDING CHANGES	3
PARKING & LANDSCAPING	4
VEHICLE TRIPS	4
DELIVERIES TO AND FROM BUILDING	4
SECURITY	5
CANNABIS CULTIVATION	8
OVERVIEW	8
CATEGORIES OF OPERATION	9
CANNABIS ODOR MITIGATION	10
CULTIVATION WATER USE AND EFFLUENT	12
NOISE	12

BACKGROUND

In February of 2016, the City of Santa Rosa proposed ordinance 40-60, which allows for Indoor Commercial Cannabis Cultivation within the city limits. On March 15, 2016, that ordinance was adopted and added to the City Code as Chapter 20 – 46.

Duke Collective Inc, the Applicant, proposes to use a building of approximately 24,510 square feet located at 2835 Duke Court and obtain a Conditional Use Permit for indoor cannabis cultivation.

ZONING & SCHOOLS

Presently, the building is Zoned, IL, Light Industrial, one of the designated zoning districts where this use is allowed. Additionally, the building is in an area classified as Light Industry within the General Plan of the City.

The area around the subject property is industrial in nature. The building sits on the Duke Court cul-de-sac on the North East corner. To the East lies a rail spur, to the South and West several industrial buildings, and to the north lies approximately 15 residential homes. Several of these homes share a fence line with the property, but there is no direct road connection between the homes and the subject property.

The Subject Building is in the Bellevue School District and is more than 600 feet away from the nearest school. The closest school is Belleview Elementary and it is located approximately 2,200 linear feet to the North West of the subject property.

BUILDING CHANGES

This application proposes no external changes to the building. There are existing windows on the exterior of the building that will remain. Those windows will be closed from the inside of the building to provide enhanced security for the cultivation operation within.

Presently the interior of the building is mostly open. Our attached architectural plans demonstrate a healthy functioning working environment, which will include 16 cultivation rooms (14 flowering and 2 vegetative). All of the internal demising walls have been designed to meet Santa Rosa Fire and Building Code requirements.

We will be upgrading the HVAC systems and the power systems of the building to accommodate the cannabis cultivation use. The power upgrade will be completed with PG&E approval and oversight. The HVAC upgrades will be in compliance with Title 24. The internal power distribution will be done according to Santa Rosa Uniform Building Code.

PARKING & LANDSCAPING

Currently the building has 98 parking spaces. The operation of the cannabis cultivation will have approximately 22 employees during peak business operations. The total possible peak demand for parking spaces for employees will be 22 spaces. The existing parking of 98 spaces will provide more than sufficient parking for all employees at all times.

There is existing landscaping around the building consisting of mature trees. There are no proposed changes to the landscaping.

VEHICLE TRIPS

The standard staffing for this operation will be 7 full time employees. These employees will be monitoring the garden and keeping the operations going on a day-to-day basis.

Two days a week there will be an additional crew of approximately 15 people who come to the facility in order to trim the cannabis flowers. This is an integral part of the process where by the flowers of the plant are removed from the stems of the plant. (More information on this subject in the *Cannabis Cultivation* section below)

We have had a Traffic Consultant, LSC Consultants, conduct a vehicle trips evaluation of the project. Their analysis has shown that there will be 62 one-way vehicles trips to the property every business day. The previous industrial use of an R&D Facility generated approximately 171 one-way vehicles trips per day to the property. The Cannabis Cultivation use will have a net negative impact of 109 one-way vehicle trips per day. Please see attached exhibit “Exhibit - Duke Court Cannabis Trip Generation” for more details.

DELIVERIES TO AND FROM BUILDING

All deliveries of sensitive plant material will be delivered into the loading bay of the facility, located in the North East corner of the building. This loading bay will act as a sally port, with the roll up door being closed and locked once the delivery vehicle is inside the loading area. There is another set of lockable doors on the inside of the building that will remain locked when the exterior roll up door is open. Likewise all export of finished plant material will be loaded into delivery vehicles within the loading area. This Sally Port design will prevent transfer of materials outside the building, adding further safety and security to the facility. Furthermore, all vehicles containing finished product will be unmarked vehicles with no indication of the contents of the cargo inside.

The below image is a diagram of the loading bay of the facility showing the existing exterior roll up door, and an interior set of doors to create a sally port.

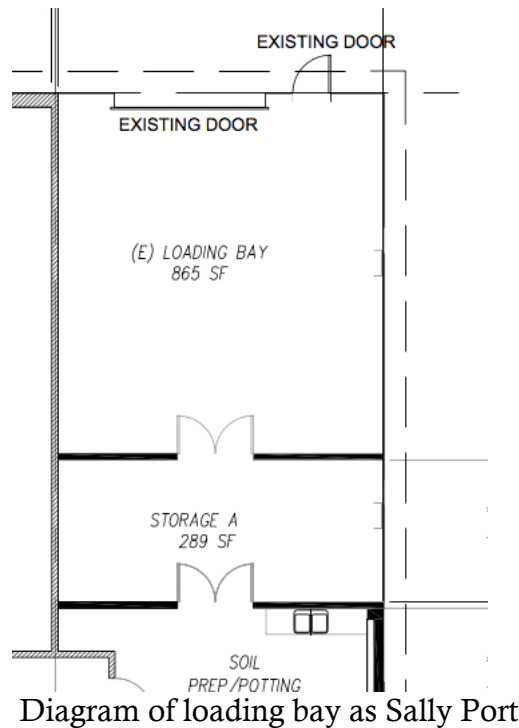

SECURITY

We will be implementing a security plan for this building consisting of Controlled Access to the building, 24 hour a day security, Monitored Security System, Access Control, Surveillance Cameras, Exterior Lighting and a front gate to secure the property.

Should there be any security or operational issues that arise, the building owner and the facility manager will be available 24 hours a day to respond to any concerns. The on duty security officer will have a phone list with emergency contact numbers on it for all ownership and management personnel.

Access to Building:

Only registered and known individuals will be able to access this building. There is no public facing dispensing of medical product, and there is no public access of any kind to the building. Only individuals that have an appointment, or who are members of staff will be admitted to the facility.

All staff members will be subject to criminal background checks as a part of their application for employment at the facility.

24/7 Security Guards:

First Security Services, a Santa Rosa security company, will provide full time manned security at the facility. This individual will be stationed at the front of the building with an

unobstructed view of the entrance to the parking lot of the facility. In the security room of the facility, there will be a bank of monitors that shows live feeds from all of the security cameras throughout the building. This individual will be briefed to know all acceptable employee personnel who are allowed to enter the building, and will also be provided with a list of scheduled deliveries on any given day. This guard will be responsible for monitoring the camera footage, conducting patrols of the exterior of the building, and providing a presence at the facility at all times. If any situation arises that cannot be handled by the security guard, they will notify law enforcement, facility management and building ownership immediately.

Please see attached "Exhibit - First Security Proposal" for more information pertaining to the Security Guard.

Monitored Alarm System:

The Monitored security system will feature a commercial alarm control panel. Each perimeter door and window to the facility will be alarmed and linked to the central control panel. The existing windows of the facility are non-operable and cannot be opened. They will remain as inoperable under the new facility use. Internal motion sensors will be installed and if triggered after normal operating hours, will alert the Security Guard, the Security Company, the Building Owner, the Tenant and Law Enforcement.

Access Controls:

The main entrance of the building will feature access code keys to allow entry into the building for approved members of staff only. The first room entered into the facility will be a security office. This security office will be the only area accessible through the front entrance. To gain further access into the building, there will be another set of locked doors within the security office. Effectively, the security room will act as a sally port. The security guard on duty will control any access further into the building.

During office hours any entrants to the building will have to enter through the main entrance. There is a roll up door at the rear of the facility that will be locked and secured from the inside, with only expected deliveries being allowed into the loading area. This area is the loading bay and is where all sensitive incoming material and all outgoing finished plant material will be loaded and unloaded. There are also several fire escape doors located around the property. These fire escape doors will be inoperable from the exterior and feature push bars for exit from the inside. They are also designed as Sally Ports with double layers of doors. If any of these fire doors are opened, it will alert the alarm system and the security guard.

After hours entrance will be controlled by a keypad with the only entrance to the building being the main entrance. This key pad entry will enter directly into the Security room where a security guard will be on duty at all times.

Duress Alarms:

The facility will feature silent duress alarms that allow employees of the facility to trigger an alarm without a siren call to ensure the safety of the employees in a robbery scenario. This is similar to silent alarms in banks. If this alarm is triggered, the Security Guard, facility management and Law Enforcement will be immediately notified.

Monitored Security Cameras:

Surveillance Cameras will be installed at each perimeter door to the facility and strategically on the outside of the building covering the exterior of doors, loading bay, driveway of the facility and the parking lot area. The security room (entrance to facility) will have a camera with high enough resolution to identify faces located such that any persons entering the facility will be recorded. Every fire escape door and the roll up door in the rear of the building will have cameras to record all activity. All cameras will have feeds that link into the security office for monitoring by the security guard on duty. All recordings from the security cameras will be recorded onsite and will be backed up offsite daily. Any suspicious activity will be reported immediately to Law Enforcement.

Exterior Lighting:

The building will have exterior lighting around all doors and entrances to the building. This lighting will be on from dusk until dawn every night. Exterior lighting is a proven deterrent to theft as darkness provides cover for nefarious activities. There is existing lighting in the parking lot, which will also be kept on during nighttime hours.

Facility Gate:

There is an existing low gate at the front of the building that will be closed after business hours to deter any vehicles from entering the parking lot of the building. This gate will have a Santa Rosa Fire Department approved locking mechanism (Knox Box) to enable fire access in case of an emergency. The gate is made from tubular steel and completely blocks the front of the building. The below picture indicates the type of gate that currently exists on the property.



Example Security Gate at Property

Product Security:

Once cannabis flowers have been matured, they will be cut and removed from the pots in which they grow. These cut plants will be transferred to a special drying room where they will be hung. This drying room will be locked at all times and only accessible by designated managerial personnel.

Once the plants have been sufficiently dried, they will be removed from the drying room and “bucked down” a process that consists of removing the flower material from the branches of the plants. This “bucked down” material will then be placed into a special Vault room.

The vault room will be another room that is locked at all times and only accessible to designated managerial personnel at the facility. When the trimming crew comes to the facility, individual containers of “bucked down” material will be taken out of the vault by designated personnel and moved to the trimming area. Once the flower material has been trimmed off the branches of the plant, all of the saved flowers will be placed into a flower bin, and the “trim” or leaves that are not flowers, but still have some desirable cannabinoids on their surface, will be placed in another bin. Both of these bins will be weighed and placed back into the vault when they are completed.

At all stages of the plants progress from growing, to harvest to trimming, a inventory management system that is compliant with the State of California’s Track and Trace program will be utilized to ensure no diversion of product to the illicit market. (Note, this system has yet to be developed at a State level. Once regulations have been published by the Bureau of Marijuana Regulation, we will select an appropriate system to be in compliance) Furthermore, if there are any discrepancies in the inventory management system, all staff members will be trained in a process to report the theft to management. If there is a report made, management will involve Law Enforcement and will comply with all requests for information.

CANNABIS CULTIVATION

OVERVIEW

Cannabis cultivation is one of the oldest occupations in human history. As a medicine, a fabric, a food and fuel source, and as a narcotic humans have benefitted by cultivating cannabis for over 10,000 years. Esteemed Harvard professor and ethnobotanist Richard Evans Schultes tells us that cannabis, “has been carried across continents, cultivated in many different environments, escaped widely as a weed and, at least in certain areas of central Asia, may have hybridized with *C. Indica*” (Schultes, 1981). Although cannabis has evolved without becoming dependent on human participation (something unique among agricultural cultivars), its evolution is inextricably linked with our own.

The cultivation of cannabis is a scientific as well as artistic enterprise. A good scientific approach can yield consistent results, produce medicines of unparalleled versatility, prevent

abiotic and biotic disorders, and encourage further exploration into the value of cannabis in human life. It is, however, the botanical artistry, the mutual allurements engendered by participating intimately with the life cycles of cannabis that draws one in and inspires one to cultivate not simply medicine, but also beauty.

CATEGORIES OF OPERATION

Within the cultivation facility there will be six major categories of “in house” operation.

PROPAGATION

All productive cultivation facilities require a consistent and dependable supply of new plants. Reproduction may occur through seed germination or “cloning”, a form of vegetative propagation that ensures consistent genetic identity.

VEGETATION

A thriving vegetation room is crucial for our floriculture system. Healthy vegetative plants exhibit robust root systems and an abundance of disease-free foliage and future flowering sites. The vegetative process is the foundation for the successful and abundant cultivation of medical cannabis.

FLORICULTURE

Through careful attention and best management practices cultivators will produce pure cannabis flowers rich in medicine, taste, and floral aroma.

HARVEST—DRYING

When Cannabis flowers have reached maturity and ripeness, as indicated by the progression of pistil, calyx, and trichome development, cultivators will harvest and slowly dehydrate the flowers in order to preserve medicinal integrity.

TRIMMING

Trimming cannabis flowers separates three essential products for the commercial medical cannabis industry: (1) manicured cannabis flowers, (2) trim, the medicinally rich leaves surrounding the flower calyxes that are trimmed off in the manicuring process, and (3) “larf” wispy flowers that are too small to be displayed on medical cannabis dispensary shelves. Once cured (see description below) the manicured flowers are market-ready. The trim and larf, in contrast, provide material for secondary “off site” processing, such as with essential oil extraction, medicinal edibles production, specialty packaging (as with the rolling and packaging of “joints”), etc.

CURING

Curing refers to the last stage of cannabis cultivation, whereby any remaining chlorophyll in the flower tissue is broken down through further dehydration. This slow and patient process is essential for preserving clarity of medicine, aroma, and flavor.

CANNABIS ODOR MITIGATION

Medical cannabis cultivation is a highly fragrant initiative. Mitigating odors from the cultivation facility is necessary for security measures as well as maintaining amicable relations with neighbors. Ventilation exhaust air must be filtered and strict operating procedures must be observed to isolate cannabis odors to growing and processing environs. The cultivation facility at 2835 Duke Ct. will be equipped with air filtration systems that purify all incoming and outgoing air.

All ventilation air entering the building will pass through HEPA (High Efficiency Particulate Arrestance) filters. These filters are commonly used in medical facilities, aircraft and the automotive industry. The filters remove 99.97% of all particulates from air that passes through them. The picture below is an example of a HEPA filter.



HEPA FILTER

The rooms where cannabis is actively being grown and processed will have several layers of activated Carbon filtration happening within them. Activated Carbon works via a process called adsorption, whereby pollutant molecules in the air to be treated are trapped inside the pore structure of the carbon substrate. One pound of Activated Carbon has the surface area of 100 acres of land. Carbon filtering is commonly used for water purification, in air purifiers and industrial gas processing, for example the removal of siloxanes and hydrogen sulfide from biogas. We use “The Original Can” filters, which are the original Activated Carbon filters and remain the best product available. These filters have a life span of one year and will be replaced annually. The Exhibit, “Exhibit - CAN Filters Sourcebook Information” has further details on the CAN 150 Air filter. Pictured Below.



The Original Can Activated Carbon Filter

The first line of filtration happens in something called a Scrubber. Scrubbers are simply fans with an Activated Carbon Filter attached to them. The air in the room is pulled into the fan and pushed through the Activated Carbon Filter. The Scrubber is recirculating constantly which helps with air movement and de-stratification within the room and also removes a majority of the ambient smell that is generated from the plants.

The second line of filtration happens with the exhaust air from the rooms. All rooms where cannabis is grown and processed will have a single point exhaust air with an Original Can Activated Carbon filter attached to it. Exhausting from the flower rooms will happen periodically throughout the day.

The final aspect of the odor control process is negative pressure. The whole building is under subtle negative pressure. The air filtration systems are designed such that there is always air being pulled out of the building through Activated Carbon filters. If a door is opened to the outside, the negative pressure within the building will suck in through that door, preventing any existing air within the facility from escaping.

All air out of the building will have passed through at least 3 layers of filtration and smell mitigation before returning to the outside environment. The system we have outlined above has been implemented in all of our previous projects and is a proven and effective way of reducing all smell from the cultivation operation.

In the event of a power outage, an emergency back up generator will be installed at the facility that will be dedicated to running the environmental systems to ensure that any odor from the facility will be contained and mitigated.

CULTIVATION WATER USE AND EFFLUENT

One benefit of cultivating medical cannabis indoors is that the operator has more control over the climate, the amount of water used for production, and the amount of effluent that drains from potted plants. For 2835 Duke Ct. we estimate our cultivation-related water use to be 2,500 – 3,000 gallons/day. Correspondingly, we estimate our cultivation-related effluent to be 300 - 450 gallons/day (roughly 10-15% of water input).

We are committed to supporting the city of Santa Rosa in the effort to regulate/assess both water used and also water wasted in the production of medical cannabis. Our cultivation water supply will be isolated and metered to provide specific data on the amount of water our facility uses for cultivation. Correspondingly, we will consolidate the drainage into a central process waste pipe that is separate from sewage; and provide secure manhole access for city personnel to test and meter effluent prior to its entry into the sewage system.

NOISE

The Duke Court Facility is will be using a Trane Model RTAC 140 Chiller. This single chiller will provide all of the cooling for the project. In the attached document “Exhibit - Trane Chiller Noise Info” a decibel rating spreadsheet has been provided. Currently the city of Santa Rosa has an ordinance stating that the decibel level at the property line cannot exceed 70 decibels in Industrial areas. The Cooling unit that has been chosen falls within that sound level with a decibel rating of 68 decibels. Furthermore, the Chiller Unit will be situated close to the building with approximately 75 feet of distance from the chiller unit to the property line. The sound level of the chiller will be below the 70-decibel threshold when it reaches the property line.

Due to the industrial nature of the surrounding properties and the rail spur for the SMART train that passes immediately adjacent to the property, we do not anticipate our additional equipment having a significant impact on the surrounding area. Furthermore, there are a large number of mature trees used as landscaping throughout the north end of the property facing the residential uses that will help reduce any noise impacts.

Unit Location

Table 2 — Sound Pressure Levels End Opposite Control Box

Unit Size RTAC	A-Weighted Sound Pressure Level, dBA, ref 20 micro Pa	
	60 Hz @ 30 ft	50 Hz @ 10 m
140 STD	68.0	64.0
155 STD	69.0	65.0
170 STD	70.0	65.0
185 STD	70.0	66.0
200 STD	71.0	67.0
225 STD	71.0	NA
250 STD	71.0	67.0
275 STD	72.0	68.0
300 STD	72.0	69.0
350 STD	73.0	68.0
375 STD	NA	69.0
400 STD	74.0	70.0
450 STD	74.0	NA
500 STD	74.0	NA
140 HIGH	69.0	65.0
155 HIGH	70.0	65.0
170 HIGH	70.0	66.0
185 HIGH	71.0	67.0
200 HIGH	71.0	67.0
225 HIGH	71.0	NA
250 HIGH	71.0	67.0
275 HIGH	72.0	68.0
300 HIGH	73.0	69.0
350 HIGH	73.0	69.0
375 HIGH	NA	70.0
400 HIGH	74.0	70.0

Table 3 — Sound Pressure Levels Control Box End

Unit Size RTAC	A-Weighted Sound Pressure Level, dBA, ref 20 micro Pa	
	60 Hz @ 30 ft	50 Hz @ 10 m
140 STD	67.0	63.0
155 STD	68.0	64.0
170 STD	69.0	64.0
185 STD	69.0	65.0
200 STD	70.0	66.0
225 STD	70.0	NA
250 STD	70.0	66.0
275 STD	71.0	67.0
300 STD	71.0	68.0
350 STD	72.0	67.0
375 STD	NA	68.0
400 STD	73.0	69.0
450 STD	73.0	NA
500 STD	73.0	NA
140 HIGH	68.0	64.0
155 HIGH	69.0	64.0
170 HIGH	69.0	65.0
185 HIGH	70.0	66.0
200 HIGH	70.0	66.0
225 HIGH	70.0	NA
250 HIGH	70.0	66.0
275 HIGH	71.0	67.0
300 HIGH	72.0	68.0
350 HIGH	72.0	68.0
375 HIGH	NA	69.0
400 HIGH	73.0	69.0

Can-Filters Group Inc.
Filters, Fans and Accessories

source BOOK

5

The Original
Can-Filters®
canfilters.com

ACTIVE
CAN-LITE™
FILTER

Max-Duct™

The Original
Can-Filters®
canfilters.com

Max-Fan™

The Original
Can-Fan®
canfilters.com

canfilters.com

Can-Filters Group Inc.

Office Hours: 7:30am – 5:00pm PST

Phone 1-250-825-2722

Toll Free 1-800-825-4288

Fax 1-250-825-2723

**Customer Service: Arin Calder
and Kathy Tricker**

email: arin@canfilters.com

Phone Extension: 2

Returns: returns@canfilters.com

**Director of Sales and Marketing
Dennis Langlois**

email: dennis@canfilters.com

Phone Extension: 1

Cell: 250-354-2993

Canadian Sales: Brandon Arcuri

email: brandon@canfilters.com

Phone Extension: 7

Cell: 250-551-3843

Canadian Accounting: Cindy Gavin

email: cindy@canfilters.com

Phone Extension: 4

USA Accounting: Stacey Carter

email: stacey@canfilters.com

Phone Extension: 8

East Coast Sales: Matt Sherman

email: matt@canfilters.com

Cell: 704-596-8983

Locations

Charlotte

Distribution

Sacramento

Distribution

Nelson

Head Office
Manufacturing
Distribution

2722 Highway 3A
Nelson, BC
CANADA, V1L 6L6

Europe

CanFilters BV
Manufacturing
Distribution

Ameide Holland
canfilters.nl



Can-Filters Group Inc.

Filters

Can-Filters®
Max-Filter™
Can-Lite™

Fans

Max-Fan™
Q-Max™
Max-Fan™ PRO SERIES
Can-Fan® HO
Can-Fan® S Series

Accessories

Speed Control
Finger Guards
Backdraft Dampers
Ducting
Flanges
Long Term Storage Bags
Mufflers

canfilters.com



Can-Filters Group Inc. / Can USA Inc. Terms and Conditions of Business

Pricing: Subject to change without notice.

Product: We reserve the right to change, modify or improve our products at any time without notice. Information contained in this product book is subject to change at any time. All data is as accurate as possible at the time of printing.

Purchase Orders: Purchase Orders must be either faxed to 250-825-2423 or emailed to arin@canfilters.com.

Return Merchandise Authorization: (Warranty / Defective Merchandise)

If you have a product that needs to be returned to us, please contact our Administration Office by phone 800-825-4288 ext. 2, by fax 250-825-2723 or email returns@canfilters.com. Please list all products you wish to return and the reason for the return for each item including serial number(s). When contacting us for an RMA be prepared to tell us the original invoice that a product was purchased on. Every product returned requires an RMA number. Shortly after you contact us you will receive a written RMA confirmation via email or fax. Please do not send back ANY items not part of your original RMA. You will need to call us for a new RMA if you have additional items that you want to send back. Your written RMA confirmation will include shipping instructions. Compensation for merchandise will be credited to your account. No cash refunds.

Warranty: Can-Fans® and Max-Fans™ are warranted against defects in material and workmanship for a period of five (5) years from date of purchase.

Warranty Does Not Apply To:

- (a) Shipping damage, either concealed or visible. Claims must be filed with carrier.
- (b) Damage caused by improper installation, wiring, or connection to incorrect electrical voltage.
- (c) Goods that have been modified or altered.
- (d) Damage caused by corrosion, abrasion, or severe temperatures.
- (e) Goods that have had identification labels removed or altered.
- (f) Goods that have been subjected to improper maintenance, abuse, misuse, abnormal usage, or accident.
- (g) Warranty does not cover the cost of removal or reinstallation of a unit when service or warranty work is required.
- (h) Installation of a unit is by others. Warranty does not cover faulty installation or damage to personal property resulting from incorrect or faulty installation.

These warranties give specific legal rights and are subject to any applicable consumer protection legislation. Additional rights, which may vary according to local jurisdiction, may also apply. No other warranties, expressed, implied or written, shall apply to these goods. No responsibility will be accepted for any consequential or incidental damages, loss of property, revenues or profit, cost of removal, installation or re-installation, personal damage or loss of life, or for any breach of warranty, regardless of cause.

Merchandise Returns: (Non moving stock, etc.)

At our discretion we may accept returned merchandise. We will only take back new, unused merchandise in resalable condition. Products being returned will be assessed a minimum 15% restocking fee to cover administrative costs, labor, replacement packaging, etc. Product must be in its' original packaging. Collect shipments of returned goods will not be accepted. All product must be properly

packed and shipped prepaid. RMA number must be clearly written on the outside of packaging and a copy of the RMA letter must be included. A copy of the original Bill of Sale to verify purchase date must be included. If merchandise is received back in condition other than described above or if it is damaged in shipment, we will be unable to give credit on the merchandise. Return items must be a current model and less than one year since purchase. The return of any special, non-stock, obsolete, or non-saleable merchandise will not be accepted. Compensation for returned merchandise will be credited to the customers account. No cash refunds.

Freight: F.O.B. Sacramento, CA. and Charlotte, NC: Freight is prepaid on all orders over your free freight minimum as noted on your credit application. On all orders under your free freight minimum, freight charges will be prepaid by Can USA and added to the invoice.

Freight Damage and Shortages: All claims must be made with the carrier. At the time of delivery, make sure there is no damage or any shortages. If there is, it must be noted on the Delivery Receipt at the time of delivery. If time does not permit you to inspect the shipment at the time of delivery, note on the bill of lading "subject to count & inspection" before signing for the order.

If the Bill of Lading is signed as complete / undamaged and at a later point damage or shortages are found, you will be unable to receive compensation.

Financial Terms: New accounts must fill out account application and agree to allow Can USA to check vendor references. New accounts will be on a prepay basis. All credit card payments are subject to a 1.75% administration fee. (credit cards are not accepted in Canada) If credit is requested a credit application and personal guarantee must be filled out and submitted.

- (a) A 2% per month service charge is assessed for all invoices over 30 days.
- (b) Can USA reserves the right to place the debtor on "Stop Ship" or Prepaid without notice, in event of default, remittance(s) without sufficient funds (NSF) or for any other reason. A \$40.00 service fee will be assessed for all NSF checks.
- (c) Orders to accounts with past due balances will be held until the account becomes current even if the account is under the established credit limit.
- (d) Payments must be received by Can USA in order for held orders to be released. Verbal assurances the check has been sent will not cause held orders to be released. In this situation, please consider sending a check overnight, or ACH payment to expedite shipment of a future order.
- (e) Accounts with balances aged over 90 days will be turned over for collection. All collection costs and attorney fees will be incurred by the client if they are not paid as agreed. These fees will be 25 – 50% of the principal, depending on if the collection goes to court or not.
- (f) If you require a significant credit line with us, we may require a copy of a customers financial statements to evaluate prior to granting credit.

Note: Legal title & ownership of merchandise supplied by Can USA does not transfer to a customer until the goods are paid for in full. The merchandise remains the property & collateral of Can USA until full payment has been received.

About Can-Filters Group

The CF Group was incorporated in 2000 as a North American Manufacturing and Distribution company. Part of our strength extends from our alliances with world class manufacturers who bring research and development capabilities to the mix. The CF Group has manufacturing and distribution in: Nelson BC, Sacramento California and Charlotte North Carolina.

Our alliances bring additional manufacturing facilities in Holland, Germany and Romania.

Our long term approach to business requires our commitment to quality control, innovation, and smooth distribution. Recognition of market demands and a willingness to work with you, the customer.



The Original
Can-Filters®
canfilters.com



Filter Applications:

- VOC Removal
- Pollution Control
- Paint Booth
- Greenhouses
- Laboratories
- Airports
- Manufacturing
- Waste Disposal
- Hair Salons
- Clean Rooms
- Hospitals
- Fabrication
- Cafeterias
- Schools
- Locker Rooms
- Pet Odors



The Original Can Filters® are designed for the control of VOCs (paint fumes, hydrocarbons, etc...), odors, and other gaseous contaminants. Built with a proven Packed Bed Design and Pelletized Virgin Activated Carbon. This line of time tested Activated Carbon Air Filters sets the standard for Long Life, Consistent Performance, and Low Pressure Drop. Rated at a conservative 0.1 sec Contact Time, The Original Can-Filters® provide excellent value and confidence.

40 cm (16") Activated Carbon Air Filters

Can 150 SKU: 358700

Recommended Exhaust CFM: 1260 CFM /

2100m³/h @ 0.1 sec contact time

Pre-filter: Yes

Flange: 10" - 12" - 14"

Dimensions: (with pre-filter)

- Outside Diameter: 42 cm / 16.5"
- Height: 150 cm / 60"

Total Weight: 71 kg / 156 lbs.

Carbon Weight: 56 kg / 123 lbs.

Carbon Bed Depth: 6.5 cm / 2.56"

Max Operating Temp: 80°C / 176°F

Pressure drop at max CFM: 180pa / .75"wg

Recommended Fan:

FAN	Filtered Air CFM	Watts
16" Max-Fan™	1410	322
14" Max-Fan™	1230	250
12" Max-Fan™	1440	480
12" Can-Fan® HO	888	290
10" Max-Fan™	907	227



The Original
Can-Filters®
canfilters.com

Can-Filters

Can 125 SKU: 358705

Recommended Exhaust CFM: 1020 CFM /

1700m³/h @ 0.1 sec contact time

Pre-filter: Yes

Flange: 8" - 10" - 12" - 14"

Dimensions: (with pre-filter)

- Outside Diameter: 42 cm / 16.5"
- Height: 125 cm / 49.2"

Weight: 58.6 kg / 129 lbs.

Carbon Weight: 48.6 kg / 103 lbs.

Carbon Bed Depth: 6.5 cm / 2.56"

Max Operating Temp: 80°C / 176°F

Pressure drop at max CFM: 180pa / .75"wg

Recommended Fan:

FAN	Filtered Air CFM	Watts
14" Max-Fan™	1120	248
12" Max-Fan™	1340	487
12" Can-Fan® HO	862	300
10" Max-Fan™	879	227
10" Can-Fan® HO	670	260
8" Max-Fan™	598	166



Response to Request for Proposal Security Guard Services

EXECUTIVE SUMMARY, CONTACTS, AND SCOPE OF SERVICES

First Alarm Security & Patrol Inc. dba
First Security Services

Dec., 2016

Legal Name of Firm

Date

1240 Briggs Avenue, Santa Rosa, CA

Firm Address

(707) 584-1110

Telephone Number

(707)528-3076

FAX Number

Corporation – State of California #C1649490
PPO # 11167

Type of Organization

Cal Horton, President and CEO

Name of Principal-in-Charge and Title

Teresa Huerta Larkin

Chief Administrative Officer – Registered Agent on behalf of Corporation

Cal Horton, President and CEO Phone: (831) 818-1111

or

Teresa Huerta Larkin, Chief Administrative Officer - Phone: (831) 239-1963

Name, Title and Phone Number of person To Whom Correspondence Should be Directed

1731 Technology Drive, Suite 800 – San Jose, CA 95110

Address Where Correspondence Should Be Sent

Uniformed Security Services

Areas of Responsibility of Prime Contractor

77-0237870

Federal Tax ID Number

NAICS 561612 –CCR Registered – GSA Application in Progress

NAICS CODE – CCR/SBA/Local Certifications

SCOPE OF SERVICES

FIRST SECURITY SERVICES respectfully submits this proposal in response for Duke Collective, Inc. for armed and unarmed security guard Services proposes to provide:

- Unarmed, fully licensed, uniformed armed or unarmed security officer.
- Walking of areas of concern and interest as outlined in the POST Orders.
- Greeting and identifying visitors as required.
- Always aware of the nature of the business, and the security issues.
- Keeping all information about client site confidential at all times
- Being a very visible presence at all time to deter any criminal occurrences.
- Security Officers will adhere to POST Orders to be established between client and contractor specifying areas of concern. Including checking the areas of concern, buildings, common areas, maintenance issues, parking areas. Also, respond to all calls for service during hours of operation from staff.
- Security rounds will be recorded in REAL TIME, and transmitted in real time, or transmitted at the opening of the clients business that day. First Security Services has launched a proprietary security reporting system that is far superior to any so far developed. We are very proud to offer this reporting system to our clients. It is called **First Watch**, and acts as a management tool for First Security managers, and a verification tool for our valued clients.

- **Here is how it works:**

- **THE PATROL OFFICER/SITE SECURITY OFFICER USING AN ANDROID PHONE, OR TABLET AS A PLATFORM SCANS TAGS LOCATED IN AREAS OF INTEREST AT THE CONSTRUCTION SITE. THIS IS RECORDED ON THE SPOT WITH TIME AND DATE, SO THE CLIENT KNOWS EXACTLY THE DATE, TIME, AND LOCATION THAT WE MADE ROUNDS.**
- **IN ADDITION THE OFFICER WILL NOTE IN THE TEXT MODE ANY OBSERVATIONS THAT THE CLIENT SHOULD KNOW ABOUT SUCH AS CONTACT WITH HOMELESS, PARKING LIGHTS OUT, GRAFFITI,**

CRIMINAL ACTIVITY AND SO FORTH. PICTURES ARE ALSO TAKEN, AND TRANSMITTED OF THE AREA, OR ISSUE.

- **THESE FILES ARE STORED FOR FUTURE REFERENCE.**
- **THE ACCESS BY YOU THE CLIENT IS AS EASY AS OPENING UP ANY OTHER FILE, AND CAN BE DONE ANYTIME OF THE DAY FROM ANY LOCATION SERVED BY WI FI.**
- **THIS REPORTING SYSTEM ALONG WITH OUR 24/7 COMPUTERIZED ASSISTED DISPATCH SYSTEM WHERE PHONE CALLS FROM CLIENTS ARE ANSWERED WITHIN THREE RINGS MAKE FIRST SECURITY SERVICES NUMBER ONE IN REPORTING, AND COMMUNICATIONS WITH OUR CLIENTS.**
- **PLEASE LET US DEMONSTRATE IT FOR YOU. WE ARE THE ONLY SECURITY COMPANY TO OFFER THIS PROGRAM.**

ORGANIZATION

Founded in 1966 as *First Alarm* private security services (a sole proprietorship owned by Santa Cruz, California native, Jarl E. Saal), First Alarm applied a unique combination of electronic security and uniformed security guard protocols to provide efficient, integrated security solutions to Santa Cruz, Monterey, San Benito, Santa Clara, San Mateo, San Francisco, Alameda, Contra Costa, Sonoma, Mendocino and Napa County California residents and businesses. The *First Alarm* brand earned the reputation of quality, integrity and professionalism in the protection of life, property and private assets. *First Alarm* incorporated under California law on July 7, 1982. On January 1, 1990, First Alarm separated its uniformed security guard division from its electronic security division. The uniformed security guard division was reformed and incorporated under California law as First Alarm Security & Patrol, Inc. dba *First Security Services* (“FSS”) under the direction of Cal L. Horton, CPP, and managed by Michael Ferguson in the North Bay Area.

NORTHERN CALIFORNIA BUSINESS FOOTPRINT

The lion's share of First Security Services' California footprint rests in the San Jose, Silicon Valley area. It has developed and maintained a strong **North Bay presence for over 20 years.**

PUBLIC SECTOR EXPERIENCE

For over 15 years, First Security Services has provided security services to the public sector, including the State of California, City and County of Santa Cruz, County of Monterey, City of San Jose, County of Sonoma, County of Mendocino, City of Santa Rosa, Sacramento, Stockton, and Central Valley areas, as well as the federal government, numerous school districts and the military.



EMERGENCY BACK-UP CALL CENTER

Many regions of the state are able to predict and prepare for natural disasters – Northern California numbers among them. In the event of an emergency or natural disaster, First Alarm Security & Patrol and First Alarm's UL/FM certified Central Station will remain standing and operational as the City of San Jose Redevelopment Agency's emergency back up call center because it has been structurally designed and built to exceed federal and California's earthquake, flood and fire threat standards. Its wireless and energy regeneration back-up systems ensure continuous communication, even in the event of natural disaster or other attack.

MANAGEMENT (PARTIAL)

CAL L. HORTON, CPP

Cal L. Horton is the President of First Security Services. He is a board certified security protection professional (“CPP”); a member of the American Society for Industrial Security (“ASIS”); a member of the Board of Directors of California Association of Licensed Agencies, Guards & Associates (“CALSAGA”) and a member of the Certification Board for the CALSAGA Private Patrol Operator Certification Program. Mr. Horton holds an individual Patrol Operator license (under License No. 14024 - March, 2000), Associate in Science degree in Administration of Justice from Cabrillo College, is a graduate of Central Coast Police Academy at Gavilan College and holds a Basic P.O.S.T. Certificate as well as a current Emergency Medical Technician 1A (EMT-1A) certificate. Mr. Horton served on the Bureau of Security and Investigative Services (BSIS) industry advisory committee under Bureau Chief, Steve Giorgi and was instrumental in the development of compulsory security guard training legislation.

TERESA HUERTA LARKIN, LL.M, AMLA, CAPA™

Teresa Huerta Larkin is the Chief Administrative Officer and Director of Legal Affairs for First Security Services. She is a member of the American Society for Industrial Security (“ASIS”), a member of the California Association of Licensed Agencies, Guards & Associates (“CALSAGA”) and a member of the International Association for Healthcare Security & Safety (“IAHSS”).

Ms. Larkin holds a Bachelor of Science in Law, an Executive Juris Doctor, and a Master of Laws in the legal specialty of International Taxation and Finance Centers. She holds a Certificate of Expertise in Anti-Money Laundering & Compliance from Thomas Jefferson School of Law, San Diego, California, and an International Certification in Anti-Money Laundering Awareness (“AMLA”) from the International Compliance Association, West Midlands, and United Kingdom. Ms. Larkin is a Certified Asset Protection Analyst™ (“CAPA”) (with subject matter emphasis on immigration in international business planning) and is also designated as a Fellow of the American Academy of Financial Management...



MICHAEL FERGUSON – NORTH BAY REGIONAL BRANCH MANAGEMENT

COMBINED 44 YEARS OF LAW ENFORCEMENT AND SECURITY MANAGEMENT EXPERIENCE

Michael Ferguson has been the Regional Branch Manager for First Security Services North Bay Region since 2001 (Marin, Mendocino, Napa and Sonoma Counties). He is a member of the California Association of Licensed Agencies, Guards & Associates (“CALSAGA”) with an extensive background in public service, community involvement, and leadership. Mr. Ferguson worked for an urban law enforcement agency, and then with the Sonoma County Sheriff’s Department where he served with distinction until his retirement after thirty-two years as a law enforcement manager. During his law enforcement career, Mr. Ferguson supervised and managed numerous law enforcement units, and bureaus including patrol, crime prevention, investigations, search and rescue, tactical team, and court security. He taught at the Criminal Justice Training Center and for a private training company. He also served as an interim police chief. Before coming to First Security Services Mr. Ferguson served as the Field Operations Manager for the U.S. Census Bureau, with responsibility for managing 1300 enumerators in Northern California. Mr. Ferguson has degrees in Administration of Justice, and Criminal Justice. He also has thousands of hours of F.B.I. training, and Calif. state certified training.

He is very active in his community with 32 years of perfect weekly attendance at his Rotary Club, and has held many positions in philanthropic, and community organizations.

Mike is a hands on manager that is either working, and or on call to his clients and employees 24/7.

LOCAL REFERENCES

Marin County Airport

Contact: Dan Jensen/Airport Operations Coordinator

451 A-A Airport Rd.

Novato, CA. 94945

Phone: (415) 897-1264

Scope of Duties: Fifty six hours per week. Patrol vehicle/standing guard. Maintaining anti-terrorism protocols, and general security to avoid theft of expensive planes, and parts.

Goodwill Industries of the Redwood Empire

Corporate Offices

651 Yolando Ave.

Santa Rosa Ca.

Phone: 707-523-0550

Fax: 707- 523-0597

Contact: Jim Hennessey

Scope of Duties: Patrol duties at some stores, and pickup services at all Sonoma County stores.

Simi Winery

Contact: John Pritchard/Director of Operations

Healdsburg

Office phone #: 707-473-3206

Email: John.Pritchard@cbrands.com

Scope of Duties: 56 hours per week/seven days walking patrol of entire large facility checking on security issues, as well as plant equipment.

Many construction sites, wineries, shopping centers, industrial areas, apartments, mobile home parks, and so forth.

Many more references upon request, including several medical marijuana stores, and grow sites. Will discuss in person.

ENVIRONMENTALLY PREFERABLE (RECYCLE) PROCUREMENT POLICY

First Security Services is committed to alternative energy sources and recycling.

- Recycle: In its headquarters and in all branches, paper products, plastics and all aluminum cans are separated and managed through recycling/shred services.
-
- Purchase Recycle Paper: All printer matter is reproduced on recycle paper.
-
- Hybrid Vehicles: Management staff are encouraged to select Hybrid (Honda Civic electric battery) vehicles for business travel. Several on the executive management team drive Hybrid vehicles expressly for business use.
-
- Alternative Fuel Vehicles: First Security Services, and its sister company First Alarm, owns and uses three (3) alternative fuel source powered vehicles in its service fleet, including a NG Honda Civic.
-
- Energy Efficient Light Bulbs: Where possible, energy efficient light bulbs are used for office lamps and overhead lighting.



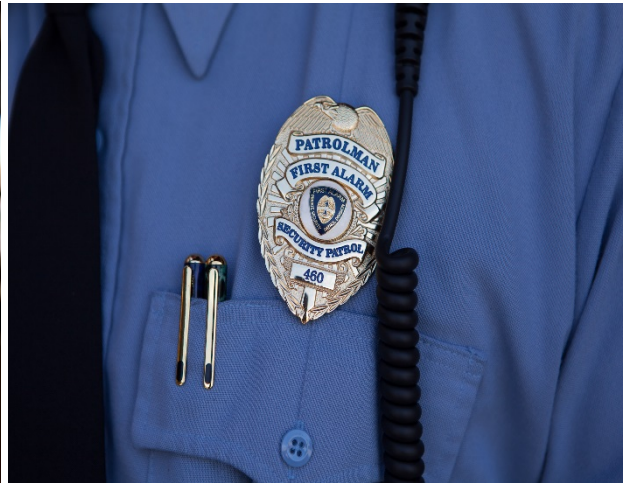

24/7 professional
Dispatch center

Uniforms of highest caliber

Security ~ Service ~ Integrity

24/7