

1. Contractor shall bid and install planting materials per these plans and specifications, unless given further written instructions, or written instruction by Landscape Architect. Work includes, but is not limited to all labor, general liability insurance, workman's compensation, equipment, and materials necessary to furnish, install and guarantee planting, as shown on the drawings and specified herein.
2. Coordinate field observations with Landscape Architect (minimum 2 visits), call to provide 48 hour notice.
 - A. Review finished grade w/ Landscape Architect prior to plant placement. All plants shall be inspected by arborist/Landscape Architect for health, percent canopy and size prior to layout.
 - B. Layout plantings for approval in full quantities, prior to digging holes. Adjust layout as directed by Landscape Architect.
3. Contractor shall provide submittals/samples to Landscape Architect of all specimen trees (photographs with human scale), soil, mulch, stakes, ties, arborist tablets, grass pave materials, steel edging, and other materials.
4. All work shall conform to the latest applicable Sonoma County Water Agency ordinances relating to planting and irrigation. All plant materials to be installed per City of Santa Rosa standards and planting details. The plants/materials shall conform to the plant legend specification for size & latest edition of the American nurseryman standards.
5. Prior to removing any plants, contractor shall obtain approval of owner and Landscape Architect to determine specimens to remain or be transplanted. All planting areas are to be free of deleterious materials and weeds prior to planting.
6. A soil fertility test shall be required for review by the Landscape Architect after grading is complete and before any plant work. A soil test shall be performed to determine the final amendment and fertilizer formula. The soils report conducted by Waypoint Analytical, (408) 727-0330, unless otherwise approved) must contain the following information:
 - A. Soil permeability rate in inches per hour
 - B. Soil texture test
 - C. Cation exchange capacity
 - D. Soil fertility including tests for nitrogen, potassium, phosphorous, p, organic matter
 - E. Total soluble salts and sodium content
 - F. Contractor to request a "Boy-Friendly" Recommendation for amendments to the planting area soil
7. A minimum of 8" of non-mechanically compacted soil shall be available for water absorption and root growth in planted areas. Within the limits of new planting areas, the top 12" of existing soil or to the extent of existing topsoil, which ever is less, shall be stripped and stockpiled on the site for re-use. All planting areas to be tilled so as to soil loose and not compacted. All planting beds to receive a minimum of 12" of approved topsoil. To prepare planting beds at lawn areas, cultivate into top 12" of soil 6 cubic yards of organic compost per 1,000 square feet. Compost is to have the US Composting Council's Seal of

8. All plant locations to be confirmed in the field by the Landscape Architect. Contractor is to coordinate all planting with utility locations not shown on this plan. Any conflicts between locations of proposed planting and site utilities or lighting to be called to the attention of the Landscape Architect.
9. Layout of plantings is diagrammatic and may need field adjustments for existing site conditions not shown on plans, or as directed by the Landscape Architect. Adjustments will be made for views, access, etc. All plantings shall be field adjusted to meet the minimum state regulations for planting and maintaining a defensible space. Dept. of Forest Practice Planting and Maintenance Manual, 1998, 1999, 2000, 2001, 2002, 2003, 2004, 2005, 2006, 2007, 2008, 2009, 2010, 2011, 2012, 2013, 2014, 2015, 2016, 2017, 2018, 2019, 2020, 2021, 2022, 2023, 2024, 2025, 2026, 2027, 2028, 2029, 2030, 2031, 2032, 2033, 2034, 2035, 2036, 2037, 2038, 2039, 2040, 2041, 2042, 2043, 2044, 2045, 2046, 2047, 2048, 2049, 2050, 2051, 2052, 2053, 2054, 2055, 2056, 2057, 2058, 2059, 2060, 2061, 2062, 2063, 2064, 2065, 2066, 2067, 2068, 2069, 2070, 2071, 2072, 2073, 2074, 2075, 2076, 2077, 2078, 2079, 2080, 2081, 2082, 2083, 2084, 2085, 2086, 2087, 2088, 2089, 2090, 2091, 2092, 2093, 2094, 2095, 2096, 2097, 2098, 2099, 2100, 2101, 2102, 2103, 2104, 2105, 2106, 2107, 2108, 2109, 2110, 2111, 2112, 2113, 2114, 2115, 2116, 2117, 2118, 2119, 2120, 2121, 2122, 2123, 2124, 2125, 2126, 2127, 2128, 2129, 2130, 2131, 2132, 2133, 2134, 2135, 2136, 2137, 2138, 2139, 2140, 2141, 2142, 2143, 2144, 2145, 2146, 2147, 2148, 2149, 2150, 2151, 2152, 2153, 2154, 2155, 2156, 2157, 2158, 2159, 2160, 2161, 2162, 2163, 2164, 2165, 2166, 2167, 2168, 2169, 2170, 2171, 2172, 2173, 2174, 2175, 2176, 2177, 2178, 2179, 2180, 2181, 2182, 2183, 2184, 2185, 2186, 2187, 2188, 2189, 2190, 2191, 2192, 2193, 2194, 2195, 2196, 2197, 2198, 2199, 2200, 2201, 2202, 2203, 2204, 2205, 2206, 2207, 2208, 2209, 2210, 2211, 2212, 2213, 2214, 2215, 2216, 2217, 2218, 2219, 2220, 2221, 2222, 2223, 2224, 2225, 2226, 2227, 2228, 2229, 2230, 2231, 2232, 2233, 2234, 2235, 2236, 2237, 2238, 2239, 2240, 2241, 2242, 2243, 2244, 2245, 2246, 2247, 2248, 2249, 2250, 2251, 2252, 2253, 2254, 2255, 2256, 2257, 2258, 2259, 2260, 2261, 2262, 2263, 2264, 2265, 2266, 2267, 2268, 2269, 2270, 2271, 2272, 2273, 2274, 2275, 2276, 2277, 2278, 2279, 2280, 2281, 2282, 2283, 2284, 2285, 2286, 2287, 2288, 2289, 2290, 2291, 2292, 2293, 2294, 2295, 2296, 2297, 2298, 2299, 2300, 2301, 2302, 2303, 2304, 2305, 2306, 2307, 2308, 2309, 2310, 2311, 2312, 2313, 2314, 2315, 2316, 2317, 2318, 2319, 2320, 2321, 2322, 2323, 2324, 2325, 2326, 2327, 2328, 2329, 2330, 2331, 2332, 2333, 2334, 2335, 2336, 2337, 2338, 2339, 2340, 2341, 2342, 2343, 2344, 2345, 2346, 2347, 2348, 2349, 2350, 2351, 2352, 2353, 2354, 2355, 2356, 2357, 2358, 2359, 2360, 2361, 2362, 2363, 2364, 2365, 2366, 2367, 2368, 2369, 2370, 2371, 2372, 2373, 2374, 2375, 2376, 2377, 2378, 2379, 2380, 2381, 2382, 2383, 2384, 2385, 2386, 2387, 2388, 2389, 2390, 2391, 2392, 2393, 2394, 2395, 2396, 2397, 2398, 2399, 2400, 2401, 2402, 2403, 2404, 2405, 2406, 2407, 2408, 2409, 2410, 2411, 2412, 2413, 2414, 2415, 2416, 2417, 2418, 2419, 2420, 2421, 2422, 2423, 2424, 2425, 2426, 2427, 2428, 2429, 2430, 2431, 2432, 2433, 2434, 2435, 2436, 2437, 2438, 2439, 2440, 2441, 2442, 2443, 2444, 2445, 2446, 2447, 2448, 2449, 2450, 2451, 2452, 2453, 2454, 2455, 2456, 2457, 2458, 2459, 2460, 2461, 2462, 2463, 2464, 2465, 2466, 2467, 2468, 2469, 2470, 2471, 2472, 2473, 2474, 2475, 2476, 2477, 2478, 2479, 2480, 2481, 2482, 2483, 2484, 2485, 2486, 2487, 2488, 2489, 2490, 2491, 2492, 2493, 2494, 2495, 2496, 2497, 2498, 2499, 2500, 2501, 2502, 2503, 2504, 2505, 2506, 2507, 2508, 2509, 2510, 2511, 2512, 2513, 2514, 2515, 2516, 2517, 2518, 2519, 2520, 2521, 2522, 2523, 2524, 2525, 2526, 2527, 2528, 2529, 2530, 2531, 2532, 2533, 2534, 2535, 2536, 2537, 2538, 2539, 2540, 2541, 2542, 2543, 2544, 2545, 2546, 2547, 2548, 2549, 2550, 2551, 2552, 2553, 2554, 2555, 2556, 2557, 2558, 2559, 2560, 2561, 2562, 2563, 2564, 2565, 2566, 2567, 2568, 2569, 2570, 2571, 2572, 2573, 2574, 2575, 2576, 2577, 2578, 2579, 2580, 2581, 2582, 2583, 2584, 2585, 2586, 2587, 2588, 2589, 2590, 2591, 2592, 2593, 2594, 2595, 2596, 2597, 2598, 2599, 2600, 2601, 2602, 2603, 2604, 2605, 2606, 2607, 2608, 2609, 2610, 2611, 2612, 2613, 2614, 2615, 2616, 2617, 2618, 2619, 2620, 2621, 2622, 2623, 2624, 2625, 2626, 2627, 2628, 2629, 2630, 2631, 2632, 2633, 2634, 2635, 2636, 2637, 2638, 2639, 2640, 2641, 2642, 2643, 2644, 2645, 2646, 2647, 2648, 2649, 2650, 2651, 2652, 2653, 2654, 2655, 2

OUR PLANTING PLAN INFLUENCES THE IRRIGATION PLAN BY PROVIDING PLANTING AREAS WITH DISTINCT HYDROZONES. HYDROZONES ARE GROUPINGS OF PLANTS WITH SIMILAR WATER REQUIREMENTS. THIS GREATLY AIDS IN THE EFFICIENT USE OF LANDSCAPE WATER. THE PLANTING PLAN ALSO TAKES INTO CONSIDERATION SOLAR EXPOSURE AND ASPECT, ADJACENT LANDSCAPE FEATURES AND BUILDINGS, SOIL TYPES AND MICROCLIMATES, ALL OF WHICH FACTOR INTO THE DESIGN OF HIGHLY EFFICIENT IRRIGATION SYSTEMS.

(2) 15 G.C. TREE = 6" DBH OR (1) 24" BOX TREE = (3) 15 G.C. TREE

PROPOSED REPLACEMENT TREES:
(17) 24" BOX TREE = 146" DBH
TOTAL 146" DBH

| KEY | BOTANICAL NAME | WUCOLS | COMMON NAME | SIZE | QTY | REMARKS |
|----------------------|-------------------------------|--------|--------------------|---------|-----|-----------------------|
| STREET / SHADE TREES | | | | | | |
| AR | ACER RUBRUM | M | RED MAPLE | 24" BOX | | - SINGLE TRUNKED FORM |
| AC | ASCULUS CALIFORNICA | L | CALIFORNIA BUCKEYE | 24" BOX | | - MULTI TRUNKED FORM |
| AM | ABUTILON MARINIA | L | STRAWBERRY TREE | 24" BOX | | - SINGLE TRUNKED FORM |
| PA | PAEONIA MOUTANSII | L | COLEMANIAN TREE | 24" BOX | | - SINGLE TRUNKED FORM |
| MG | MAGNOLIA G. 'MAJESTIC BEAUTY' | M | SOUTHERN MAGNOLIA | 24" BOX | | - SINGLE TRUNKED FORM |
| QA | QUERCUS AGROBOLIA | VL | COAST LIVE OAK | 24" BOX | | - SINGLE TRUNKED FORM |
| QU | QUERCUS GRANATA | VL | VALLEY OAK | 24" BOX | | - SINGLE TRUNKED FORM |
| ZS | ZELKOVA SERRATA | M | SAW LEAF ZELKOVA | 24" BOX | | - SINGLE TRUNKED FORM |

| ACCENT TREES | | | | | |
|--------------|--------------------------|----|---------------------|---------|-----------------------|
| AU | ARBUTUS UNEDO | L | STRAWBERRY TREE | 15 GAL | - SINGLE TRUNKED FORM |
| CR | CHIONANTHUS RETUSUS | M | CHINESE FRINGE TREE | 15 GAL | - SINGLE TRUNKED FORM |
| CO | CERCIS OCCIDENTALIS | VL | WESTERN REDBUD | 24" BOX | - SINGLE TRUNKED FORM |
| CT | X CHITALPA TASHKENTENSIS | L | CHITALPA | 15 GAL | - SINGLE TRUNKED FORM |
| LG | LAGERSTROEMIA SSP. | L | CRAPE MYRTLE | 15 GAL | - SINGLE TRUNKED FORM |

| | | | | | | |
|----|-----------------------------|---|----------------------|--------|---|--------------------|
| HS | HELICTOTRICHON SEMPERVIRENS | L | BLUE OAT GRASS | 1 G.C. | - | 2' O.C. d. SPACING |
| LR | LOMONDRA LONGIFOLIA | L | MAT RUSH | 1 G.C. | - | 4' O.C. d. SPACING |
| ML | MUHLENBERGIA RIGENS | L | DEER GRASS | 1 G.C. | - | 3' O.C. d. SPACING |
| PA | PENNISETUM ALOPECUROIDES | L | DWARF FOUNTAIN GRASS | 1 G.C. | - | 2' O.C. d. SPACING |

| | | | | | | | |
|----|------------------------------------|---|----------------------|--------|---|----------|------------|
| AS | ACHILLEA MILLEFOLIUM | L | COMMON YARROW | 1 G.C. | - | 2' OC. | 3' SPACING |
| CS | EUPHORBIA RIGIDA | L | SILVER SPURGE | 1 G.C. | - | 2' OC. | 3' SPACING |
| BF | BEPETIA X FRAASSENII "WALKERS LOW" | L | WALKER'S LOW CATMINT | 1 G.C. | - | 2' OC. | 3' SPACING |
| LV | LAVANDULA SPP. | L | LAVENDER | 1 G.C. | - | 3' OC. | 3' SPACING |
| SA | SEDUM "AUTUMN JOY" | L | STONECROP | 1 G.C. | - | 3' OC. | 3' SPACING |
| SC | SENECIO CINERARIA | L | DUSTY MILLER | 1 G.C. | - | 1.5' OC. | 3' SPACING |
| SG | SALVIA GREGGII | L | AUTUMN SAGE | 1 G.C. | - | 3' OC. | 3' SPACING |
| TC | TEUCCRIUM FRUTICAOSUS | L | BUSH GERMANDER | 1 G.C. | - | 4' OC. | 3' SPACING |

| | | | | | | | |
|----|--------------------------|---|------------------|--------|---|-----------|-----------|
| CH | <i>CISTUS X HYBRIDUS</i> | L | WHITE ROCKROSE | 1 G.C. | - | 4' O.C. | D SPACING |
| ND | <i>NANDINA DOMESTICA</i> | L | HEAVENLY BAMBOO | 1 G.C. | - | 3' O.C. | D SPACING |
| PF | <i>PHLOMIS FRUTICOSA</i> | L | JERUSALEM SAGE | 1 G.C. | - | 3.5' O.C. | D SPACING |
| PH | <i>PHORMIUM SPP.</i> | L | NEW ZEALAND FLAX | 1 G.C. | - | 4' O.C. | D SPACING |
| SL | <i>SALVIA LEUCANTHA</i> | L | MEXICAN SAGE | 1 G.C. | - | 3' O.C. | D SPACING |

| | | | | | | | |
|----|---------------------------------------|---|-------------------|--------|---|----------|-----------|
| CU | <i>COINUS COGNETA</i> ROYAL PURPLE | L | SMOKE TREE | 5 G.C. | - | 10' O.C. | d SPACING |
| CN | <i>CNEANTHUS</i> SPP. | L | <i>CNEANTHUS</i> | 5 G.C. | - | 8' O.C. | d SPACING |
| GR | <i>GREVILLEA</i> SPP. | L | <i>GREVILLEA</i> | 5 G.C. | - | 6' O.C. | d SPACING |
| LC | <i>LOROPETALUM CHINENSIS</i> | L | RED FRINGE FLOWER | 5 G.C. | - | 4' O.C. | d SPACING |
| OL | <i>OLEA EUROPAEA</i> 'LITTLE OLLIE' | L | DWARF OLIVE | 5 G.C. | - | 5' O.C. | d SPACING |
| RC | <i>RHAMNUS CALIFORNICA</i> 'EVE CASE' | L | COFFEEBERY | 5 G.C. | - | 8' O.C. | d SPACING |
| WF | <i>WESTRINGIA FRUTICOSA</i> | L | COAST ROSEMARY | 5 G.C. | - | 8' O.C. | d SPACING |

| | | | | | | | |
|----|------------------------------------|---|-----------------------|--------|---|----------|-----------|
| AR | ARCTOSTAPHYLOS 'EMERALD CARPET' | L | CARPET MANZANITA | 1 G.C. | - | 4' O.C. | Δ SPACING |
| BP | BACCHARIS PILULARIS 'PIGEON POINT' | L | DWARF COYOTE BUSH | 1 G.C. | - | 8' O.C. | Δ SPACING |
| CD | COTONEASTER DAMMERI 'LOWFAST' | L | BEARBERRY COTONEASTER | 1 G.C. | - | 10' O.C. | Δ SPACING |
| DP | DYNDOMIA MARGARETAE | L | DYNDOMIA | 1 G.C. | - | 4' O.C. | Δ SPACING |
| MY | MYOPORUM P. 'PUTAH CREEK' | L | CREEPING MYOPORUM | 1 G.C. | - | 12' O.C. | Δ SPACING |

| | | | | | | | | |
|----|--------------------|---|------------------|--------|---|---------|---|---------|
| CR | CAMPIS RADICANS | L | TRUMPET CREEPER | 5 G.C. | - | 8' O.C. | Δ | SPACING |
| IM | IPOMEA INDICA | L | BLUE DAWN FLOWER | 5 G.C. | - | 8' O.C. | Δ | SPACING |
| HV | HARDENBERGIA VIOLA | L | HARDENBERGIA | 5 G.C. | - | 8' O.C. | Δ | SPACING |

| | | | | | | |
|----|--------------------------------------|---|--------------------|--------|---|--------------------------|
| AC | ACHILLEA MILLEFOLIUM 'SUNMOON COAST' | L | TARROW | 1 G.C. | X | 3' O.C. Δ SPACING |
| JP | JUNCUS PATENS 'CARMANS GRAY' | L | BLUE RUSH | 1 G.C. | X | 3' O.C. Δ SPACING |
| LC | LEYMUS CONDENSATUS 'CANYON PRINCE' | L | GIANT WILD RYE | 1 G.C. | X | 3' O.C. Δ SPACING |
| MR | MUHLENBERGIA RIGENS | L | DEER GRASS | 1 G.C. | X | 4' O.C. Δ SPACING |
| ZC | ZAUSCHNERIA 'CALISTOGA' | L | CALIFORNIA FUCHSIA | 1 G.C. | X | 2' O.C. Δ SPACING |

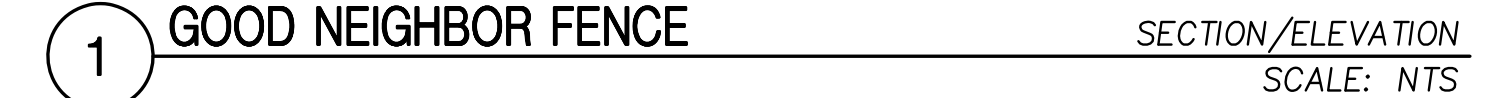

SECTION/ELEVATION
SCALE: NTS

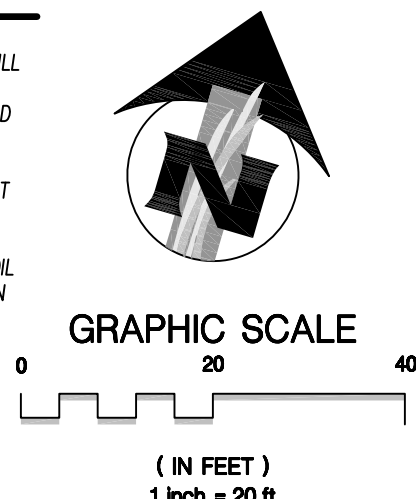
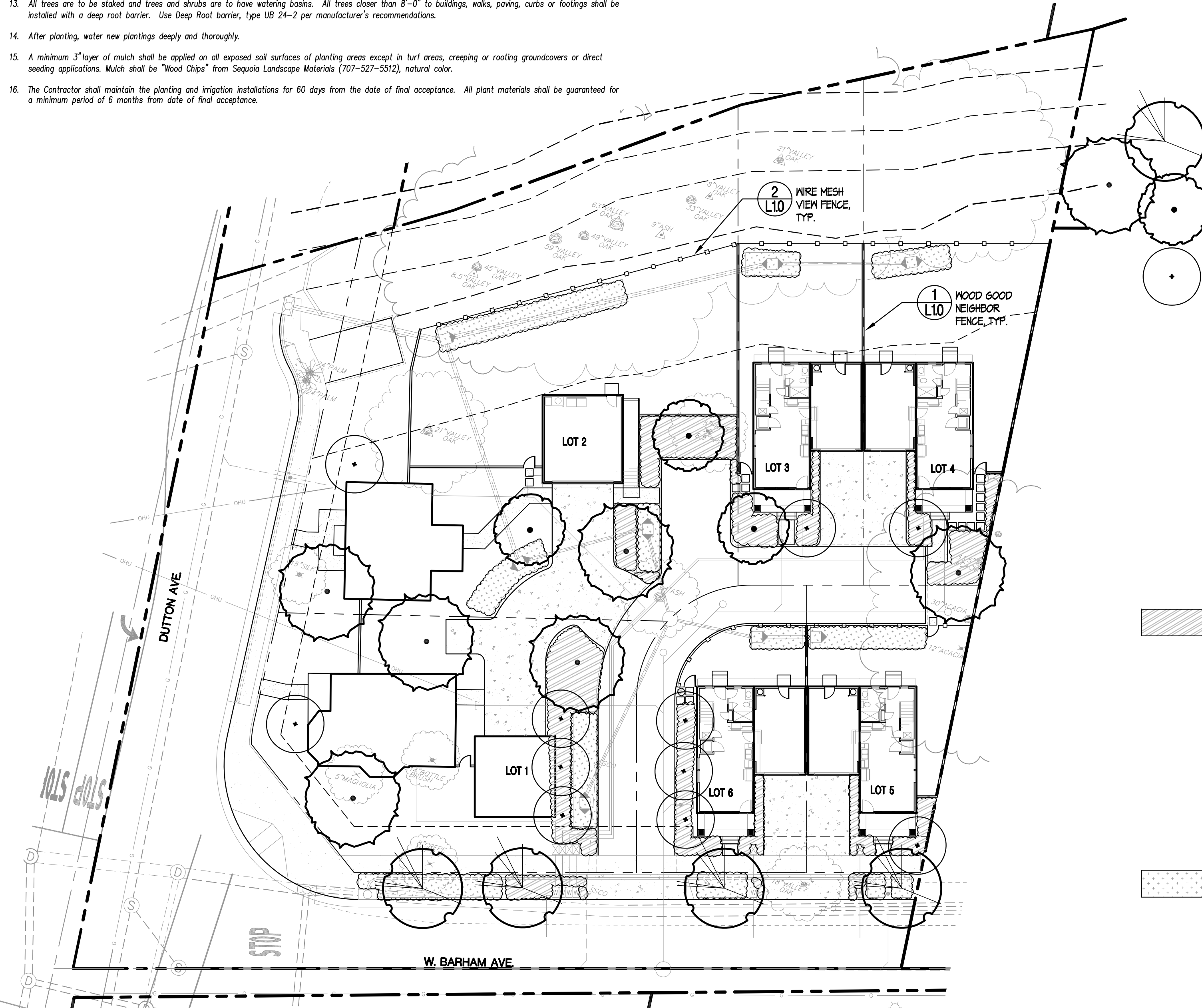

FIRMA
DESIGN GROUP
planners • civil engineers • landscape architects

A stylized graphic element consisting of several horizontal, slightly curved lines of varying lengths, creating a sense of motion or a stylized 'F' shape.

www.firmadesigngroup.com
418 B Street, Third Floor
Santa Rosa, California 95401
telephone • 707.792.1800

Ric J. Hendricks
RLA 5094 Exp. 11/30/18

BAGGETT RESIDENCE - APN# 125-281-045-000
1084 & 1086 DUTTON AVE., SANTA ROSA, CA.

DESIGN REVIEW LANDSCAPE SITE PLAN

[illegible]

| | |
|----------|----------|
| Designed | DCF |
| Checked | RH |
| Date | 05/14/18 |
| <hr/> | |
| Sheet | |

L1.0

1 of 2 Sheets

Job No. 0703-010

DRAWING IS PRELIMINARY UNLESS STAMPED & WET SIGNED