



September 26, 2019

Michael Wixon, Planner
Planning & Economic Development
100 Santa Rosa Avenue
Santa Rosa, CA 95404

RE: Battaglia-Arrieta House located at 135 W 6th Street

Dear Michael,

Thank you for the opportunity to share some of the design constraints while meeting Rehabilitation Standards for the dormer addition on the Battaglia-Arrieta House. Although this house is a contributor due to its age, it has few features of adornment typical of Italianate style. The most outstanding feature of this home is the bracketed cornice which we desired to keep unaltered. Existing wood millwork at the front bay window informed our front porch design and interior stair detailing. Also noteworthy is the symmetry of the roof structure and the basic central hall front to back configuration of the floor plan which limits the location of possible stairs. Additionally, we performed a structural feasibility analysis at the onset of the project which set engineering criteria requirements such that we must keep the overall weight as close to the existing structure as possible and loading thru the foundation as close to current conditions as possible. Many of the local Italianate homes expressed extraordinary roof configurations in a variety of shapes and sizes. Many of these roofs appeared to be original, of the few possible roof dormer additions we observed, both gable and shed configurations were seen. As we worked thru various ideas, we settled on the current four-dormer solution as it preserved the bracketed cornice and symmetry while adding interest and drama to the roof in a way consistent with an Italianate dormer addition verses an originally configuration. This solution also keeps the weight as close to existing framing loads as possible as the new dormers will be configured and bear in a similar fashion to existing roof rafters at the perimeter wall and flat roof area. I have included some additional images 1 – 5 as examples of inspiration that we drew from.

Thank you,
Robin Stephani



1. Downtown Santa Rosa



2. 1889 Italianate Style Bauer Mansion



3. Downtown Santa Rosa



4. McDonald Avenue



5. McDonald Mansion

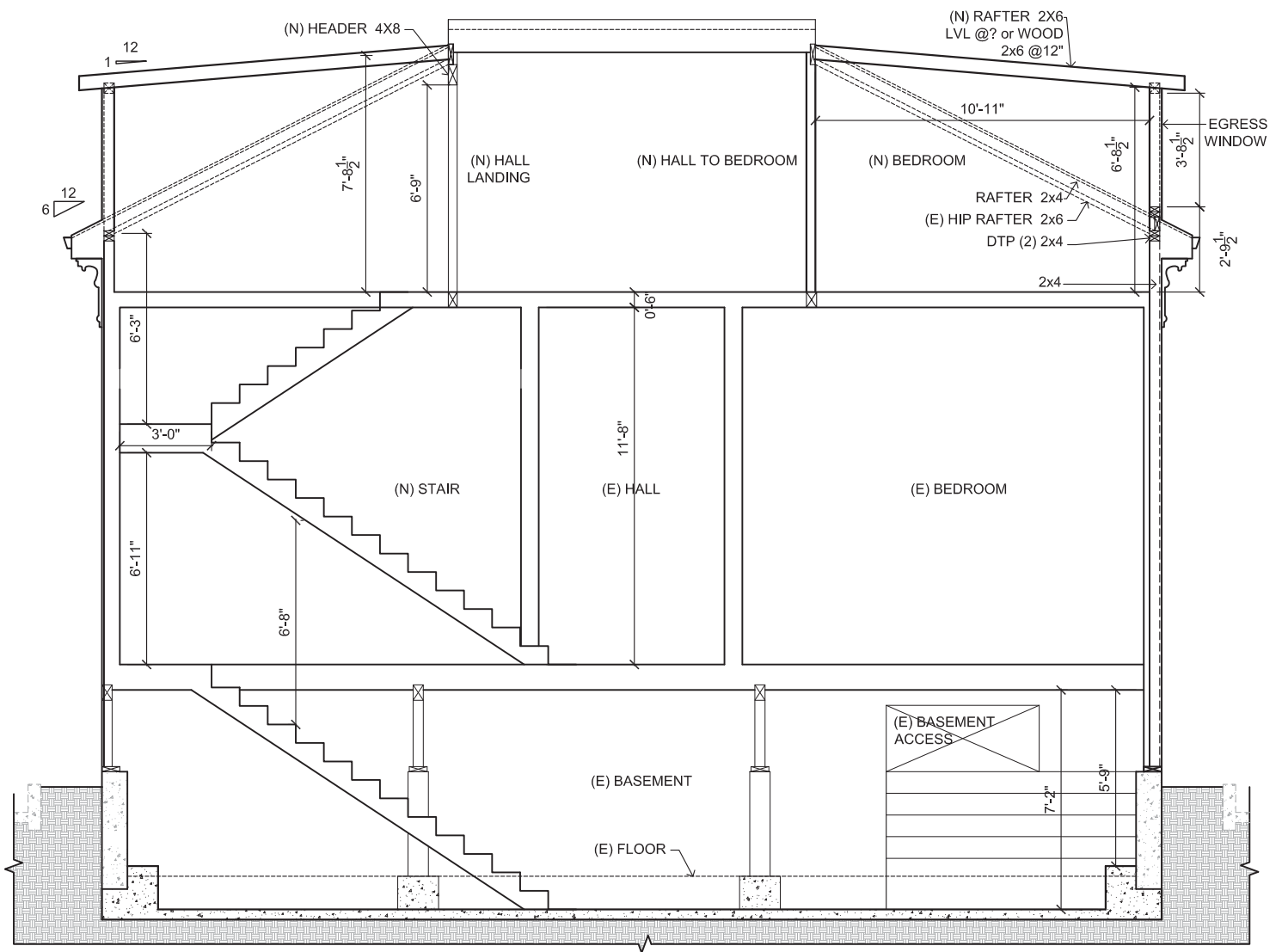

SECTION

3/16" = 1'-0"

A4

9/27/19