

LOT LINES (PROPERTY)	---
EXISTING CURB AND GUTTER	---
PROPOSED CURB AND GUTTER	---
PROPOSED STORM DRAIN LINE	SD
EXISTING STORM DRAIN LINE	-SD-
PROPOSED SEWER LINE	SS
EXISTING SEWER LINE	-SS-
PROPOSED WATER LINE	W
EXISTING WATER LINE	-W-
EXISTING FENCE	-X-
GRADE BREAK	---
FINISH GRADE CONTOUR LINES	4960
EXISTING GRADE CONTOUR LINES	4960
FINISH GRADE SLOPE	SLOPE
GRADE BREAK	GB
INVERT ELEVATION	IE
TOP OF GRATE	TOG
TOP OF ASPHALT	TA
TOP BACK OF CURB	TBC
PROPOSED	PROP
EXISTING	EX
FINISHED GRADE	FG
FINISHED FLOOR ELEVATION	FFE
BACK OF SIDEWALK	BOW
1' CURB CUT SPILLWAY	
REVERSE PAN AND GUTTER	

PRELIMINARY  
NOT FOR CONSTRUCTION

- GENERAL NOTES:
1. CONTRACTOR SHALL NOTIFY CALIFORNIA 811 PRIOR TO CONSTRUCTION
  2. CONTRACTOR SHALL VERIFY LOCATION AND ELEVATION OF ALL EXISTING UTILITY LINES AND STRUCTURES PRIOR TO CONSTRUCTION
  3. ALL PROPOSED WATER LINES SHALL HAVE A MINIMUM OF 5' OF COVER
  4. ALL SEWER, WATER AND STORM DRAIN PIPES SHALL BE BACKFILLED WITH SELECT GRANULAR FILL AS PER CITY STANDARDS.
  5. ANY OFF SITE DAMAGE TO EXISTING ASPHALT, CURB & GUTTER, LANDSCAPING AND ALL UTILITIES SHALL BE REPLACED IN KIND.
  6. SEE UTILITY PLAN FOR CONSTRUCTION OF SEWER AND WATER LINES.
  7. ALL WORK SHALL BE ACCORDING TO CITY STANDARDS.

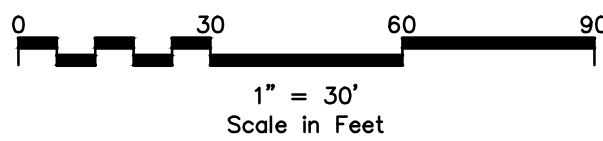

LEGEND ENGINEERING  
52 WEST 100 NORTH  
HEBER CITY, UT 84032  
PHONE: 435-654-4828  
www.legendengineering.com



OLD DOMINION FREIGHT LINE  
GRADING PLAN  
2960 AND 2970 S DUTTON AVE SANTA ROSA, CA 95407

SHEET:  
C-2

DATE: 5/31/2019



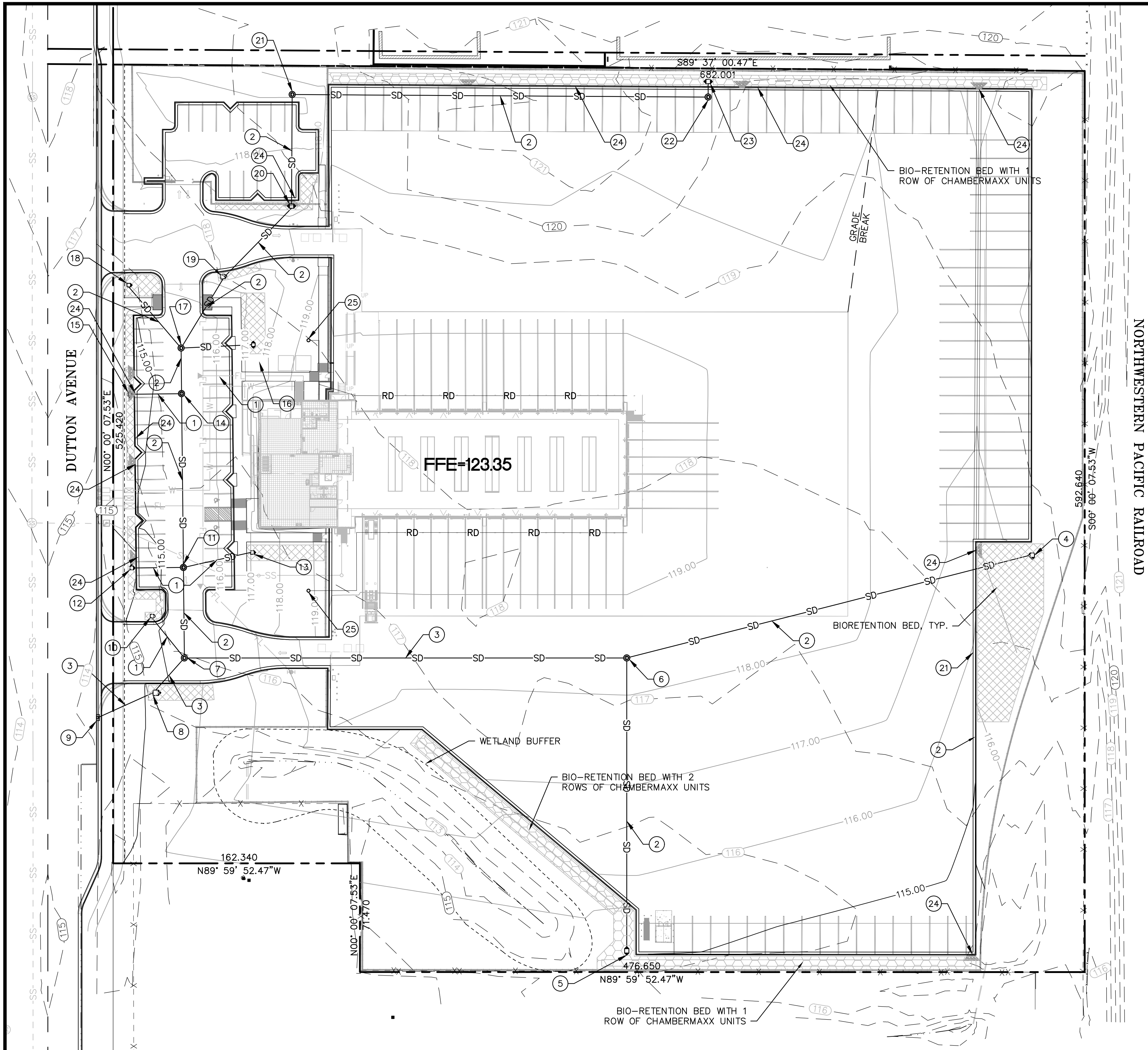

NORTHWESTERN PACIFIC RAILROAD



LOT LINES (PROPERTY)	---
EXISTING CURB AND GUTTER	---
PROPOSED CURB AND GUTTER	==
PROPOSED STORM DRAIN LINE	—SD—
EXISTING STORM DRAIN LINE	---SD---
PROPOSED SEWER LINE	—SS—
EXISTING SEWER LINE	---SS---
PROPOSED WATER LINE	—W—
EXISTING WATER LINE	---W---
EXISTING FENCE	---X---
GRADE BREAK	---
FINISH GRADE CONTOUR LINES	4960
EXISTING GRADE CONTOUR LINES	4960
FINISH GRADE SLOPE	SLOPE
GRADE BREAK	GB
INVERT ELEVATION	IE
TOP OF GRATE	TOG
TOP OF ASPHALT	TA
TOP BACK OF CURB	TBC
PROPOSED	PROP
EXISTING	EX
FINISHED GRADE	FG
FINISHED FLOOR ELEVATION	FFE
BACK OF SIDEWALK	BOW

PRELIMINARY  
NOT FOR CONSTRUCTION

- GENERAL NOTES:
1. CONTRACTOR SHALL NOTIFY CALIFORNIA 811 PRIOR TO CONSTRUCTION
  2. CONTRACTOR SHALL VERIFY LOCATION AND ELEVATION OF ALL EXISTING UTILITY LINES AND STRUCTURES PRIOR TO CONSTRUCTION
  3. ALL PROPOSED WATER LINES SHALL HAVE A MINIMUM OF 5' OF COVER
  4. ALL SEWER, WATER AND STORM DRAIN PIPES SHALL BE BACKFILLED WITH SELECT GRANULAR FILL AS PER CITY STANDARDS.
  5. ANY OFF SITE DAMAGE TO EXISTING ASPHALT, CURB & GUTTER, LANDSCAPING AND ALL UTILITIES SHALL BE REPLACED IN KIND.
  6. SEE UTILITY PLAN FOR CONSTRUCTION OF SEWER AND WATER LINES.
  7. ALL WORK SHALL BE ACCORDING TO CITY STANDARDS.

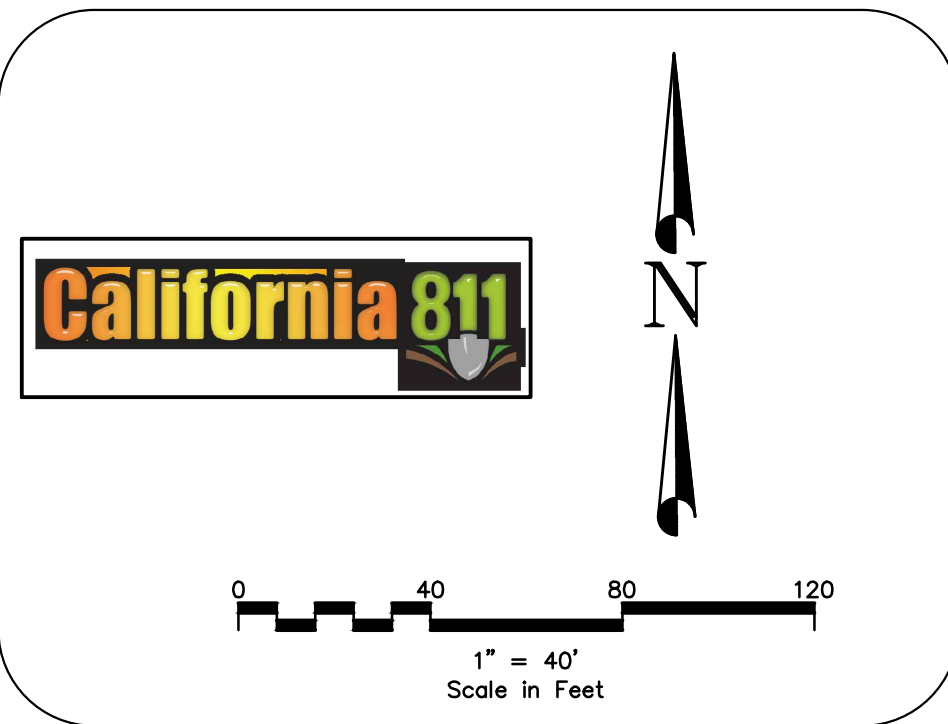

- |   |   |   |   |   |
|---|---|---|---|---|
| 1 8" CORRUGATED H.D.P.E. STORM DRAIN PIPE                                       | 7 60" SDMH<br>RIM=115.35<br>IE=110.21 (IN)<br>IE=110.21 (IN)<br>IE=110.21 (IN)<br>IE=110.11 (OUT)         | 11 60" SDMH<br>RIM=115.42<br>IE=111.34 (IN)<br>IE=110.61 (IN)<br>IE=110.51 (THRU) | 16 18"X18" FIELD DRAIN<br>RIM=117.49<br>IE=111.45 (OUT)                           | 21 60" SDMH<br>RIM=118.72<br>IE=112.40 (IN)<br>IE=112.30 (OUT)  |
| 2 18" CORRUGATED H.D.P.E. STORM DRAIN PIPE                                      | 8 30"X30" FIELD DRAIN<br>W/ SNOOT OIL &<br>DEBRIS STOP<br>RIM=115.18<br>IE=109.96 (IN)<br>IE=106.86 (OUT) | 12 18"X18" FIELD DRAIN<br>RIM=114.88<br>IE=110.78 (OUT)                           | 17 60" SDMH<br>RIM=115.54<br>IE=111.33 (IN)<br>IE=111.33 (IN)<br>IE=111.23 (THRU) | 22 60" SDMH<br>RIM=117.20<br>IE=113.87 (IN)<br>IE=113.77 (OUT)  |
| 3 24" CORRUGATED H.D.P.E. STORM DRAIN PIPE                                      | 9 EX. SDCB<br>TC=114.03<br>IE=109.65 (IN)<br>IE=106.55 (OUT)  | 13 18"X18" FIELD DRAIN<br>RIM=117.06<br>IE=111.57 (OUT)                           | 18 18"X18" FIELD DRAIN<br>RIM=116.84<br>IE=111.62 (OUT)                           | 23 24"X24" FIELD DRAIN<br>RIM=120.42<br>IE=113.92 (IN)          |
| 4 24"X24" FIELD DRAIN<br>RIM=118.78<br>IE=111.44 (OUT)                          | 10 18"X18" FIELD DRAIN<br>RIM=115.72<br>IE=110.39 (OUT)   | 14 60" SDMH<br>RIM=115.45<br>IE=111.18 (IN)<br>IE=111.18 (IN)<br>IE=111.08 (THRU) | 19 24"X24" FIELD DRAIN<br>RIM=117.40<br>IE=111.50                                 | 24 1' CURB CUT OPENING AT LOW POINT AND<br>18" O.C.             |
| 5 24"X24" FIELD DRAIN<br>RIM=115.58<br>IE=111.28 (OUT)                          |   | 15 18"X18" FIELD DRAIN<br>RIM=115.12<br>IE=111.35 (OUT)                           | 20 24"X24" FIELD DRAIN<br>RIM=117.72<br>IE=111.93 (IN)<br>IE=111.83 (OUT)         | 25 INSTALL POP UP DRAINAGE EMITTER PER<br>DETAIL 12, SHEET C-7. |
| 6 60" SDMH<br>RIM=118.41<br>IE=110.89 (IN)<br>IE=110.89 (IN)<br>IE=110.79 (OUT) |   |   |   |   |







LOT LINES (PROPERTY)	
EXISTING CURB AND GUTTER	
PROPOSED CURB AND GUTTER	
PROPOSED STORM DRAIN LINE	
EXISTING STORM DRAIN LINE	
PROPOSED SEWER LINE	
EXISTING SEWER LINE	
PROPOSED WATER LINE	
EXISTING WATER LINE	
EXISTING FENCE	
GRADE BREAK	
FINISH GRADE CONTOUR LINES	
EXISTING GRADE CONTOUR LINES	
FINISH GRADE SLOPE	
GRADE BREAK	GB
INVERT ELEVATION	IE
TOP OF GRADE	TOG
TOP OF CONCRETE	TC
TOP BACK OF CURB	TBC
PROPOSED	PROP
EXISTING	EX
FINISHED GRADE	FG
FINISHED FLOOR ELEVATION	FFE
BACK OF SIDEWALK	BOW
REVERSE PAN AND GUTTER	

PRELIMINARY  
NOT FOR CONSTRUCTION

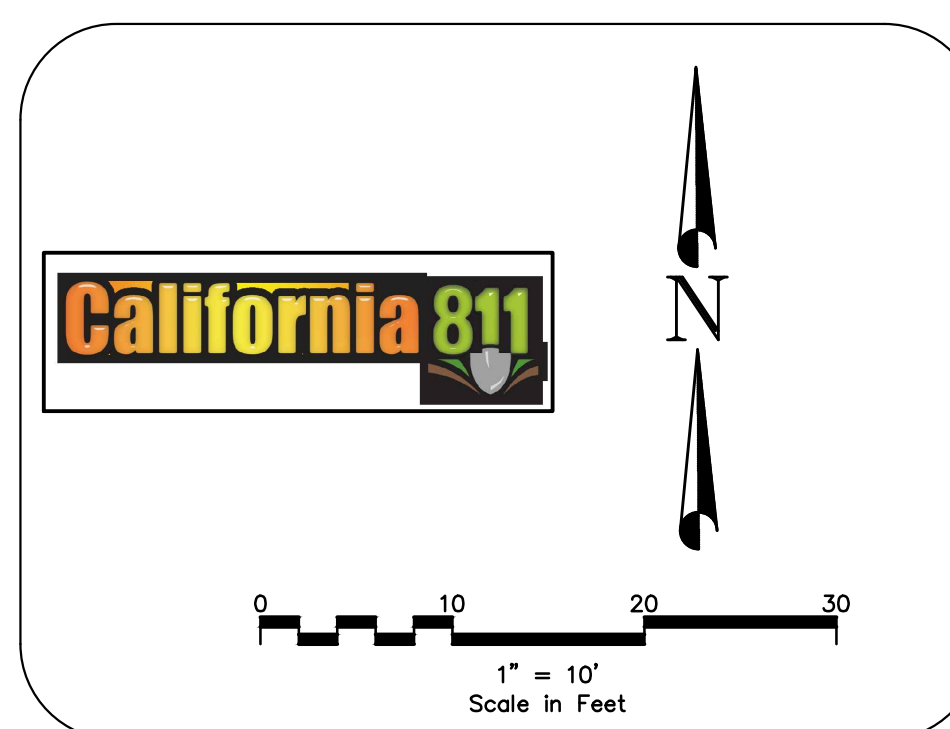
[illegible]

**LEGEND ENGINEERING**  
552 WEST 100 NORTH  
HEBER CITY, UT 84032  
PHONE: 435-654-4828  
[www.legendengineering.com](http://www.legendengineering.com)



OLD DOMINION FREIGHT LINE  
GRADING PLAN 2  
2960 AND 2970 S DUTTON AVE SANTA ROSA, CA 95407

SHEET:  
**C-4**

DATE: 5/31/2019



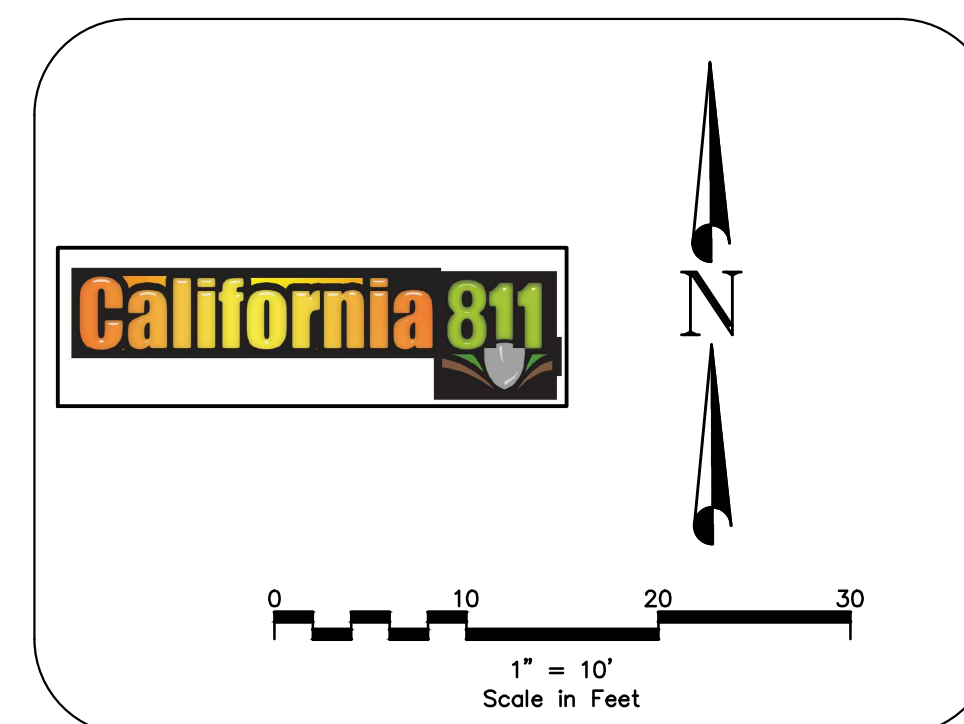

SHEET:  
**C-5**  
DATE: 5/31/2019