

# Residential Fence

## Minor Conditional Use Permit

1998 Long Leaf Court

---

July 2, 2020

Conor McKay, City Planner  
Planning and Economic Development

## Project Description

---

This minor Conditional Use Permit would legalize an existing 6' residential fence constructed 10' from the back of sidewalk where a 15' setback is required by Zoning Code Section 20-22.050

## Project Location



## Site Plan

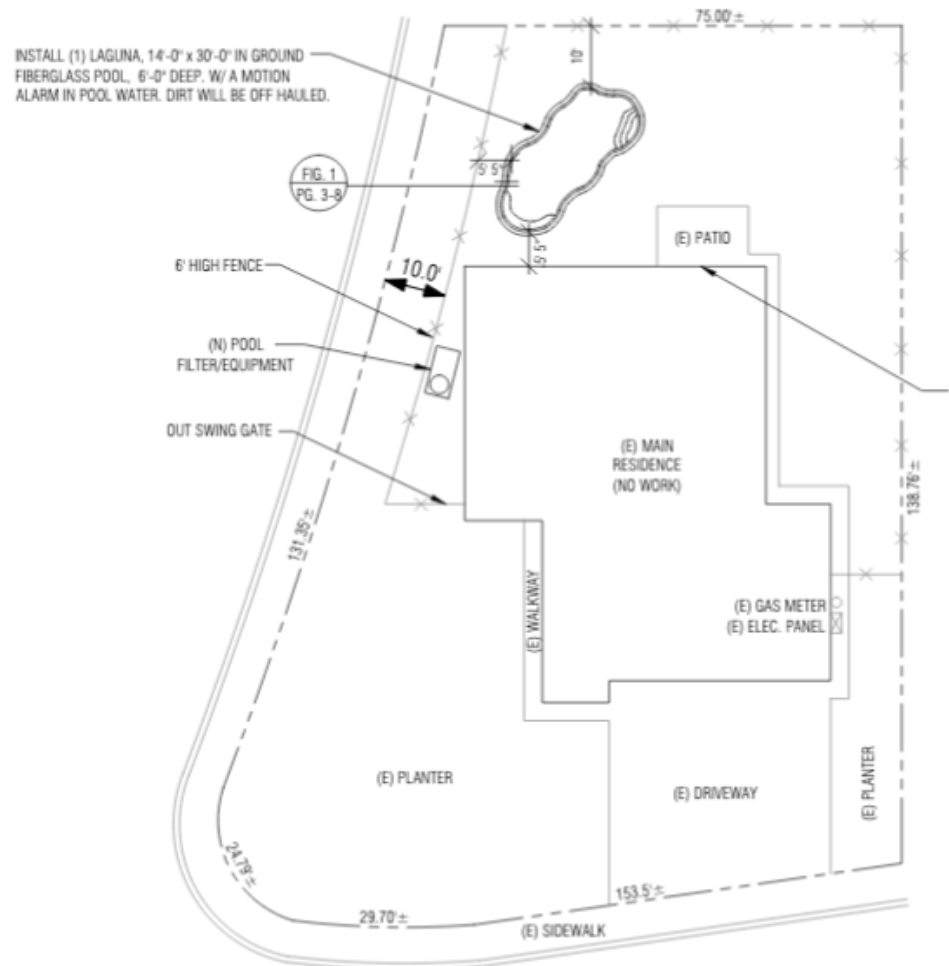

## 1998 Long Leaf Court

Existing Aerial



## 1998 Long Leaf Court

Northeast Elevation,  
Looking South





## 1998 Long Leaf Court

Southeast Elevation,  
Looking North



## 1998 Long Leaf Court

Southeast Elevation,  
Looking West





## Recommendation

The Planning and Economic Development Department recommends that the Zoning Administrator, by resolution, approve a minor Conditional Use Permit to legalize an existing 6' fence at 1998 Long Leaf Court located 10' feet from the back of sidewalk where 15' is required by the Zoning Code.

Conor McKay, City Planner  
Planning and Economic Development  
[Ctmckay@srcity.org](mailto:Ctmckay@srcity.org)  
(707) 543-4351

