

Meadowood Ranch Subdivision

(Concept Design Review)

2853 & 2875 Dutton Meadow

May 6, 2021

Susie Murray, Senior Planner
Planning and Economic Development



Contribution toward Regional Housing Needs Allocation (RHNA)

Santa Rosa RHNA Allocation 2015-2023

Total = 5,083 New Housing Units

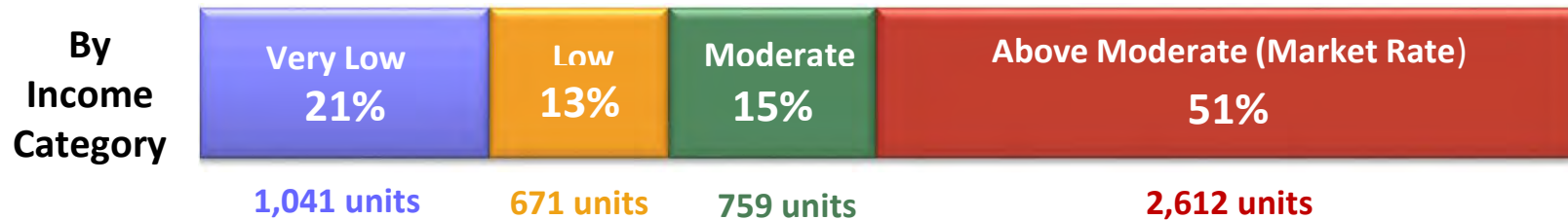

Project Contribution toward RHNA



Moderate/Second Unit:
90 Units (2.6% of RHNA)

- Proposed 90-parcel, small lot subdivision to develop 138 dwelling units
 - Six detached single-family dwellings
 - 84 attached single-family
 - 48 accessory dwelling units (ADUs)

Project Location 2853 & 2875 Dutton Meadow



General Plan & Zoning

Low Density Residential
Low Density Residential/Open Space



R-1-6
Single Family Residential

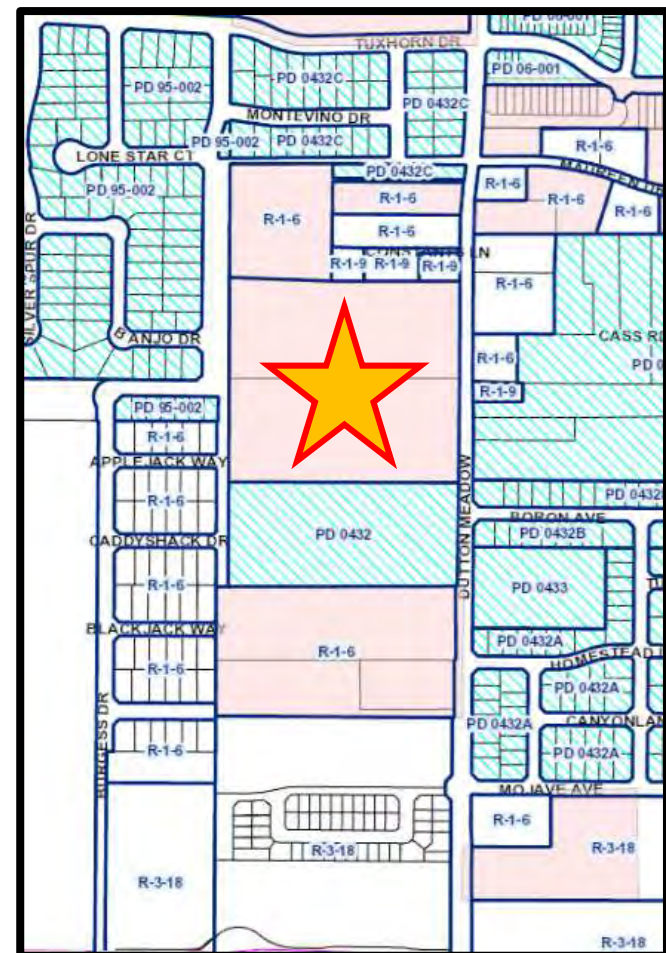

Conceptual Site Plan

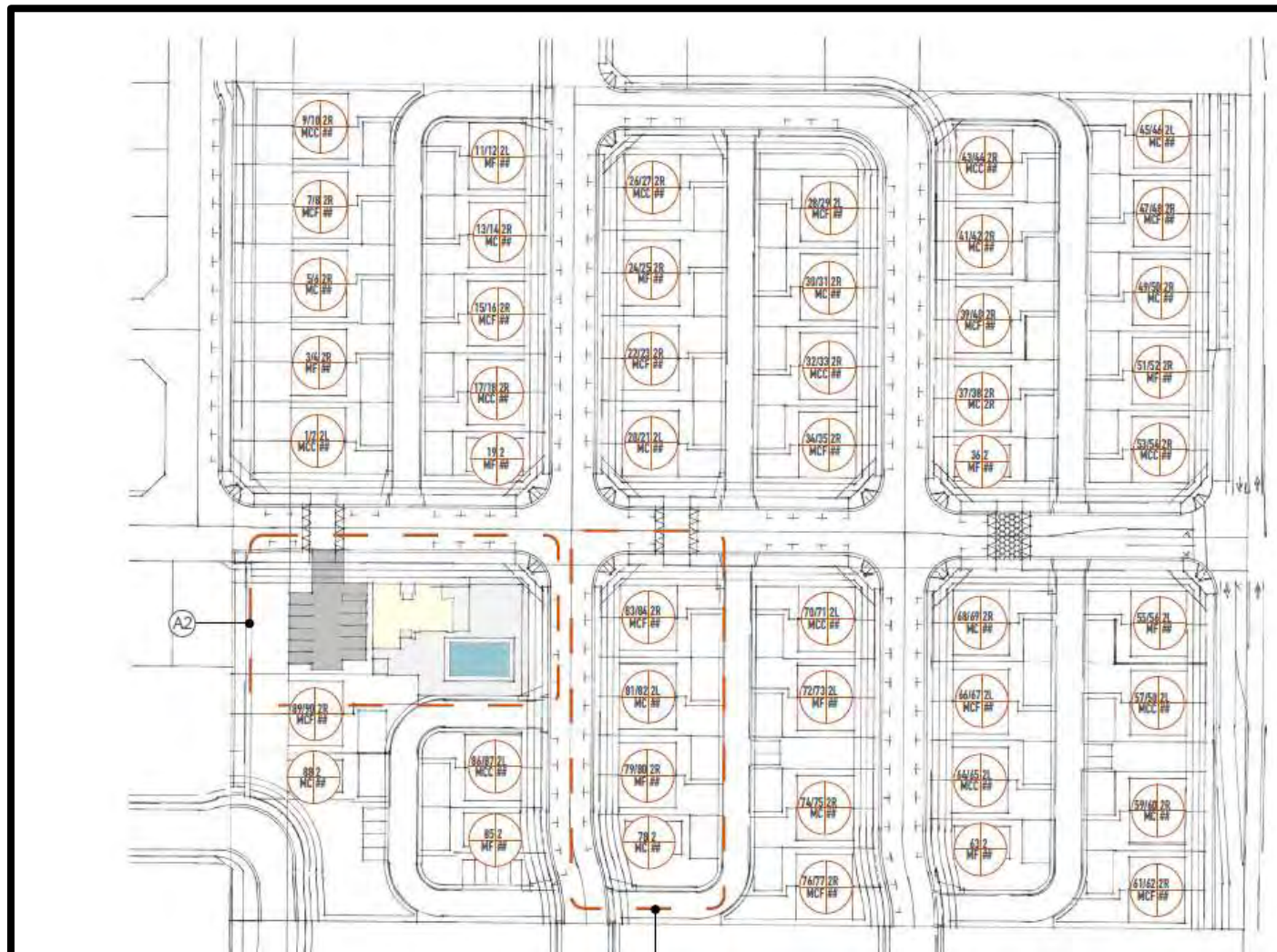

- Traffic
- Non-traffic infrastructure concerns
- Overpopulation of the area

Note: These concerns are within the purview of the Planning Commission.

Susie Murray, Senior Planner
Planning and Economic Development
SMurray@SRCity.org
(707) 543-4348

