

PLANTING NOTES

1. THE CONTRACTOR SHALL BE LICENSED OR CERTIFIED BY THE STATE OF CALIFORNIA FOR THE TYPE OF WORK SHOWN ON THE PLANS.
2. A MINIMUM THREE INCH (3") LAYER OF MULCH SHALL BE APPLIED ON ALL EXPOSED SOIL SURFACES OF PLANTING AREAS EXCEPT IN TURF AREAS, CREEPING OR ROOTING GROUNDCOVERS, OR DIRECT SEEDING APPLICATIONS WHERE MULCH IS CONTRAINDICATED.
3. FOR LANDSCAPE INSTALLATIONS, COMPOST AT A RATE OF A MINIMUM OF SIX CUBIC YARDS PER 1,000 SQUARE FEET OF PERMEABLE AREA SHALL BE INCORPORATED TO A DEPTH OF EIGHT INCHES INTO THE SOIL. SOILS WITH GREATER THAN 6% ORGANIC MATTER IN THE TOP 6 INCHES OF SOIL ARE EXEMPT FROM ADDING COMPOST AND TILLING.
4. PRIOR TO THE PLANTING OF ANY MATERIALS, COMPACTED SOILS SHALL BE TRANSFORMED TO A FRIABLE CONDITION, ON ENGINEERED SLOPES, ONLY AMENDED PLANTING HOLES NEED MEET THIS REQUIREMENT.
5. CONTRACTOR IS TO SUBMIT SOIL SAMPLES FROM TYPICAL PLANTING AREAS TO A LABORATORY FOR ANALYSIS AND RECOMMENDATIONS. SOIL SAMPLING SHALL BE CONDUCTED IN ACCORDANCE WITH LABORATORY PROTOCOL, INCLUDING PROTOCOLS REGARDING ADEQUATE SAMPLING DEPTH FOR THE INTENDED PLANTS. THE SOIL ANALYSIS SHALL INCLUDE:
 1. SOIL TEXTURE;
 2. INFILTRATION RATE DETERMINED BY LABORATORY TEST OR SOIL TEXTURE INFILTRATION RATE TABLE;
 3. PH;
 4. TOTAL SOLUBLE SALTS;
 5. SODIUM;
 6. PERCENT ORGANIC MATTER; AND
 7. RECOMMENDATIONS.
6. SOIL AMENDMENTS SHALL BE INCORPORATED ACCORDING TO RECOMMENDATIONS OF THE SOIL REPORT AND WHAT IS APPROPRIATE FOR THE PLANTS SELECTED.
7. UPON COMPLETION OF THE INSTALLATION, THE CONTRACTOR SHALL SUBMIT TO THE ENGINEERING DEVELOPMENT SERVICES INSPECTOR A COMPLETED AND SIGNED "CERTIFICATE OF COMPLETION" STATING THAT THE PROJECT HAS BEEN INSTALLED AS DESIGNED.
8. A REGULAR MAINTENANCE SCHEDULE SHALL BE SUBMITTED WITH THE CERTIFICATE OF COMPLETION. A REGULAR MAINTENANCE SCHEDULE SHALL INCLUDE, BUT NOT BE LIMITED TO, ROUTINE INSPECTION; TOP DRESSING WITH COMPOST, REPLENISHING MULCH; FERTILIZING; PRUNING; WEEDING IN ALL LANDSCAPE AREAS.
9. THE CERTIFICATE OF COMPLETION SHALL BE ACCOMPANIED BY AN IRRIGATION AUDIT, IRRIGATION SCHEDULE AND MAINTENANCE SCHEDULE, AS DESCRIBED IN THE CITY ORDINANCE.
10. A FINAL CITY INSPECTION SHALL BE PERFORMED. THE INSTALLATION CONTRACTOR SHALL ATTEND THIS INSPECTION AND MAKE ALL REQUIRED REPAIRS AND ADJUSTMENTS TO ACHIEVE APPROVAL AND COMPLETION FROM THE CITY. TO SCHEDULE AN INSPECTION, CONTACT ENGINEERING DEVELOPMENT SERVICES AT (707) 543-4611.

GENERAL LEGEND

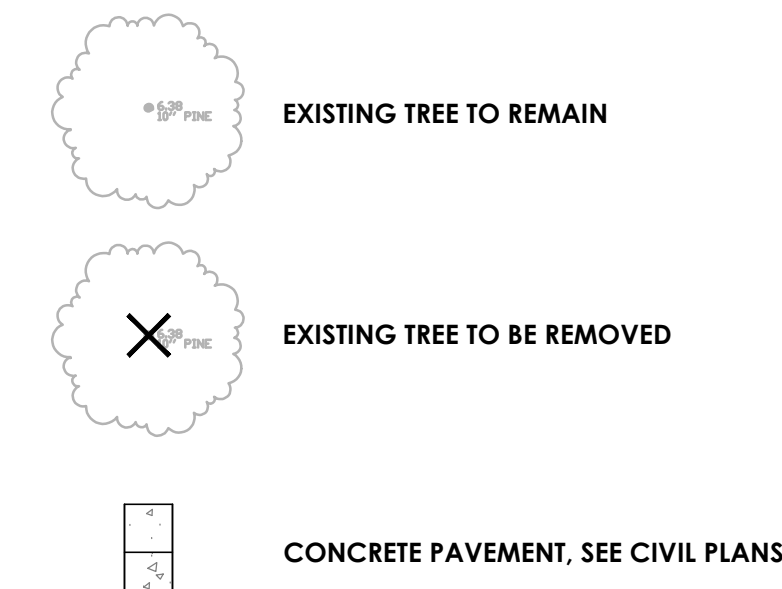

IRRIGATION CONCEPT STATEMENT

THE IRRIGATION SYSTEM WILL BE SERVICED BY A DEDICATED LANDSCAPE METER AND SHALL INCLUDE A WEATHER BASED, SELF-ADJUSTING CONTROLLER TO ACHIEVE MAXIMUM WATER USE EFFICIENCY. ADDITIONAL COMPONENTS SHALL INCLUDE ISOLATION VALVES ON THE MAIN LINE, BUBBLERS FOR TREES WHICH WILL BE ON SEPARATE ZONES FROM THE REST OF THE LANDSCAPE, AND LOW FLOW DRIP IRRIGATION. PLANTING AREAS WITH DISTINCT HYDROZONES WILL BE IRRIGATED ON THE SAME VALVE. FINAL DESIGN OF THE IRRIGATION SYSTEM WILL ACCOUNT FOR SOLAR EXPOSURE AND ASPECT, SITE FEATURES AND BUILDINGS, SOIL TYPES AND MICROCLIMATES.

MWELO STATEMENT

"I HAVE COMPLIED WITH THE CRITERIA OF THE ORDINANCE AND APPLIED THEM FOR THE EFFICIENT USE OF WATER IN THE LANDSCAPE PLAN"

Stephen A. Kovanis
 STEPHEN A. KOVANIS
 REGISTERED LANDSCAPE ARCHITECT #6197
 07/06/2022
 DATE

PLANTING LEGEND

BOTANICAL NAME / COMMON NAME	WUCOLS	SIZE	QTY.	COMMENTS
TREES				
ARBUSUS 'MARINA' / 'MARINA' STRAWBERRY TREE	L	24" BOX	--	STANDARD TREE FORM, MATCHED HEIGHT
PISTACIA CHINENSIS / PISTACHE	L	24" BOX	--	STANDARD TREE FORM, MATCHED HEIGHT
QUERCUS AGRIFOLIA / COAST LIVE OAK	VL	24" BOX	--	STANDARD TREE FORM, MATCHED HEIGHT
SHRUBS				
ARCTOSTAPHYLOS 'HOWARD MCMINN' / MANZANITA	L	5 GAL	--	6' O.C. SPACING
LOROPETALUM 'PURPLE DIAMOND' / FRINGE FLOWER	L	5 GAL	--	6' O.C. SPACING
PHORMIUM 'MAORI MAIDEN' / 'MAORI MAIDEN' FLAX	L	5 GAL	--	5' O.C. SPACING
SALVIA G. 'LIPSTICK' / 'LIPSTICK' SAGE	L	5 GAL	--	4' O.C. SPACING
GROUNDCOVERS				
ARCTOSTAPHYLOS 'JOHN DOURLY' / JOHN DOURLY MANZANITA	L	1 GAL	--	6' O.C. SPACING
NEPETA 'WALKER'S LOW' / 'WALKER'S LOW' CAMINT	L	1 GAL	--	3' O.C. SPACING
TEUCRIUM CHAMAEDRYS / GERMANDER	L	1 GAL	--	3' O.C. SPACING
BIOFILTRATION PLANTERS				
CAREX TUMULICOLA / FOOTHILL SEDGE	L	1 GAL	--	2' O.C. SPACING
CHONDROPETALUM TECTORUM / CAPE RUSH	L	1 GAL	--	4' O.C. SPACING
JUNCUS P. 'CARMAN'S GRAY' / GRAY RUSH	L	1 GAL	--	2' O.C. SPACING

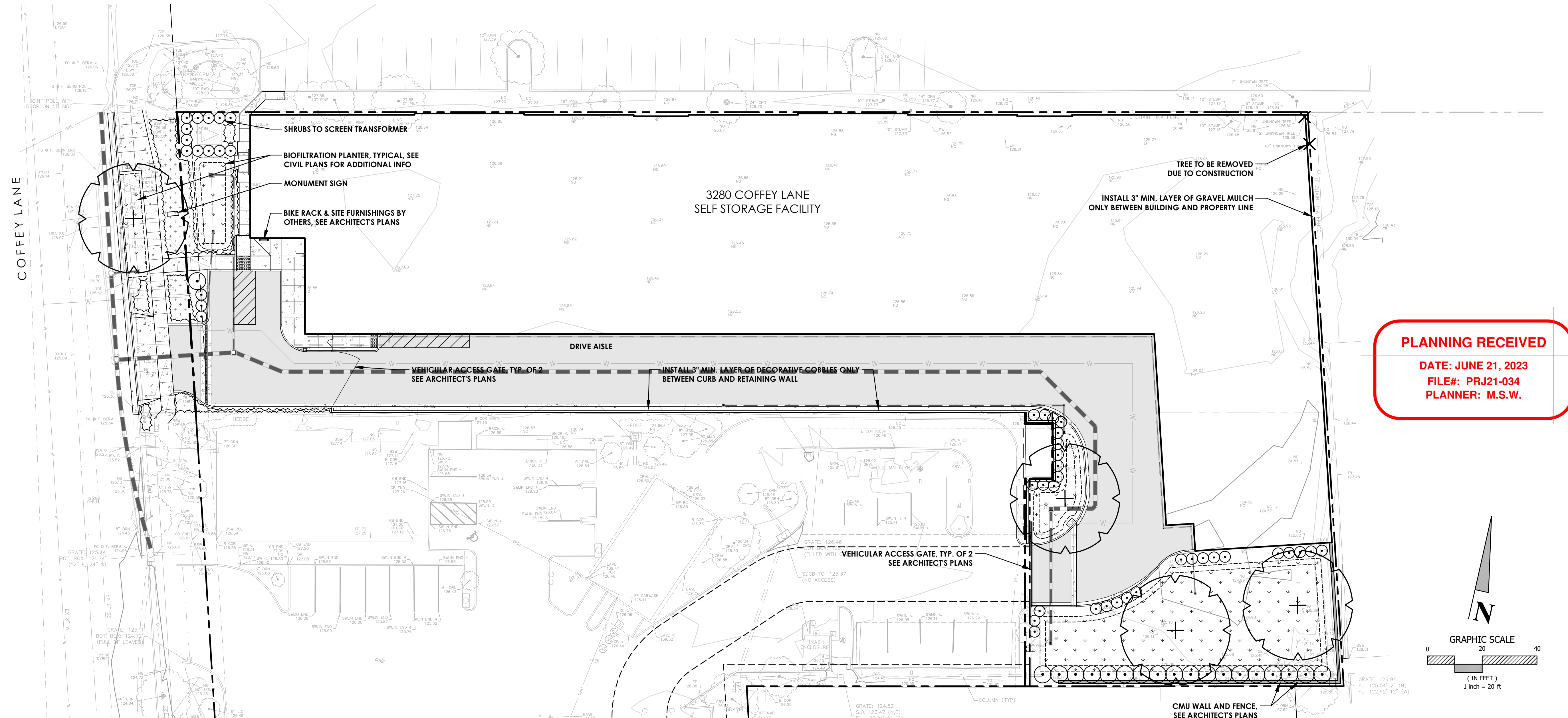

PLANNING RECEIVED
 DATE: JUNE 21, 2023
 FILE#: PRJ21-034
 PLANNER: M.S.W.

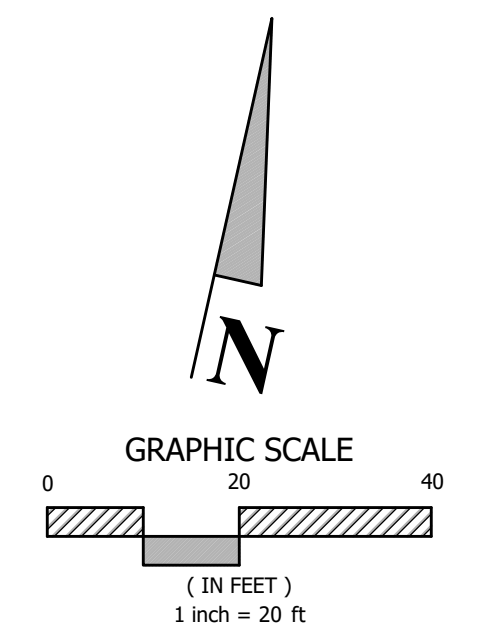

NOT FOR CONSTRUCTION

DATE	
BY	
DESCRIPTION	
REV.	

BC ENGINEERING GROUP, INC.
 CIVIL ENGINEERING & LAND PLANNING
 www.bceengineeringgroup.com
 Phone: 707.542.4321
 418 B Street, Third Floor
 Santa Rosa, CA 95401

DESIGN REVIEW DRAWINGS
 PRELIMINARY LANDSCAPE PLAN
 COFFEY PARK STORAGE
 3282, 3230, 3240, & 3300 COFFEY LANE
 SANTA ROSA, CA 95403

PRELIMINARY

Date: 6/19/2023
 Job: 1378-19
 Drawn: TSL
 Scale: AS SHOWN
 APN: 034-011-077
 034-011-076
 034-011-074
 Permit #
 Sheet: **L1.0**
 6 of 6