



AERIAL VIEW

PROJECT LOCATION



VIEW FROM BROOKWOOD

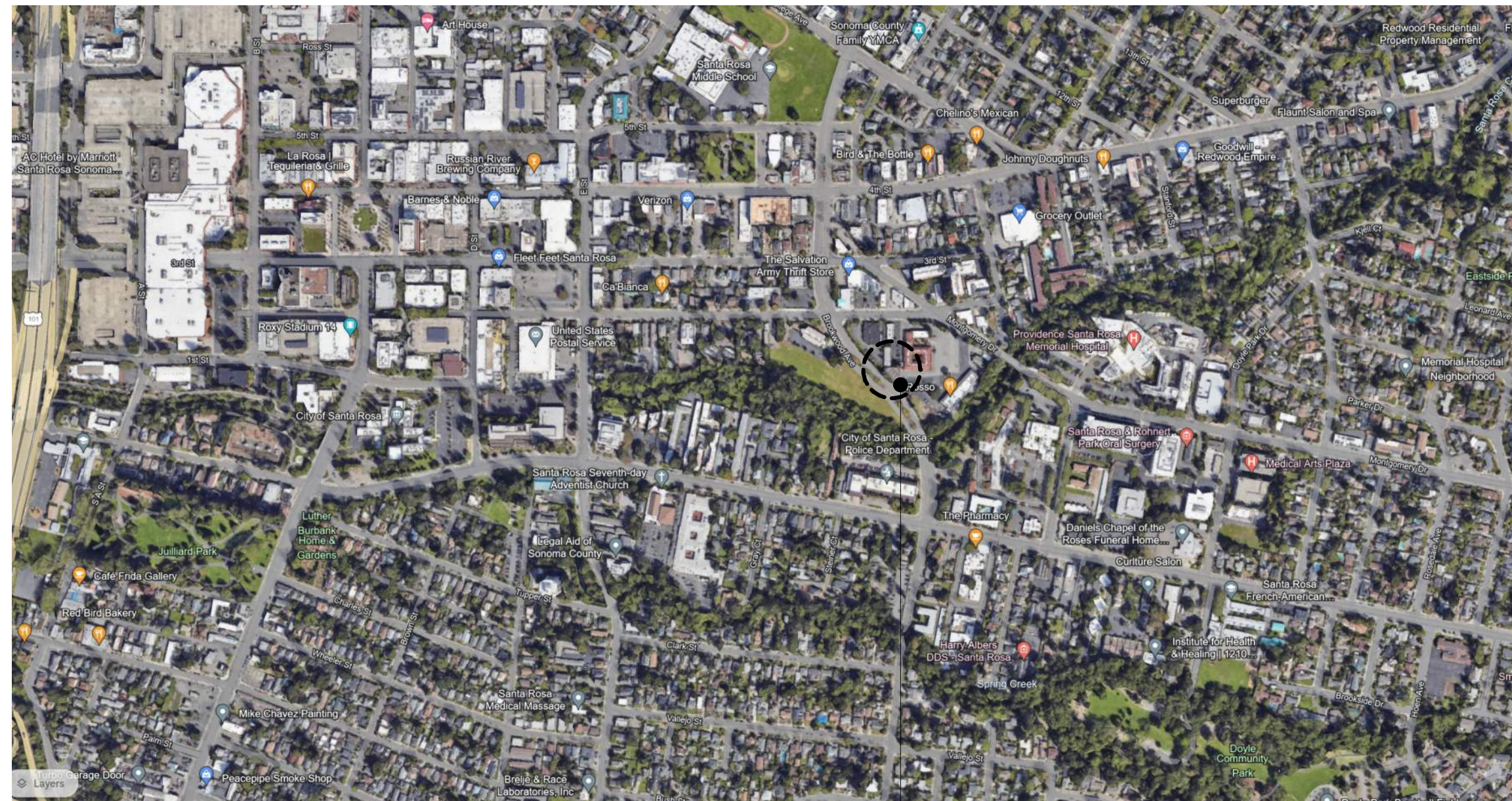

NEIGHBORHOOD MAP

PROJECT LOCATION



VIEW FROM PARKING



CURO Pet Care

100 Brookwood Ave.  
Santa Rosa, CA  
95404

Date Description

Project Name  
ALDERBROOK

Dr. Partner  
DR. HART

Description  
NEIGHBORHOOD MAP & PHOTOS

Scale  
NOT TO SCALE

A1



**CURO Pet Care**

100 Brookwood Ave.  
Santa Rosa, CA  
95404

**PROJECT LOCATION**  
100 BROOKWOOD AVE.

**PROJECT GENERAL NOTE**

ALL SITE CONDITION SHOWN ARE EXISTING TO REMAIN  
ALL PARKING ARE EXISTING TO REMAIN

**PROJECT DESCRIPTION**

TENANT IMPROVEMENT PROJECT TO ACCOMMODATE A NEW  
GENERAL PRACTICE VETERINARY CLINIC. NO COMMERCIAL  
OVERNIGHT BOARDING TO BE PART OF THE PRACTICE.

**PROJECT VALUATION**

\$600,000

① Site Plan  
1" = 30'-0"

Date	Description
------	-------------

Project Name

ALDERBROOK

Dr. Partner

DR. HART

Description

SITE PLAN

Scale

1" = 30'-0"

**A2**

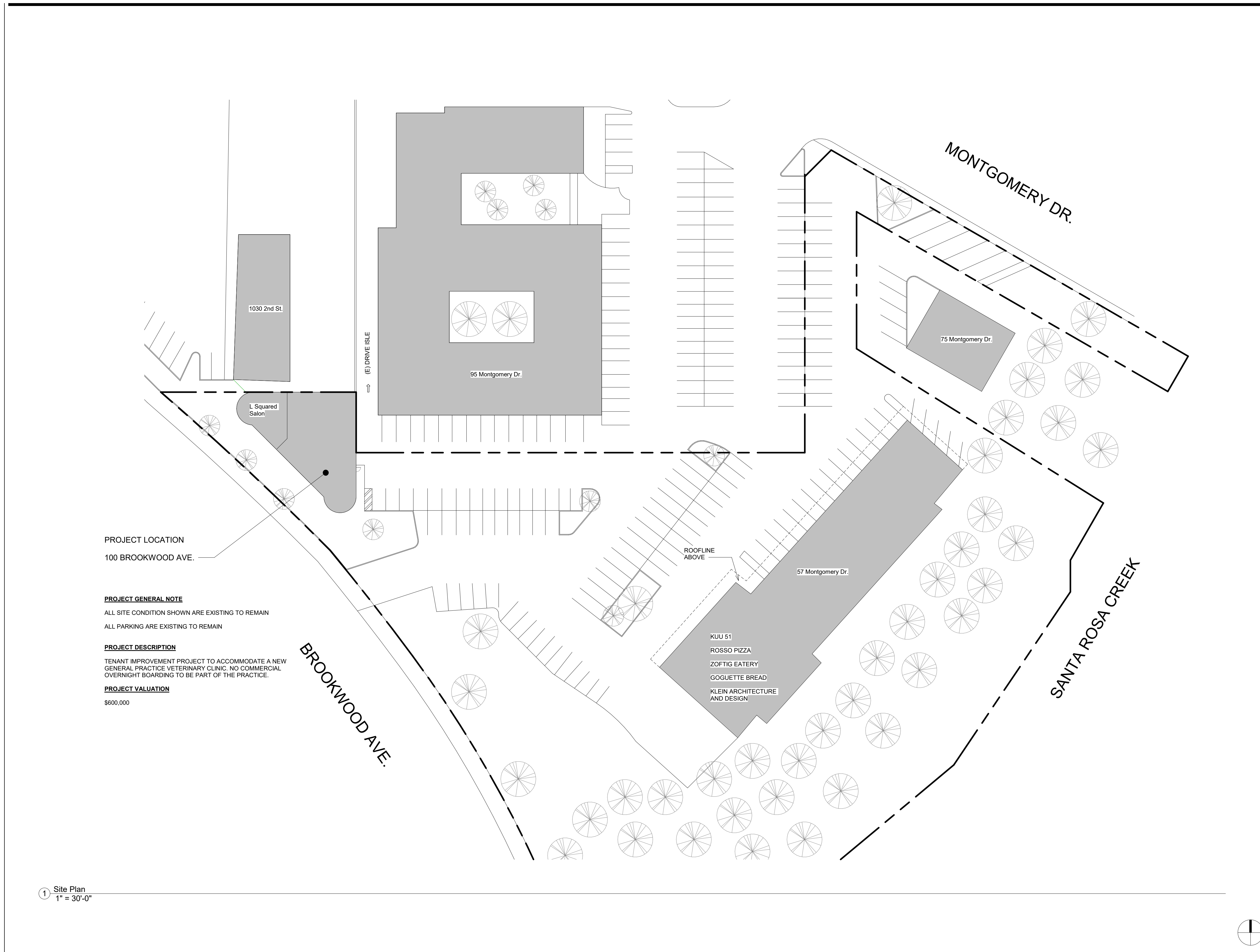



**CURO Pet Care**

100 Brookwood Ave.  
Santa Rosa, CA  
95404

Date Description

Project Name  
**ALDERBROOK**

Dr. Partner  
**DR. HART**

Description  
**PROPOSED FLOOR PLAN**

Scale  
1/4" = 1'-0"

**A3**



1 Conceptual Floor Plan  
1/4" = 1'-0"