

Water and Recycled Water Update

Board of Public Utilities Meeting

March 16, 2023

Peter Martin – Deputy Director Water Resources

Mike Prinz – Deputy Director Water Reuse

Lake Pillsbury Storage

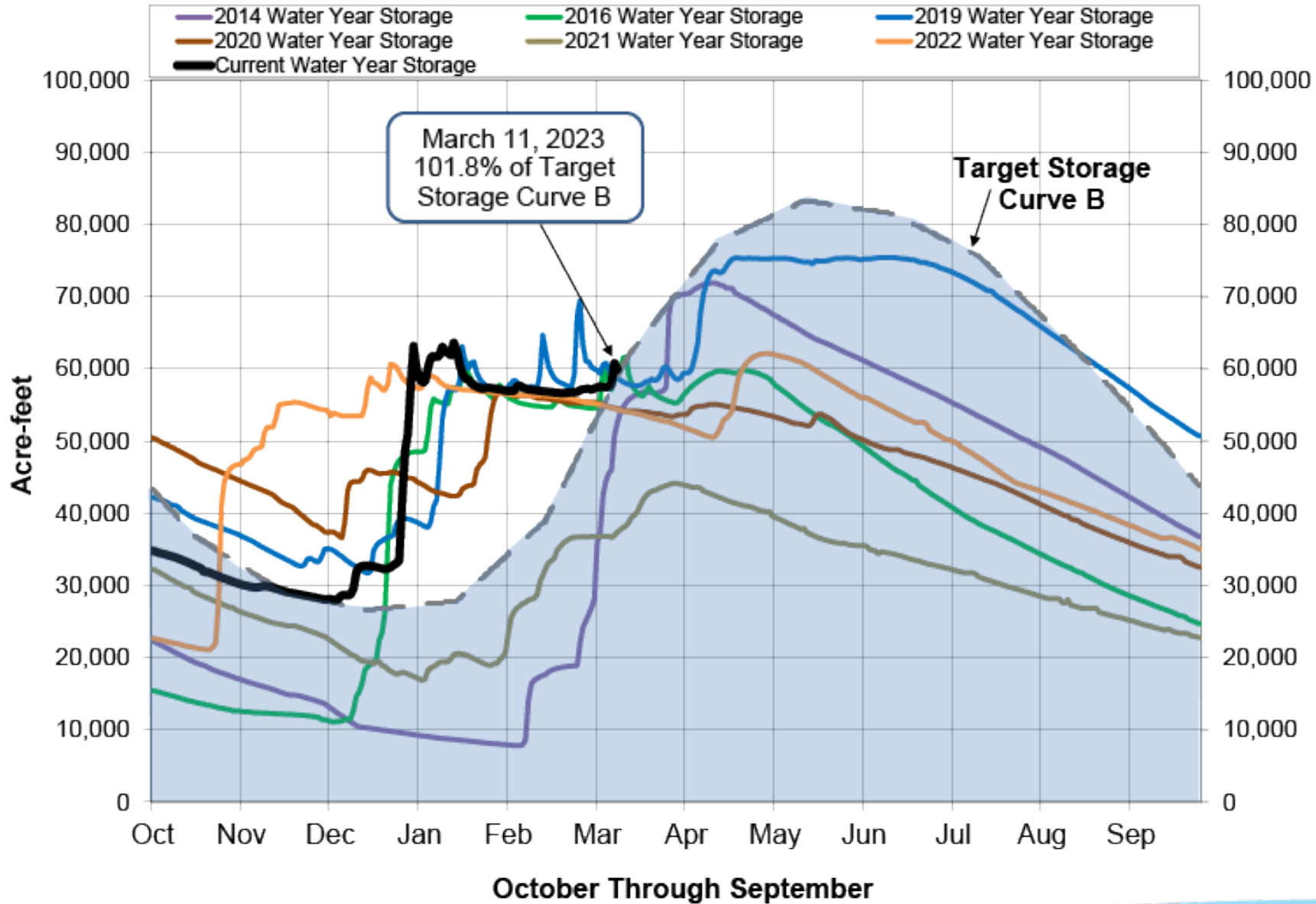

Lake Mendocino Storage

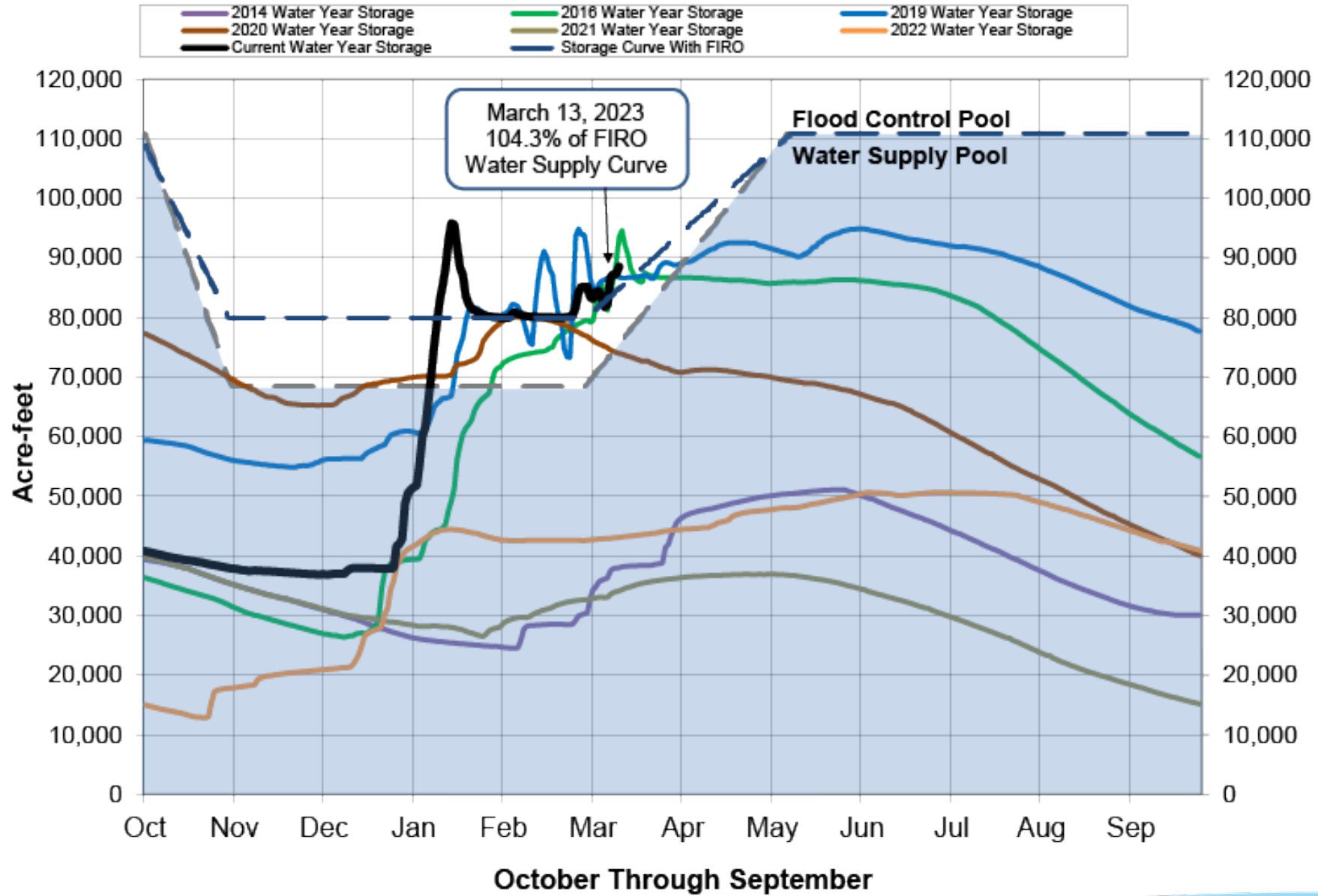

Lake Sonoma Storage

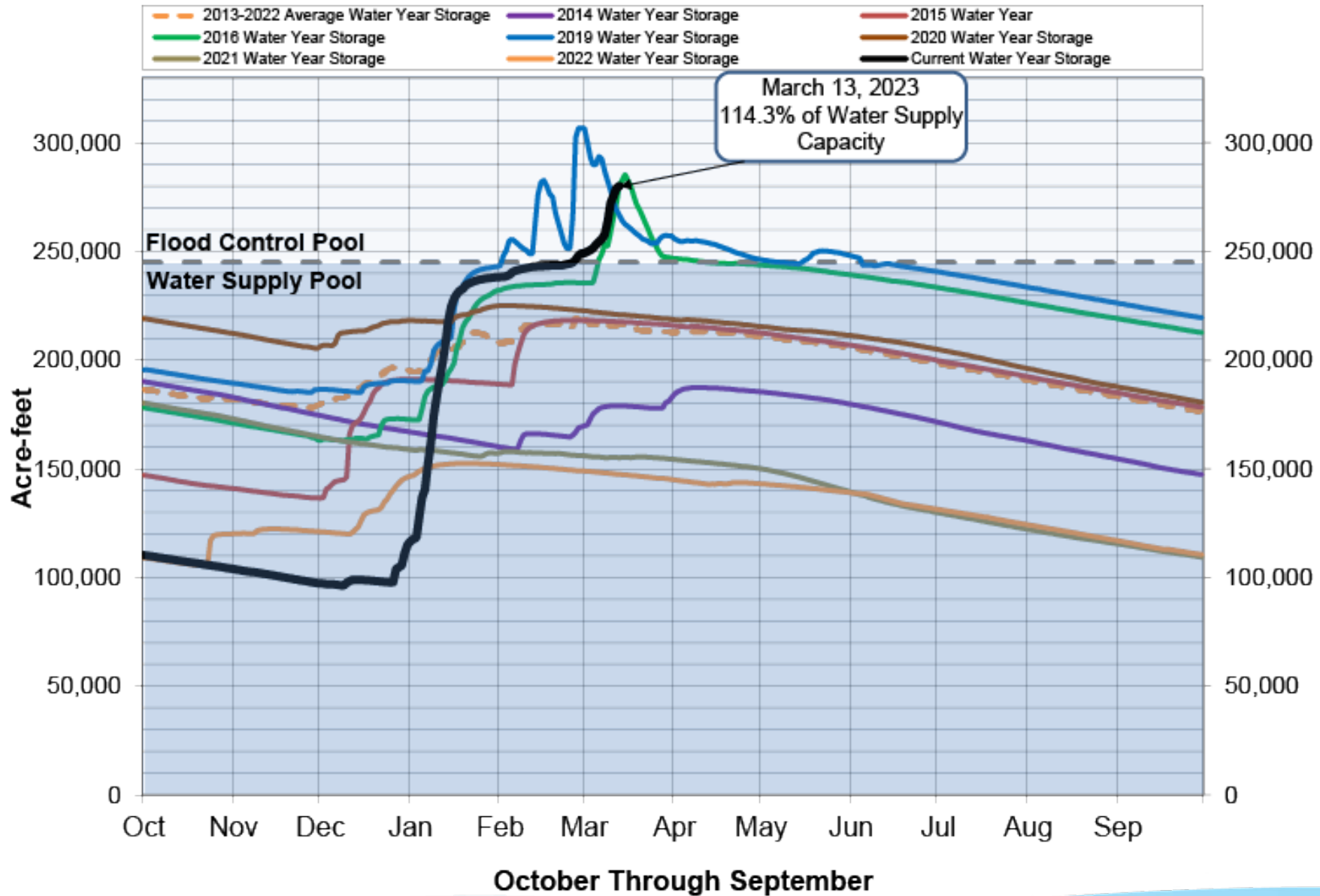

Water Year Rainfall Totals to Date

Location	Rainfall Oct 1, 2022 – March 12, 2023	Percentage of Normal*	Normal Water Year Total* (Oct-Sept)
Ukiah	32.61"	118%	34.84"
Santa Rosa	33.78"	123%	33.78"

Source: CA-NV River Forecast Center

*Percentage of Normal / Water Year Total Normal based on 1991-2020 Averages

Lake Mendocino and Lake Sonoma Operations

- **Lake Mendocino storage encroached flood control storage on January 8th**
 - USACE is now operating and making releases
 - WY 2021 – 2026 major deviation in control manual to store additional 11,650 AF above storage curve (FIRO assisted)
- **Lake Sonoma storage encroached flood control storage on February 27th**
 - USACE authorization to store additional 19,000 AF above 245,000 AF water supply pool this water year (minor deviation)

Sonoma-Marín Saving Water Partnership Annual Report

Fiscal Year 2021/2022 Highlights

- 922,000 Square Feet of Turf Removed
- 25 Water Use Efficiency Workshops
- 24 “Pop Up” Events in region – Significant Coordinated Outreach
- 2 EPA WaterSense Awards: Outreach and QWEL Program
- 97 - Regional Average GPCD

<https://www.savingwaterpartnership.org/about/annual-reports/>

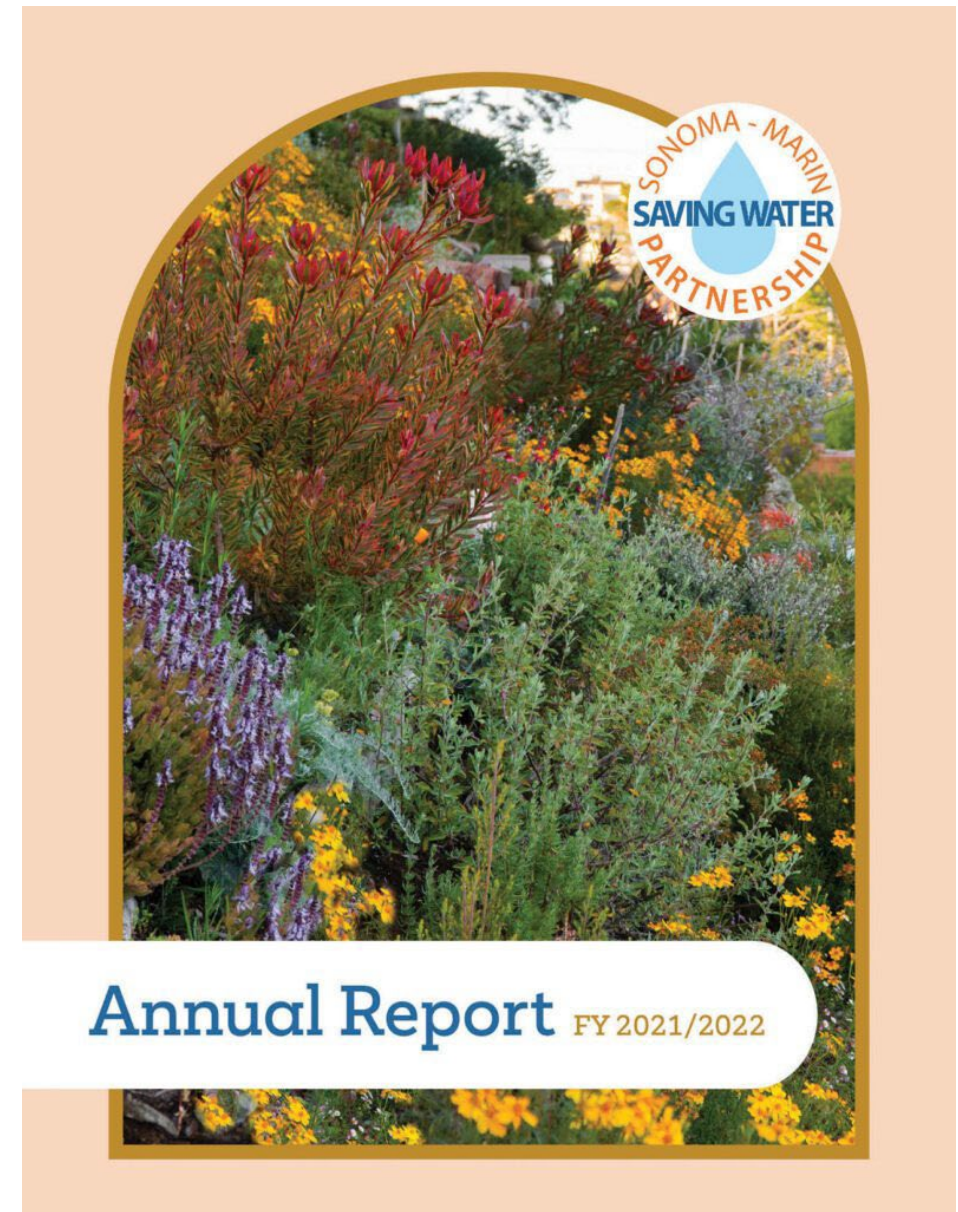

Current Recycled Water Storage

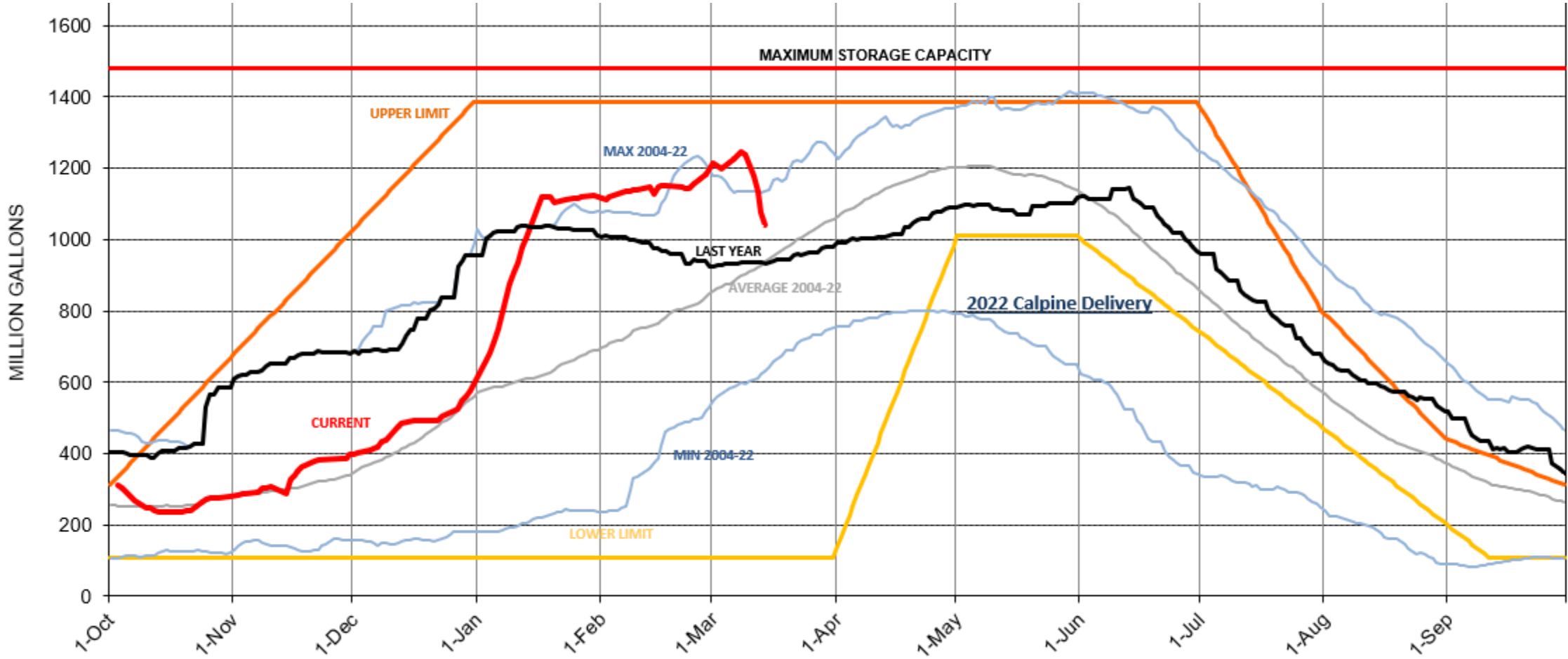



Discharge Continues - Intermittently







Data Collection

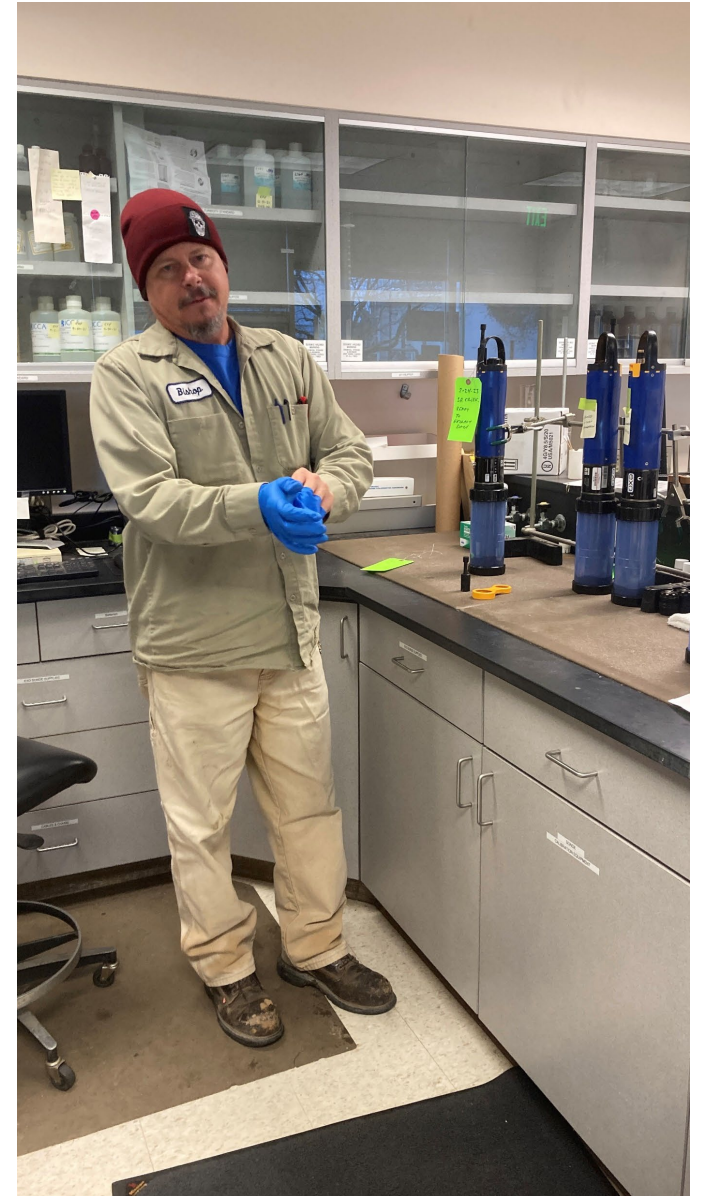

Part of the Team



Discharge To Date

- Discharged approximately 522 million gallons
- Equates to 8,157 pounds of Phosphorus, which equals 8,157 credits used for discharge
- SR Water has 7,473 Phosphorus credits remaining (after recent discharge events)

UV Construction Update

- Total Payments to date: \$7.82M (11.5%)
- Mass excavation
- Sheet Piling
- Hypochlorination System Relocation

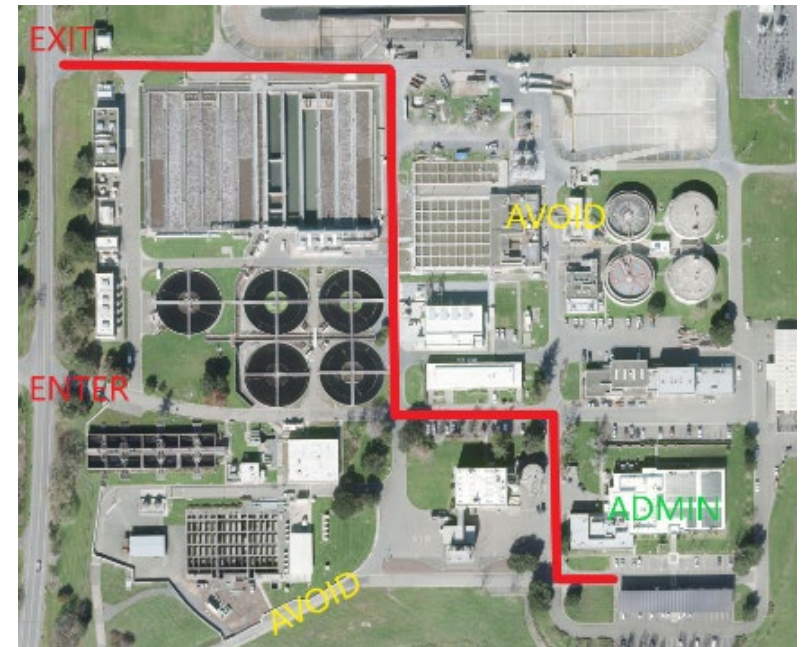









Questions?
