

PARKING CALCULATIONS

CODE SANTA ROSA CITY CODE, CHAPTER 20-36 (TABLE 3-4, 3-5)

GROUP B (AUTOMOBILE GALLERY): 1 PARKING STALL PER 450 S.F. (2,348 SF)
 GROUP S-1 (VEHICLE SERVICES): 1 SPACE PER SERVICE BAY (20), PLUS 1 PER EMPLOYEE (41)
 GROUP B (ACCESSIBLE): 1 PARKING STALL PER 25 REQUIRED PARKING STALLS
 GROUP B (VAN ACCESSIBLE): 1 PARKING STALL PER 500 REQUIRED PARKING STALLS

	REQUIRED	PROVIDED
AUTOMOBILE SHOWROOM	6	6
AUTOMOBILE SERVICE	61	88
ACCESSIBLE	3	3
VAN ACCESSIBLE	1	1
TOTAL	71	98

LEGEND

- (E) LANDSCAPE AREA
- PROPERTY LINE
- PROPERTY SET BACK
- ACCESSIBLE PATH OF TRAVEL
- ACCESSIBLE ROUTE, 4'-0" WIDE MINIMUM, 5'-0" WIDE AT DOORWAYS, 4" WHITE PAINTED STRIPING, SPACED AT 3'-0" ON CENTER, AT 30 DEGREE ANGLE.
- HIGH POWER POST MOUNTED WALL CONNECTOR, SEE DETAIL 1/A8.02 & ELECTRICAL DRAWINGS.
- C COMPACT STALL
- S STANDARD PARKING STALL
- EV ELECTRIC CAR CHARGING STALL
- A ACCESSIBLE PARKING STALL
- A-V ACCESSIBLE VAN PARKING STALL

GENERAL PARKING STRIPING NOTES

- PARKING NUMBERS SHOWN ARE NOT TO SCALE AND ARE FOR LOCATION REFERENCE ONLY.
- NEW PARKING NUMBERS TO BE 12" TALL IN COLOR: YELLOW. CENTER ON EACH PARKING SPOT, TYP.
- ALIGN NEW # WITH END OF PARKING STRIPES SO PARKING STALL # IS ON THE INSIDE OF PARKING SPOT. ORIENT DIRECTION OF NUMBER AS SHOWN.
- SEE SHEET A0.02 FOR ADDITIONAL SITE MARKING DETAILS.

KEY NOTES

- PROPERTY LINE
- EGRESS DOOR, SEE 3/A0.02
- (E) POLE MOUNTED SITE LIGHTING
- (E) TRANSFORMER, SEE ELECTRICAL DRAWINGS
- (E) GAS METER
- TRENCH FOR MONUMENT SIGN POWER, SEE ELECTRICAL DRAWINGS. GC TO CONFIRM BEST ROUTE FOR CONDUIT RUNS.
- SURFACE MOUNTED KEY DROP BOX. NOTE: THRU WALL DROP BOX IS FOR HIGH SECURITY AREAS.
- (E) CHAIN LINK FENCE. REPLACE PRIVACY SLATS WITH NEW UP TO NEIGHBORING BUILDING, V.I.F. REPLACE ANY DAMAGED SECTIONS OF CHAIN-LINK FENCING BETWEEN POSTS, TYP.
- (E) FIRE HYDRANT
- (E) FIRE DEPARTMENT CONNECTION
- GC TO REMOVE EXISTING MONUMENT SIGN AND REPLACE WITH NEW INTERNALLY ILLUMINATED 8'-0" HIGH MONUMENT SIGN
- NEW 2" REDUCED PRESSURE BACKFLOW PREVENTER. SEE SHEET P2.00 AND P3.0 FOR MORE INFORMATION.
- NOT USED
- INTERNALLY ILLUMINATED 8'-0" HIGH DIRECTIONAL SIGN (2) SIDED
- NEW PARKING SPOT STRIPING, TYP. EVENLY SPACE OUT PARKING SPOTS WITHIN THE AREA AVAILABLE TO ACHIEVE THE AMOUNT OF SPOTS SHOWN.
- NOT USED
- (E) BIKE RACK
- NEW CURB CUT AT NEW OVERHEAD DOOR OPENING
- NEW 36" H METAL GUARD RAILING, PAINT PT-3
- NEW WHEEL STOPS
- NEW ASPHALT RAMP AT OVERHEAD DOOR. NOT TO EXCEED 1:6 MAX SLOPE
- NEW CMU TRASH ENCLOSURE FOR (4) 8 YD. DUMPSTERS, SEE A1.01b FOR DETAILS
- PROVIDE NEW TRUNCATED DOME DETECTIBLE WARNING MAT AT EXISTING LANDING. BASE DIAMETER SHALL BE .9", TOP DIAMETER SHALL BE .45", 2" IN HEIGHT. MAT COLOR "YELLOW".

© COPYRIGHT 2019 TESLA MOTORS, INC. ALL RIGHTS RESERVED. PROPRIETARY AND CONFIDENTIAL BUSINESS INFORMATION

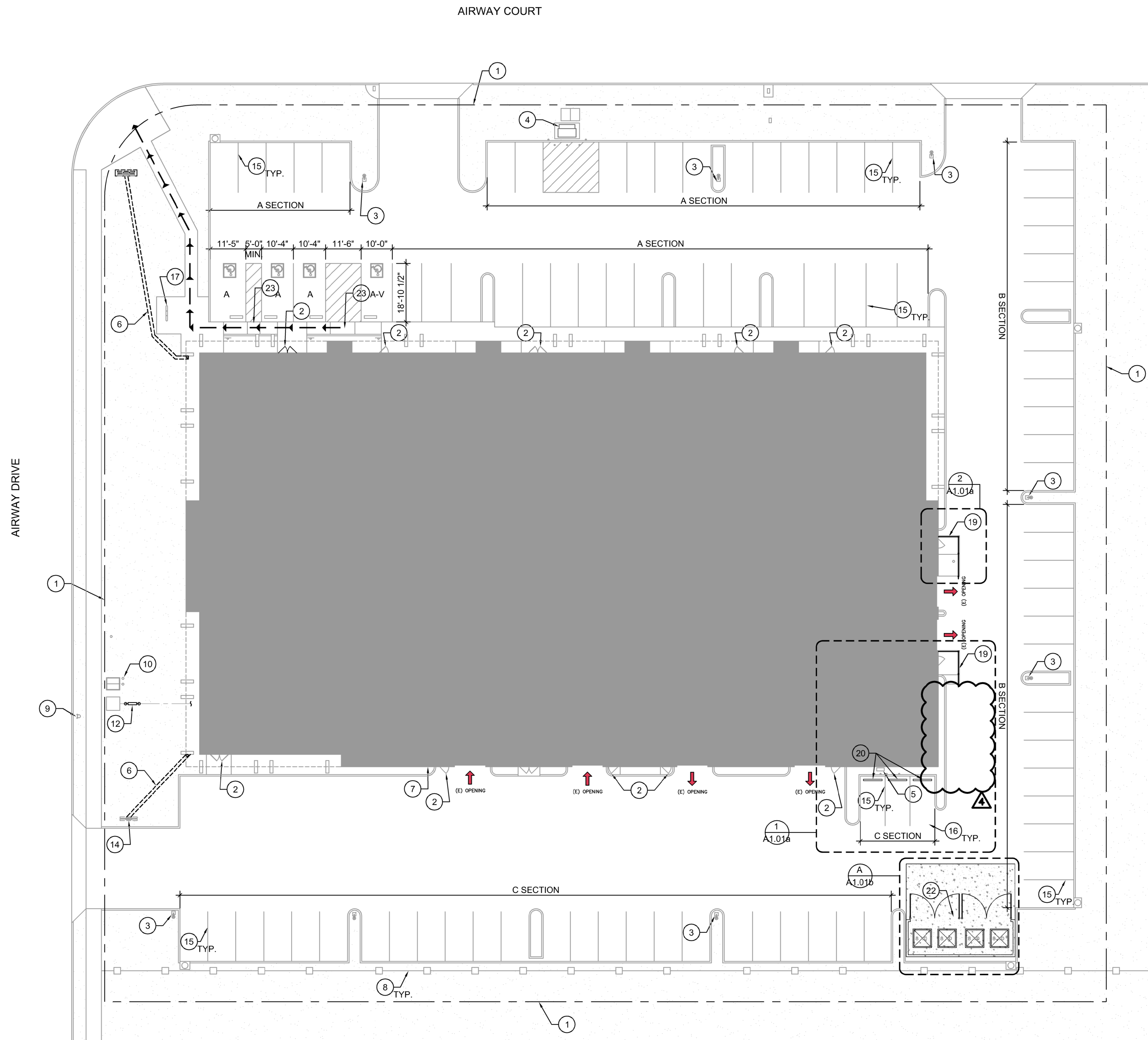

City of Santa Rosa
 Planning & Economic
 Development Department
 12/12/2022
 RECEIVED

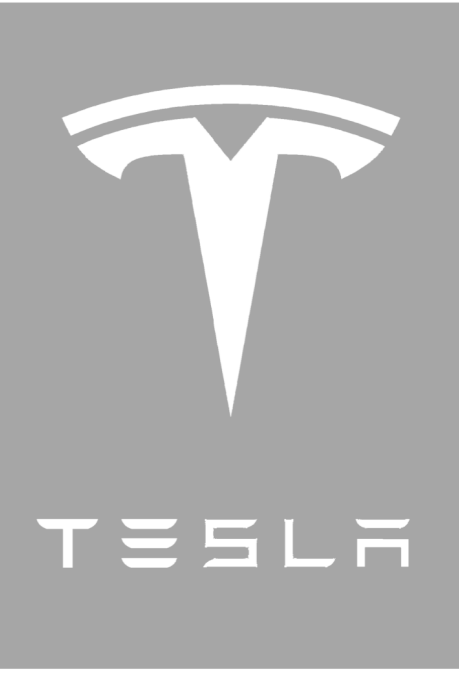

10/21/22

ARCVISION
 INCORPORATED
 ARCHITECTURE • ENGINEERING • STORE PLANNING
 SAINT LOUIS / DALLAS / LAS VEGAS / ORLANDO
 1850 CRAG ROAD, SUITE 300 ST. LOUIS, MO 63146
 PH: (314) 415-2400 FAX: (314) 415-2300 www.arcv.com

TESLA
 FACILITY
 3286 AIRWAY DRIVE
 SANTA ROSA, CA 95403

ISSUE / REVISION	DATE	DESCRIPTION
04.06.22	75%	ISSUE SET
04.18.22	100%	ISSUE SET
07.15.22	1	CITY COMMENTS
08.29.22	2	CITY COMMENTS
09.16.22	3	OWNER COMMENTS
10.14.22	4	OWNER COMMENTS

DRAWING TITLE

SITE PLAN

SCALE: AS NOTED
 PROJECT NUMBER: 220121
 TESLA ID: 20585

SHEET NUMBER

A1.01

SITE PLAN SCALE: 3/8" = 1'-0" 1