

9/7/2023 6:34 PM Printed by Marcell S:\Clients\1978-20\Charlie Traboulsi - Mariner Way (Heritage Commerce Center), Santa Rosa, CA\CAD\Civil Engineering\Exhibit\1978-20 Creek Exhibit.dwg

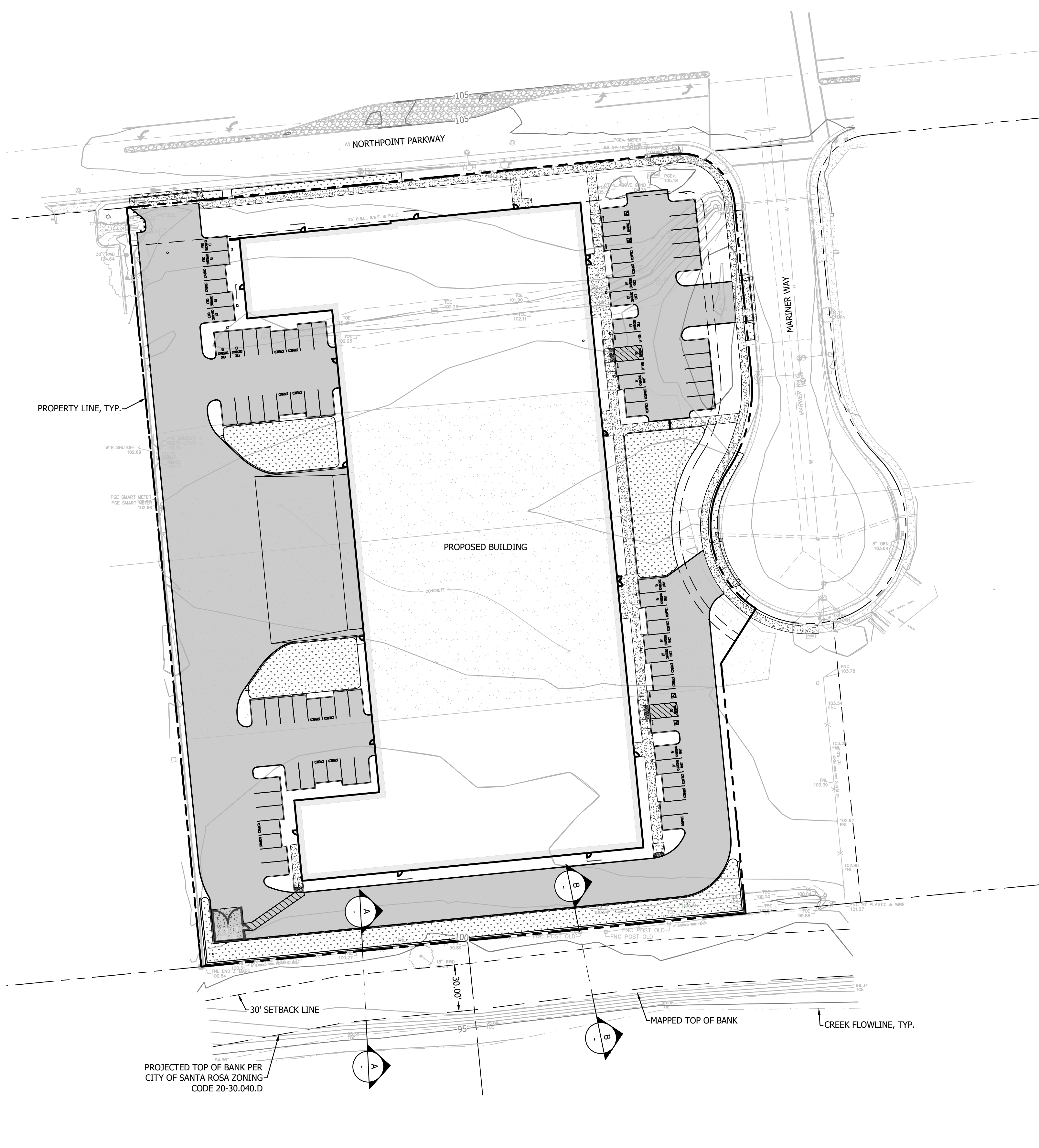

**PLAN VIEW**  
SCALE: 1"=40'

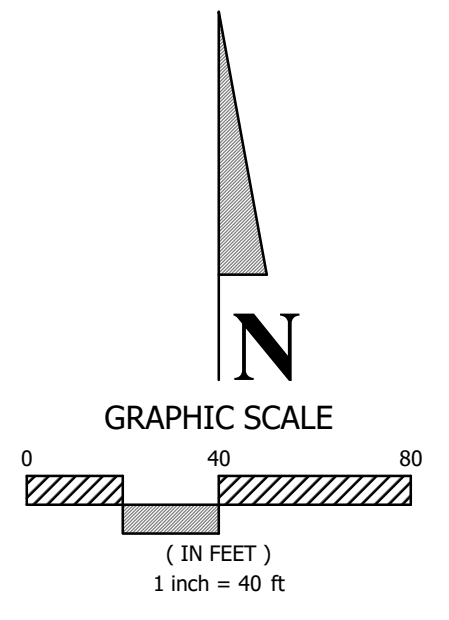

**NOTES:**  
TOP OF BANK SHOWN IN THE CROSS SECTIONS IS PER THE PROJECTED TOP OF BANK BASED ON THE CITY OF SANTA ROSA ZONING CODE 20-30.040.D.  
THE SURROUNDING DEVELOPMENTS WERE DEVELOPED PRIOR TO SEPTEMBER 3, 2004 THEREFORE THE SETBACK FOR DEVELOPMENT FROM THE CREEK TOP OF BANK IS 30' PER CITY OF SANTA ROSA ZONING CODE 20-30.040.D.

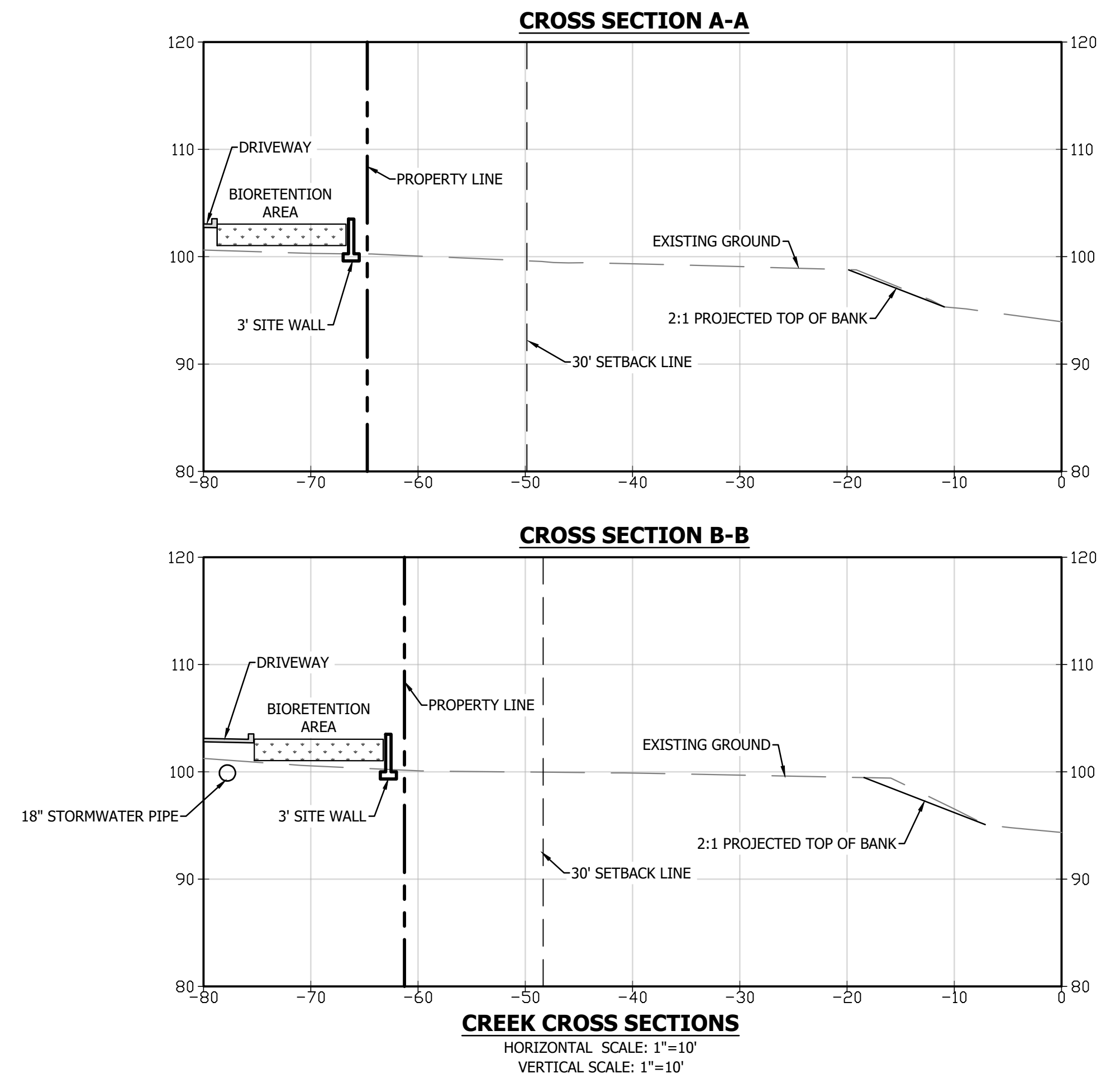

REV.	DESCRIPTION	BY	DATE

**BC ENGINEERING GROUP, INC.**  
**CIVIL ENGINEERING & LAND PLANNING**  
www.bceengineeringgroup.com  
Phone: 707.542.4321  
SANTA ROSA OFFICE:  
418 B Street, Third Floor, Santa Rosa CA 95401  
UKIAH OFFICE:  
603 S. State Street, Ukiah CA 95482



**HERITAGE COMMERCE CENTER**  
CREEK EXHIBIT  
MCNEILL REAL ESTATE SERVICES, INC.  
WEST MARINER WAY  
SANTA ROSA, CA 95401

Date: 09/06/2023  
Job: 1978-20  
Drawn: EK/MB  
Scale: AS SHOWN  
APN: 035-530-016, -055  
Permit #:  
Sheet:

**C1.0**  
1 of 1

NOT FOR CONSTRUCTION